

			21

(SUBMIT IN TRIPLICATE)

UNITED STATES
DEPARTMENT OF THE INTERIOR
GEOLOGICAL SURVEY

Indian Agency _____
Mearilla
 Allottee **Contract #116**
 Lease No. _____

SUNDRY NOTICES AND REPORTS ON WELLS

NOTICE OF INTENTION TO DRILL.....	X	SUBSEQUENT REPORT OF WATER SHUT-OFF.....
NOTICE OF INTENTION TO CHANGE PLANS.....		SUBSEQUENT REPORT OF SHOOTING OR ACIDIZING.....
NOTICE OF INTENTION TO TEST WATER SHUT-OFF.....		SUBSEQUENT REPORT OF ALTERING CASING.....
NOTICE OF INTENTION TO REDRILL OR REPAIR WELL.....		SUBSEQUENT REPORT OF REDRILLING OR REPAIR.....
NOTICE OF INTENTION TO SHOOT OR ACIDIZE.....		SUBSEQUENT REPORT OF ABANDONMENT.....
NOTICE OF INTENTION TO PULL OR ALTER CASING.....		SUPPLEMENTARY WELL HISTORY.....
NOTICE OF INTENTION TO ABANDON WELL.....		

(INDICATE ABOVE BY CHECK MARK NATURE OF REPORT, NOTICE, OR OTHER DATA)

June 6 1957

Well No. "E" 10-21 is located 990 ft. from N line and 990 ft. from E line of sec. 21

NE/4 NE/4 21 (¼ Sec. and Sec. No.)	26N 34E (Twp.) (Range)	RPM (Meridian)
Tapacito C Extra & Blanco Mesqueros (Field)	Sio Arriba (County or Sub-division)	New Mexico (State or Territory)

The elevation of the ~~deck~~^{upper} ~~door~~^{grad} above sea level is 7122 ft.

DETAILS OF WORK

(State names of and expected depths to objective sands; show sizes, weights, and lengths of proposed casings; indicate mudding jobs, cementing points, and all other important proposed work)

Propose to drill 13-3/4" hole to 215', set 10-3/4" OD casing and cement to surface w/200 sx reg. Drill 9-7/8" hole to 4140', set 7-5/8" OD casing and cement w/150 sx w/8% gel and 50 sx neat. Drill 6-3/4" hole to total depth of 6240', set 5 1/2" OD liner from 3910' to 6240' and cement w/200 sx reg. Test top of liner and, if necessary, bradenhead squeeze w/50 sx reg. Perforate the 5 1/2" liner from 5530-5210' and fracture the Mesaverde w/approx 150,000 gals water. Isolate the Mesaverde with a temp bridge plug, perforate the 7-5/8" casing from 3890-4010 and fracture the Pictured Cliffs w/approx 40,000 gals water w/1# oil/gal. Retrieve the bridge plug and clean out to total depth. Hang 2-3/8" OD tubing at 6175' w/production packer set at 5490' and side-door choke at 5489' to produce the Mesaverde. Inside the 2-3/8" tubing by 7-5/8" casing annulus, hang 1 1/2" OD tubing at 3980' to produce the Pictured Cliffs. Swab in both formations and complete well. The E/2 of Sec 21, containing 320 acres, is dedicated for both the Pictured Cliffs and Mesaverde formations.

I understand that this plan of work must receive approval in writing by the Geological Survey before operations may be commenced.

Company _____

Address _____

By RAY PHILLIPS

Title Asst Mgr, Prod Operations



NEW MEXICO
OIL CONSERVATION COMMISSION

Form C-128

Well Location and/or Gas Proration Plat

Date June 5, 1957

Operator Northwest Production Lease "X"

Well No. E 10-21 Section 21 Township 26 North Range 3 West NMPM

Located 990 Feet From North Line, 990 Feet From East Line,

Rio Arriba County, New Mexico. G. L. Elevation 7122

Name of Producing Formation Pictured Cliffs Pool Tapacito PG Extra Dedicated Acreage 320

(Note: All distances must be from outer boundaries of Section)

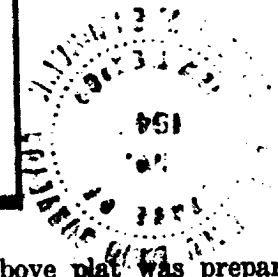
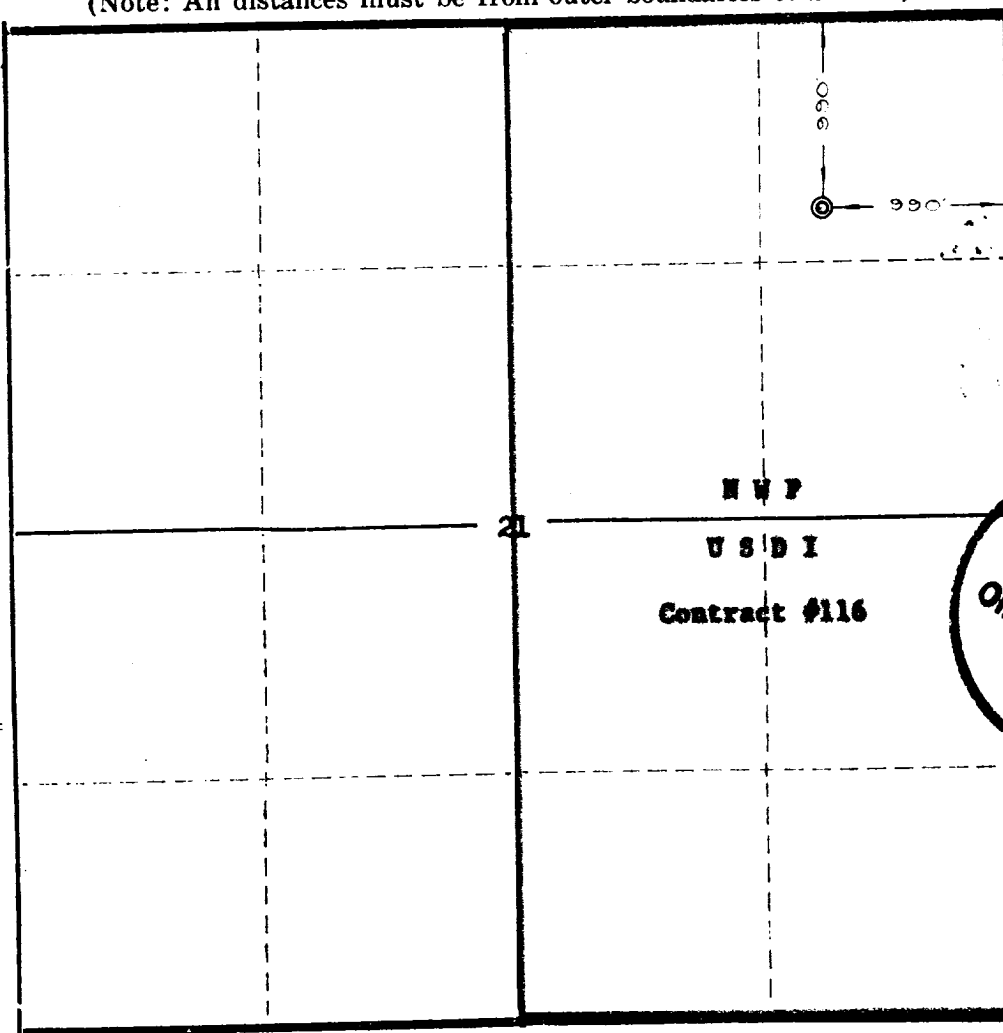

NOTE

This section of form is to be used for gas wells only.

SCALE: 1"=1000'

1. Is this Well a Dual Comp. ? Yes ☒ No ☐
2. If the answer to Question 1 is yes, are there any other dually completed wells within the dedicated acreage?
Yes ☐ No ☒

Name RAY PHILLIPS
Position Asst Mgr. Production Operations
Representing NORTHWEST PRODUCTION CORPORATION
Address 520 Central Ave.
Albuquerque, New Mexico

This is to certify that the above plat was prepared from field notes of actual surveys made by me or under my supervision and that the same are true and correct to the best of my knowledge and belief.

Date Surveyed August 31, 1956

Ernest V. Echohawk
Ernest V. Echohawk
Reg. Land Surveyor, N. Mex., Reg. No. 1545

NEW MEXICO
OIL CONSERVATION COMMISSION

Form C-128

Well Location and/or Gas Proration Plat

Date June 5, 1957

Operator Northwest Production Lease "N"
Well No. E 10-21 Section 21 Township 26 North Range 3 West NMPM
Located 990 Feet From North Line, 990 Feet From East Line,
Rio Arriba County, New Mexico. G. L. Elevation 7122

Name of Producing Formation Mesa Verde Pool Blanco MV Dedicated Acreage 320

(Note: All distances must be from outer boundaries of Section)

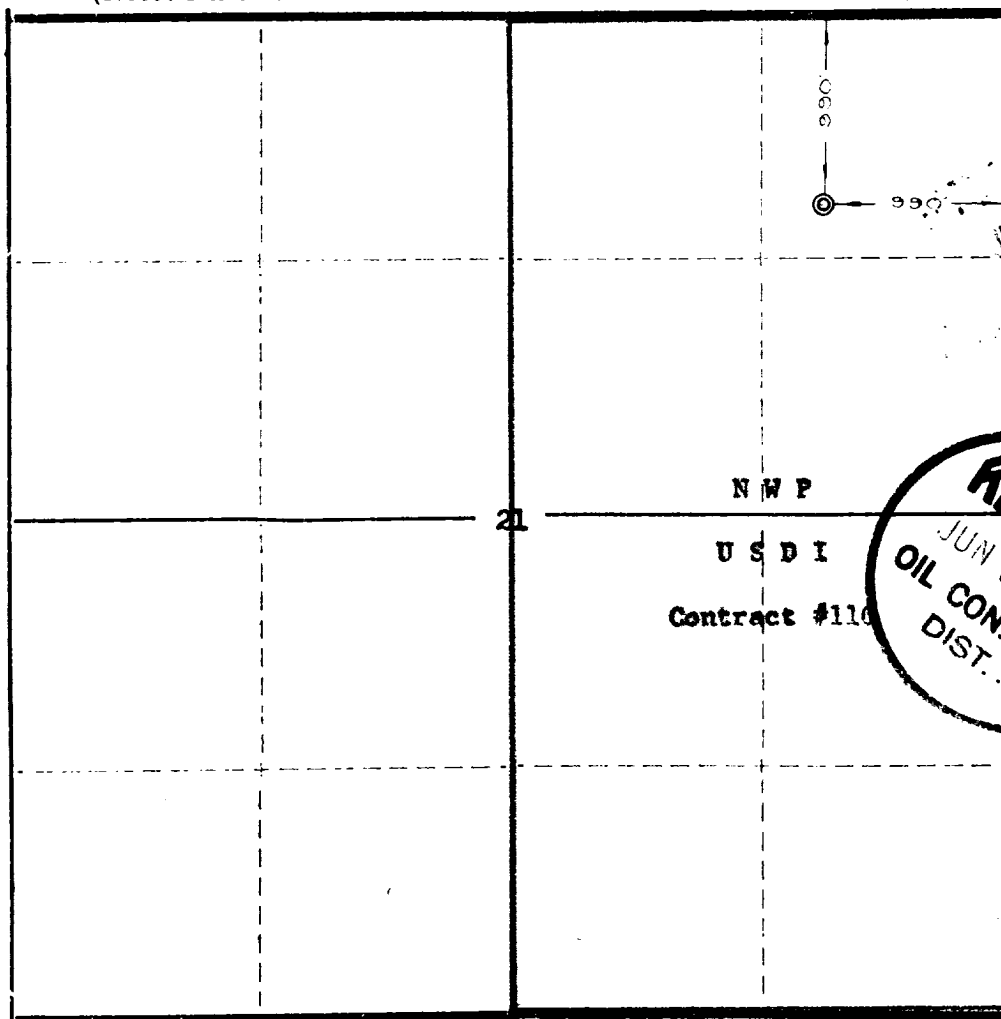

NOTE

This section of
form is to be
used for gas
wells only.

SCALE: 1"=1000'

1. Is this Well a Dual Comp. ? Yes ☒ No ☐
2. If the answer to Question 1 is yes, are there any other
dually completed wells within the dedicated acreage?
Yes ☐ No ☒

RAY PHILLIPS

Name Ray Phillips

Position Asst Mgr, Production Operations

Representing NORTHWEST PRODUCTION CORPORATION

Address 520 Simms Building

Albuquerque, New Mexico

This is to certify that the above plat was prepared
from field notes of actual surveys made by me or
under my supervision and that the same are true and
correct to the best of my knowledge and belief.

Date Surveyed August 31, 1956

Ernest V. Echohawk

Ernest V. Echohawk

Reg. Land Surveyor, N. Mex., Reg. No. 1545

NEW MEXICO OIL CONSERVATION COMMISSION
Well Location and Acreage Dedication Plat

Section A.

Date June 5, 1957

Operator Northwest Production Corp. Lease "E"
Well No. 10-21 Unit Letter A Section 21 Township 26N Range 3W NMPM
Located 990 Feet From North Line, 990 Feet From East Line
County Rio Arriba G. L. Elevation 7122 Dedicated Acreage 320 Acres
Name of Producing Formation Pictured Cliffs Pool Tapacito PG Extn

1. Is the Operator the only owner* in the dedicated acreage outlined on the plat below?
Yes ☒ No ☐.
2. If the answer to question one is "no," have the interests of all the owners been consolidated by communitization agreement or otherwise? Yes ☐ No ☐. If answer is "yes," Type of Consolidation _____
3. If the answer to question two is "no," list all the owners and their respective interests below:

Owner

Land Description

Section B

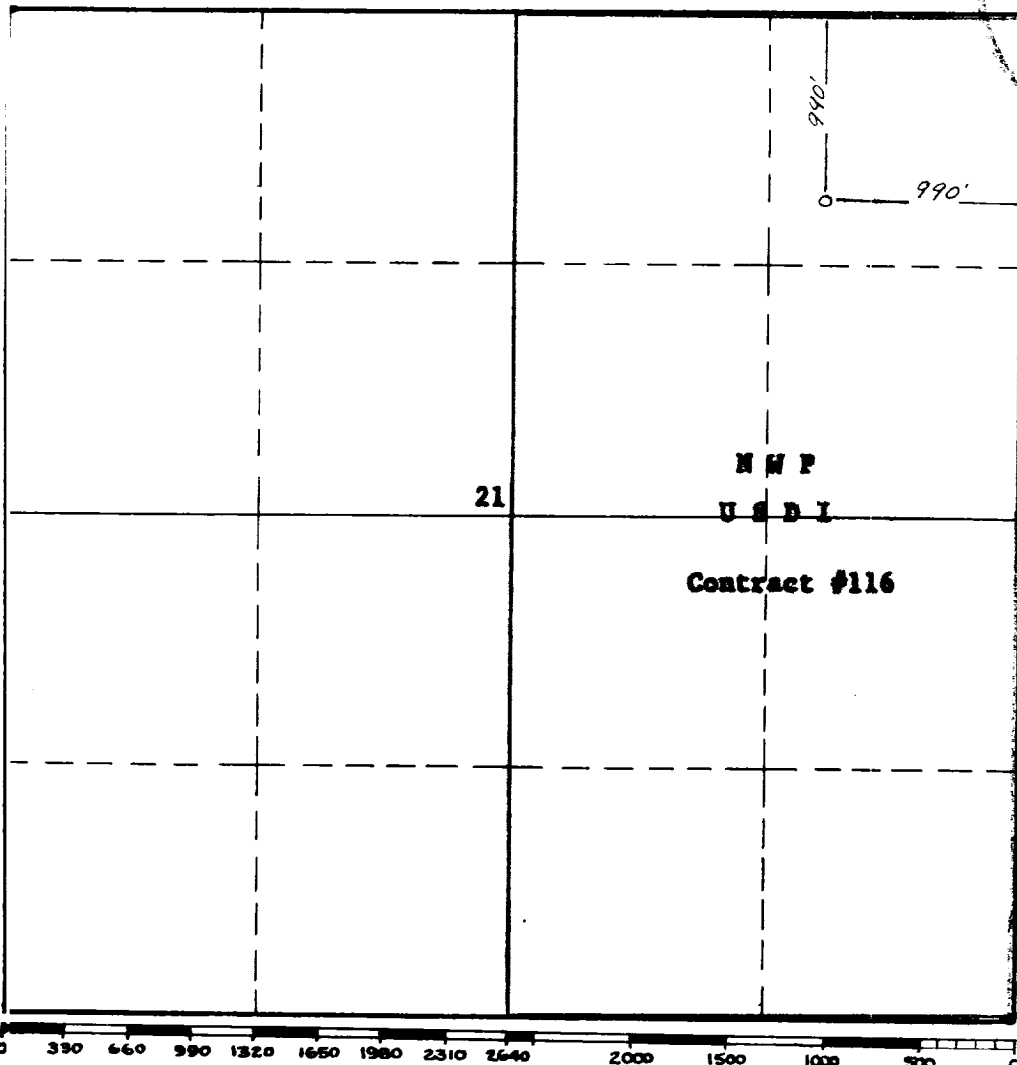

This is to certify that the information in Section A above is true and complete to the best of my knowledge and belief.

Northwest Production Corporation
(Operator)

RAY PHILLIPS
Ray Phillips, Asst Mgr, Prod Opr
(Representative)

520 Sims Bldg, Albuquerque, N.M.
Address

This is to certify that the well location shown on the plat in Section B was plotted from field notes of actual surveys made by me or under my supervision and that the same is true and correct to the best of my knowledge and belief.

Date Surveyed 8-31-56

E. V. Echohawk
Registered Professional
Engineer and/or Land Surveyor.

Certificate No. 1545

INSTRUCTIONS FOR COMPLETION:

1. Operator shall furnish and certify to the information called for in Section A.
2. Operator shall outline the dedicated acreage for both oil and gas wells on the plat in Section B.
3. A registered professional engineer or land surveyor registered in the State of New Mexico or approved by the Commission shall show on the plat the location of the well and certify this information in the space provided.
4. All distances shown on the plat must be from the outer boundaries of Section.
5. If additional space is needed for listing owners and their respective interests as required in question 3, Section A, please use space below

* "Owner" means the person who has the right to drill into and to produce from any pool and to appropriate the production either for himself or for himself and another. (65-3-29 (e) NMSA 1953 Comp.)

NEW MEXICO OIL CONSERVATION COMMISSION
Well Location and Acreage Dedication Plat

Section A.

Date June 5, 1957

Operator Northwest Production Corporation Lease "G"
Well No. 10-21 Unit Letter A Section 21 Township 26N Range 3W NMPM
Located 990 Feet From North Line, 990 Feet From East Line
County Rio Arriba G. L. Elevation 7122 Dedicated Acreage 320 Acres
Name of Producing Formation Mosavarda Pool Blanco Mosavarda

1. Is the Operator the only owner* in the dedicated acreage outlined on the plat below?
Yes X No .
2. If the answer to question one is "no," have the interests of all the owners been consolidated by communitization agreement or otherwise? Yes No . If answer is "yes," Type of Consolidation
3. If the answer to question two is "no," list all the owners and their respective interests below:

Owner

Land Description

Section B

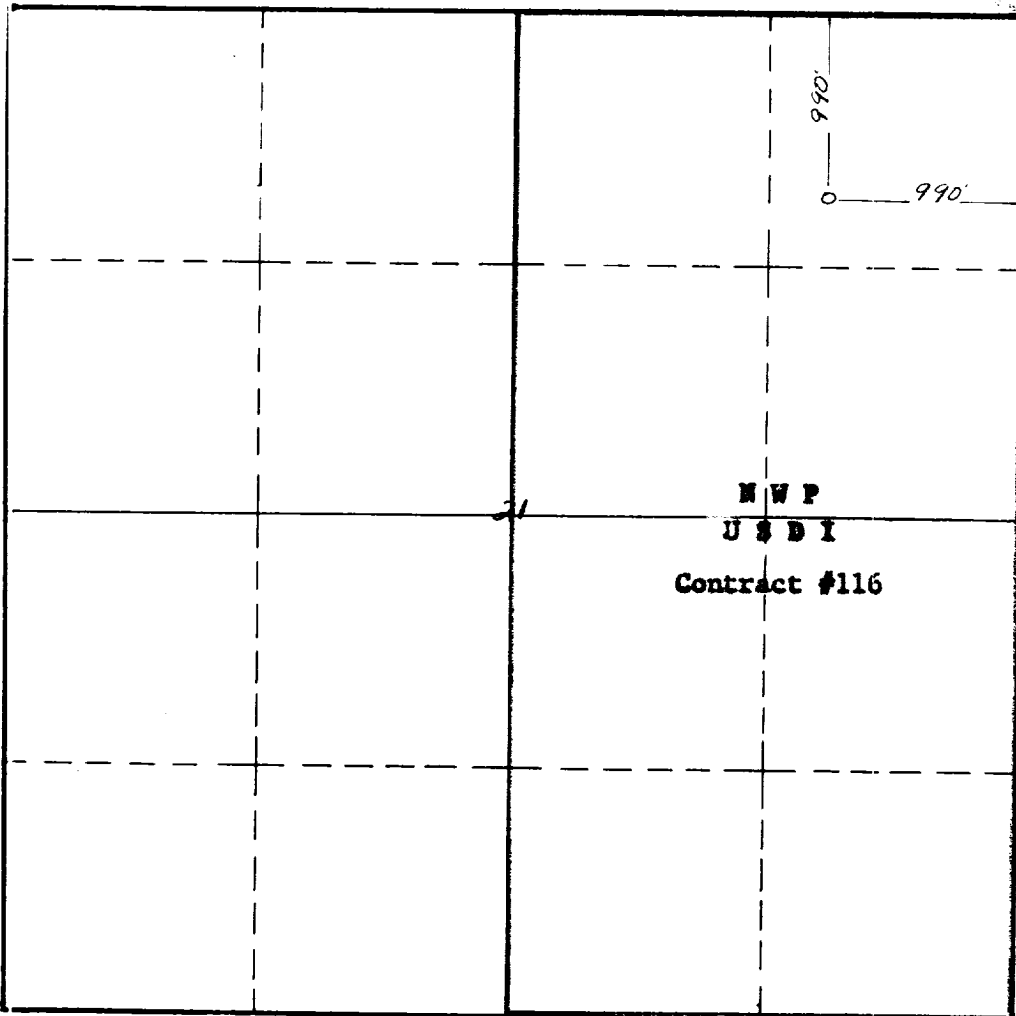

This is to certify that the information in Section A above is true and complete to the best of my knowledge and belief.

Northwest Production Corporation
(Operator)
RAY PHILLIPS
Ray Phillips, Asst Mgr. Prod Opr
(Representative)

520 Sims Bldg. Albuquerque, N.M.
Address

This is to certify that the well location shown on the plat in Section B was plotted from field notes of actual surveys made by me or under my supervision and that the same is true and correct to the best of my knowledge and belief.

Date Surveyed 8-31-56

E. V. Echobank
Registered Professional
Engineer and/or Land Surveyor.

Certificate No.

INSTRUCTIONS FOR COMPLETION:

1. Operator shall furnish and certify to the information called for in Section A.
2. Operator shall outline the dedicated acreage for both oil and gas wells on the plat in Section B.
3. A registered professional engineer or land surveyor registered in the State of New Mexico or approved by the Commission shall show on the plat the location of the well and certify this information in the space provided.
4. All distances shown on the plat must be from the outer boundaries of Section.
5. If additional space is needed for listing owners and their respective interests as required in question 3, Section A, please use space below

* "Owner" means the person who has the right to drill into and to produce from any pool and to appropriate the production either for himself or for himself and another. (65-3-29 (e) NMSA 1953 Comp.)