

NO. OF COPIES RECEIVED	6
DISTRIBUTION	
SANTA FE	1
FILE	
U.S.G.S.	2
LAND OFFICE	
OPERATOR	2

P. O. BOX 2088

SANTA FE, NEW MEXICO 87501

30-043-20626

5A. Indicate Type of Lease
STATE <input type="checkbox"/> FEDERAL <input type="checkbox"/>
5. State Oil & Gas Lease No.
14-08-0001-12395

## APPLICATION FOR PERMIT TO DRILL, DEEPEN, OR PLUG BACK

1a. Type of Work

DRILL ☐DEEPEN ☐PLUG BACK ☐

b. Type of Well

OIL WELL ☐GAS WELL ☐

OTHER

Boreholes

SINGLE ZONE ☐MULTIPLE ZONE ☐

2. Name of Operator

Gas Company of New Mexico

3. Address of Operator

First International Bldg., #1800, Dallas, Texas 75270

4. Location of Well

UNIT LETTER N LOCATED 404 FEET FROM THE South LINEAND 2380 FEET FROM THE West LINE OF SEC. 20 TWP. 15N RST. 1E NMPW

7. Unit Agreement Name

Las Milpas

8. Farm or Lease Name

San Ysidro

9. Well No.

5A

10. Field and Pool, or Wildcat

Gas Storage

12. County

Sandoval

18. Proposed Depth

200 feet

19A. Formation

Strat Test

20. Rotary or C.T.

Rotary

21. Elevations (Show whether DF, KI, etc.)

5698 GL

21A. Kind &amp; Status Plug. Bond

National

21B. Drilling Contractor

J. Ludwick

22. Approx. Date Work will start

August 15, 1979

23.

## PROPOSED CASING AND CEMENT PROGRAM

SIZE OF HOLE	SIZE OF CASING	WEIGHT PER FOOT	SETTING DEPTH	SACKS OF CEMENT	EST. TOP
5.13	None	None	200 feet	30 sacks	surface

The information received from this core hole will be used for geological purposes only.

Core hole was cemented to the surface after completion.

THIS WELL IS BEING DRILLED FOR STRATIGRAPHIC TEST-HOLE FOR OIL AND GAS PRODUCTION ONLY AND UNDER NO CIRCUMSTANCES WILL IT BE PRODUCED.

SEP 27 1979  
OIL CON. COM.  
DIST. 3

ABOVE SPACE DESCRIBE PROPOSED PROGRAM: IF PROPOSAL IS TO DEEPEN OR PLUG BACK, GIVE DATA ON PRESENT PRODUCTIVE ZONE AND PROPOSED NEW PRODUCTION ZONE. GIVE BLOWOUT PREVENTER PROGRAM, IF ANY.

I hereby certify that the information above is true and complete to the best of my knowledge and belief.

By Ronald H. Sautz Title Drilling & Production Engineer Date 9/24/79

(This space for State Use)

APPROVED BY Frank J. Chang TITLE Oil & Gas Inspector, Dist. #3 DATE SEP 27 1979

CONDITIONS OF APPROVAL, IF ANY:

**NEW MEXICO OIL CONSERVATION COMMISSION  
WELL LOCATION AND ACREAGE DEDICATION PLAT**

Form C-102  
Supersedes C-128  
Effective 1-1-65

All distances must be from the outer boundaries of the Section.

*Partial*

Operator <b>GAS COMPANY OF NEW MEXICO</b>			Lease <b>SAN YSIDRO</b>		Well No. <b>5 A</b>
Unit Letter <b>N</b>	Section <b>20</b>	Township <b>15 NORTH</b>	Range <b>1 EAST</b>	County <b>SANDOVAL</b>	
Actual Footage Location of Well: <b>404</b> feet from the <b>SOUTH</b> line and <b>2380</b> feet from the <b>WEST</b> line					
Ground Level Elev. <b>5698</b>	Producing Formation <b>N/A</b>	Pool <b>Gas Storage</b>		Dedicated Acreage: <b>N/A</b> Acres	

1. Outline the acreage dedicated to the subject well by colored pencil or hachure marks on the plat below.
2. If more than one lease is dedicated to the well, outline each and identify the ownership thereof (both as to working interest and royalty).
3. If more than one lease of different ownership is dedicated to the well, have the interests of all owners been consolidated by communitization, unitization, force-pooling, etc?

☐ Yes ☐ No If answer is "yes," type of consolidation \_\_\_\_\_

If answer is "no," list the owners and tract descriptions which have actually been consolidated. (Use reverse side of this form if necessary.) \_\_\_\_\_

No allowable will be assigned to the well until all interests have been consolidated (by communitization, unitization, forced-pooling, or otherwise) or until a non-standard unit, eliminating such interests, has been approved by the Commission.

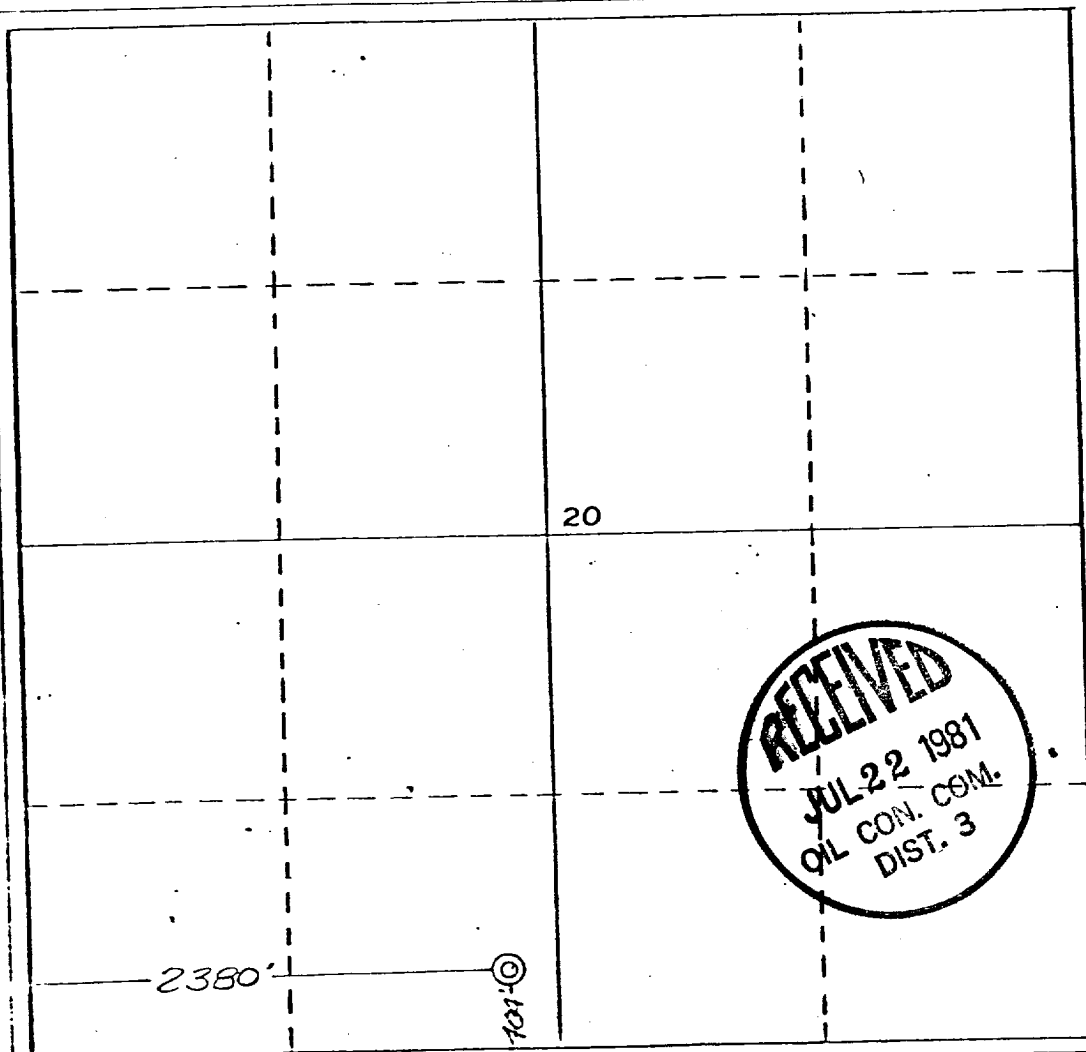

**CERTIFICATION**

I hereby certify that the information contained herein is true and complete to the best of my knowledge and belief.

*Ronald M. Sentz*

Name

**Ronald M. Sentz**

Position

**Drilling & Production Eng.**

Company

**Gas Company of New Mexico**

Date

**July 20, 1981**

I hereby certify that the well location shown on this plat as plotted in the field notes was actually made by me or under my supervision, and that the same is true and correct to the best of my knowledge and belief.

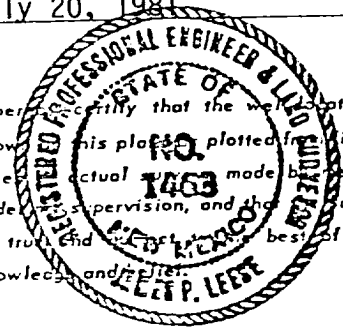

Date Surveyed

**8 May 1979**

Registered Professional Engineer  
and Land Surveyor

*James P. Lease*  
**James P. Lease**

Certificate No.

**1463**

220 660 90 1320 1650 1980 2310 2640 2970 3300 3630 3960 4290 4620 4950 5280 5610 5940 6270 6600