

(SUBMIT IN TRIPLICATE)

UNITED STATES
DEPARTMENT OF THE INTERIOR
GEOLOGICAL SURVEY

Budget Bureau No. 42-R358.4.
Approval expires 12-31-60.

Land Office **New Mexico**

Lease No. **NM 088995**

Unit **Spencer-Federal**

SUNDRY NOTICES AND REPORTS ON WELLS

NOTICE OF INTENTION TO DRILL		SUBSEQUENT REPORT OF WATER SHUT-OFF	
NOTICE OF INTENTION TO CHANGE PLANS		SUBSEQUENT REPORT OF SHOOTING OR ACIDIZING	
NOTICE OF INTENTION TO TEST WATER SHUT-OFF		SUBSEQUENT REPORT OF ALTERING CASING	
NOTICE OF INTENTION TO RE-DRILL OR REPAIR WELL		SUBSEQUENT REPORT OF RE-DRILLING OR REPAIR	
NOTICE OF INTENTION TO SHOOT OR ACIDIZE		SUBSEQUENT REPORT OF ABANDONMENT	
NOTICE OF INTENTION TO PULL OR ALTER CASING		SUPPLEMENTARY WELL HISTORY	
NOTICE OF INTENTION TO ABANDON WELL			

U.S. GEOLOGICAL SURVEY
FARMINGTON, NEW MEXICO

(INDICATE ABOVE BY CHECK MARK NATURE OF REPORT, NOTICE, OR OTHER DATA)

June 23, 1961

19

Well No. **10** is located **925** ft. from **N** line and **810** ft. from **E** line of sec. **11**

NW 1/4 **Sec. 11** **10 N** **3 W** **NMP**
(1/4 Sec. and Sec. No.) (Twp.) (Range) (Meridian)

Unknown **Sandoval** **New Mexico**
(Field) (County or Subdivision) (State or Territory)

The elevation of the derrick floor above sea level is **6692** ft. (**Ground**)

DETAILS OF WORK

(State names of and expected depths to objective sands; show sizes, weights, and lengths of proposed casings; indicate mudding jobs, cementing points, and all other important proposed work)

Rotary Wells to T.D.

T.D. est. 1300'

if productive will run casing to T.D. & cement to surface - perforate opposite pay zone.

Mesa Verde Test

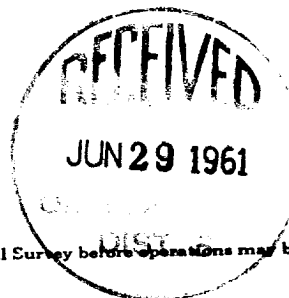

I understand that this plan of work must receive approval in writing by the Geological Survey before operations may be commenced.

Company **W.W. Holmes**

Address **P.O. Box 567**

Amarillo, Texas

By **John H. Burton, Agent**
Title **Box 1594, Santa Fe, NM**

NEW MEXICO OIL CONSERVATION COMMISSION

Well Location and Acreage Dedication Plat

SECTION A.

Date **June 23, 1961**

Operator **W. W. Holmes** Lease **Spencer-Federal**
 Well No. **20** Unit Letter **B** Section **11** Township **18 North** Range **3 West** NMPM
 Located **1925** Feet From **North** Line **810** Feet From **West** Line
 County **Sandoval** G. L. Elevation **6692** Dedicated Acreage Acres
 Name of Producing Formation **Blanco Verde** Pool **Holmes**

1. Is the Operator the only owner* in the dedicated acreage outlined on the plat below? Yes ☒ No ☐
2. If the answer to question One is "No," have the interests of all the owners been consolidated by communization agreement or otherwise? Yes ☐ No ☐ If answer is "Yes," Type of Consolidation _____
3. If the answer to question Two is "No," list all the owners and their respective interests below:

OWNER

LAND DESCRIPTION

SECTION B.

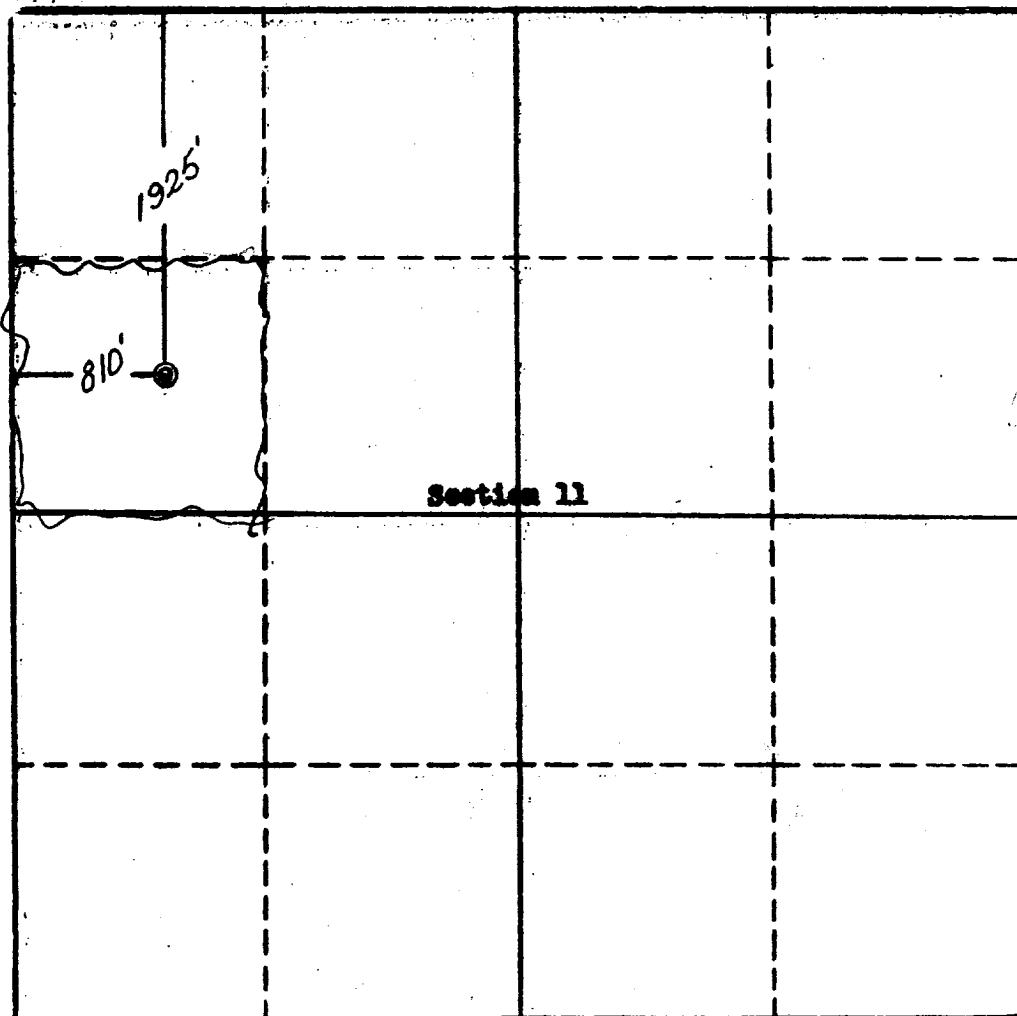

This is to certify that the information in Section A above is true and complete to the best of my knowledge and belief.

W. W. Holmes
P.O. Box 567, Amarillo, Texas

John E. Burton
John E. Burton, Agent
P.O. Box 1574, Santa Fe, NM

(ADDRESS)

This is to certify that the information shown on the plat above was plotted from actual survey and is true and correct to the best of my knowledge and belief.

Date Surveyed **June 19, 1961**

Four States Engineering Co.
 FARMINGTON, NEW MEXICO

E. L. Potter
 REGISTERED ENGINEER OR
 LAND SURVEYOR

Certificate No. **3084**