

(SUBMIT IN TRIPLICATE)

UNITED STATES  
DEPARTMENT OF THE INTERIOR  
GEOLOGICAL SURVEY

Land Office Santa FeLease No. 970081Unit SE/4Unit 2-Sec. #943

## SUNDRY NOTICES AND REPORTS ON WELLS

NOTICE OF INTENTION TO DRILL	<input checked="" type="checkbox"/>	SUBSEQUENT REPORT OF WATER SHUT-OFF	
NOTICE OF INTENTION TO CHANGE PLANS		SUBSEQUENT REPORT OF SHOOTING OR ACIDIZING	
NOTICE OF INTENTION TO TEST WATER SHUT-OFF		SUBSEQUENT REPORT OF ALTERING CASING	
NOTICE OF INTENTION TO RE-DRILL OR REPAIR WELL		SUBSEQUENT REPORT OF RE-DRILLING OR REPAIR	
NOTICE OF INTENTION TO SHOOT OR ACIDIZE		SUBSEQUENT REPORT OF ABANDONMENT	
NOTICE OF INTENTION TO PULL OR ALTER CASING		SUPPLEMENTARY WELL HISTORY	
NOTICE OF INTENTION TO ABANDON WELL			

(INDICATE ABOVE BY CHECK MARK NATURE OF REPORT, NOTICE, OR OTHER DATA)

August 15, 1955, 19

**Huerfano Unit**  
Well No. 26-33 is located 990 ft. from [N] line and 1190 ft. from [E] line of sec. 33

SE/4 Sec. 33 - T 27-N R 9-W N.M.P.M.  
(1/4 Sec. and Sec. No.) (Twp.) (Range) (Meridian)

SE. 1/4 Sec. 33 - San Juan County New Mexico  
(Field) (County or Subdivision) (State or Territory)

The elevation of the ~~surface~~ ungraded ground above sea level is 651.1 ~~ft.~~

## DETAILS OF WORK

(State names of and expected depths to objective sands; show sizes, weights, and lengths of proposed casings; indicate mudding jobs, cementing points, and all other important proposed work)

Propose to spud with cable tools; then drill with rotary tools to the top of the Pictured Cliffs Formation - expected between 1,900 feet and 2,200 feet below the surface. Completion with cable tools - and sand oil fracturing or shooting with solidified nitro-glycerin as conditions warranting.

Casing program: 90 feet 8-5/8" new 8 rd. thi. 24# casing. Circulate cement to surface, using at least 75 sacks of cement.

5-1/2" O.D. 11# J-55 casing to be set on top of ~~KIAMATH~~ Pictured Cliffs formation, cemented with 100 sacks regular cement.

1" tubing to be set within 20 feet of total depth for production.

I understand that this plan of work must receive approval in writing by the Geological Survey before operations may be commenced.

Company J. Glenn Turner - Unit Operator

Address Box 726 - Farmington, New Mexico

(Home Office: 17th Cir. - Mercantile Bank Building,  
Dallas 1, Texas)

Title C. Doeson Neal, Agent in Farmington



**J. Glenn Turner**

Company **Huerfano Drilling Co.**

**S.F. # 078081**

Lease **Huerfano Unit**

Well No. **26-33**

Sec. **33** T. **27 N** R. **9 W** N.M.P.M.

Location **990 feet from south line 1190 feet  
from east line.**

Elevation: **6541 OL**

**San Juan County**

**New Mexico**

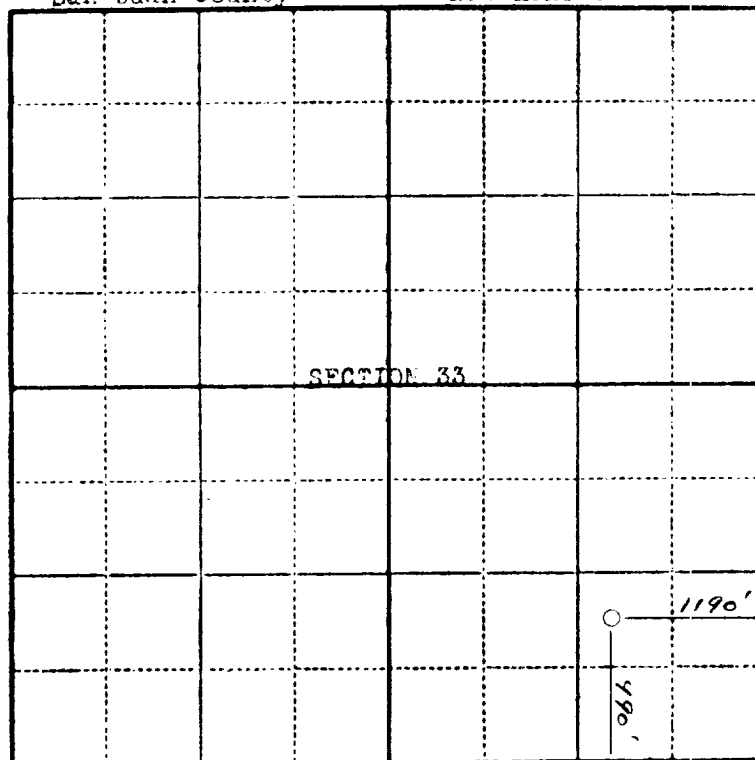

Scale—4 inches equal 1 mile.

This is to certify that the above plat was prepared from field notes of actual surveys made by me or under my supervision and that the same are true and correct to the best of my knowledge and belief.

*Stephen H. Kinney*

**STEPHEN H. KINNEY**  
Registered Professional  
Engineer and Land Surveyor

Surveyed **July 20**, **1955**

Seal:

