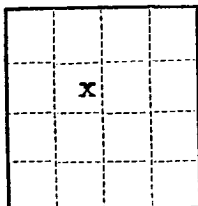

30-045-06257

Budget Bureau 42-R358.3.
Approval expires 12-31-55.Form 9-381a
(Feb. 1951)

(SUBMIT IN TRIPLICATE)

UNITED STATES
DEPARTMENT OF THE INTERIOR
GEOLOGICAL SURVEY

Land Office Santa Fe
Lease No. 078356-A
Unit NW/4 Sec. 26

SUNDRY NOTICES AND REPORTS ON WELLS

NOTICE OF INTENTION TO DRILL.....	XXXX	SUBSEQUENT REPORT OF WATER SHUT-OFF.....
NOTICE OF INTENTION TO CHANGE PLANS.....		SUBSEQUENT REPORT OF SHOOTING OR ACIDIZING.....
NOTICE OF INTENTION TO TEST WATER SHUT-OFF.....		SUBSEQUENT REPORT OF ALTERING CASING.....
NOTICE OF INTENTION TO RE-DRILL OR REPAIR WELL.....		SUBSEQUENT REPORT OF RE-DRILLING OR REPAIR.....
NOTICE OF INTENTION TO SHOOT OR ACIDIZE.....		SUBSEQUENT REPORT OF ABANDONMENT.....
NOTICE OF INTENTION TO PULL OR ALTER CASING.....		SUPPLEMENTARY WELL HISTORY.....
NOTICE OF INTENTION TO ABANDON WELL.....		

(INDICATE ABOVE BY CHECK MARK NATURE OF REPORT, NOTICE, OR OTHER DATA)

August 21, 1953.

Turner-

G. R. Gentle

Well No. 2 is located 1,690 ft. from [N] line and 1,650 ft. from [W] line of sec. 26

NW/4 Sec. 26

(1/4 Sec. and Sec. No.)

T 27 N R 9 W

(Twp.)

(Range)

N.M.P.M.

(Meridian)

Fulcher-Kutz

(Field)

San Juan County

(County or Subdivision)

New Mexico

(State or Territory)

The elevation of the ~~derrick~~ ^{ground} floor above sea level is 6526 ft.

DETAILS OF WORK

(State names of and expected depths to objective sands; show sizes, weights, and lengths of proposed casings; indicate mudding jobs, cementing points, and all other important proposed work)

Propose to drill with rotary tools to the top of the Pictured Cliff Formation - expected between 1,800 feet and 2,200 feet below surface; complete drilling with cable tools to bottom of Pictured Cliff formation; and shoot with solidified nitro glycerin.

Casing program: 100 feet of 9-5/8" new H&L 8 rd. thread, 3/4" J. & L. Casing, when available. If not available, use 8-5/8" - 28# new J. & L. Casing. Circulate to surface. 5-1/2" - 17# J. & L. casing to be set on top of Pictured Cliff formation, cemented with 150 sacks regular cement.

1" tubing to be set to within 50 feet of total depth for production.

I understand that this plan of work must receive approval in writing by the Geological Survey before operations may be commenced.

J. Glenn Turner

Company

Address c/o San Juan Drilling Company
Box 728 - Farmington, New Mexico.

By

Home Office: 1711 Mercantile Bank Building
Dallas 1, Texas.

Title

Robert Neal
Agent in Farmington

1. The first part of the document discusses the importance of maintaining accurate records of all transactions. It emphasizes that proper record-keeping is essential for the integrity of the financial system and for the ability to detect and prevent fraud.

2. The second part of the document outlines the specific requirements for record-keeping. It states that all transactions must be recorded in a timely and accurate manner, and that the records must be maintained for a minimum of five years. It also discusses the importance of ensuring that the records are accessible and can be easily reviewed.

3. The third part of the document discusses the role of the auditor in ensuring the accuracy of the records. It states that the auditor must perform a thorough review of the records and must report any discrepancies or irregularities to the appropriate authorities. It also discusses the importance of the auditor's independence and objectivity.

4. The fourth part of the document discusses the consequences of failing to comply with the record-keeping requirements. It states that individuals or organizations that fail to maintain accurate records may be subject to fines, penalties, or even criminal prosecution. It also discusses the importance of ensuring that the records are protected from loss or destruction.

5. The fifth part of the document discusses the importance of transparency and accountability in the financial system. It states that the public has a right to know how the system is operating and that the records must be made available to the public in a timely and accessible manner. It also discusses the importance of ensuring that the records are used to improve the system and to prevent future problems.

Company.....J. Glenn Turner.....

Lease.....G. R. Gentle.....Well No. 2.....

Sec. 26....., T. 27 N., R. 9 W., N.M.P.M.

Location.....1690' from the North line and 1650' from
the West line.

Elevation.....6256 Ungraded ground.....

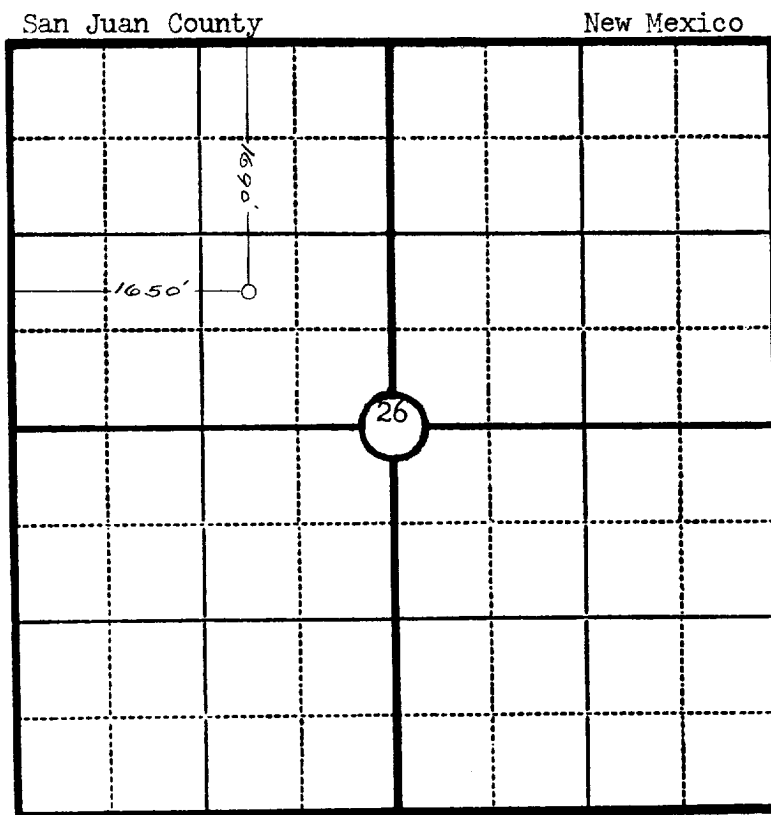

Scale—4 inches equal 1 mile.

This is to certify that the above plat was prepared from field notes of actual surveys made by me or under my supervision and that the same are true and correct to the best of my knowledge and belief.

Seal:

Registered Professional
Engineer and Land Surveyor.

James P. Leese
N. Mex. Reg. No. 1463

Surveyed June 30, 1953

