

(SUBMIT IN TRIPLICATE)

Indian Agency Window Rock

UNITED STATES

Arizona

DEPARTMENT OF THE INTERIOR

Allottee Navajo Tribal

GEOLOGICAL SURVEY

Lease No. 14-20-603-1043

## SUNDRY NOTICES AND REPORTS ON WELLS

NOTICE OF INTENTION TO DRILL <u>X</u>	SUBSEQUENT REPORT OF WATER SHUT-OFF
NOTICE OF INTENTION TO CHANGE PLANS	SUBSEQUENT REPORT OF SHOOTING OR ACIDIZING
NOTICE OF INTENTION TO TEST WATER SHUT-OFF	SUBSEQUENT REPORT OF ALTERING CASING
NOTICE OF INTENTION TO REDRILL OR REPAIR WELL	SUBSEQUENT REPORT OF REDRILLING OR REPAIR
NOTICE OF INTENTION TO SHOOT OR ACIDIZE	SUBSEQUENT REPORT OF ABANDONMENT
NOTICE OF INTENTION TO PULL OR ALTER CASING	SUPPLEMENTARY WELL HISTORY
NOTICE OF INTENTION TO ABANDON WELL	

(INDICATE ABOVE BY CHECK MARK NATURE OF REPORT, NOTICE, OR OTHER DATA)

December 1, 1958

New Mexico Navajo  
Well No. 2 is located 990 ft. from [N] line and 990 ft. from [E] line of sec. 27  
NE/4 of NE/4 Sec 27 28N 17W NMPM  
(1/4 Sec. and Sec. No.) (Twp.) (Range) (Meridian)  
Wildcat San Juan New Mexico  
(Field) (County or Subdivision) (State or Territory)

The elevation of the ~~ground~~ ground above sea level is 5284 ft.

### DETAILS OF WORK

(State names of and expected depths to objective sands; show sizes, weights, and lengths of proposed casings; indicate mudding jobs, cementing points, and all other important proposed work)

We propose to set 8 5/8" casing at 100' with sufficient cement to circulate, WOC 24 hours, and test casing to 1000' for 30 minutes. We propose to drill a 6 3/4" hole to approximately 1700 feet. This is a "strat" test and will be plugged as directed by U.S.G.S. Attached are copies of well location plat.

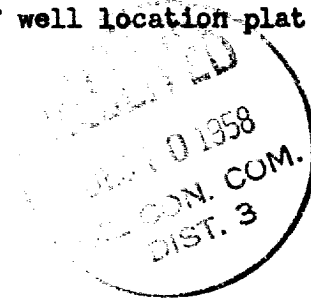

I understand that this plan of work must receive approval in writing by the Geological Survey before operations may be commenced.

Company Sun Ray Mid-Continent Oil Company

Address Box 128

Hobbs, New Mexico

By [Signature]

Title Foreman

NEW MEXICO OIL CONSERVATION COMMISSION  
Well Location and Acreage Dedication Plat

Section A.

Date November 30, 1958

Operator SUNRAY MID-CONTINENT OIL CO. Lease NAVAJO  
Well No. 2 Unit Letter A Section 27 Township 28 NORTH Range 17 WEST NMFM  
Located 990 Feet From THE NORTH Line, 990 Feet From THE EAST Line  
County SAN JUAN G. L. Elevation 5284.0 Dedicated Acreage \_\_\_\_\_ Acres  
Name of Producing Formation \_\_\_\_\_ Pool \_\_\_\_\_

1. Is the Operator the only owner\* in the dedicated acreage outlined on the plat below?  
Yes \_\_\_\_\_ No \_\_\_\_\_.
2. If the answer to question one is "no," have the interests of all the owners been consolidated by communitization agreement or otherwise? Yes \_\_\_\_\_ No \_\_\_\_\_. If answer is "yes," Type of Consolidation \_\_\_\_\_
3. If the answer to question two is "no," list all the owners and their respective interests below:

S.J.E. Plat dated 24 Oct. 1958

Owner

Land Description

Section B

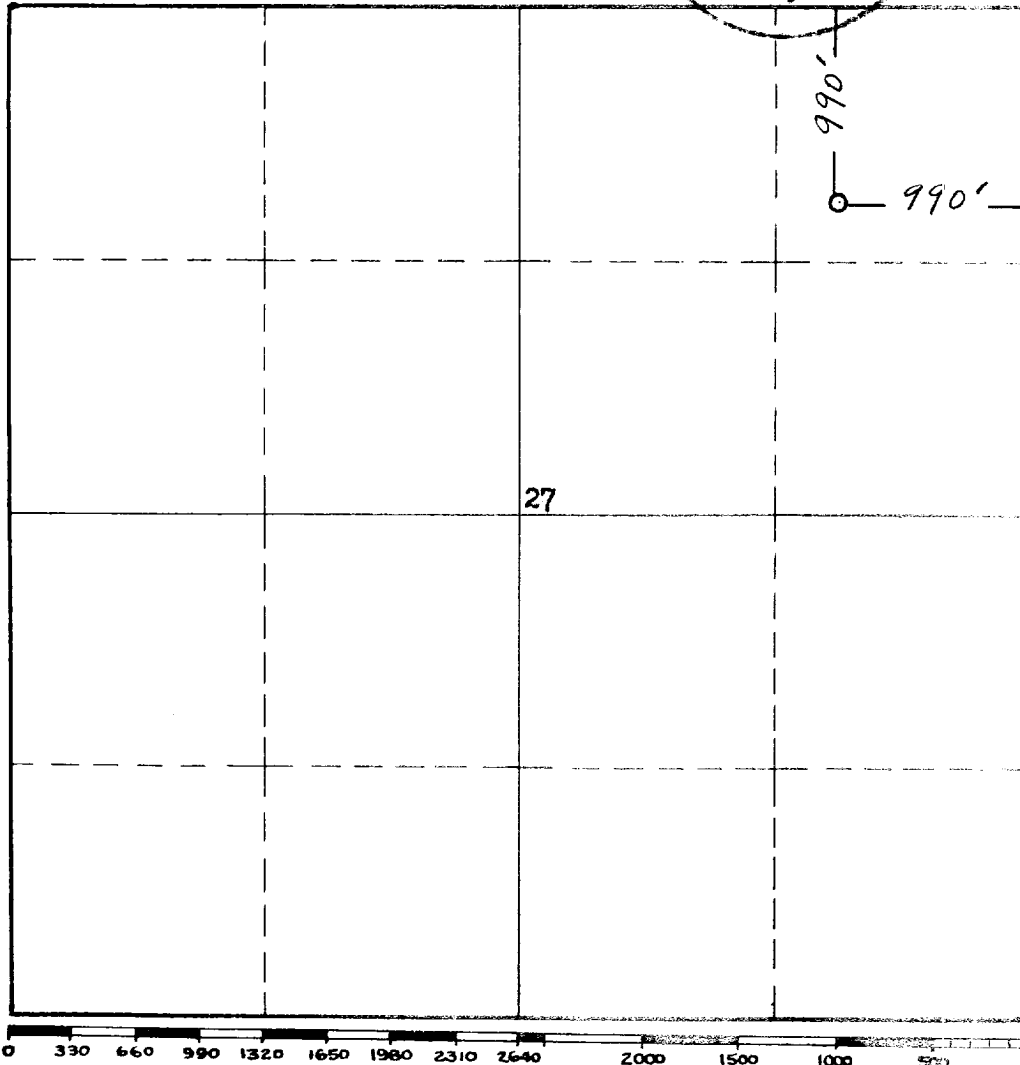

This is to certify that the information in Section A above is true and complete to the best of my knowledge and belief.

Sun Ray Mid-Continent  
(Operator)

[Signature]  
(Representative)

Farmington, New Mexico  
Address

This is to certify that the well location shown on the plat in Section B was plotted from field notes of actual surveys made by me or under my supervision and that the same is true and correct to the best of my knowledge and belief.

Date Surveyed 30 Nov. 1958

[Signature]  
Registered Professional  
Engineer and/or Land Surveyor.

James P. Leese

Certificate No. 1463

(See instructions for completing this form on the reverse side)

INSTRUCTIONS FOR COMPLETION:

1. Operator shall furnish and certify to the information called for in Section A.
2. Operator shall outline the dedicated acreage for both oil and gas wells on the plat in Section B.
3. A registered professional engineer or land surveyor registered in the State of New Mexico or approved by the Commission shall show on the plat the location of the well and certify this information in the space provided.
4. All distances shown on the plat must be from the outer boundaries of Section.
5. If additional space is needed for listing owners and their respective interests as required in question 3, Section A, please use space below

\* "Owner" means the person who has the right to drill into and to produce from any pool and to appropriate the production either for himself or for himself and another. (65-3-29 (e) NMSA 1953 Comp.)