

COPY TO O.G.C.

(SUBMIT IN TRIPLICATE)

UNITED STATES  
DEPARTMENT OF THE INTERIOR  
GEOLOGICAL SURVEYLand Office Santa Fe  
Lease No. 077968  
Unit \_\_\_\_\_  
Holder Lease

## SUNDRY NOTICES AND REPORTS ON WELLS

NOTICE OF INTENTION TO DRILL.....	<input checked="" type="checkbox"/>	SUBSEQUENT REPORT OF WATER SHUT-OFF.....	
NOTICE OF INTENTION TO CHANGE PLANS.....		SUBSEQUENT REPORT OF SHOOTING OR ACIDIZING.....	
NOTICE OF INTENTION TO TEST WATER SHUT-OFF.....		SUBSEQUENT REPORT OF ALTERING CASING.....	
NOTICE OF INTENTION TO RE-DRILL OR REPAIR WELL.....		SUBSEQUENT REPORT OF REDRILLING OR REPAIR.....	
NOTICE OF INTENTION TO SHOOT OR ACIDIZE.....		SUBSEQUENT REPORT OF ABANDONMENT.....	
NOTICE OF INTENTION TO PULL OR ALTER CASING.....		SUPPLEMENTARY WELL HISTORY.....	
NOTICE OF INTENTION TO ABANDON WELL.....			

(INDICATE ABOVE BY CHECK MARK NATURE OF REPORT, NOTICE, OR OTHER DATA)

Drilling Unit: N $\frac{1}{4}$  of Sec. 16 (160 acres)February 24, 19 53Well No. 1 is located 749 ft. from N line and 1650 ft. from E line of sec. 16

<u>N<math>\frac{1}{4}</math> Sec. 16</u> ( $\frac{1}{4}$ Sec. and Sec. No.)	<u>28N</u> (Twp.)	<u>13W</u> (Range)	<u>N.M.P.M.</u> (Meridian)
<u>Wildcat</u> (Field) <u>ANYEN</u>	<u>San Juan</u> (County or Subdivision)	<u>New Mexico</u> (State or Territory)	
<u>(West Kutz Area)</u>			

The elevation of the derrick floor above sea level is 6058 ft. (K.B.)

## DETAILS OF WORK

(State names of and expected depths to objective sands; show sizes, weights, and lengths of proposed casings; indicate mudding jobs, cementing points, and all other important proposed work)

Pictured Cliffs test. Estimated depth 1800'.

Surface Casing: 90' of 10-3/4" 32.7# casing cemented to surface with 75 sacks cement.

Production Casing: 7" 20# casing and 6-5/8" LW line pipe cemented with 100 sacks.

If commercial production is indicated the producing section will be shot with nitroglycerin.

I understand that this plan of work must receive approval in writing by the Geological Survey before operations may be commenced.

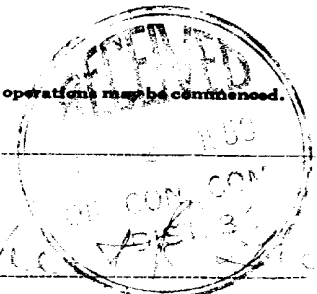
Company Benson-Montin Drilling Co.Address 315 $\frac{1}{2}$  West Main  
Farmington, New MexicoBy [Signature]  
Title Field Superintendent

1. The first part of the document is a list of names and addresses. The names are written in a cursive script, and the addresses are written in a more formal, printed script. The list is organized into two columns, with names on the left and addresses on the right.

2. The second part of the document is a list of names and addresses. The names are written in a cursive script, and the addresses are written in a more formal, printed script. The list is organized into two columns, with names on the left and addresses on the right.

3. The third part of the document is a list of names and addresses. The names are written in a cursive script, and the addresses are written in a more formal, printed script. The list is organized into two columns, with names on the left and addresses on the right.

4. The fourth part of the document is a list of names and addresses. The names are written in a cursive script, and the addresses are written in a more formal, printed script. The list is organized into two columns, with names on the left and addresses on the right.

5. The fifth part of the document is a list of names and addresses. The names are written in a cursive script, and the addresses are written in a more formal, printed script. The list is organized into two columns, with names on the left and addresses on the right.

RECEIVED  
FEB 1953  
U.S. GEOLOGICAL SURVEY

COMPANY - Crow, Benson & Martin  
LEASE - Holder Well No. 1  
Sec 16 T28N R13W N.M.P.M.  
LOCATION - 749' from north line and  
1650' from east line  
SAN JUAN COUNTY New Mexico

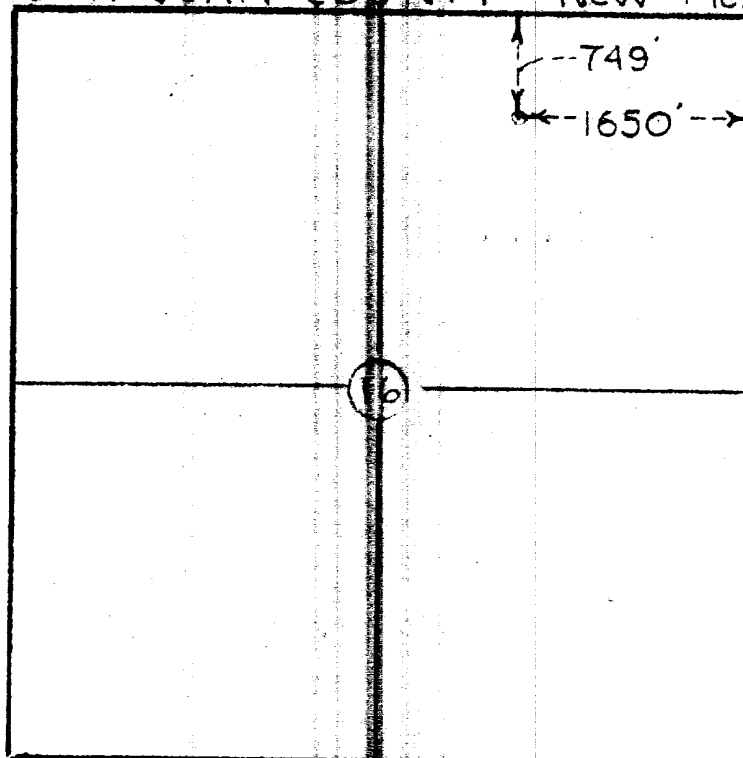

This is to certify that the above plat was prepared from field notes of actual surveys made by me and that the same are true and correct to the best of my knowledge and belief.

RECEIVED  
MAR 2 1953  
OIL COM. BUREAU  
DIST. 1

Surveyed 2-15-53

Robert L. Maddox Jr.  
Registered Professional Engineer  
and Land Surveyor  
N. Mex. Reg. No. 1426

