

NEW MEXICO OIL CONSERVATION COMMISSION
Santa Fe, New Mexico

Form C-101
Revised (12/1/55)

30-045-07852

NOTICE OF INTENTION TO DRILL

Notice must be given to the District Office of the Oil Conservation Commission and approval obtained before drilling or recompletion begins. If changes in the proposed plan are considered advisable, a copy of this notice showing such changes will be returned to the sender. Submit this notice in **QUINTUPPLICATE**. One copy will be returned following approval. See additional instructions in Rules and Regulations of the Commission. If State Land submit 6 Copies Attach Form C-128 in triplicate to first 3 copies of form C-101

Farmington, New Mexico
(Place)

February 15, 1962
(Date)

OIL CONSERVATION COMMISSION
SANTA FE, NEW MEXICO

Gentlemen:

You are hereby notified that it is our intention to commence the Drilling of a well to be known as

H.A. Flader Land Company

(Company, or Operator)

Crawford

(Lease)

, Well No. 1

, in E (Unit)

The well is

located 2125 feet from the North line line and 1010 feet from the

West Line line of Section 30, T. 29 North, R. 11 West, NMPM.

(GIVE LOCATION FROM SECTION LINE) Wildcat Pool, San Juan County

If State Land the Oil and Gas Lease is No.

If patented land the owner is Faye Crawford

Address Bloomfield, New Mexico

We propose to drill well with drilling equipment as follows: Rotary Tools

The status of plugging bond is Attached - To be filed with N.M. Oil
Conservation Commission, Santa Fe, New Mexico

Drilling Contractor Core Drilling, Inc.

We intend to complete this well in the Farmington ss. str.
formation at an approximate depth of 800 feet.

CASING PROGRAM

We propose to use the following strings of Casing and to cement them as indicated:

| Size of Hole | Size of Casing | Weight per Foot | New or Second Hand | Depth | Sacks Cement |
|--------------|----------------|-----------------|--------------------|-------|----------------|
| 8 3/4" | 7" | 20# | Used | 100' | 25 - Circulate |
| 6 1/8" | 4 1/2" | 9.5# | New | 300' | 75 |
| | 1" Tubing | | Used | 500' | |

If changes in the above plans become advisable we will notify you immediately.

ADDITIONAL INFORMATION (If recompletion give full details of proposed plan of work.)

Subject to approval of Non-standard Unit

Approved 2-16-62, 1962
Except as follows:

OIL CONSERVATION COMMISSION

By A.R. Hendrick

Sincerely yours,

H.A. Flader Land Company
(Company or Operator)

By Kenneth E. Harlan

Position K.E. Harlan Agent

Send Communications regarding well to

Name 2323 E. 11th St.
Address Farmington,



NEW MEXICO OIL CONSERVATION COMMISSION

Well Location and Acreage Dedication Plat

Section A.

Date February 15, 1962

Operator H. A. FLADER LAND COMPANY Lease CRAWFORD
 Well No. 1 Unit Letter E Section 30 Township 29 NORTH Range 11 WEST NMPM
 Located 2125 Feet From the NORTH Line 1010 Feet From the WEST Line
 County SAN JUAN G. L. Elevation 5465.5 Dedicated Acreage 160 ± Acres
 Name of Producing Formation Farmington ss. Pool Wildcat

1. Is the Operator the only owner in the dedicated acreage outlined on the plat below?
 Yes XX No _____
2. If the answer to question one is "no", have the interests of all the owners been consolidated by communitization agreement or otherwise? Yes _____ No _____. If answer is "yes", Type of Consolidation.
3. If the answer to question two is "no", list all the owners and their respective interests below:

Owner

Land Description

Section B.

This is to certify that the information in Section A above is true and complete to the best of my knowledge and belief.

H.A. Flader Land Company

(Operator)

K.E. Harlan
(Representative)

2325 East 11th. St.,

(Address)

Farmington, New Mexico

Note: All distances must be from outer boundaries of section.

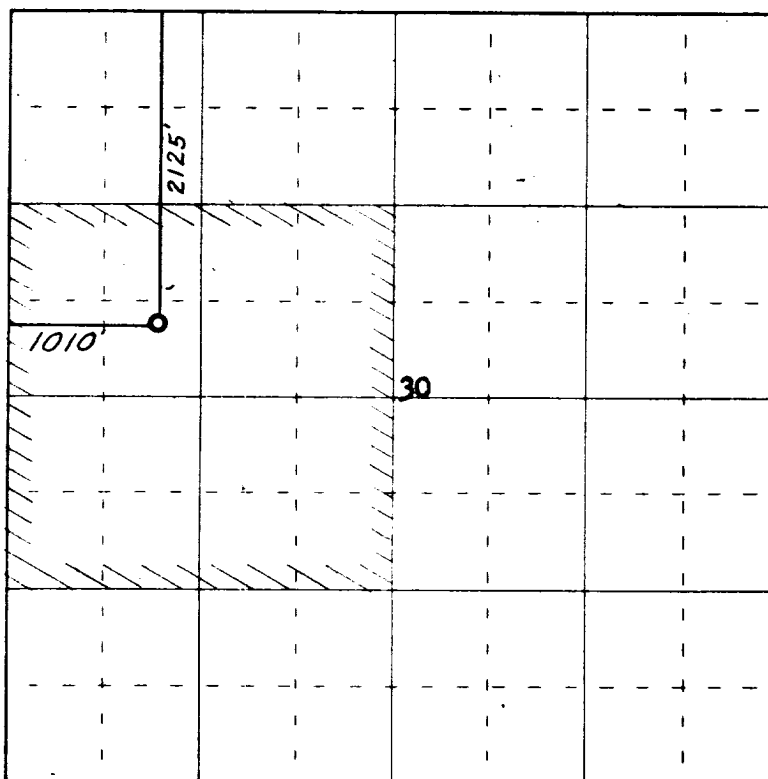

0 330 660 990 1320 1650 1980 2310 2640 2000 1500 1000 500 0

Scale 4 inches equal 1 mile

Ref: GLO plat dated 3 September 1878

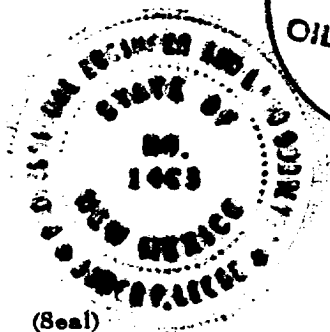

(Seal)

This is to certify that the above plat was prepared from field notes of actual surveys made by me or under my supervision and that the same are true and correct to the best of my knowledge and belief.

Date Surveyed February 8, 1962

James P. Lease
 Registered Professional Engineer and/or Land Surveyor
 James P. Lease N. Mex. Reg. No. 1463

Farmington, New Mexico