

(SUBMIT IN TRIPLICATE)  
UNITED STATES  
DEPARTMENT OF THE INTERIOR  
GEOLOGICAL SURVEY

Land Office Santa Fe  
Lease No. Part of 079511  
Unit Northeast Blanco

SUNDRY NOTICES AND REPORTS ON WELLS

NOTICE OF INTENTION TO DRILL.....	<input checked="" type="checkbox"/>	SUBSEQUENT REPORT OF WATER SHUT-OFF.....	
NOTICE OF INTENTION TO CHANGE PLANS.....		SUBSEQUENT REPORT OF SHOOTING OR ACIDIZING.....	
NOTICE OF INTENTION TO TEST WATER SHUT-OFF.....		SUBSEQUENT REPORT OF ALTERING CASING.....	
NOTICE OF INTENTION TO RE-DRILL OR REPAIR WELL.....		SUBSEQUENT REPORT OF REDRILLING OR REPAIR.....	
NOTICE OF INTENTION TO SHOOT OR ACIDIZE.....		SUBSEQUENT REPORT OF ABANDONMENT.....	
NOTICE OF INTENTION TO PULL OR ALTER CASING.....		SUPPLEMENTARY WELL HISTORY.....	
NOTICE OF INTENTION TO ABANDON WELL.....			

(INDICATE ABOVE BY CHECK MARK NATURE OF REPORT, NOTICE, OR OTHER DATA)

October 7, 1952

Well No. 5-13 is located 1100 ft. from N line and 1100 ft. from W line of sec. 13

SW/4 Section 13 30 N 8 W New Mexico Principal  
(1/4 Sec. and Sec. No.) (Twp.) (Range) (Meridian)  
N.E. Blanco Unit San Juan New Mexico  
(Field) (County or Subdivision) (State or Territory)

The elevation of the derrick floor above sea level is \_\_\_\_\_ ft. Will report when run

DETAILS OF WORK

(State names of and expected depths to objective sands; show sizes, weights, and lengths of proposed casings; indicate mudding jobs, cementing points, and all other important proposed work)

Set approximately 300' of 10-3/4" 32.75# surface casing and circulate cement.  
Set approximately 800' 7" 23# and 4000' 7" 20# production string and cement with 200 or more sacks of cement if necessary.  
Drill to Total Depth of approximately 5800' to test the Mesaverde.

I understand that this plan of work must receive approval in writing by the Geological Survey before operations may be commenced.

Company BLACKWOOD & NICHOLS COMPANY  
Address 1313 Liberty Bank Building  
Oklahoma City 2, Oklahoma  
By W. H. Little  
Title Superintendent

Company Blackwood & Nichols Company

Lease \_\_\_\_\_ Well No. \_\_\_\_\_

Sec. 13 T. 30 N, R. 8 W N.M.P.M.

Location 990' from the South line and 990' from the West line.

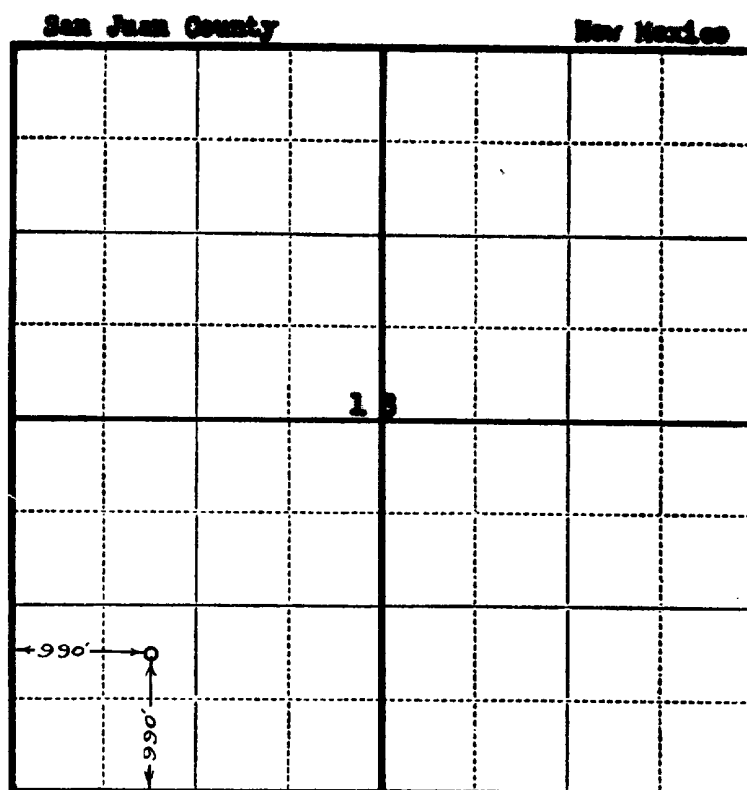

Scale—4 inches equals 1 mile.

This is to certify that the above plat was prepared from field notes of actual surveys made by me or under my supervision and that the same are true and correct to the best of my knowledge and belief.

Seal:

*Charles J. Finklee*  
Registered Professional  
Engineer and Land Surveyor.

**Charles J. Finklee**  
**N. Mex. Reg. No. 1302**

Surveyed September 26, 19 52