

UNITED STATES
DEPARTMENT OF THE INTERIOR
GEOLOGICAL SURVEY

30-045-21500

APPLICATION FOR PERMIT TO DRILL, DEEPEN, OR PLUG BACK

1a. TYPE OF WORK DRILL <input checked="" type="checkbox"/> DEEPEN <input type="checkbox"/> PLUG BACK <input type="checkbox"/>			5. LEASE DESIGNATION AND SERIAL NO. SF 078385A	
b. TYPE OF WELL OIL WELL <input type="checkbox"/> GAS WELL <input checked="" type="checkbox"/> OTHER <input type="checkbox"/> SINGLE ZONE <input type="checkbox"/> MULTIPLE ZONE <input type="checkbox"/>			6. IF INDIAN, ALLOTTEE OR TRIBE NAME	
2. NAME OF OPERATOR Lively Exploration Company			7. UNIT AGREEMENT NAME	
3. ADDRESS OF OPERATOR Box 234, Farmington, New Mexico 87401			8. FARM OR LEASE NAME Lively	
4. LOCATION OF WELL (Report location clearly and in accordance with any State requirements.)* At surface 1700' FSL - 1670' FWL At proposed prod. zone			9. WELL NO. 24	
14. DISTANCE IN MILES AND DIRECTION FROM NEAREST TOWN OR POST OFFICE* 14 miles east of Blanco, New Mexico			10. FIELD AND POOL, OR WILDCAT Wildcat	
15. DISTANCE FROM PROPOSED* LOCATION TO NEAREST PROPERTY OR LEASE LINE, FT. (Also to nearest drlg. unit line, if any) 1670'			11. SEC., T., R., M., OR BLK. AND SURVEY OR AREA Sec. 35, T30N, R8W	
16. NO. OF ACRES IN LEASE			12. COUNTY OR PARISH San Juan	
17. NO. OF ACRES ASSIGNED TO THIS WELL 160			13. STATE NM	
18. DISTANCE FROM PROPOSED LOCATION* TO NEAREST WELL, DRILLING, COMPLETED, OR APPLIED FOR, ON THIS LEASE, FT. 500' approx			19. PROPOSED DEPTH 3050'	
20. ROTARY OR CABLE TOOLS Rotary			21. APPROX. DATE WORK WILL START* 6-1-74	
22. ELEVATIONS (Show whether DF, RT, GR, etc.) 6027' GR			23. PROPOSED CASING AND CEMENTING PROGRAM	

SIZE OF HOLE	SIZE OF CASING	WEIGHT PER FOOT	SETTING DEPTH	QUANTITY OF CEMENT
12-1/4"	8-5/8"	24#	200'	175 sx
7-7/8"	4-1/2"	10.5#	3050'	650 sx

Plan to drill well with water thru Pictured Cliffs formation. The well will probably be kicking and flowing gas and water so open hole log will not be run. Plan to strip 4-1/2" casing to TD, cement casing with sufficient cement volume to control water flow, run logs thru casing, selectively perforate and stimulate Fruitland formation. Run 1-1/4" tubing and complete well.

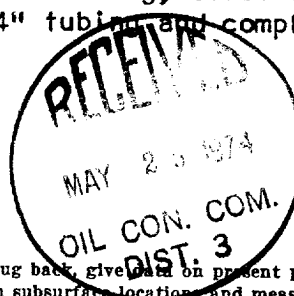

IN ABOVE SPACE DESCRIBE PROPOSED PROGRAM: If proposal is to deepen or plug back, give data on present productive zone and proposed new productive zone. If proposal is to drill or deepen directionally, give pertinent data on subsurface locations and measured and true vertical depths. Give blowout preventer program, if any.

24. SIGNED Original signed by T. A. Dugan
Thomas A. Dugan TITLE Engineer DATE 5-23-74
(This space for Federal or State office use)

PERMIT NO. APPROVAL DATE
APPROVED BY TITLE
CONDITIONS OF APPROVAL, IF ANY:

*See Instructions On Reverse Side

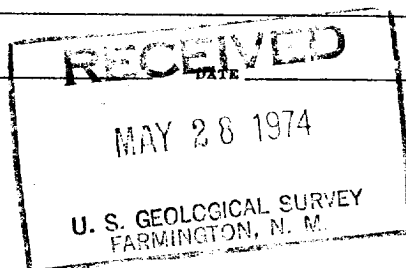

NEW MEXICO OIL CONSERVATION COMMISSION
WELL LOCATION AND ACREAGE DEDICATION PLAT

Form C-102
Supersedes C-128
Effective 1-1-65

All distances must be from the outer boundaries of the Section.

Operator Lively Exploration Company			Lease Lively		Well No. 24
Unit Letter K	Section 35	Township 30 North	Range 8 West	County San Juan	
Actual Footage Location of Well: 1700 feet from the South line and 1670 feet from the West line					
Ground Level Elev. 6027	Producing Formation Fruitland		Pool Wildcat		Dedicated Acreage: 160 Acres

1. Outline the acreage dedicated to the subject well by colored pencil or hachure marks on the plat below.
2. If more than one lease is dedicated to the well, outline each and identify the ownership thereof (both as to working interest and royalty).
3. If more than one lease of different ownership is dedicated to the well, have the interests of all owners been consolidated by communitization, unitization, force-pooling, etc?

☐ Yes ☐ No If answer is "yes," type of consolidation _____

If answer is "no," list the owners and tract descriptions which have actually been consolidated. (Use reverse side of this form if necessary.) _____

No allowable will be assigned to the well until all interests have been consolidated (by communitization, unitization, forced-pooling, or otherwise) or until a non-standard unit, eliminating such interests, has been approved by the Commission.

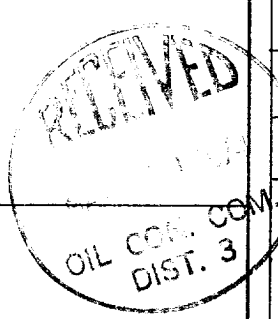
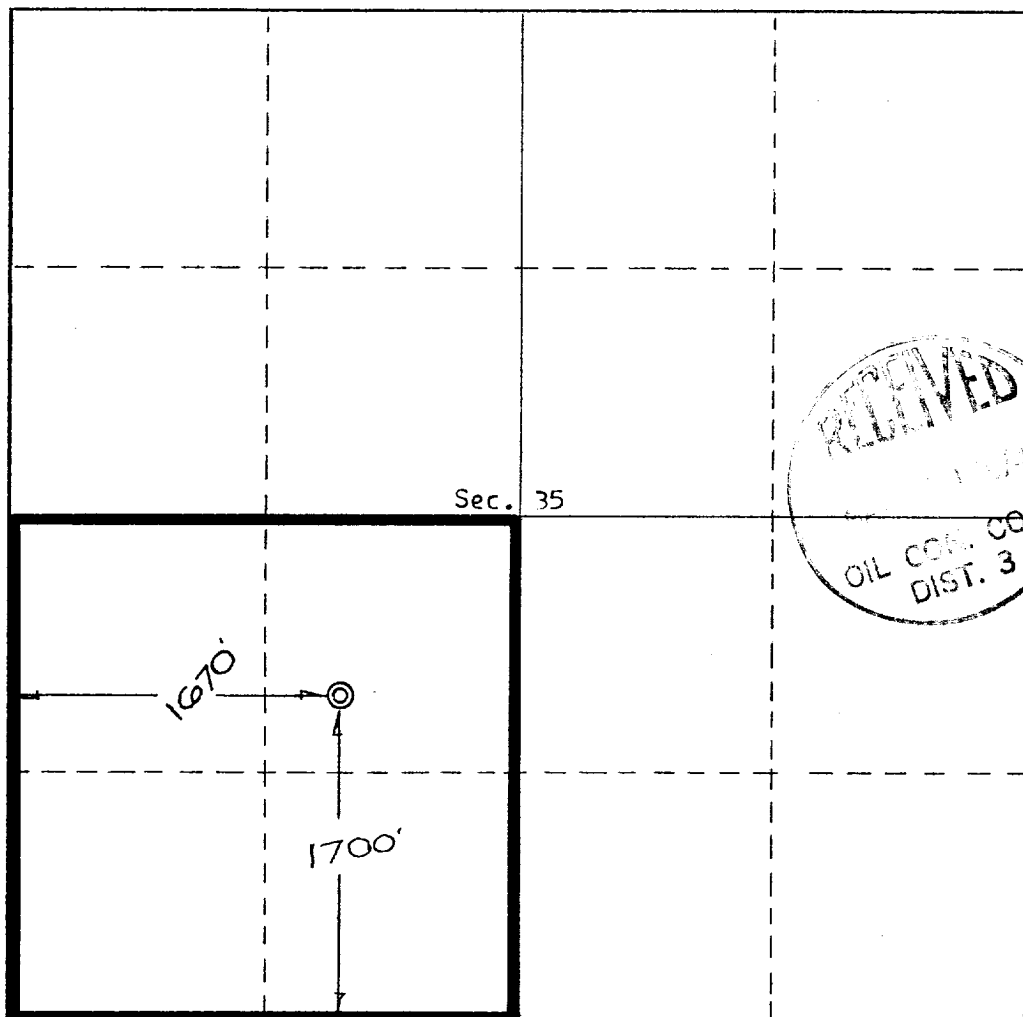

CERTIFICATION

I hereby certify that the information contained herein is true and complete to the best of my knowledge and belief.

Original signed by **T. A. Dugan**

Name Thomas A. Dugan
Position Engineer
Company Lively Exploration Co.
Date 5-23-74

I hereby certify that the well location shown on this plat was plotted from field notes of actual surveys made by me or under my supervision, and that the same is true and correct to the best of my knowledge and belief.

Date Surveyed May 1, 1974
Registered Professional Engineer and/or Land Surveyor E.V. Echohawk
Certificate No. 3602 E.V. Echohawk LS