

(SUBMIT IN TRIPLICATE)

 UNITED STATES
 DEPARTMENT OF THE INTERIOR
 GEOLOGICAL SURVEY

 Land Office Santa Fe
 Lease No. 075301
 Unit J

Section 1

SUNDRY NOTICES AND REPORTS ON WELLS

NOTICE OF INTENTION TO DRILL	<input checked="" type="checkbox"/>	SUBSEQUENT REPORT OF WATER SHUT-OFF	
NOTICE OF INTENTION TO CHANGE PLANS		SUBSEQUENT REPORT OF SHOOTING OR ACIDIZING	
NOTICE OF INTENTION TO TEST WATER SHUT-OFF		SUBSEQUENT REPORT OF ALTERING CASING	
NOTICE OF INTENTION TO RE-DRILL OR REPAIR WELL		SUBSEQUENT REPORT OF RE-DRILLING OR REPAIR	
NOTICE OF INTENTION TO SHOOT OR ACIDIZE		SUBSEQUENT REPORT OF ABANDONMENT	
NOTICE OF INTENTION TO PULL OR ALTER CASING		SUPPLEMENTARY WELL HISTORY	
NOTICE OF INTENTION TO ABANDON WELL			

(INDICATE ABOVE BY CHECK MARK NATURE OF REPORT, NOTICE, OR OTHER DATA)

9/26, 19 59

Federal 9-1
 Well No. 9 is located 1980 ft. from S line and 1980 ft. from E line of sec. 1
N4, NE, Sec 1 24 N 10 W N40W
 (1/4 Sec. and Sec. No.) (Twp.) (Range) (Meridian)
Bisti-Lower Gallup San Juan New Mexico
 (Field) (County or Subdivision) (State or Territory)

The elevation of the derrick floor above sea level is _____ ft. Will report later

DETAILS OF WORK

(State names of and expected depths to objective sands; show sizes, weights, and lengths of proposed casings; indicate mudding jobs, cementing points, and all other important proposed work)

Notice is hereby given of intention to drill the Federal 9-1 #5. A string of 5-5/8" casing ~~will~~ will be set at approximately 100' and cement will be circulated to surface. After 24 hours the pipe will be tested for leaks with 1000 psi water pressure. A 7-7/8" hole will then be drilled to a TD of approximately 5550', and 5 1/2" csg will be set at that point. After 30 hours the casing will be tested for leaks, and the rotary rig will be released. The casing will be perforated in the Lower Gallup sands and the well will be completed in that interval.

N-80

I understand that this plan of work must receive approval in writing by the Geological Survey before operations may be commenced.

Company Standard Oil Company of Texas
 Address Box 1501
Parasington, New Mexico
 By Charles H. Toney
 Title Field Foreman

NEW MEXICO OIL CONSERVATION COMMISSION
WELL LOCATION AND ACREAGE DEDICATION PLAT

FORM C-128
Revised 5/1/57

SEE INSTRUCTIONS FOR COMPLETING THIS FORM ON THE REVERSE SIDE

SECTION A

Operator STANDARD OIL COMPANY OF TEXAS		Lease FEDERAL 9 - 1 (073301)		Well No. 5
Unit Letter J	Section 1	Township 24 NORTH	Range 10 WEST	County SAN JUAN

Actual Footage Location of Well:
1980 feet from the **SOUTH** line and **1980** feet from the **EAST** line

Ground Level Elev.	Producing Formation	Pool	Dedicated Acreage:
Will rept. later	Lower Gallup	Bisti-Lower Gallup	80 Acres

Ref: GLO plat dated 21 October 1982

1. Is the Operator the only owner in the dedicated acreage outlined on the plat below? YES ☐ NO ☒ . ("Owner" means the person who has the right to drill into and to produce from any pool and to appropriate the production either for himself or for himself and another. (65-3-29 (e) NMSA 1935 Comp.)
2. If the answer to question one is "no," have the interests of all the owners been consolidated by communitization agreement or otherwise? YES ☒ NO ☐ . If answer is "yes," Type of Consolidation Designated Operator
3. If the answer to question two is "no," list all the owners and their respective interests below:

Owner	Land Description

SECTION B

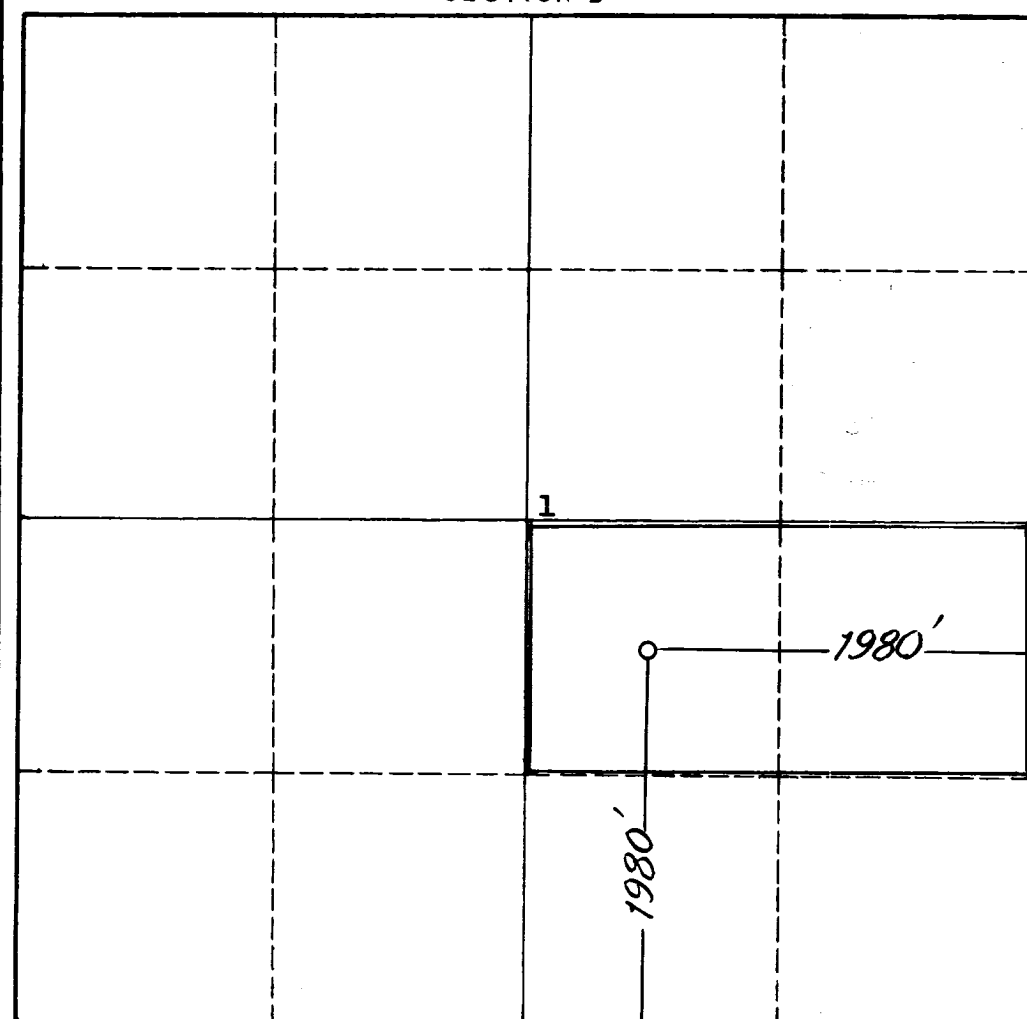

CERTIFICATION

I hereby certify that the information in SECTION A above is true and complete to the best of my knowledge and belief.

Name	<i>Charles H. Lantry</i>
Position	Field Foreman
Company	Standard Oil Co. of Texas
Date	9/16/59

I hereby certify that the well location shown on the plat in SECTION B was plotted from field notes of actual surveys made by me or under my supervision, and that the same is true and correct to the best of my knowledge and belief.

Date Surveyed	15 September 1959
Registered Professional Engineer and/or Land Surveyor	<i>James P. Leese</i> James P. Leese
Certificate No.	1463

0 330 660 990 1320 1650 1980 2310 2640 2000 1500 1000 500 0

INSTRUCTIONS FOR COMPLETION OF FORM C-128

1. Operator shall furnish and certify to the information called for in Section A.
2. Operator shall outline the dedicated acreage for *both* oil and gas wells on the plat in Section B.
3. A registered professional engineer or land surveyor registered in the State of New Mexico or approved by the Commission shall show on the plat the location of the well and certify this information in the space provided.
4. All distances shown on the plat must be from the outer boundaries of the Section.
5. If additional space is needed for listing owners and their respective interests as required in question 3 of Section A, please use space below.