

(SUBMIT IN TRIPLICATE)

UNITED STATES
DEPARTMENT OF THE INTERIOR
GEOLOGICAL SURVEY

Land Office Santa Fe
Lease No. 078390
Unit Price

SUNDRY NOTICES AND REPORTS ON WELLS

NOTICE OF INTENTION TO DRILL	<input checked="" type="checkbox"/>	SUBSEQUENT REPORT OF WATER SHUT-OFF	
NOTICE OF INTENTION TO CHANGE PLANS		SUBSEQUENT REPORT OF SHOOTING OR ACIDIZING	
NOTICE OF INTENTION TO TEST WATER SHUT-OFF		SUBSEQUENT REPORT OF ALTERING CASING	
NOTICE OF INTENTION TO RE-DRILL OR REPAIR WELL		SUBSEQUENT REPORT OF RE-DRILLING OR REPAIR	
NOTICE OF INTENTION TO SHOOT OR ACIDIZE		SUBSEQUENT REPORT OF ABANDONMENT	
NOTICE OF INTENTION TO PULL OR ALTER CASING		SUPPLEMENTARY WELL HISTORY	
NOTICE OF INTENTION TO ABANDON WELL			

(INDICATE ABOVE BY CHECK MARK NATURE OF REPORT, NOTICE, OR OTHER DATA)

September 10, 19 62

Well No. 1-15 is located ¹⁷³⁰~~1200~~ ft. from [N] line and ¹⁸⁵⁰~~1200~~ ft. from [E] line of sec. 15

NE/4 Sec. 15

(¼ Sec. and Sec. No.)

28N

(Twp.)

SW

(Range)

N.M.P.M.

(Meridian)

Basin Dakota

(Field)

Santa Juan

(County or Subdivision)

New Mexico

(State or Territory)

The elevation of the derrick floor above sea level is 5891 ft.

DETAILS OF WORK

(State names of and expected depths to objective sands; show sizes, weights, and lengths of proposed casings; indicate mudding jobs, cementing points, and all other important proposed work)

It is intended to drill a well with rotary tools thru the Dakota Formation. Mud circulation will be used thru 100' of Lewis and set 7-5/8" intermediate casing. Gas circulation will be used thru the Dakota and set 4-1/2" casing. Possible productive Dakota intervals will be perforated and fractured. Estimated Total Depth 6980'

Casing Program:

10-3/4" Surface @ 175' w/150 sks cement to surface

7-5/8" @ 2650' w/200 sks cement

4-1/2" @ 6980' w/100 sks 40% Diacel "D" followed by 50
2% gel cement.

The W/2 of Sec. 15 is dedicated to this well.

I understand that this plan of work must receive approval in writing by the Geological Survey before operations may be commenced.

Company DELMY-TAYLOR OIL CORPORATIONAddress P. O. Box 2096Farmington, New MexicoOriginal signed
by E. W. GwynnBy E. W. Gwynn
Title District Engineer

NEW MEXICO OIL CONSERVATION COMMISSION

Well Location and Acreage Dedication Plat

Section A.

Date 9/15/62

Operator DELHI TAYLOR OIL CORPORATION Lease PRICE SF 078390
 Well No. 1 - 15 Unit Letter G Section 15 Township 28 NORTH Range 8 WEST NMPM
 Located 1730 Feet From the NORTH Line, 1850 Feet From the EAST Line
 County SAN JUAN G. L. Elevation 5870.0 Dedicated Acreage 340 Acres
 Name of Producing Formation Dakota Pool Basin Dakota

1. Is the Operator the only owner in the dedicated acreage outlined on the plat below?
 Yes XXXX No _____
2. If the answer to question one is "no", have the interests of all the owners been consolidated by communitization agreement or otherwise? Yes _____ No _____. If answer is "yes", Type of Consolidation.
3. If the answer to question two is "no", list all the owners and their respective interests below:

Owner

Land Description

RECEIVED

SEP 17 1962

Section B.

This is to certify that the information in Section A above is true and complete to the best of my knowledge and belief.

Delhi-Taylor Oil Corporation

(Operator)

E. W. Gwynn

(Representative)

E. W. Gwynn

(Address)

P. O. Drawer 1198

Farmington, New Mexico

Ref: GLO plat dated 23 June 1919

Note: All distances must be from outer boundaries of section.

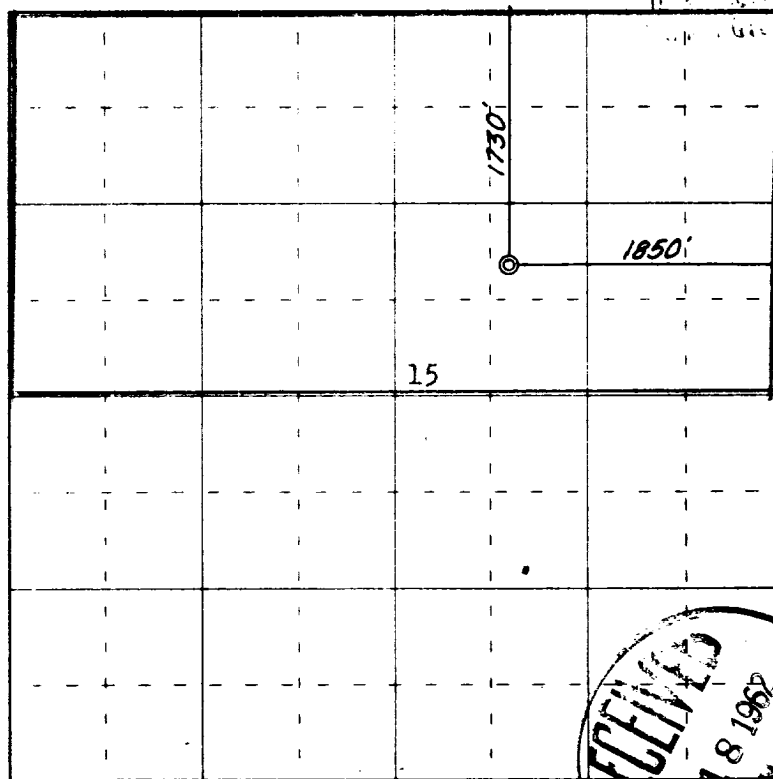

0 330 660 990 1320 1650 1980 2310 2640 2000 1500 1000 500

Scale 4 inches equal 1 mile



This is to certify that the above plat was prepared from field notes of actual surveys made by me or under my supervision and that the same are true and correct to the best of my knowledge and belief.

Date Surveyed 13 September 1962

James P. Leese
 Registered Professional Engineer and/or Land Surveyor
 James P. Leese, N. Mex. Reg. No. 1463

(Seal)

Farmington, New Mexico