

(SUBMIT IN TRIPLICATE)

Land Office Santa Fe
Lease No. 078414
Unit Day

UNITED STATES
DEPARTMENT OF THE INTERIOR
GEOLOGICAL SURVEY

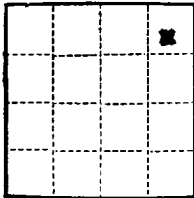

SUNDRY NOTICES AND REPORTS ON WELLS

NOTICE OF INTENTION TO DRILL.....	<input checked="" type="checkbox"/>	SUBSEQUENT REPORT OF WATER SHUT-OFF.....	
NOTICE OF INTENTION TO CHANGE PLANS.....		SUBSEQUENT REPORT OF SHOOTING OR ACIDIZING.....	
NOTICE OF INTENTION TO TEST WATER SHUT-OFF.....		SUBSEQUENT REPORT OF ALTERING CASING.....	
NOTICE OF INTENTION TO RE-DRILL OR REPAIR WELL.....		SUBSEQUENT REPORT OF RE-DRILLING OR REPAIR.....	
NOTICE OF INTENTION TO SHOOT OR ACIDIZE.....		SUBSEQUENT REPORT OF ABANDONMENT.....	
NOTICE OF INTENTION TO PULL OR ALTER CASING.....		SUPPLEMENTARY WELL HISTORY.....	
NOTICE OF INTENTION TO ABANDON WELL.....			

(INDICATE ABOVE BY CHECK MARK NATURE OF REPORT, NOTICE, OR OTHER DATA)

September 10, 1962

Well No. 1-17 is located ¹¹⁷⁰~~1150~~ ft. from {N} line and ¹⁰¹⁰~~1150~~ ft. from {E} line of sec. 17

NE/4 Sec 17 (1/4 Sec. and Sec. No.) 29N (Twp.) SW (Range) 1010 (Meridian)
Basin Dakota (Field) San Juan (County or Subdivision) New Mexico (State or Territory)

The elevation of the derrick floor above sea level is 6459 ft.

DETAILS OF WORK

(State names of and expected depths to objective sands; show sizes, weights, and lengths of proposed casings; indicate mudding jobs, cementing points, and all other important proposed work)

It is intended to drill a well with rotary tools thru the Dakota formation. Mud circulation will be used thru 100' of Lewis and set 7-5/8" intermediate casing. Gas circulation will be used thru the Dakota and set 4-1/2" casing. Possible productive Dakota intervals will be perforated and fractured. Estimated Total Depth 7680'

Casing Program:

- 10-3/4" Surface @ 175' w/150 lbs cement to surface
- 7-5/8" @ 3300' w/200 lbs cement
- 4-1/2" @ 7680' w/100 lbs 40% Dical "D" followed by 2% gel cement.

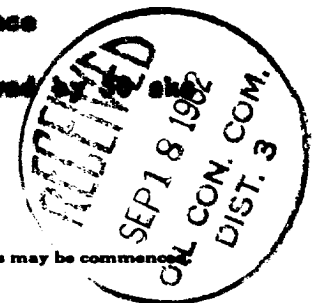

The E/2 of Sec. 17 is dedicated to this well.

I understand that this plan of work must receive approval in writing by the Geological Survey before operations may be commenced.

Company DEHL-TAYLOR OIL CORPORATION

Address ¹¹⁹⁸P. O. Box 2096

Farmington, New Mexico

Original signed
by E. W. Guyan
By E. W. Guyan
Title District Engineer

NEW MEXICO OIL CONSERVATION COMMISSION

Well Location and Acreage Dedication Plat

Section A.

Date (9/16/62)

Operator DELHI TAYLOR OIL CORPORATION Lease DAY SF 078.14
 Well No. 1 - 17 Unit Letter A Section 17 Township 29 NORTH Range 8 WEST, NMPM
 Located 1170 Feet From the NORTH Line, 1010 Feet From the EAST Line
 County SAN JUAN G. L. Elevation 6443.3 Dedicated Acreage 320 Acres
 Name of Producing Formation Dakota Pool Basin Dakota

1. Is the Operator the only owner in the dedicated acreage outlined on the plat below?
 Yes XXX No _____
2. If the answer to question one is "no", have the interests of all the owners been consolidated by communitization agreement or otherwise? Yes _____ No _____. If answer is "yes", Type of Consolidation.
3. If the answer to question two is "no", list all the owners and their respective interests below:

Owner	Land Description

RECEIVED

SEP 17 1962

U S GEOLOGICAL SURVEY
NEW MEXICO

Section B.

Note: All distances must be from outer boundaries of section.

This is to certify that the information in Section A above is true and complete to the best of my knowledge and belief.

Delhi-Taylor Oil Corporation

E. W. Gayan
(Operator)
(Representative)

E. W. Gayan
(Address)
P. O. Box 1188
Farmington, New Mexico

Ref: GLO plat dated 23 June 1919

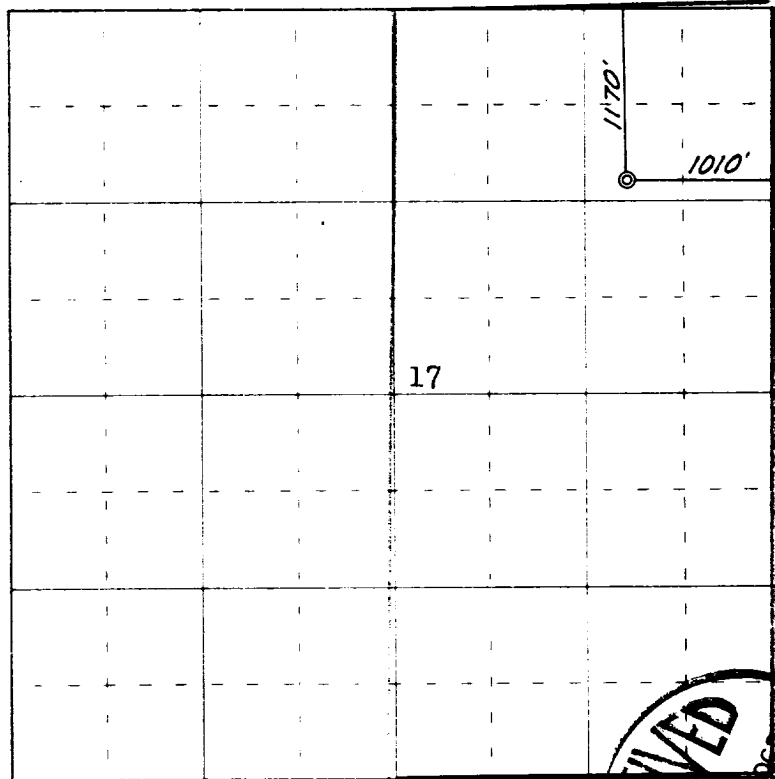

0 330 660 990 1320 1650 1980 2310 2640 2000 1500 1000 500

Scale 4 inches equal 1 mile

RECEIVED
SEPT 18 1962
OIL CON. COM.
DIST. 3



This is to certify that the above plat was prepared from field notes of actual surveys made by me or under my supervision and that the same are true and correct to the best of my knowledge and belief.

(Seal)

Date Signed 13 September 1962

P. Leese
Registered Professional Engineer and/or Land Surveyor
P. Leese, N. Mex. Reg. No. 1463

Farmington, New Mexico