

(SUBMIT IN TRIPPLICATE)

UNITED STATES  
DEPARTMENT OF THE INTERIOR  
GEOLOGICAL SURVEY

Land Office **Santa Fe**  
Lease No. **078049**  
Unit **Hughes**

SUNDRY NOTICES AND REPORTS ON WELLS

NOTICE OF INTENTION TO DRILL	<input checked="" type="checkbox"/>	SUBSEQUENT REPORT OF WATER SHUT-OFF	
NOTICE OF INTENTION TO CHANGE PLANS		SUBSEQUENT REPORT OF SHOOTING OR ACIDIZING	
NOTICE OF INTENTION TO TEST WATER SHUT-OFF		SUBSEQUENT REPORT OF ALTERING CASING	
NOTICE OF INTENTION TO RE-DRILL OR REPAIR WELL		SUBSEQUENT REPORT OF RE-DRILLING OR REPAIR	
NOTICE OF INTENTION TO SHOOT OR ACIDIZE		SUBSEQUENT REPORT OF ABANDONMENT	
NOTICE OF INTENTION TO PULL OR ALTER CASING		SUPPLEMENTARY WELL HISTORY	
NOTICE OF INTENTION TO ABANDON WELL			

(INDICATE ABOVE BY CHECK MARK NATURE OF REPORT, NOTICE, OR OTHER DATA)

September 10, 1962

Well No. 1-33 is located <sup>1470</sup>~~1250~~ ft. from S line and <sup>1716</sup>~~2000~~ ft. from W line of sec. 33  
SW/4 Sec. 33 29N 8W N.M.P.M.  
(1/4 Sec. and Sec. No.) (Twp.) (Range) (Meridian)  
Basin Dakota San Juan New Mexico  
(Field) (County or Subdivision) (State or Territory)

The elevation of the derrick floor above sea level is 6376 ft.

DETAILS OF WORK

(State names of and expected depths to objective sands; show sizes, weights, and lengths of proposed casings; indicate mudding jobs, cementing points, and all other important proposed work)

It is intended to drill a well with rotary tools thru the Dakota formation. Mud circulation will be used thru 100' of Lewis and set 7-5/8" intermediate casing. Gas circulation will be used thru the Dakota and set 4-1/2" casing. Possible productive Dakota intervals will be perforated and fractured. Estimated Total Depth 7465'

Casing Program:

10-3/4" Surface @ 175' w/150 sks cement to surface

7-5/8" @ 3100 w/200 sks cement

4-1/2" @ 7465' w/100 sks 40% Diaseal "D" followed by 2% gel cement.

The W/2 of Sec. 33 is dedicated to this well.

I understand that this plan of work must receive approval in writing by the Geological Survey before operations may be commenced.

Company DELNI-TAYLOR OIL CORPORATION

Address P. O. Box 2098

Farmington, New Mexico

Original signed  
by E. W. Guyon

By E. W. Guyon  
Title District Engineer

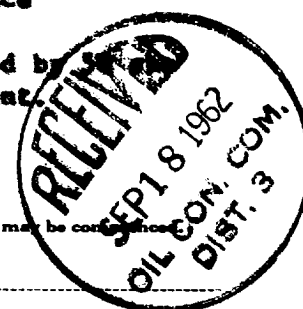

## NEW MEXICO OIL CONSERVATION COMMISSION

## Well Location and Acreage Dedication Plat

9/18/62

## Section A.

Date \_\_\_\_\_

Operator DELHI TAYLOR OIL CORPORATION Lease HUGHES SF 078049  
 Well No. 1 - 33 Unit Letter K Section 33 Township 29 NORTH Range 8 WEST NMPM  
 Located 1470 Feet From the SOUTH Line, 1716 Feet From the WEST Line  
 County SAN JUAN G. L. E. Dakota 6312.0 Dedicated Acreage 320 Acres  
 Name of Producing Formation \_\_\_\_\_ Pool \_\_\_\_\_

1. Is the Operator the only owner in the dedicated acreage outlined on the plat below?  
 Yes None No \_\_\_\_\_
2. If the answer to question one is "no", have the interests of all the owners been consolidated by communitization agreement or otherwise? Yes \_\_\_\_\_ No \_\_\_\_\_. If answer is "yes", Type of Consolidation \_\_\_\_\_
3. If the answer to question two is "no", list all the owners and their respective interests below:

Owner

Land Description

RECEIVED  
 SEP 17 1962

## Section B.

This is to certify that the information in Section A above is true and complete to the best of my knowledge and belief.

**Delhi-Taylor Oil Corp.**

(Operator)

*E. W. Gaynes*  
 (Representative)  
**E. W. Gaynes**

(Address)

**P. O. Box 1199**

**Farmington, New Mexico**

Ref: GLO plat dated 23 June 1919

Note: All distances must be from outer boundaries of section.

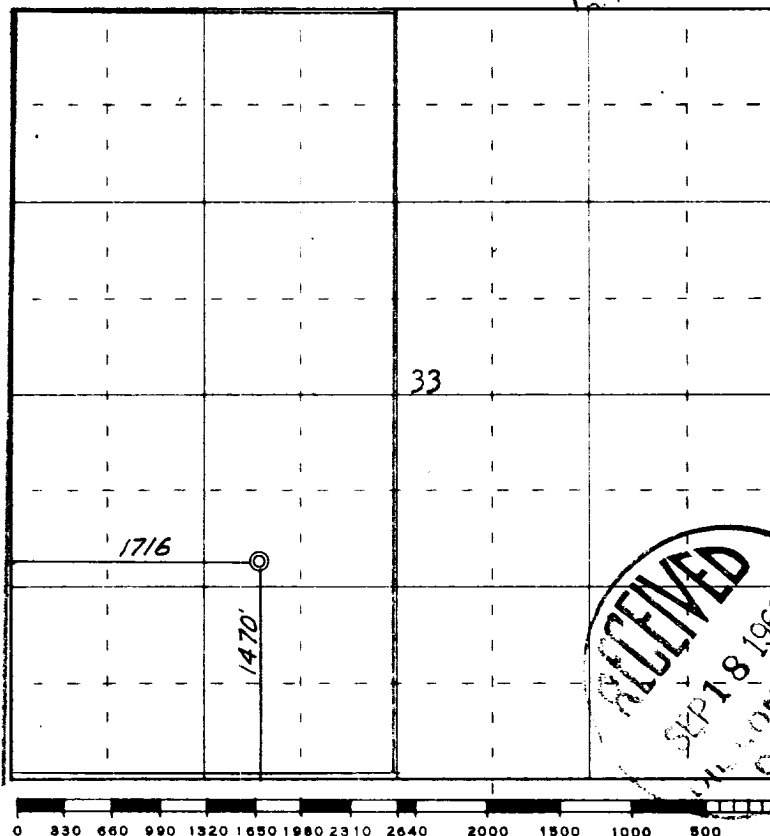

Scale 4 inches equal 1 mile

This is to certify that the above plat was prepared from field notes of actual surveys made by me or under my supervision and that the same are true and correct to the best of my knowledge and belief.

Date Surveyed 13 September 1962

*James P. Leese*  
 Registered Professional Engineer and/or Land Surveyor  
 James P. Leese, N. Mex. Reg. No. 1463

(Seal)

Farmington, New Mexico