

**ILLEGIBLE**

(SUBMIT IN TRIPLICATE)

Land Office New MexicoLease No. NM-04419Unit J. W. Aidlin "D"UNITED STATES  
DEPARTMENT OF THE INTERIOR  
GEOLOGICAL SURVEY

<b>I</b>			

**SUNDRY NOTICES AND REPORTS ON WELLS**

NOTICE OF INTENTION TO DRILL.....	<input checked="" type="checkbox"/>	SUBSEQUENT REPORT OF WATER SHUT-OFF.....	
NOTICE OF INTENTION TO CHANGE PLANS.....		SUBSEQUENT REPORT OF SHOOTING OR ACIDIZING.....	
NOTICE OF INTENTION TO TEST WATER SHUT-OFF.....		SUBSEQUENT REPORT OF ALTERING CASING.....	
NOTICE OF INTENTION TO RE-DRILL OR REPAIR WELL.....		SUBSEQUENT REPORT OF RE-DRILLING OR REPAIR.....	
NOTICE OF INTENTION TO SHOOT OR ACIDIZE.....		SUBSEQUENT REPORT OF ABANDONMENT.....	
NOTICE OF INTENTION TO PULL OR ALTER CASING.....		SUPPLEMENTARY WELL HISTORY.....	
NOTICE OF INTENTION TO ABANDON WELL.....			

(INDICATE ABOVE BY CHECK MARK NATURE OF REPORT, NOTICE, OR OTHER DATA)

**J. W. Aidlin "D"****Farmington, New Mexico June 22, 1959**Well No. 2 is located 1720 ft. from S line and 24.5 ft. from W line of sec. 10N 1/4 SW 1/4 Section 10  
(1/4 Sec. and Sec. No.)T10N  
(Twp.)R16W  
(Range)N.M.P.M.  
(Meridian)Horseshoe Gallup  
(Field)San Juan

(County or Subdivision)

New Mexico  
(State or Territory)RECEIVED  
JUN 23 1959The elevation of the derrick floor above sea level is ..... ft. (To be reported later) **CON. COM. DIST. 8****DETAILS OF WORK**

(State names of and expected depths to objective sands; show sizes, weights, and lengths of proposed casings; indicate mudding jobs, cementing points, and all other important proposed work)

We propose to drill the above well to a depth of approximately 1700' to test and develop productive Gallup zones. Stimulation will be as indicated upon penetration of Gallup pay. Rotary tools will be used to total depth. Casing program will be as follows:

SIZE	DEPTH	CEMENT	REMARKS
8-5/8"	200'	—	Neat - circulate to surface.
4-1/2"	1700'	175	4 1/2 gal and neat.

Copies of location plat are attached. A copy of any survey taken will be submitted upon completion of well.

I understand that this plan of work must receive approval in writing by the Geological Survey before operations may be commenced.

Company Pan American Petroleum CorporationAddress Box 487Farmington, New MexicoORIGINAL SIGNED BY  
R. M. Bauer, Jr.

By

Attn: L. O. Spoor, Jr.Title Area Engineer

NEW MEXICO OIL CONSERVATION COMMISSION

Well Location and Acreage Dedication Plat

Section A.

Date June 16, 1959

Operator PAN AMERICAN PETROLEUM CORPORATION Lease J. W. Aidlin "D"  
Well No. 2 Unit Letter L Section 10 Township 30 NORTH Range 16 WEST NMPM  
Located 1720 Feet From SOUTH Line, 845 Feet From WEST Line  
County SAN JUAN G. L. Elevation \* Dedicated Acreage 38.50 Acres  
Name of Producing Formation GALLUP Pool HORSESHOE GALLUP

1. Is the Operator the only owner\* in the dedicated acreage outlined on the plat below?  
Yes X No        \*TO BE REPORTED LATER.
2. If the answer to question one is "no," have the interests of all the owners been consolidated by communitization agreement or otherwise? Yes        No       . If answer is "yes,"  
Type of Consolidation
3. If the answer to question two is "no," list all the owners and their respective interests below:

Owner

Land Description



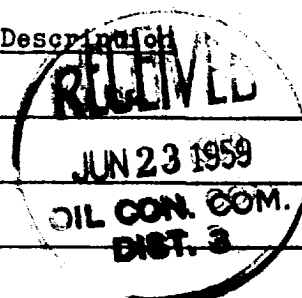

Section B

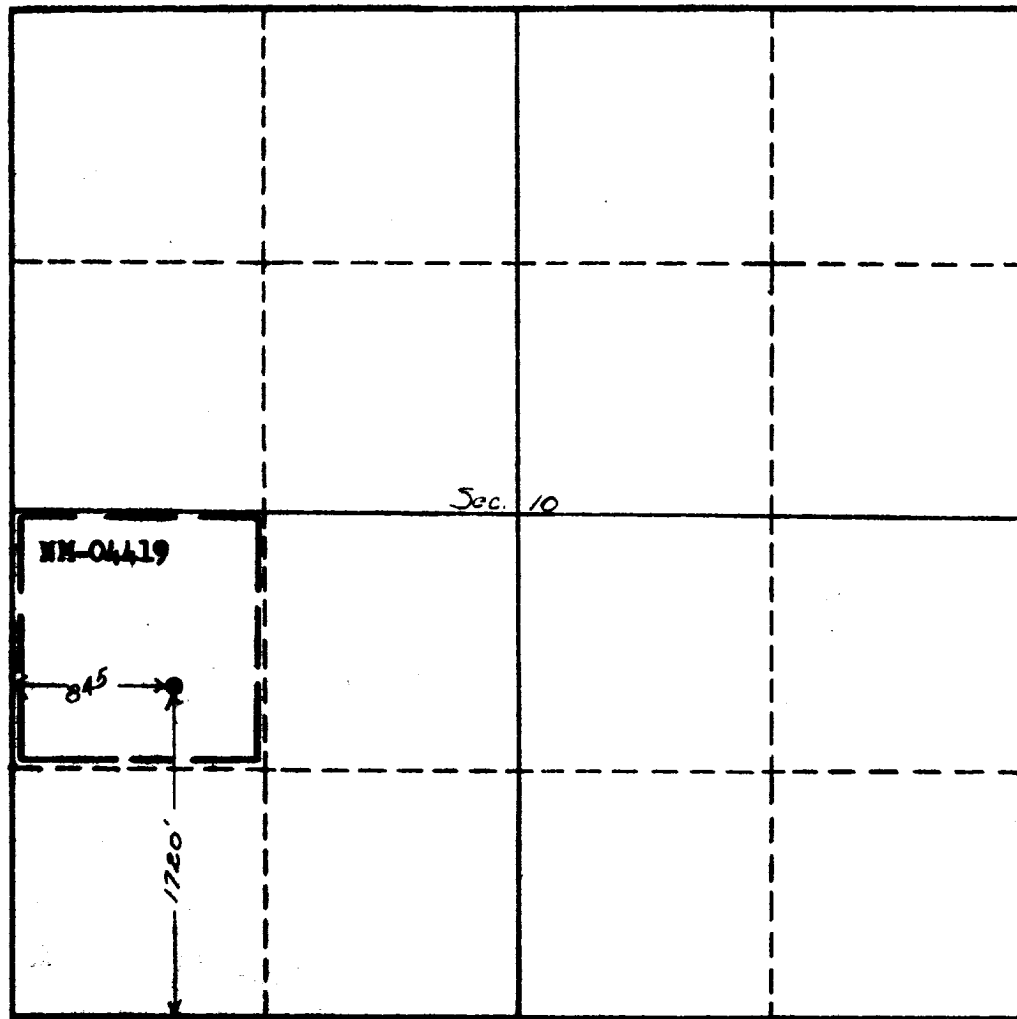

This is to certify that the information in Section A above is true and complete to the best of my knowledge and belief.

PAN AMERICAN PETROLEUM CORPORATION

(Operator)  
R.M. Bauer, Jr.  
R.M. BAUER, JR.

(Representative)

BOX 487,  
FARMINGTON, NEW MEXICO

Address

This is to certify that the well location shown on the plat in Section A was obtained from field notes of actual survey made by or under my supervision and that the same is true and correct to the best of my knowledge and belief.

Date Surveyed June 12, 1959

Ernest V. Echoshawk  
Ernest V. Echoshawk  
Registered Land Surveyor.

Certificate No. 1545