

District I  
1625 N French Dr, Hobbs, NM 88240

District II  
1301 W Grand Avenue, Artesia, NM 88210

District III  
1000 Rio Brazos Road, Aztec, NM 87410

District IV  
1220 S St Francis Dr, Santa Fe, NM 87505

State of New Mexico  
Energy Minerals and Natural Resources

Form C-101  
June 16, 2008

Oil Conservation Division  
1220 South St. Francis Dr.  
Santa Fe, NM 87505

Submit to appropriate District Office

☐ AMENDED REPORT

**APPLICATION FOR PERMITTED DRILL, RE-ENTER, DEEPEN,  
PLUGBACK, OR ADD A ZONE**

<sup>1</sup> Operator Name and Address Yates Petroleum Corporation 105 S Fourth Street Artesia, NM 88210		<sup>2</sup> OGRID Number 025575
		<sup>3</sup> API Number <b>30-005</b> <del>30-015-29096</del>
<sup>3</sup> Property Code <b>38814</b>	<sup>5</sup> Property Name Mongoose BLM State	<sup>6</sup> Well No. 1H
<sup>9</sup> Proposed Pool 1 Wildcat, <del>Wolfcamp</del>		<sup>10</sup> Proposed Pool 2

<sup>7</sup> Surface Location

UL or lot no P	Section 2 <b>25</b>	Township 15S	Range 30E	Lot Idn	Feet from the 330'	North/South line South	Feet from the 200'	East/West line East	County Chaves
-------------------	------------------------	-----------------	--------------	---------	-----------------------	---------------------------	-----------------------	------------------------	------------------

<sup>8</sup> Proposed Bottom Hole Location If Different From Surface

UL or lot no N	Section 25	Township 15S	Range 30E	Lot Idn	Feet from the 330'	North/South line South	Feet from the 1650'	East/West line West	County Chaves
-------------------	---------------	-----------------	--------------	---------	-----------------------	---------------------------	------------------------	------------------------	------------------

Additional Well Information

<sup>11</sup> Work Type Code N	<sup>12</sup> Well Type Code Oil	<sup>13</sup> Cable/Rotary R	<sup>14</sup> Lease Type Code State <b>S</b>	<sup>15</sup> Ground Level Elevation 4250'
<sup>16</sup> Multiple N	<sup>17</sup> Proposed Depth 11,734'	<sup>18</sup> Formation Wolfcamp	<sup>19</sup> Contractor Not Determined	<sup>20</sup> Spud Date ASAP

<sup>21</sup> Proposed Casing and Cement Program

Hole Size	Casing Size	Casing weight/foot	Setting Depth	Sacks of Cement	Estimated TOC
17.5"	13.375"	48#	400'	425	Surface
12.25"	9.625"	36-40#	3700'	1175	Surface
8.75	5.5"	17#	11,734'	1125	3,200'

<sup>22</sup> Describe the proposed program. If this application is to DEEPEN or PLUG BACK, give the location of the present productive zone and approval date. **Permit Expires 2 Years From Approval Date Unless Drilling Underway**

<sup>23</sup> **Change of plan.**

Yates Petroleum Corporation proposes to drill and test the Wolfcamp and intermediate formations. If commercial, production casing will be run and cemented, well perforated and stimulate as needed for production.

MUD PROGRAM: 0-400' Fresh Water Gel, 400'-3700' Brine Water, 3700'-7350' Cut Brine, 7350'-11734' Cut Brine/2-3% KCL (lateral)

BOPE PROGRAM: 3000 psi system nipped up and tested on 9 5/8" casing.

Pilot hole drilled vertically to 8650'. Well will then be plugged back and kicked off at approx 8030' and directionally drilled at 12 degrees per 100' with a 8 3/4" hole To 8797' MD (8507' TVD). If hole conditions dictate, 7" casing will be set. A 6 1/8" hole will then be drilled to 11734' MD (8404' TVD) where 4 1/2" casing with Packer port system will be run. If 7" is not set, then hole size will be reduced to 8 1/2" and drilled to 11734' MD (8404' TVD) where 5 1/2" casing with a packer port system in the lateral, with a ECP and cementing tool near top of curve will be ran to cement the 5 1/2" above the curve to 3200'. Penetration point of producing formation encountered at 330' FSL and 694' FEL. Deepest TVD of the well will be in the pilot hole @ 8650'. Deepest TVD in the lateral will be 8507'.

Previously approved as the Mongoose BLM Federal Com #1H please change to the Mongoose BLM State #1H.

<sup>23</sup> I hereby certify that the information given above is true and complete to the best of my knowledge and belief.

Signature.

*Monti Sanders*

Printed name  
Monti Sanders

Title.  
Land Regulatory Technician

E-mail Address  
montis@yatespetroleum.com

Date:  
9/13/11

Phone:  
575-748-4244

OIL CONSERVATION DIVISION

Approved by:

Title

**PETROLEUM ENGINEER**

Approval Date:

**SEP 19 2011**

Expiration Date

Conditions of Approval Attached ☐

SEP 19 2011

SEP 14 2011

## State of New Mexico

Energy, Minerals &amp; Natural Resources Department

## OIL CONSERVATION DIVISION

1220 South St. Francis Dr.  
Santa Fe, New Mexico 87505

Form C-102

Revised July 16, 2010

Submit to Appropriate  
District Office☐ AMENDED REPORT

DISTRICT I  
25 N. FRENCH DR., HOBBS, NM 88240

DISTRICT II  
1301 W. GRAND AVENUE, ARTESIA, NM 88210

DISTRICT III  
1000 RIO BRAZOS RD., AZTEC, NM 87410

DISTRICT IV  
11885 S. ST. FRANCIS DR., SANTA FE, NM 87505

## WELL LOCATION AND ACREAGE DEDICATION PLAT

API Number 30-005-29096	Pool Code 97872	Pool Name Wildcat; <del>Abq-Wolfcamp</del>
Property Code 38814	Property Name MONGOOSE BLM STATE	Well Number 1H
OGRID No. 025575	Operator Name YATES PETROLEUM CORPORATION	Elevation 4250

## Surface Location

UL or lot No.	Section	Township	Range	Lot Idn	Feet from the	North/South line	Feet from the	East/West line	County
P	25	15-S	30-E		330	SOUTH	200	EAST	CHAVES

## Bottom Hole Location If Different From Surface

UL or lot No.	Section	Township	Range	Lot Idn	Feet from the	North/South line	Feet from the	East/West line	County
N	25	15-S	30-E		330	SOUTH	1650	WEST	CHAVES
Dedicated Acres 120	Joint or Infill	Consolidation Code	Order No.						

NO ALLOWABLE WILL BE ASSIGNED TO THIS COMPLETION UNTIL ALL INTERESTS HAVE BEEN CONSOLIDATED OR A NON-STANDARD UNIT HAS BEEN APPROVED BY THE DIVISION

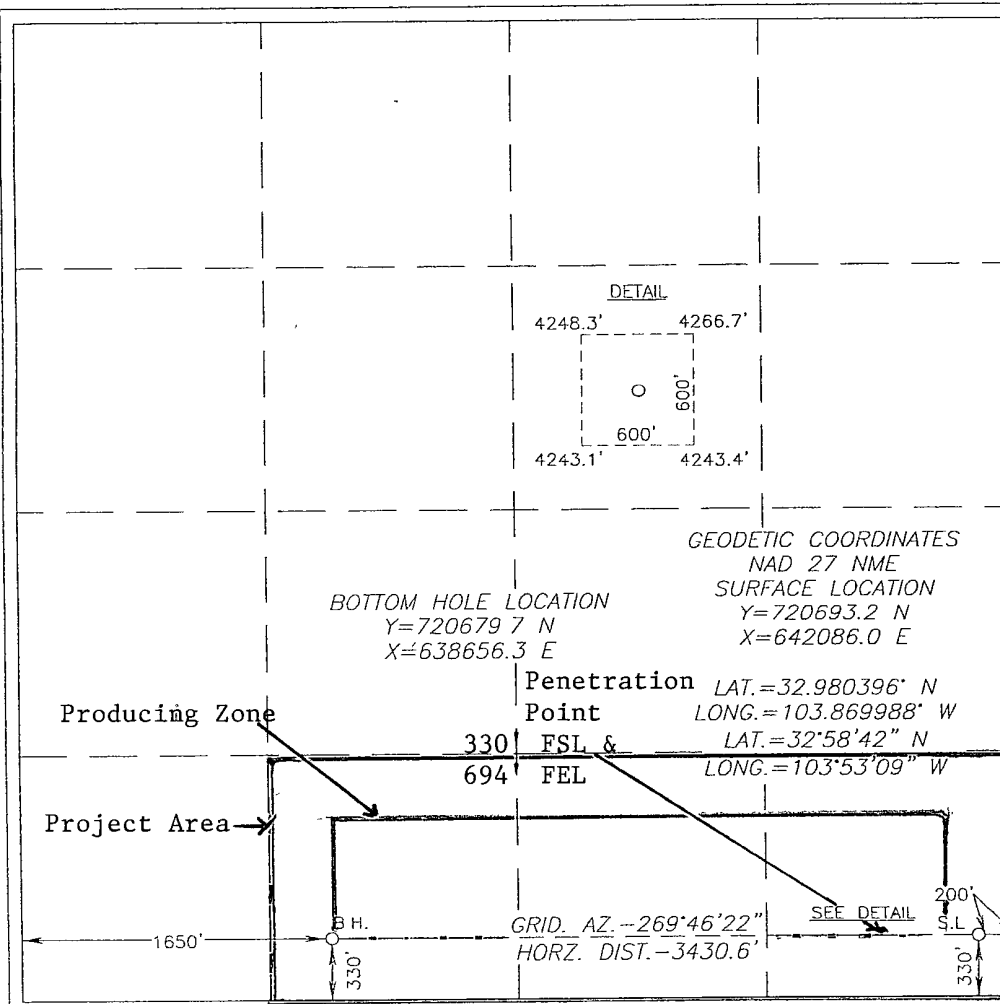

## OPERATOR CERTIFICATION

I hereby certify that the information herein is true and complete to the best of my knowledge and belief, and that this organization either owns a working interest or unleased mineral interest in the land including the proposed bottom hole location or has a right to drill this well at this location pursuant to a contract with an owner of such mineral or working interest, or to a voluntary pooling agreement or a compulsory pooling order heretofore entered by the division.

*Montis Sanders* 9/13/11  
Signature Date

Montis Sanders  
Printed Name

montis@yatespetroleum.com  
E-mail Address

## SURVEYOR CERTIFICATION

I hereby certify that the well location shown on this plat was plotted from field notes of actual surveys made by me or under my supervision, and that the same is true and correct to the best of my belief.

MAY 9, 2008

Date of Survey  
Signature & Seal of Professional Surveyor:

**RONALD J. EIDSON**  
NEW MEXICO  
3239  
Certificate Number Gary C. Eidson 12641  
Ronald J. Eidson 3239  
LA WSC W.O. 11.13.0692

## Mongoose BLM State #1H

### Contingency Casing Design

If hole conditions dictate, 7" casing will be set. A 6 1/8" hole will then be drilled to 11,734' MD (8404' TVD) where a 4 1/2" liner with packer port system will be run. If 7" is not set, then hole size will be reduced to 8 1/2" and drilled to 11,734' MD (8404' TVD) where 5 1/2" casing with a packer port system in the lateral, with a ECP and cementing tool above the top of curve. Will then cement the 5 1/2" from cementing tool up to 3200'

#### 2nd Intermediate

0 ft to 8,797 ft		Make up Torque ft-lbs			Total ft = 8,797	
O.D.	Weight	Grade	Threads	opt	min.	mx.
7 inches	26 #/ft	P-110	LT&C	6930	5200	8660
Collapse Resistance	Internal Yield	Joint Strength		Body Yield		Drift
6,230 psi	9,950 psi	639,000 #		830,000 #		6.151"

Cement w/900sx Lite Crete (YLD 2.66 Wt. 9.9), tail w/200sx Class C (YLD 1.34 Wt. 14.8) TOC=Surface

#### Production Liner

7,500 ft to 11,734 ft		Make up Torque ft-lbs			Total ft = 4,234	
O.D.	Weight	Grade	Threads	opt	min.	mx.
4.5 inches	11.6 #/ft	HCP-110	LT&C	3020	2270	3780
Collapse Resistance	Internal Yield	Joint Strength		Body Yield		Drift
8,650 psi	10,690 psi	279,000 #		367,000 #		3.875

4 1/2" liner will be run with packer/port system with no cement.

Co: Yates Petroleum Corporation			Units: Feet, ° 1100ft			VS Az: 269.77		Tgt TVD: 8404.00	
Drillers: 0			Elevation:			Tgt Radius: 0.00		Tgt MD: 0.00	
Well Name: Mongoose BLM State #1H			Northing:			Tgt N/S: -13.50		Tgt Displ.: 0.00	
Location: Section 25, 15S-30E			Easting:			Tgt E/W: -3429.70		Method: Minimum Curvature	

No.	MD	CL	Inc.	Azi.	TVD	VS	+N/S-	+E/W-	BR	WR	DLS	Comments
0	0.00	0.00	0.00	0.00	0.00	0.00	0.00	0.00				
1	2123.00	2123.00	0.00	360.00	2123.00	0.00	0.00	0.00	0.00	0.00	0.00	Yates
2	2278.00	155.00	0.00	360.00	2278.00	0.00	0.00	0.00	0.00	0.00	0.00	Seven Rivers
3	2916.00	638.00	0.00	360.00	2916.00	0.00	0.00	0.00	0.00	0.00	0.00	Queen
4	3331.00	415.00	0.00	360.00	3331.00	0.00	0.00	0.00	0.00	0.00	0.00	Grayburg
5	3616.00	285.00	0.00	360.00	3616.00	0.00	0.00	0.00	0.00	0.00	0.00	San Andres
6	5176.00	1560.00	0.00	360.00	5176.00	0.00	0.00	0.00	0.00	0.00	0.00	Glorietta
7	6371.00	1195.00	0.00	360.00	6371.00	0.00	0.01	0.00	0.00	0.00	0.00	Tubb
8	7400.00	1029.00	0.00	360.00	7400.00	0.00	0.01	0.00	0.00	0.00	0.00	Abo
9	8030.37	8030.37	0.00	269.77	8030.37	0.00	0.01	0.00	0.00	3.36	0.00	KOP
10	8100.00	69.63	8.36	269.77	8099.75	5.07	-0.01	-5.07	12.00	0.00	12.00	
11	8200.00	100.00	20.36	269.77	8196.45	29.82	-0.11	-29.82	12.00	0.00	12.00	
12	8300.00	100.00	32.36	269.77	8285.90	74.13	-0.28	-74.13	12.00	0.00	12.00	
13	8400.00	100.00	44.36	269.77	8364.17	136.07	-0.53	-136.07	12.00	0.00	12.00	
14	8500.00	100.00	56.36	269.77	8427.85	212.94	-0.83	-212.93	12.00	0.00	12.00	
15	8600.00	100.00	68.36	269.77	8474.17	301.36	-1.18	-301.36	12.00	0.00	12.00	
16	8700.00	100.00	80.36	269.77	8501.08	397.48	-1.56	-397.48	12.00	0.00	12.00	
17	8797.20	766.83	92.02	269.77	8507.53	494.29	-1.94	-494.29	12.00	0.00	12.00	Basal Abo Target
18	11734.46	2937.26	92.02	269.77	8404.00	3429.73	-13.49	-3429.70	0.00	0.00	0.00	Lateral TD

