

New Mexico Oil Conservation
UNITED STATES
DEPARTMENT OF THE INTERIOR
BUREAU OF LAND MANAGEMENT
1625 N. FURNACE DRIVE
HOBBS, NM 88240

SUBMIT IN TRIPPLICATE

(Other instructions on
reverse side)FORM APPROVED
OMB NO. 1004-0136
Expires: February 28, 1995

APPLICATION FOR PERMIT TO DRILL OR DEEPEN

1a. TYPE OF WORK

DRILL ☒DEEPEN ☐

b. TYPE OF WELL

OIL
WELL ☒GAS
WELL ☐OTHER ☐SINGLE
ZONE ☒MULTIPLE
ZONE ☐

2. NAME OF OPERATOR

POGO PRODUCING COMPANY (RICHARD WRIGHT 432-685-8140) <17891>

3. ADDRESS AND TELEPHONE NO.

P.O. BOX 10340 MIDLAND, TEXAS 79702-7340 (432-685-8100)

4. LOCATION OF WELL (Report location clearly and in accordance with any State requirements.)*

At surface

2480' FNL & 1250' FWL SECTION 21 T25S-R32E LEA CO. NM

At proposed prod. zone SAME

14. DISTANCE IN MILES AND DIRECTION FROM NEAREST TOWN OR POST OFFICE*

Approximately 28 miles West of Jal New Mexico

15. DISTANCE FROM PROPOSED*

LOCATION TO NEAREST
PROPERTY OR LEASE LINE, FT.
(Also to nearest drlg. unit line, if any)

1250'

16. NO. OF ACRES IN LEASE

1920±

17. NO. OF ACRES ASSIGNED
TO THIS WELL

40

18. DISTANCE FROM PROPOSED LOCATION*

TO NEAREST WELL, DRILLING, COMPLETED,
OR APPLIED FOR, ON THIS LEASE, FT.

700'

19. PROPOSED DEPTH

5000'

20. ROTARY OR CABLE TOOLS

ROTARY

21. ELEVATIONS (Show whether DF, RT, GR, etc.)

3395' GR.

22. APPROX. DATE WORK WILL START*
WHEN APPROVED

23.

PROPOSED CASING AND CEMENTING PROGRAM

SIZE OF HOLE	GRADE, SIZE OF CASING	WEIGHT PER FOOT	SETTING DEPTH	QUANTITY OF CEMENT
26"	20" conductor	NA	40' J55	Cement to surface W/Redi-mix.
12 1/2"	H-40 8 5/8"	24#	600' 8 1/2"	300 Sx. Circulate cement
7 7/8"	J-55 5 1/2"	15.5#	5000'	725 Sx. " "

1. Drill 26" hole to 40'. Set 40' of 20" conductor pipe and cement to surface with Redi-mix.
2. Drill 12 1/2" hole to 600'. Run and set 600' of 8 5/8" H-40 24# ST&C casing. Cement with 150 Sx. of 65/35/6 Class "C" POZ/GEL, tail in with 150 Sx. of Class "C" cement + 2% CaCl, + 1/2# Flocele/Sx. Circulate cement to surface.
3. Drill 7 7/8" hole to 5000'. Run and set 5000' of 5 1/2" 15.5# J-55 ST&C casing. Cement with 475 Sx. of Class "C" light weight cement + 5% Salt, mixed at 12.9 PPG, tail in with 250 Sx. of Class "C" cement + 8# Gilsonite/Sx., mixed at 14.1 PPG. Cement volumes are calculated to circulate cement to surface.

IN ABOVE SPACE DESCRIBE PROPOSED PROGRAM: If proposal is to deepen, give data on present productive zone and proposed new productive zone. If proposal is to drill or deepen directionally, give pertinent data on subsurface locations and measured and true vertical depths. Give blowout preventer program, if any.

24.

SIGNED

TITLE

Agent

DATE 10/18/05

(This space for Federal or State office use)

PERMIT NO.

APPROVAL DATE

Application approval does not warrant or certify that the applicant holds legal or equitable title to those rights in the subject lease which would entitle the applicant to conduct operations thereon.

CONDITIONS OF APPROVAL IF ANY:

/s/ Joe G. Lara

ACTING
FIELD MANAGER

APPROVAL FOR 1 YEAR

DEC - 5 2005

APPROVED BY

TITLE

DATE

State of New Mexico

DISTRICT I

1625 N. FRENCH DR., HOBBBS, NM 88240

Energy, Minerals and Natural Resources Department

Form C-102

DISTRICT II

1301 W. GRAND AVENUE, ARTESIA, NM 88210

OIL CONSERVATION DIVISION

1220 SOUTH ST. FRANCIS DR.

Santa Fe, New Mexico 87505

Submit to Appropriate District Office

State Lease - 4 Copies

Fee Lease - 3 Copies

DISTRICT III

1000 Rio Brazos Rd., Aztec, NM 87410

DISTRICT IV

1220 S. ST. FRANCIS DR., SANTA FE, NM 87505

WELL LOCATION AND ACREAGE DEDICATION PLAT

☐ AMENDED REPORT

API Number 30-025-37586	Pool Code 49460	Pool Name PADUCA-DELAWARE
Property Code 301629	Property Name COTTON DRAW UNIT	Well Number 98
GRID No. 17891	Operator Name POGO PRODUCING COMPANY	Elevation 3395'

Surface Location

UL or lot No.	Section	Township	Range	Lot Idn	Feet from the	North/South line	Feet from the	East/West line	County
E	21	25-S	32-E		2480	NORTH	1250	WEST	LEA

Bottom Hole Location If Different From Surface

UL or lot No.	Section	Township	Range	Lot Idn	Feet from the	North/South line	Feet from the	East/West line	County
Dedicated Acres 40	Joint or Infill	Consolidation Code	Order No.						

NO ALLOWABLE WILL BE ASSIGNED TO THIS COMPLETION UNTIL ALL INTERESTS HAVE BEEN CONSOLIDATED
OR A NON-STANDARD UNIT HAS BEEN APPROVED BY THE DIVISION

	<p>GEODETIC COORDINATES NAD 27 NME</p> <p>Y=406603.6 N X=700983.0 E</p> <p>LAT.=32°06'58.34" N LONG.=103°41'03.03" W</p>	<p>OPERATOR CERTIFICATION</p> <p>I hereby certify the the information contained herein is true and complete to the best of my knowledge and belief.</p> <p><i>Joe T. Janica</i> Signature</p> <p>Joe T. Janica Printed Name</p> <p>Agent Title</p> <p>10/18/05 Date</p>
		<p>SURVEYOR CERTIFICATION</p> <p>I hereby certify that the well location shown on this plat was plotted from field notes of actual surveys made by me or under my supervision, and that the same is true and correct to the best of my belief.</p> <p>AUGUST 15, 2005</p>
		<p>Date Surveyed</p> <p>Signature & Seal of Professional Surveyor</p> <p><i>GARY EIDSON</i> Signature</p> <p>05.11.1207 Date</p>
		<p>Certificate No. GARY EIDSON 12841</p>

EXHIBIT "A"

SECTION 21, TOWNSHIP 25 SOUTH, RANGE 32 EAST, N.M.P.M.,
LEA COUNTY, NEW MEXICO

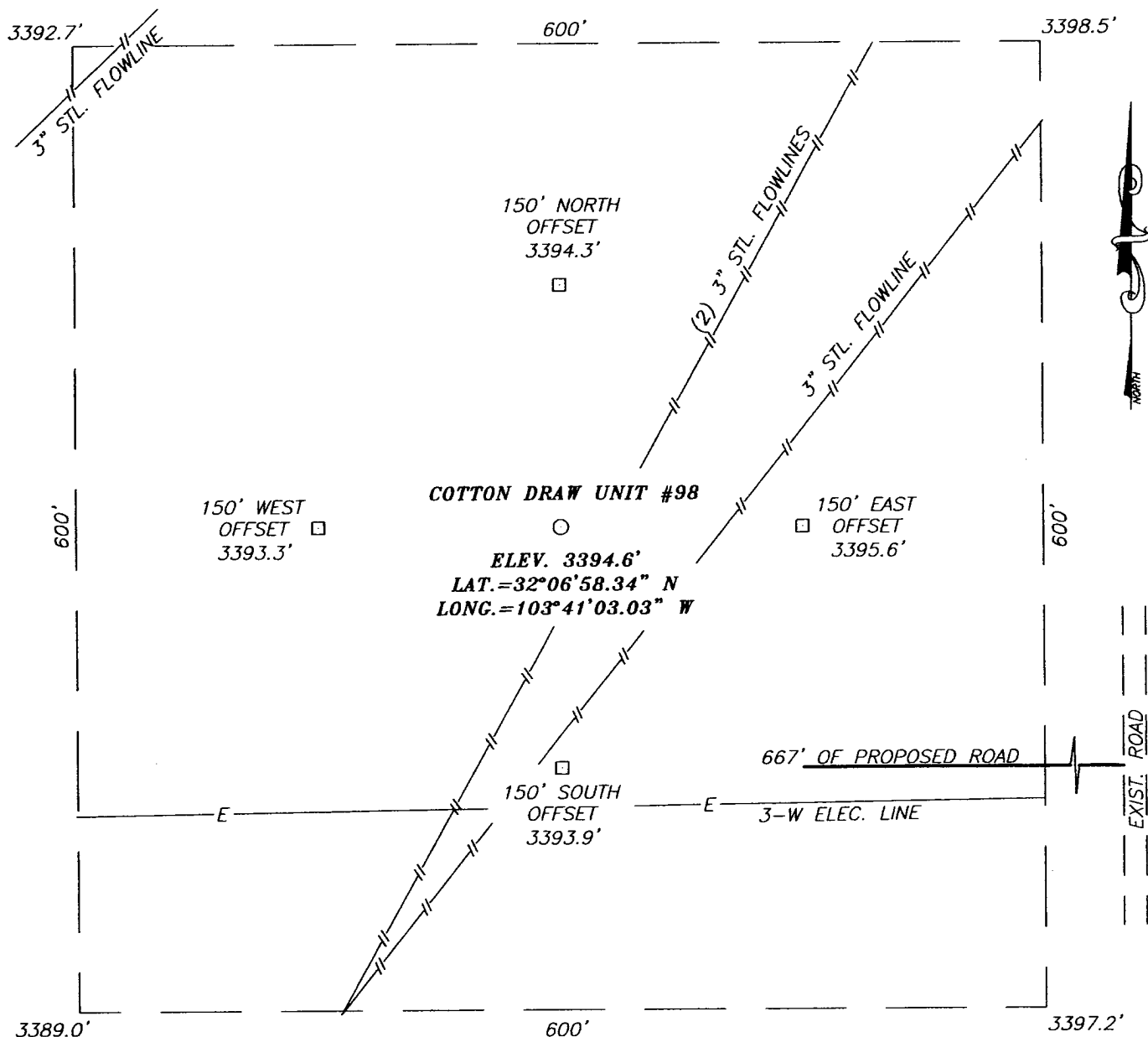

DIRECTIONS TO LOCATION

FROM THE INTERSECTION OF ST. HWY. #128 (JAL HWY) AND CO RD. #1 (ORLA RD.) GO SOUTH ON CO. RD. #1 APPROX. 6.3 MILES. TURN RIGHT AND GO WEST APPROX. 0.13 MILES. TURN LEFT AND GO SOUTH APPROX. 0.9 MILES. TURN RIGHT AND GO WEST APPROX. 0.5 MILES. TURN RIGHT AND GO NORTH APPROX. 0.2 MILES TO A PROPOSED ROAD SURVEY ON THE LEFT. FOLLOW ROAD SURVEY WEST APPROX. 667 FEET TO THIS LOCATION.

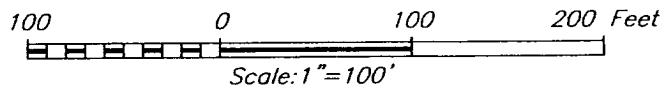

POGO PRODUCING COMPANY

COTTON DRAW UNIT #98 WELL
LOCATED 2480 FEET FROM THE NORTH LINE
AND 1250 FEET FROM THE WEST LINE OF SECTION 21,
TOWNSHIP 25 SOUTH, RANGE 32 EAST, N.M.P.M.,
LEA COUNTY, NEW MEXICO.

Survey Date: 8/15/05	Sheet 1 of 1 Sheets
W.O. Number: 05.11.1207	Dr By: LA
Date: 8/23/05	Disk: CD#4
05111207	Scale: 1"=100'

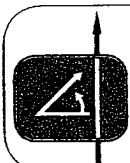

PROVIDING SURVEYING SERVICES
SINCE 1946
JOHN WEST SURVEYING COMPANY
412 N. DAL PASO
HOBBS, N.M. 88240
(505) 393-3117

VICINITY MAP

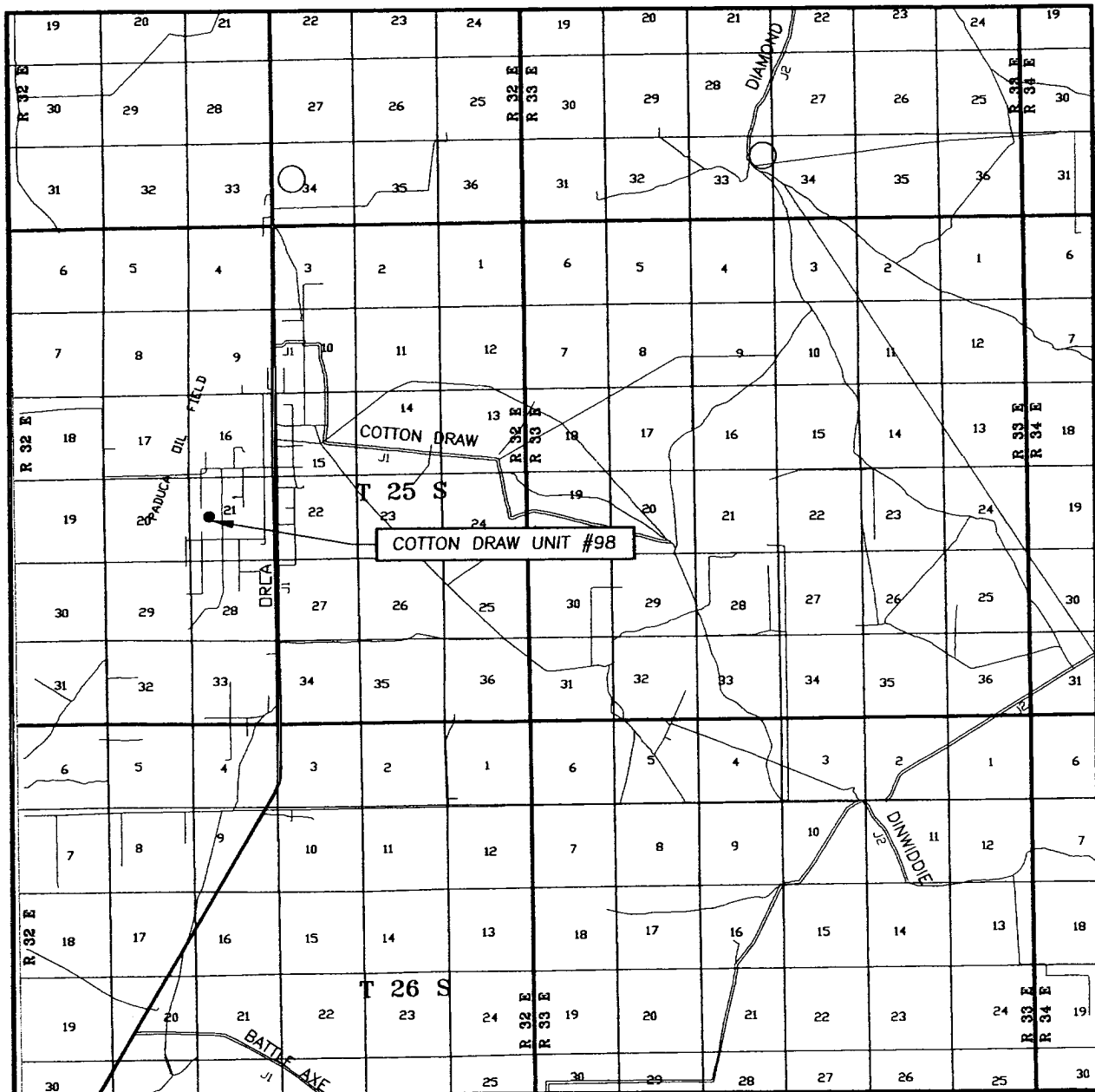

SCALE: 1" = 2 MILES

SEC. 21 TWP. 25-S RGE. 32-E

SURVEY N.M.P.M.

COUNTY LEA

DESCRIPTION 2480' FNL & 1250' FWL

ELEVATION 3395'

OPERATOR POGO PRODUCING COMPANY

LEASE COTTON DRAW UNIT

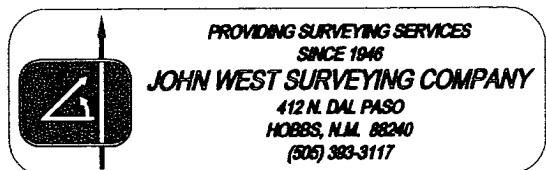

LOCATION VERIFICATION MAP

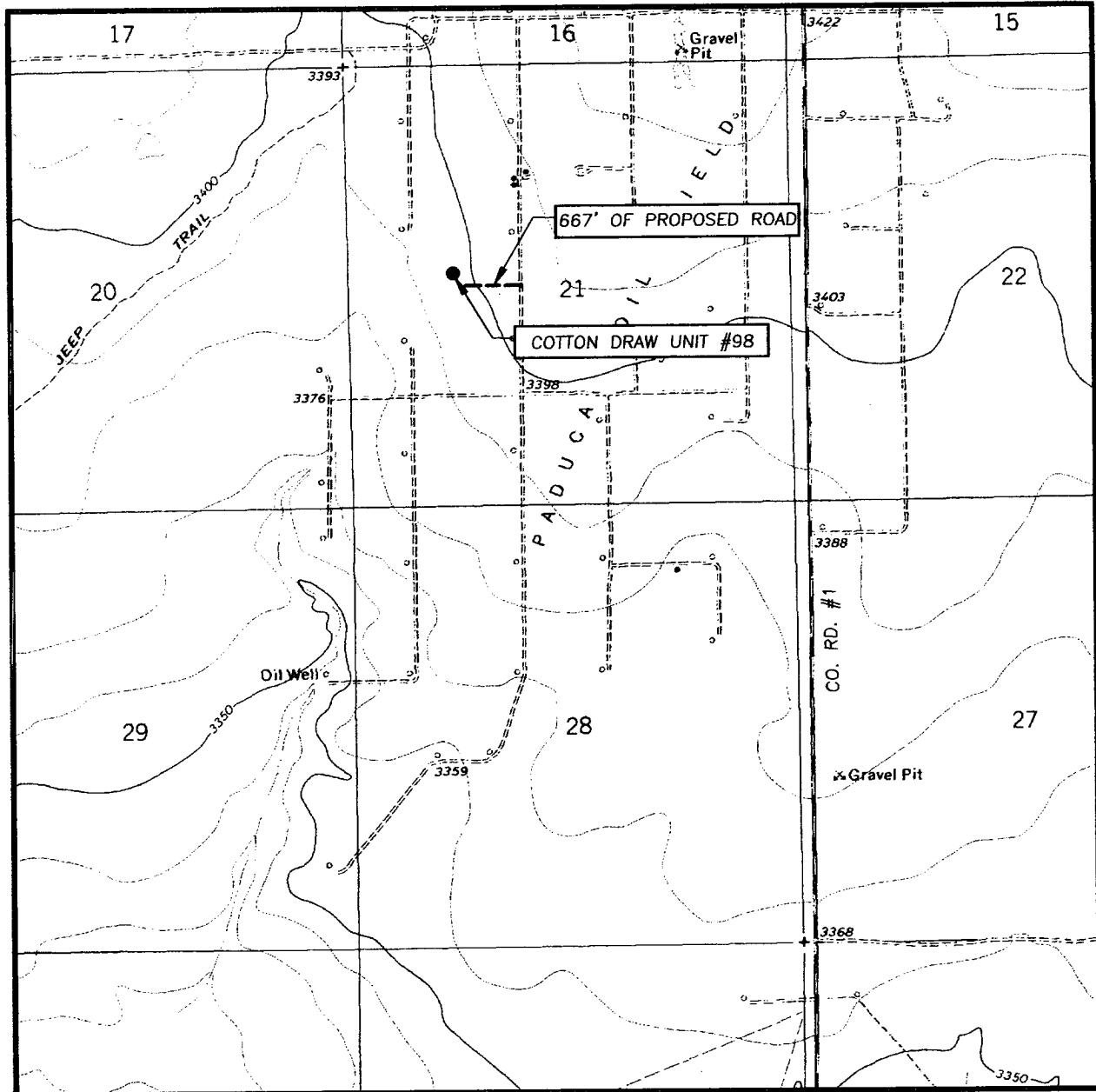

SCALE: 1" = 2000'

CONTOUR INTERVAL: 10'
PADUCA BREAKS W, N.M.

SEC. 21 TWP. 25-S RGE. 32-E

SURVEY N.M.P.M.

COUNTY LEA

DESCRIPTION 2480' FNL & 1250' FWL

ELEVATION 3395'

OPERATOR POGO PRODUCING COMPANY

LEASE COTTON DRAW UNIT

U.S.G.S. TOPOGRAPHIC MAP
PADUCA BREAKS W, N.M.

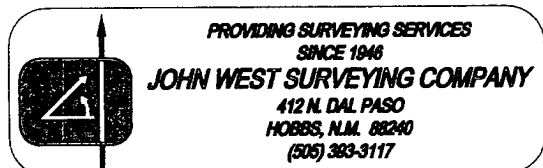

APPLICATION TO DRILL

POGO PRODUCING COMPANY
COTTON DRAW UNIT #98
UNIT "E" SECTION 21
T25S-R32E LEA CO. NM

In response to questions asked under Section II of Bulletin NTL-6 the following information on the above well is provided for your consideration.

1. Location of well: 2480' FNL & 1250' FWL SECTION 21 T25S-R32E LEA CO. NM
2. Ground Elevation above Sea Level: 3395' GR.
3. Geological age of surface formation: Quaternary Deposits:
4. Drilling tools and associated equipment: Conventional rotary drilling rig using drilling mud as a circulating medium to remove solids from hole.
5. Proposed drilling depth: 5000'
6. Estimated tops of geological markers:

Rustler Anhydrite	753'	Ramsey	4680'
Salt	1072'	Ford	4780'
Lamar Lime	4638'	Olds	4787'
Delaware	4662'	TD	5000'
7. Possible mineral bearing formations:

Delaware	Oil	Olds	Oil
Ramsey	Oil		
Ford	Oil		
8. Casing Program:

Hole Size	Interval	OD of Casing	Weight	Thread	Collar	Grade
26"	0-40	20"	NA	NA	NA	Conductor
12 1/4"	0- 600 815'	8 5/8"	24#	8-R	ST&C	H-40
7 7/8"	0-5000'	5 1/2"	15.5#	8-R	ST&C	J-55

APPLICATION TO DRILL

POGO PRODUCING COMPANY
COTTON DRAW UNIT #98
UNIT "E" SECTION 21
T25S-R32E LEA CO. NM

9. CEMENTING & CASING SETTING DEPTHS:

20"	Conductor	Set 40' of 20" conductor pipe and cement to surface with Redi-mix.
8 5/8"	Surface	Set ^{815'} 600' of 8 5/8" 24# J-55 ST&C casing. Cement with 150 Sx. of 65/35/6 Class "C" POX/GEL, tail in with 150 Sx. of Class "C" cement + 2% CaCl ₂ + 1/2# Flocele/Sx. Circulate cement to surface.
5 1/2"	Production	Set 5000' of 5 1/2" 15.5# J-55 ST&C casing. Cement with 475 Sx. of Class "C" Light weight cement with 5% salt, mixed at 12.9 PPG, tail in with 250 Sx. of Class "C" cement + 8# Gilsonite/Sx. Mix at 14.1 PPG circulate cement to surface. Cement volumes may have to be adjusted if caliper logs show more is required to circulate.

10. PRESSURE CONTROL EQUIPMENT:

Exhibit "E" shows a 2000 PSI working pressure B.O.P., consisting of a stripper head instead of an annular preventor, blind rams, and pipe rams. This B.O.P. stack is being used because of Substructure height limitations of the drilling rig being used to drill this well. Pressures encountered during drilling are not expected to exceed 2000 PSI at total depth. Pogo requests permission to 3rd party test of B.O.P. B.O.P. will be installed after setting the 8 5/8" surface casing, The B.O.P. will be tested according to API specifications. Exhibit "E-1" shows a manually operated choke manifold , as no remote B.O.P. equipment will be necessary.

11. PROPOSED MUD CIRCULATING SYSTEM:

DEPTH	MUD WT.	VISC.	FLUID LOSS	TYPE MUD
40- 600' ^{815'}	8.4-8.7	29-34	NC	Fresh water spud mud use paper to control seepage.
^{815'} 600 -5000'	10.0-10.2	29-38	NC*	Brine water add paper to control seepage and high viscosity sweeps to clean hole.

* Water loss control may be necessary in order to run logs and casing. Use starch to control water loss or a Polymer system.

APPLICATION TO DRILL

POGO PRODUCING COMPANY
COTTON DRAW UNIT #98
UNIT "E" SECTION 21
T25S-R32E LEA CO. NM

12. LOGGING, CORING, AND TESTING PROGRAM:

- A. Open hole logs: Dual Laterolog, LDT, SNP, MICRO SFL, Gamma Ray, Caliper run from TD Back to 8 5/8" casing shoe.
- B. Run Gamma Ray, Neutron from 8 5/8" casing shoe back to surface.
- C. No DST's are planned at this time.
- D. Cores may be taken at the advice of Geologist.

13. POTENTIAL HAZARDS:

No abnormal pressures or temperatures are expected. There is no known presence of H²S in this area. If H²S is encountered the operator will comply with the provisions of Onshore Oil and Gas Order No. 6. No lost circulation is expected to occur. All personnel will be familiar with all aspects of safe operation of equipment being used to drill this well. Estimated BHP 2000 PSI, and Estimated BHT 130°.

14. ANTICIPATED STARTING DATE AND DURATION OF OPERATION:

Road and location construction will begin after the BLM has approved the APD. Anticipated spud date will be as soon after BLM approval and as soon as a rig will be available. Move in operation and drilling is expected to take 20 days. If production casing is run then an additional 30 days will be needed to complete well and construct surface facilities and/or lay flowlines in order to place well on production.

15. OTHER FACETS OF OPERATIONS:

After running casing, cased hole Gamma Ray, Neutron Collar logs will be run from TD back to all possible productive zones. The Delaware formation will be perforated and stimulated in order to establish production. The well will be swab tested and potentialized as an oil well.

HYDROGEN SULFIDE DRILLING OPERATIONS PLAN

1. All Company and Contract personnel admitted on location must be trained by a qualified H₂S safety instructor to the following:
 - A. Characteristics of H₂S
 - B. Physical effects and hazards
 - C. Proper use of safety equipment and life support systems.
 - D. Principle and operation of H₂S detectors, warning system and briefing areas.
 - E. Evacuation procedure, routes and first aid.
 - F. Proper use of 30 minute pressure demand air pack.
2. H₂S Detection and Alarm Systems
 - A. H₂S detectors and audio alarm system to be located at bell nipple, end of blooie line (mud pit) and on derrick floor or doghouse.
3. Windsock and/or wind streamers
 - A. Windsock at mudpit area should be high enough to be visible.
 - B. Windsock at briefing area should be high enough to be visible.
 - C. There should be a windsock at entrance to location.
4. Condition Flags and Signs
 - A. Warning sign on access road to location.
 - B. Flags to be displayed on sign at entrance to location. Green flag, normal safe condition. Yellow flag indicates potential pressure and danger. Red flag, danger, H₂S present in dangerous concentration. Only emergency personnel admitted to location.
5. Well control equipment
 - A. See exhibit "E"
6. Communication
 - A. While working under masks chalkboards will be used for communication.
 - B. Hand signals will be used where chalk board is inappropriate.
 - C. Two way radio will be used to communicate off location in case of emergency help is required. In most cases cellular telephoned will be available at most drilling foreman's trailer or living quarters.
7. Drillstem Testing
 - A. Exhausts will be watered.
 - B. Flare line will be equipped with an electric ignitor or a propane pilot light in case gas reaches the surface.
 - C. If location is near any dwelling a closed D.S.T. will be performed.

HYDROGEN SULFIDE DRILLING OPERATIONS PLAN

8. Drilling contractor supervisor will be required to be familiar with the effects H₂S has on tubular goods and other mechanical equipment.
9. If H₂S is encountered, mud system will be altered if necessary to maintain control of formation. A mud gas separator will be brought into service along with H₂S scavengers if necessary.

SURFACE USE PLAN

POGO PRODUCING COMPANY
COTTON DRAW UNIT #98
UNIT "E" SECTION 21
T25S-R32E LEA CO. NM

1. EXISTING ROADS & PROPOSED ROADS: Area maps; Exhibit "B" is a reproduction of a County General Hi-way Map. Exhibit "C" is a reproduction of a USGS Topographic Map, showing existing and proposed roads. All existing roads will be maintained in a condition equal to or better than current conditions. Any new roads will be constructed to BLM specifications.
 - A. Exhibit "A" shows the proposed well site as staked.
 - B. From Eunice New Mexico take State Road 207 South 2.6 miles to Delaware Basin road, turn Right (West) follow Delaware Basin Road to the junction with State Hi-way 128, turn Right (West) go 9.5 miles to CR-1, turn Left (South) go 6.4 miles, turn Right (West) go past caliche pit and bear Right (South) go .85 miles, turn Right (South) .6 miles turn Right (West) go 800' to location.
 - C. Exhibit "C" shows proposed flowlines, and powerlines that will be constructed.
2. PLANNED ACCESS ROADS: Approximately 800' of new road will be constructed.
 - A. The access roads will be crowned and ditched to a 12' wide travel surface with a 40' Right-of-Way.
 - B. Gradient of all roads will be less than 5.00%.
 - C. If turn-outs are necessary they will be constructed.
 - D. If needed roads will be surfaced with a minimum of 4" of caliche. This material will be obtained from a local source.
 - E. Center-line for new roads will be flagged. Earth-work will be will be done as field conditions require.
 - F. Culverts will be placed in the access road if they are necessary. The roads will be constructed to utilize low water crossings for drainage as required by topography.
3. LOCATIONS OF EXISTING WELLS IN A ONE MILE RADIUS. EXHIBIT "A-1"
 - A. Water wells - One approximately 2 miles North.
 - B. Disposal wells - None known
 - C. Drilling wells - None known
 - D. Producing wells - As shown on Exhibit "A-1"
 - E. Abandoned wells - As shown on Exhibit "A-1"

SURFACE USE PLAN

POGO PRODUCING COMPANY
COTTON DRAW UNIT #98
UNIT "E" SECTION 21
T25S-R32E LEA CO. NM

4. If on completion this well is a producer the operator will lay pipelines and construct powerlines along existing road R-O-W's or other existing R-O-W's. Exhibit "C" shows proposed routes of roads, flowlines and powerlines.

5. LOCATION AND TYPE OF WATER SUPPLY:

Water will be purchased locally from a commercial source and trucked over the access roads or piped to location in flexible lines laid on top of the ground.

6. SOURCE OF CONSTRUCTION MATERIAL:

If possible construction material will be obtained from the excavation of drill site, if additional material is needed it will be obtained from a local source and transported over the access roads as shown on Exhibit "C".

7. METHODS OF HANDLING WASTE MATERIAL:

- A. Drill cuttings will be disposed of in the reserve pits.
- B. All trash, junk and other waste material will be contained in trash cages or trash bins to prevent scattering. When the job is completed all contents will be removed and disposed of in a approved sanitary land fill.
- C. Salts remaining after completion of well will be picked up by the supplier, including broken sacks.
- D. Waste water from living quarters will be drained into holes with a minimum of 10'. These holes will be covered during drilling and will be back filled when the well is completed. A Porto-John will be provided for the rig crews. This equipment will be properly maintained during the drilling and completion operations and will be removed when all operations are complete.
- E. Remaining drilling fluids will be allowed to evaporate in the reserve pits until the pits are dry enough to be broken out for further drying. If the drilling fluids do not evaporate in a reasonable time they will be hauled off by transports to a state approve disposal site. Later pits will be broken out to speed drying. Water produced during completion will be put in reserve pits. Oil and condensate produced will be put in storage tanks and sold.

8. ANCILLARY FACILITIES:

- A. No camps or air strips will be constructed on location.

SURFACE USE PLAN

POGO PRODUCING COMPANY
COTTON DRAW UNIT #98
UNIT "E" SECTION 21
T25S-R32E LEA CO. NM

9. WELL SITE LAYOUT:

- A. Exhibit "D" shows the proposed well site layout.
- B. This Exhibit shows the location of reserve pit, sump pits, and living facilities.
- C. Mud pits in the active circulating system will be steel pits and the reserve pits will be unlined unless subsurface conditions encountered during pit construction indicate that a plastic liner is required to contain lateral migration.
- D. If needed the reserve pits will be lined with polyethelene. The pit liner will be no less than 6 mils thick and the liner will be extended at least 3 feet over the top of the dikes and secured in place to keep edge of liner in place.
- E. The reserve pit will be fenced on three sides and fenced with four strands of barbed wire during drilling and completion phases. The 4th side will be fenced after drilling operations are complete and the drilling rig has moved out. If the well is a producer the mud pits will remain fenced in until the mud has dried up enough to break out the pits and reclaimed according to BLM requirements.

10. PLANS FOR RESTORATION OF SURFACE:

Rehabilitation of the location and reserve pits will be allowed to dry properly, fluids may be moved and disposed of in accordance with article 7-E as previously noted. The pit area will then be leveled and contoured to conform to the original and surrounding area. Drainage systems, if any will be reshaped to the original configuration with provisions made to alleviate future erosion. In case of the well completed as a producer the drilling pad will be necessary to construct production facilities. After the area has been shaped and contoured top soil from the spoil pile will be placed over the disturbed area to the extent possible so that revegetation procedures can be accomplished to comply with the BLM specifications.

If the well is a dry hole the pad and road area will be contoured to match the existing terrain. Top soil will be spread to the extent possible and revegetation will be carried out according to the BLM specifications.

Should the well be a producer the previously noted procedures will apply to those areas which are not required for production facilities.

SURFACE USE PLAN

POGO PRODUCING COMPANY
COTTON DRAW UNIT #98
UNIT "E" SECTION 21
T25S-R32E LEA CO. NM

11. OTHER INFORMATION:

- A. Topography is relatively flat with a slight dip to the Southwest with shallow drainage patterns. Vegetation consists of creosote bush, little leaf sumac, broom-snakeweed, and native grasses.
- B. Surface is owned by the U.S. Department of Interior and is administered by the Bureau of Land Management. The surface is leased to ranchers for grazing of live stock and the minerals are owned by the U.S. Government and used by oil companies for the production of oil and gas.
- C. An archaeological survey will be conducted and the results will be filed with The Bureau of Land Management Carlsbad Field office in Carlsbad NM.
- D. There are no domestic dwellings located within one mile of the location.

12. OPERATORS REPRESENTATIVE:

Before construction:

TIERRA EXPLORATION, INC.
P.O. BOX 2188
HOBBS, NEW MEXICO 88241
JOE T. JANICA
OFFICE PHONE 505-391-8503

During and after construction:

POGO PRODUCING COMPANY
P.O. BOX 10340
MIDLAND, TEXAS 79702-7340
RICHARD WRIGHT
OFFICE PHONE 432-685-8140

13. CERTIFICATION: I hereby certify that I or persons under my direct supervision have inspected the proposed drill site and access route, that I am familiar with the conditions which currently exist, that the statements made in this plan are to the best of my knowledge, are true and correct, and that the work associated with the operations proposed herein will be performed by POGO PRODUCING COMPANY it's contractors/subcontractors is in the conformity with this plan and the terms and conditions under which it is approved. This statement is subject to the provision of U.S.C. 1001 for the filing of a false statement.

NAME : Joe T. Janica

DATE : 10/18/05

TITLE : Agent

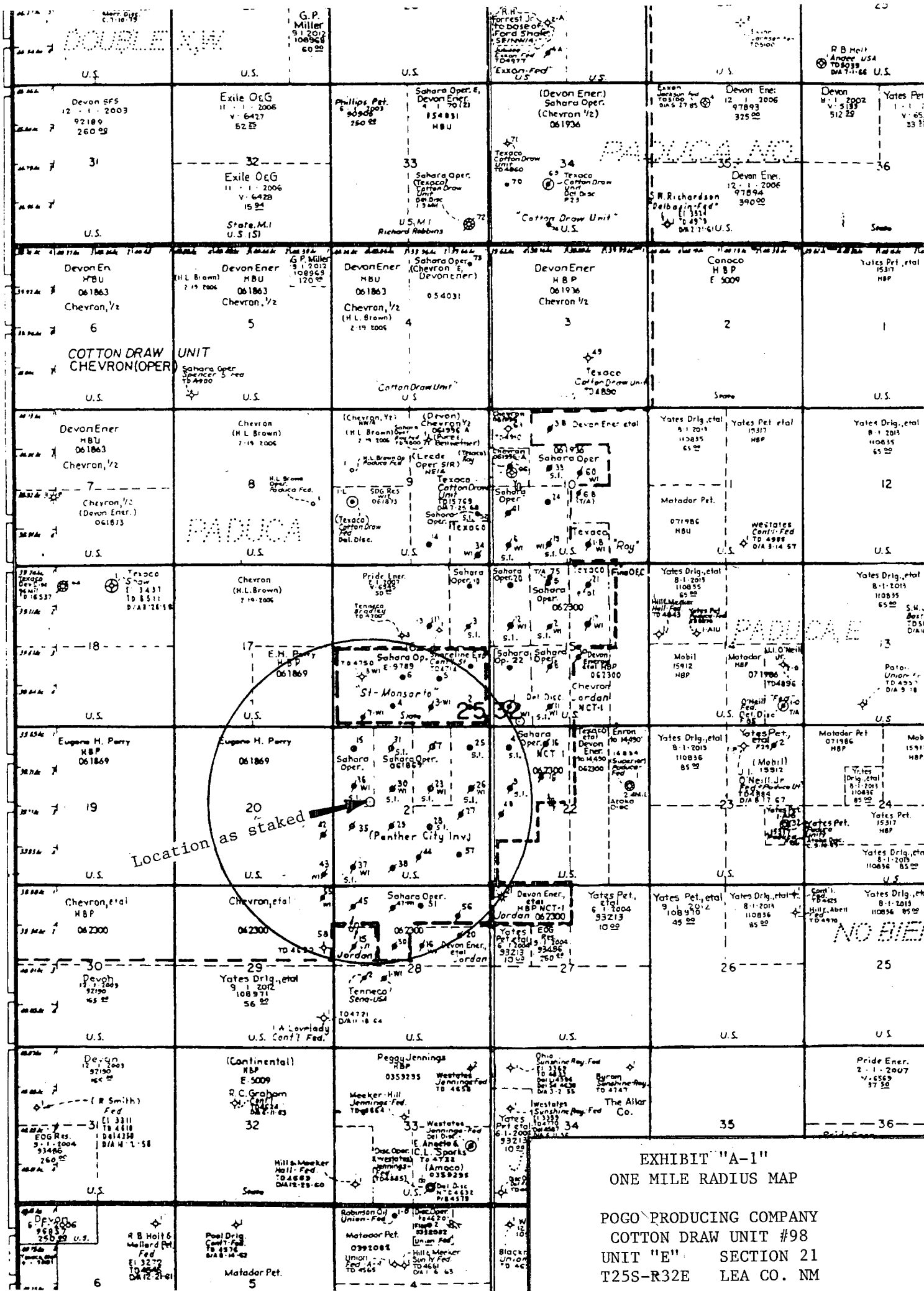

POGO\PRODUCING COMPANY
COTTON DRAW UNIT #98
UNIT "E" SECTION 21
T25S-R32E LEA CO. NM

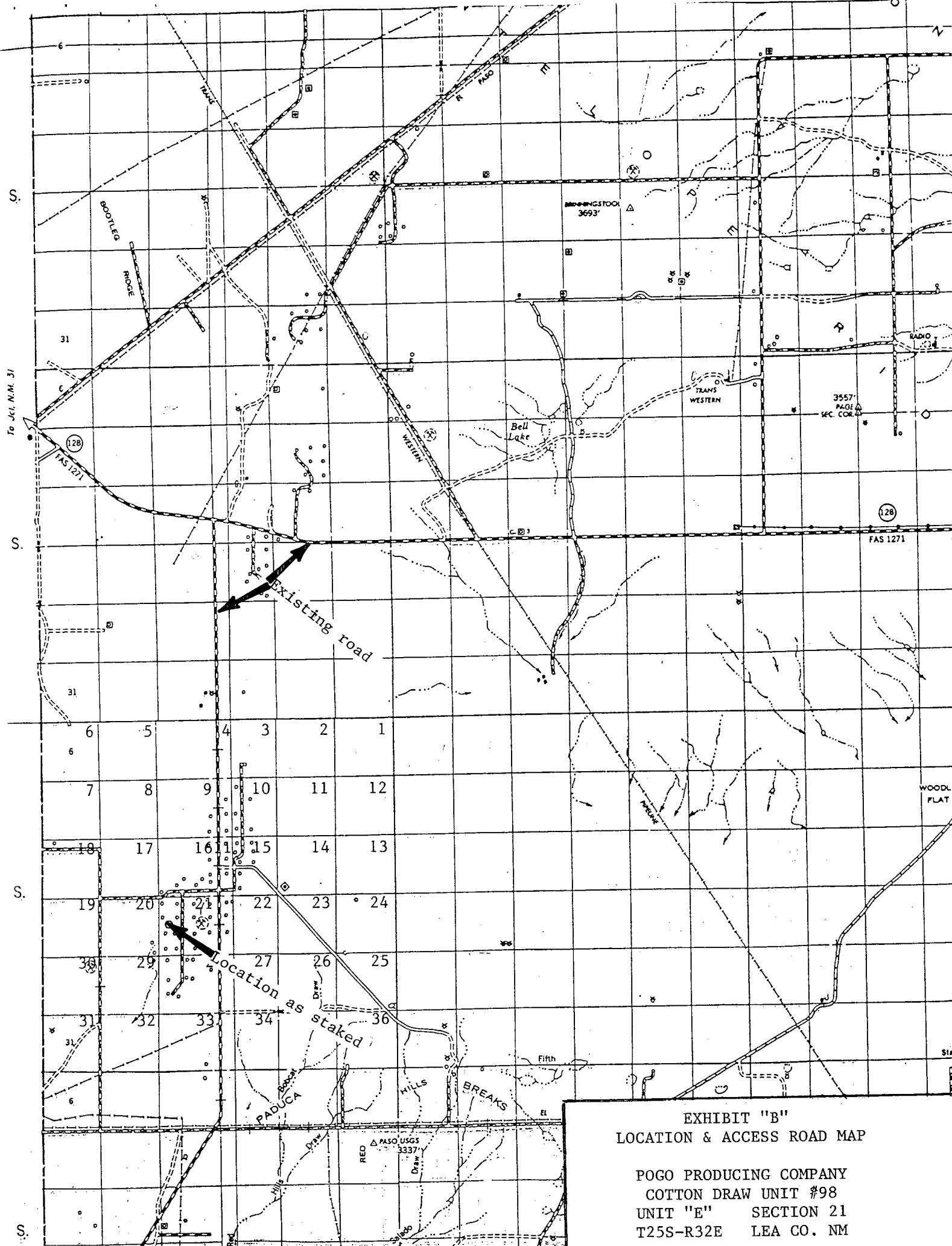

EXHIBIT "B"
LOCATION & ACCESS ROAD MAP

POGO PRODUCING COMPANY
COTTON DRAW UNIT #98
UNIT "E" SECTION 21
T25S-R32E LEA CO. NM

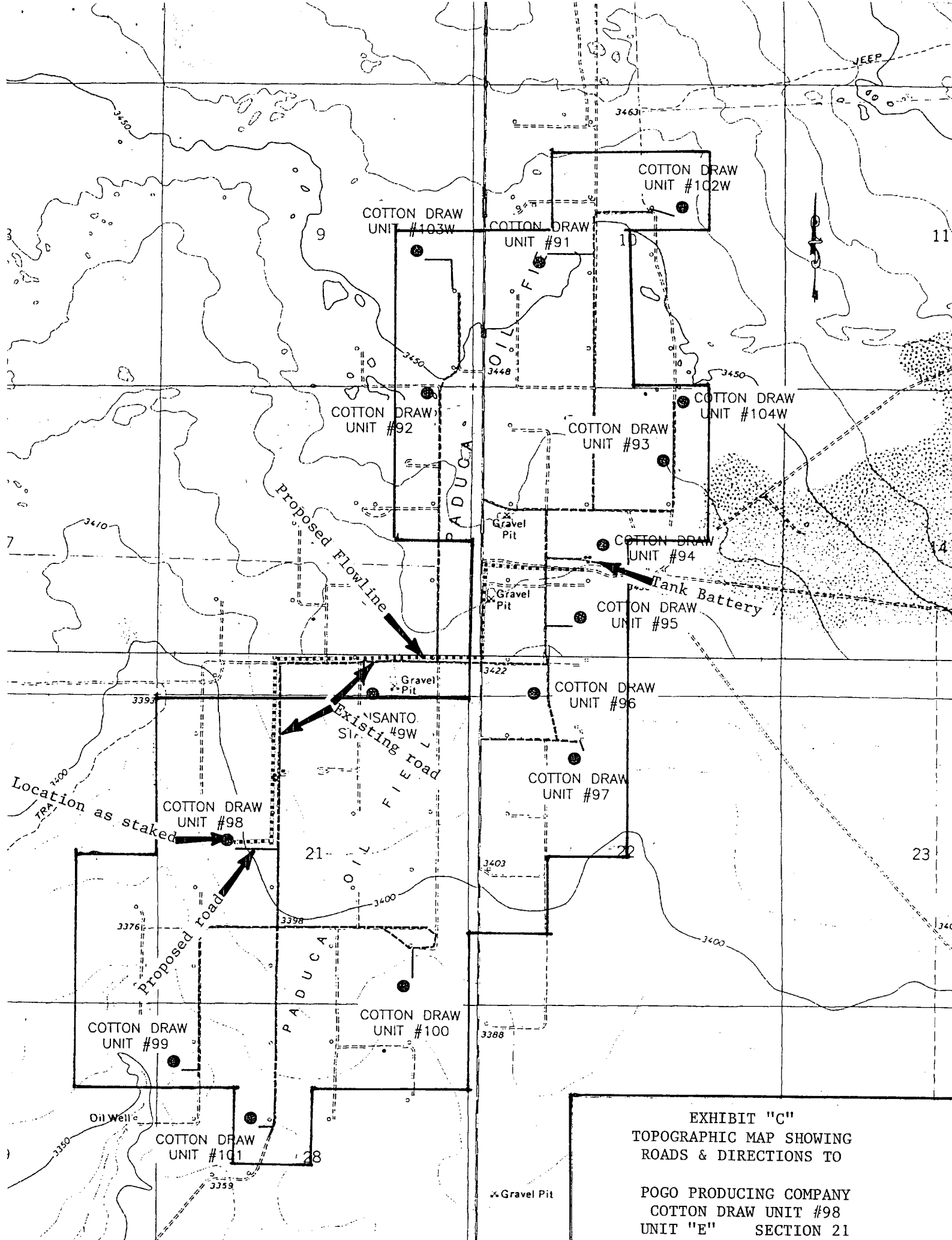
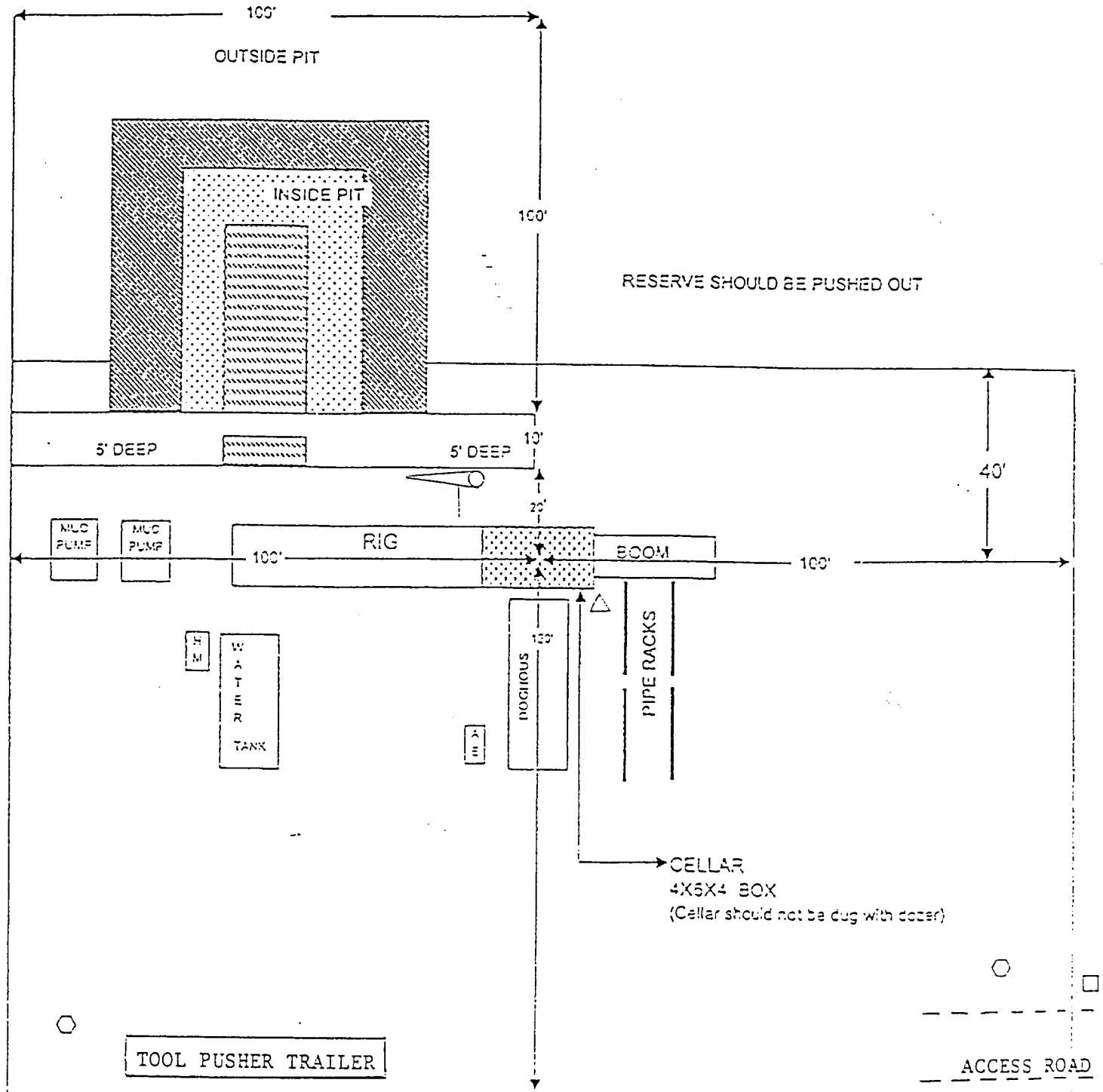

EXHIBIT "C"
TOPOGRAPHIC MAP SHOWING
ROADS & DIRECTIONS TO
POGO PRODUCING COMPANY
COTTON DRAW UNIT #98
UNIT "E" SECTION 21

FOR EARTH PITS



Cellar can be 4X4X4 if using a screw-on wellhead

Working Pits dug 5' below ground level

Wind Direction Indicators
(wind sock or streamers)

H2S Monitors
(alarms at bell nipple and shale shaker)

Briefing Areas
Remote BOP Closing Unit
Sign and Condition Flags

Location Specs

EXHIBIT "D"
RIG LAY OUT PLAT

POGO PRODUCING COMPANY
COTTON DRAW UNIT #98
UNIT "E" SECTION 21
T25S-R32E LEA CO. NM

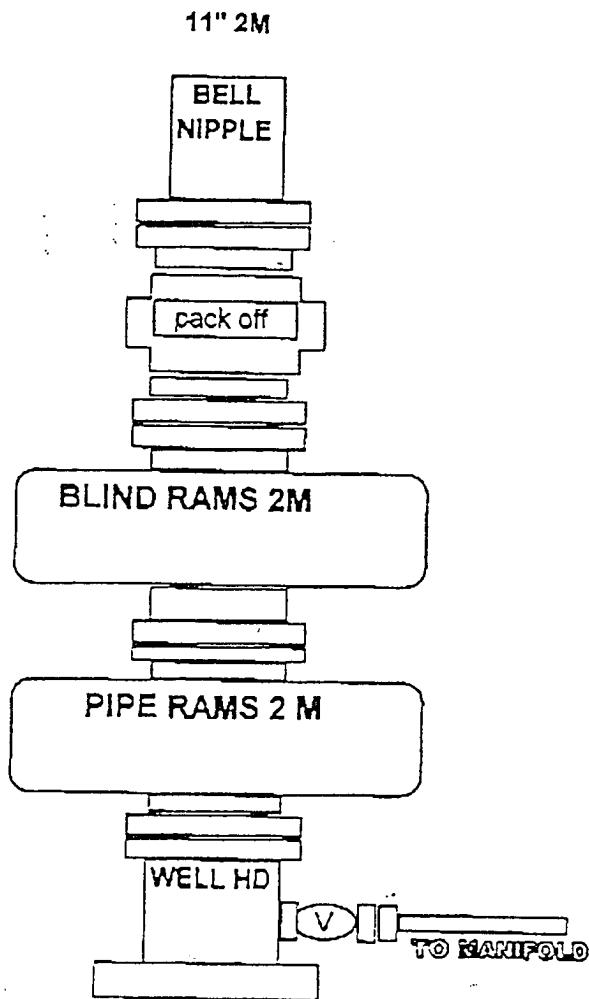

EXHIBIT "E"
SKETCH OF B.O.P. TO BE USED ON

POGO PRODUCING COMPANY
COTTON DRAW UNIT #98
UNIT "E" SECTION 21
T25S-R32E LEA CO. NM

CHOKE MANIFOLD

3000 PSI WP

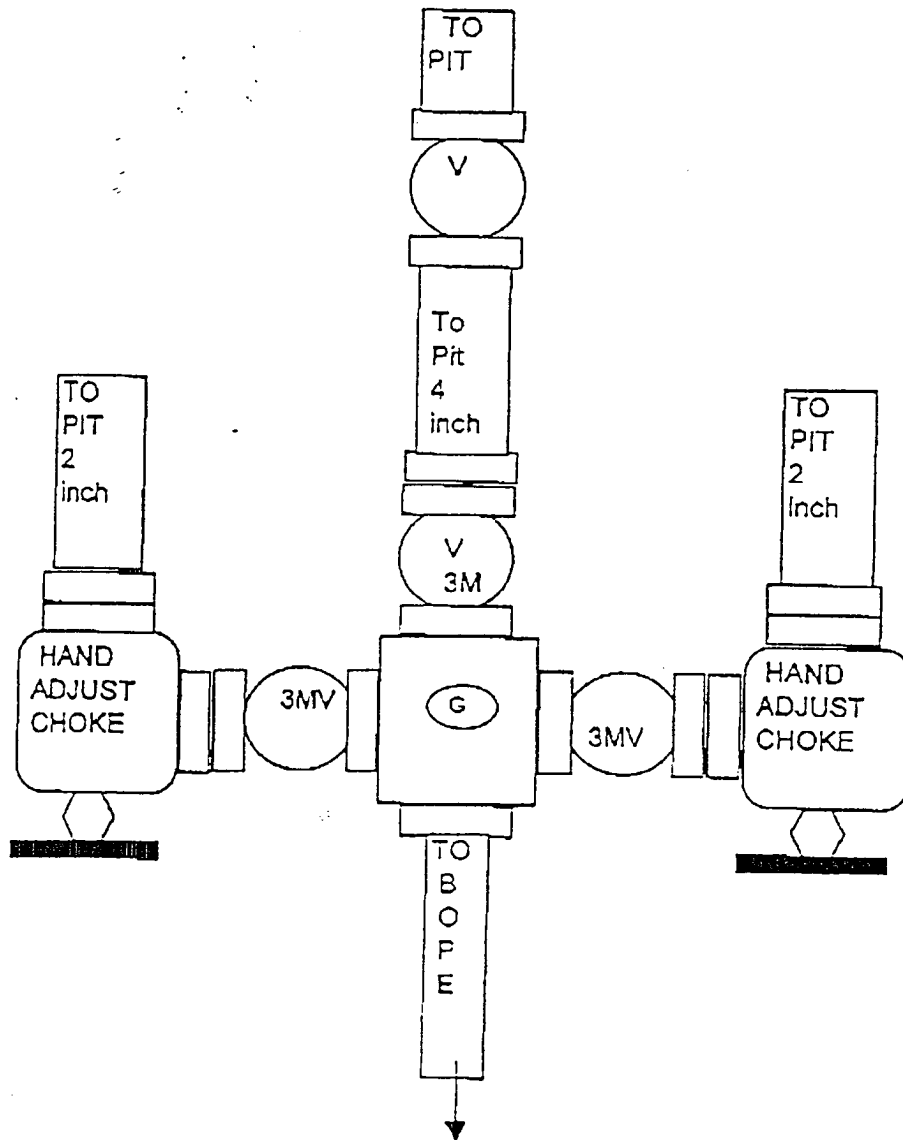

EXHIBIT "E-1"
CHOKE MANIFOLD & CLOSING UNIT

POGO PRODUCING COMPANY
COTTON DRAW UNIT #98
UNIT "E" SECTION 21
T25S-R32E LEA CO. NM

SPECIAL DRILLING STIPULATIONS

THE FOLLOWING DATA IS REQUIRED ON THE WELL SIGN

Operator's Name Pogo Producing Co. Well Name & No. Cotton Draw Unit#96
Location 10 F S L & 1150 F W L Sec. 15, T. 25 S, R. 32 E.
Lease No. LC-062300 County Lea State New Mexico

The Special stipulations check marked below are applicable to the above described well and approval of this application to drill is conditioned upon compliance with such stipulations in addition to the General Requirements. The permittee should be familiar with the General Requirements, a copy of which is available from a Bureau of Land Management office. EACH PERMITTEE HAS THE RIGHT OF ADMINISTRATIVE APPEAL TO THESE STIPULATIONS PURSUANT TO TITLE 43 CRF 3165.3 AND 3165.4.

This permit is valid for a period of one year from the date of approval or until lease expiration or termination whichever is shorter.

I. SPECIAL ENVIRONMENT REQUIREMENTS

- ☐ Lesser Prairie Chicken (stips attached) ☐ Flood plain (stips attached)
☐ San Simon Swale (stips attached) ☐ Other

II. ON LEASE - SURFACE REQUIREMENTS PRIOR TO DRILLING

☒ The BLM will monitor construction of this drill site. Notify the ☒ Carlsbad Field Office at (505) 234-5972 () Hobbs Office (505) 393-3612, at least 3 working days prior to commencing construction.

☒ Roads and the drill pad for this well must be surfaced with 6 inches of compacted caliche.

☐ All topsoil and vegetation encountered during the construction of the drill site area will be stockpiled and made available for resurfacing of the disturbed area after completion of the drilling operation. Topsoil on the subject location is approximately _____ inches in depth. Approximately _____ cubic yards of topsoil material will be stockpiled for reclamation.

☐ Other.

III. WELL COMPLETION REQUIREMENTS

☐ A Communitization Agreement covering the acreage dedicated to the well must be filed for approval with the BLM. The effective date of the agreement must be prior to any sales.

☒ Surface Restoration: If the well is a producer, the reserve pit(s) will be backfilled when dry, and cut-and-fill slopes will be reduced to a slope of 3:1 or less. All areas of the pad not necessary for production must be re-contoured to resemble the original contours of the surrounding terrain, and topsoil must be re-distributed and re-seeded with a drill equipped with a depth indicator (set at depth of ½ inch) with the following seed mixture, in pounds of Pure Live Seed (PLS), per acre.

- | | |
|--|---|
| <input type="checkbox"/> A. Seed Mixture 1 (Loamy Sites)
Side Oats Grama (<i>Bouteloua curtipendula</i>) 5.0
Sand Dropseed (<i>Sporobolus cryptandrus</i>) 1.0 | <input checked="" type="checkbox"/> B. Seed Mixture 2 (Sandy Sites)
Sand Dropseed (<i>Sporobolus cryptandrus</i>) 1.0
Sand Lovegrass (<i>Eragrostis trichodes</i>) 1.0
Plains Bristlegrass (<i>Setaria magrostachya</i>) 2.0 |
| <input type="checkbox"/> C. Seed Mixture 3 (Shallow Sites)
Side oats Grama (<i>Boute curtipendula</i>) 1.0 | <input type="checkbox"/> D. Seed Mixture 4 (Gypsum Sites)
Alkali Sacaton (<i>Sporobollud airoides</i>) 1.0
Four-Wing Saltbush (<i>Atriplex canescens</i>) 5.0 |

☐ OTHER SEE ATTACHED SEED MIXTURE

Seeding should be done either late in the fall (September 15 - November 15, before freeze up, or early as possible the following spring to take advantage of available ground moisture.

☐ Other.

RESERVE PIT CONSTRUCTION STANDARDS

The reserve pit shall be constructed entirely in cut material and lined with 6 mil plastic.

Mineral material extracted during construction of the reserve pit may be used for development of the pad and access road as needed. Removal of any additional material on location must be purchased from BLM.

Reclamation: Reclamation of this type of deep pit will consist of pushing the pit walls into the pit when sufficiently dry to support track equipment. The pit liner is NOT TO BE RUPTURED to facilitate drying; a ten month period after completion of the well is allowed for drying of the pit contents.

The pit area must be contoured to the natural terrain with all contaminated drilling mud buried with at least 3 feet of clean soil. The reclaimed area will then be seeded as specified in this permit.

OPTIONAL PIT CONSTRUCTION STANDARDS

The reserve pit may be constructed in predominantly fill material if:

- (1) Lined as specified above and
- (2) A borrow/caliche/gravel pit can be constructed immediately adjacent to the reserve pit and it capable of containing all reserve pit contents. The mineral material removed in the process can be used for pad and access road construction. However, a material sales contract must be purchased from the BLM prior to removal of the material.

Reclamation of the reserve pit consists of bulldozing all reserve pit contents and contaminants into the borrow pit and covering with a minimum of 3 feet of clean soil material. The entire area must be recontoured, all trash removed, and reseeded as specified in this permit.

CULTURAL

Whether or not an archaeological survey has been completed and notwithstanding that operations are being conducted as approved, the lessee/operator/grantee shall notify the BLM immediately if previously unidentified cultural resources are observed during surface disturbing operations. From the time of the observation, the lessee/operator/grantee shall avoid operations that will result in disturbance to these cultural resources until directed to processed by BLM.

TRASH PIT STIPS

All trash, junk, and other waste material shall be contained in trash cages or bins to prevent scattering and will be removed and deposited in an approved sanitary landfill. Burial on site is not permitted.

CONDITIONS OF APPROVAL - DRILLING

Operator's Name: POGO Producing Company
Well Name & No: Cotton Draw Unit No. 096
Location: Surface: 10' FSL & 1150' FWL, Sec.15, T. 25 S., R. 32 E.
Lease: NMLC 062300
Lea County, New Mexico

.....

I. DRILLING OPERATIONS REQUIREMENTS:

1. The Bureau of Land Management (BLM) is to be notified at the Roswell Field Office, 2909 West Second St., Roswell, NM 88201, (505) 627-0272 for wells in Chaves and Roosevelt Counties; the Carlsbad Field Office, 620 East Greene St., Carlsbad, NM 88220, (505) 361-2822 for wells in Eddy County; and the Hobbs Field Station, 414 West Taylor, Hobbs NM 88240, (505) 393-3612 for wells in Lea County, in sufficient time for a representative to witness:
 - A. Spudding
 - B. Cementing casing: 20 inch; 8 5/8 inch; 5 1/2 inch.
 - C. BOP Tests
2. A Hydrogen Sulfide (H₂S) Drilling Plan is not required for this wellbore.
3. Unless the production casing has been run and cemented or the well has been properly plugged, the drilling rig shall not be removed from over the hole without prior approval.
4. Submit a Sundry Notice (Form 3160-5, one original and five copies) for each casing string, describing the casing and cementing operations. Include pertinent information such as; spud date, hole size, casing (size, weight, grade and thread type), cement (type, quantity and top), water zones and problems or hazards encountered. The Sundry shall be submitted within 15 days of completion of each casing string. The reports may be combined into the same Sundry if they fall within the same 15 day time frame.
5. The API No. assigned to the well by NMOCD shall be included on the subsequent report of setting the first casing string.

II. CASING:

1. The 8 5/8 inch shall be set at 815 Feet with cement circulated to the surface. If cement does not circulate to the surface the appropriate BLM office shall be notified and a temperature survey or cement bond log shall be run to verify the top of the cement. Remedial cementing shall be completed prior to drilling out that string.
2. The minimum required fill of cement behind the 5 1/2 inch Production casing is to circulate to surface.

III. PRESSURE CONTROL:

1. All BOP systems and related equipment shall comply with well control requirements as described in Onshore Oil and Gas Order No. 2. The BOP and related equipment shall be installed and operational before drilling below the 8 5/8 inch casing shoe and shall be tested as described in Onshore Order No. 2. Any equipment failing to test satisfactorily shall be repaired or replaced.
2. Minimum working pressure of the blowout preventer and related equipment (BOPE) shall be 2 M psi.

III. Pressure Control (continued):

3. The appropriate BLM office shall be notified in sufficient time for a representative to witness the test.

- The test shall be done by an independent service company
- The results of the test shall be reported to the appropriate BLM office.
- Testing fluid must be water or an appropriate clear liquid suitable for sub-freezing temperatures.
- Use of drilling mud for testing is not permitted since it can mask small leaks.
- Testing must be done in safe workman-like manner. Hard line connections shall be required.
- Both low pressure and high pressure testing of BOPE is required.

G Gourley 10/26/05

BLM Serial Number: LC-062300
Company Reference: Pogo Producing Co.
Well No. & Name: Cotton Draw Unit #96

STANDARD STIPULATIONS FOR PERMANENT RESOURCE ROADS
CARLSBAD FIELD OFFICE

A copy of the grant and attachments, including stipulations, survey plat and/or map, will be on location during construction. BLM personnel may request to you a copy of your permit during construction to ensure compliance with all stipulations.

The holder/grantee/permittee shall hereafter be identified as the holder in these stipulations. The Authorized Officer is the person who approves the Application for Permit to Drill (APD) and/or Right-of-Way (ROW).

GENERAL REQUIREMENTS

A. The holder shall indemnify the United States against any liability for damage to life or property arising from the occupancy or use of public lands under this grant.

B. The holder shall comply with all applicable Federal laws and regulations existing or hereafter enacted or promulgated. In any event, the holder shall comply with the Toxic Substances Control Act of 1976, as amended (15 U.S.C. 2601, *et. seq.*) with regard to any toxic substances that are used, generated by or stored on the right-of-way or on facilities authorized by this grant. (See 40 CFR, Part 702-799 and especially, provisions on polychlorinated biphenyls, 40 CFR 761.1-761.193.) Additionally, any release of toxic substances (leaks, spills, etc.) in excess of the reportable quantity established by 40 CFR, Part 117 shall be reported as required by the Comprehensive Environmental Response, Compensation and Liability Act, Section 102b. A copy of any report required or requested by any Federal agency or State government as a result of a reportable release or spill of any toxic substances shall be furnished to the Authorized Officer concurrent with the filing of the reports to the involved Federal agency or State government.

C. The holder agrees to indemnify the United States against any liability arising from the release of any hazardous substance or hazardous waste (as these terms are defined in the Comprehensive Environmental Response, Compensation and Liability Act of 1980, 42 U.S.C. 9601, *et. seq.* or the Resource Conservation and Recovery Act, 42 U.S.C. 6901, *et. seq.*) on the right-of-way (unless the release or threatened release is wholly unrelated to the right-of-way holder's activity on the right-of-way). This agreement applies without regard to whether a release is caused by the holder, its agent, or unrelated third parties.

D. If, during any phase of the construction, operation, maintenance, or termination of the road, any oil or other pollutant should be discharged, impacting Federal lands, the control and total removal, disposal, and cleaning up of such oil or other pollutant, wherever found, shall be the responsibility of the holder, regardless of fault. Upon failure of the holder to control, dispose of, or clean up such discharge on or affecting Federal lands, or to repair all damages to Federal lands resulting there from, the Authorized Officer may take such measures as deemed necessary to control and cleanup the discharge and restore the area, including, where appropriate, the aquatic environment and fish and wildlife habitats, at the full expense of the holder. Such action by the Authorized Officer shall not relieve the holder of any liability or responsibility.

E. The holder shall minimize disturbance to existing fences and other improvements on public domain surface. The holder is required to promptly repair improvements to at least their former state. Functional use of these improvements will be maintained at all times.

The holder will make a documented good-faith effort to contact the owner of any improvements prior to disturbing them. When necessary to pass through a fence line, the fence shall be braced on both sides of the passageway prior to cutting of the fence.

F. The Holder shall ensure that the entire right-of-way, including the driving surface, ditching and drainage control structures, road verges and any construction sites or zones, will be kept free of the following plant species: Malta starthistle, African rue, Scotch thistle and salt cedar.

Holder agrees to comply with the following stipulations:

1. ROAD WIDTH AND GRADE

The road will have a driving surface of 14 feet (all roads shall have a minimum driving surface of 12 feet, unless local conditions dictate a different width). The maximum grade is 10 percent unless the box below is checked. Maximum width of surface disturbance from construction will be 30 feet.

☐ Those segments of road where grade is in excess of 10% for more than 300 feet shall be designed by a professional engineer.

2. CROWNING AND DITCHING

Crowning with materials on site and ditching on one side of the road on the uphill side will be required. The road cross-section will conform to the cross section diagrams in Figure 1. If conditions dictate, ditching may be required for both sides of the road; if local conditions permit, a flat-bladed road may be considered (if these conditions exist, check the appropriate box below). The crown shall have a grade of approximately 2% (i.e., 1" crown on a 12' wide road).

☒ Ditching will be required on both sides of the roadway as shown on the attached map or as staked in the field.

☐ Flat-blading is authorized on segment(s) delineated on the attached map.

3. DRAINAGE

Drainage control shall be ensured over the entire road through the use of borrow ditches, outsloping, insloping, natural rolling topography, lead-off (turnout) ditches, culverts, and/or drainage dips.

A. All lead-off ditches shall be graded to drain water with a 1 percent minimum to 3 percent maximum ditch slope. The spacing interval for lead-off ditches shall be determined according to the following table, but may be amended depending upon existing soil types and centerline road slope (in %):

SPACING INTERVAL FOR TURNOUT DITCHES

Percent slope	Spacing interval
0% - 4%	400' - 150'
4% - 6%	250' - 125'
6% - 8%	200' - 100'
8% - 10%	150' - 75'

A typical lead-off ditch has a minimum depth of 1 foot below and a berm 6 inches above natural ground level. The berm will be on the down-slope side of the lead-off ditch. The ditch end will tie into vegetation whenever possible.

For this road the spacing interval for lead-off ditches shall be at

☒ 400 foot intervals.

☐ _____ foot intervals.

☐ locations staked in the field as per spacing intervals above.

☐ locations delineated on the attached map.

B. Culvert pipes shall be used for cross drains where drainage dips or low water crossings are not feasible. The minimum culvert diameter must be 18 inches. Any culvert pipe installed shall be of sufficient diameter to pass the anticipated flow of water. Culvert location and required diameter are shown on the attached map (Further details can be obtained from the Roswell District Office or the appropriate Resource Area Office).

C. On road slopes exceeding 2%, drainage dips shall drain water into an adjacent lead-off ditch. Drainage dip location and spacing shall be determined by the formula:

$$\text{spacing interval} = \frac{400'}{\text{road slope in \%}} + 100'$$

Example: 4% slope: spacing interval = $\frac{400}{4} + 100 = 200$ feet

4. TURNOUTS

Unless otherwise approved by the Authorized Officer, vehicle turnouts will be required. Turnouts will be located at 2000-foot intervals, or the turnouts will be intervisible, whichever is less. Turnouts will conform to the following diagram:

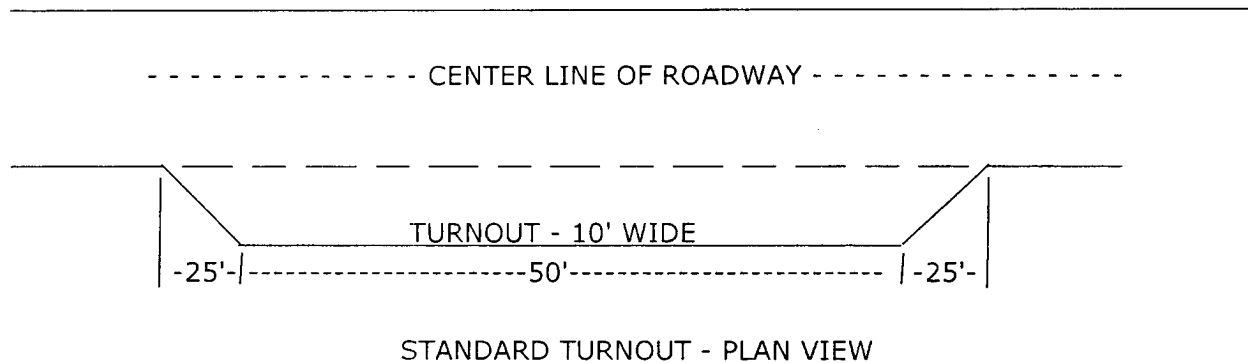

5. SURFACING

Surfacing of the road or those portions identified on the attached map may, at the direction of the Authorized Officer, be required, if necessary, to maintain traffic within the right-of-way with caliche, gravel, or other surfacing material which shall be approved by the Authorized Officer. When surfacing is required, surfacing materials will be compacted to a minimum thickness of six inches with caliche material. The width of surfacing shall be no less than the driving surface. Prior to using any mineral materials from an existing or proposed Federal source, authorization must be obtained from the Authorized Officer.

A sales contract for the removal of mineral materials (caliche, sand, gravel, fill dirt, etc.) from an authorized pit, site, or on location must be obtained from the BLM prior to using any such mineral material from public lands. Contact the BLM solid minerals staff for the various options to purchase mineral material.

6. CATTLEGUARDS

Where used, all cattleguard grids and foundation designs and construction shall meet the American Association of State Highway and Transportation Officials (AASHTO) Load Rating H-20, although AASHTO U-80 rated grids shall be required where heavy loads (exceeding H-20 loading), are anticipated (See BLM standard drawings for cattleguards). Cattleguard grid length shall not be less than 8 feet and width of not less than 14 feet. A wire gate (16-foot minimum width) will be provided on one side of the cattleguard unless requested otherwise by the surface user.

7. MAINTENANCE

The holder shall maintain the road in a safe, usable condition. A maintenance program shall include, but not be limited to blading, ditching, culvert installation, culvert cleaning, drainage installation, cattleguard maintenance, and surfacing.

8. PUBLIC ACCESS

Public access along this road will not be restricted by the holder without specific written approval being granted by the Authorized Officer. Gates or cattleguards on public lands will not be locked or closed to public use unless closure is specifically determined to be necessary and is authorized in writing by the Authorized Officer.

9. CULTURAL RESOURCES

Any cultural and/or paleontological resource (historic or prehistoric site or object) discovered by the holder, or any person working on the holder's behalf, on public or Federal land shall be immediately reported to the authorized officer. The holder shall suspend all operations in the immediate area of such discovery until written authorization to proceed is issued by the authorized officer. An evaluation of the discovery will be made by the authorized officer to determine appropriate actions to prevent the loss of significant cultural or scientific values. The holder will be responsible for the cost of evaluation and any decision as to the proper mitigation measures will be made by the authorized officer after consulting with the holder.

10. SPECIAL STIPULATIONS:

BLM Serial Number: LC-062300
Company Reference: Pogo Producing Co.
Well No. & Name: Cotton Draw Unit #96

STANDARD STIPULATIONS FOR SURFACE INSTALLED PIPELINES

A copy of the grant and attachments, including stipulations, survey plat and/or map, will be on location during construction. BLM personnel may request to you a copy of your permit during construction to ensure compliance with all stipulations.

Holder agrees to comply with the following stipulations to the satisfaction of the Authorized Officer:

1. The holder shall indemnify the United States against any liability for damage to life or property arising from the occupancy or use of public lands under this grant.
2. The holder shall comply with all applicable Federal laws and regulations existing or hereafter enacted or promulgated. In any event, the holder shall comply with the Toxic Substances Control Act of 1976 as amended, 15 USC 2601 et seq. (1982) with regards to any toxic substances that are used, generated by or stored on the right-of-way or on facilities authorized under this right-of-way grant. (See 40 CFR, Part 702-799 and especially, provisions on polychlorinated biphenyls, 40 CFR 761.1-761.193.) Additionally, any release of toxic substances (leaks, spills, etc.) in excess of the reportable quantity established by 40 CFR, Part 117 shall be reported as required by the Comprehensive Environmental Response, Compensation, and Liability Act, section 102b. A copy of any report required or requested by any Federal agency or State government as a result of a reportable release or spill of any toxic substances shall be furnished to the authorized officer concurrent with the filing of the reports to the involved Federal agency or State government.
3. The holder agrees to indemnify the United States against any liability arising from the release of any hazardous substance or hazardous waste (as these terms are defined in the Comprehensive Environmental Response, Compensation and Liability Act of 1980, 42 U.S.C. 9601, et seq. or the Resource Conservation and Recovery Act, 42 U.S.C. 6901, et seq.) on the Right-of-Way (unless the release or threatened release is wholly unrelated to activity of the Right-of-Way holder's activity on the Right-of-Way), or resulting from the activity of the Right-of-Way holder on the Right-of-Way. This agreement applies without regard to whether a release is caused by the holder, its agent, or unrelated third parties.
4. The holder shall be liable for damage or injury to the United States to the extent provided by 43 CFR Sec. 2883.1-4. The holder shall be held to a standard of strict liability for damage or injury to the United States resulting from pipe rupture, fire, or spills caused or substantially aggravated by any of the following within the right-of-way or permit area:
 - a. Activities of the holder including, but not limited to construction, operation, maintenance, and termination of the facility.
 - b. Activities of other parties including, but not limited to:

- (1) Land clearing.
- (2) Earth-disturbing and earth-moving work.
- (3) Blasting.
- (4) Vandalism and sabotage.

c. Acts of God.

The maximum limitation for such strict liability damages shall not exceed one million dollars (\$1,000,000) for any one event, and any liability in excess of such amount shall be determined by the ordinary rules of negligence of the jurisdiction in which the damage or injury occurred.

This section shall not impose strict liability for damage or injury resulting primarily from an act of war or from the negligent acts or omissions of the United States.

5. If, during any phase of the construction, operation, maintenance, or termination of the pipeline, any oil, salt water, or other pollutant should be discharged from the pipeline system, impacting Federal lands, the control and total removal, disposal, and cleaning up of such oil, salt water, or other pollutant, wherever found, shall be the responsibility of the holder, regardless of fault. Upon failure of the holder to control, dispose of, or clean up such discharge on or affecting Federal lands, or to repair all damages resulting there from, on the Federal lands, the Authorized Officer may take such measures as he deems necessary to control and clean up the discharge and restore the area, including, where appropriate, the aquatic environment and fish and wildlife habitats, at the full expense of the holder. Such action by the Authorized Officer shall not relieve the holder of any responsibility as provided herein.

6. All construction and maintenance activity will be confined to the authorized right-of-way width of 10 feet.

7. No blading or clearing of any vegetation will be allowed unless approved in writing by the Authorized Officer.

8. The holder shall install the pipeline on the surface in such a manner that will minimize suspension of the pipeline across low areas in the terrain. In hummocky or dune areas, the pipeline will be "snaked" around hummocks and dunes rather than suspended across these features.

9. The pipeline shall be buried with a minimum of 36 inches under all roads, "two-tracks," and trails. Burial of the pipe will continue for 20 feet on each side of each crossing. The condition of the road, upon completion of construction, shall be returned to at least its former state with no bumps or dips remaining in the road surface.

10. The holder shall minimize disturbance to existing fences and other improvements on public lands. The holder is required to promptly repair improvements to at least their former state. Functional use of these improvements will be maintained at all times. The holder will contact the owner of any improvements prior to disturbing them. When necessary to pass through a

fence line, the fence shall be braced on both sides of the passageway prior to cutting of the fence. No permanent gates will be allowed unless approved by the Authorized Officer.

11. In those areas where erosion control structures are required to stabilize soil conditions, the holder will install such structures as are suitable for the specific soil conditions being encountered and which are in accordance with sound resource management practices.

12. Excluding the pipe, all above-ground structures not subject to safety requirement shall be painted by the holder to blend with the natural color of the landscape. The paint used shall be a color which simulates "Standard Environmental Colors" – **Shale Green**, Munsell Soil Color No. 5Y 4/2; designated by the Rocky Mountain Five State Interagency Committee.

13. The pipeline will be identified by signs at the point of origin and completion of the right-of-way and at all road crossings. At a minimum, signs will state the holder's name, BLM serial number, and the product being transported. Signs will be maintained in a legible condition for the life of the pipeline.

14. The holder shall not use the pipeline route as a road for purposes other than routine maintenance as determined necessary by the Authorized Officer in consultation with the holder. The holder will take whatever steps are necessary to ensure that the pipeline route is not used as a roadway.

15. Any cultural and/or paleontological resource (historic or prehistoric site or object) discovered by the holder, or any person working on his behalf, on public or Federal land shall be immediately reported to the authorized officer. Holder shall suspend all operations in the immediate area of such discovery until written authorization to proceed is issued by the authorized officer. An evaluation of the discovery will be made by the authorized officer to determine appropriate cultural or scientific values. The holder will be responsible for the cost of evaluation and any decision as to proper mitigation measures will be made by the authorized officer after consulting with the holder.

16. Special Stipulations:

(March 1989)

STATEMENT ACCEPTING RESPONSIBILITY FOR OPERATIONS

OPERATOR NAME: POGO PRODUCING COMPANY

ADDRESS: P.O. BOX 10340

CITY, STATE, & ZIP: MIDLAND, TEXAS 79702-7340

The above operator accepts all applicable terms, conditions, stipulations, and restrictions concerning operations conducted on the leased land or portion thereof, as described below.

Lease No: LC-062300

Well name: COTTON DRAW UNIT # 96 10' FSL & 1150' FWL Section 15
T25S-R32E LEA CO. NM.

Legal Description of land: $\frac{W}{2}$ of $NW\frac{1}{4}$ Section 15
 $SW\frac{1}{4}$ $SW\frac{1}{4}$

Bond coverage: NATION WIDE

B.L.M. Bond File No : WYB 000238

Authorized Signature

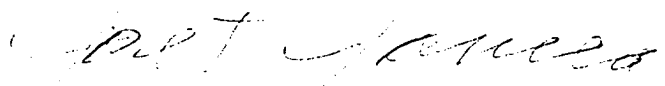
Title: Agent

Date: 12/05/05

District I
1625 N. French Dr., Hobbs, NM 88240
District II
1301 W. Grand Avenue, Artesia, NM 88210
District III
1000 Rio Brazos Road, Aztec, NM 87410
District IV
1220 S. St. Francis Dr., Santa Fe, NM 87505

State of New Mexico
Energy Minerals and Natural Resources

Form C-144
June 1, 2004

Oil Conservation Division
1220 South St. Francis Dr.
Santa Fe, NM 87505

For drilling and production facilities, submit to appropriate NMOCD District Office.
For downstream facilities, submit to Santa Fe office

Pit or Below-Grade Tank Registration or Closure

Is pit or below-grade tank covered by a "general plan"? Yes ☐ No ☒

Type of action: Registration of a pit or below-grade tank ☒ Closure of a pit or below-grade tank ☐

Operator: <u>Pogo Producing Company</u> Telephone: <u>432-685-8100</u> e-mail address: <u>wrightc@pogoproducing.com</u>		
Address: <u>P. O. Box 10340, Midland, TX 79702-7340</u>		
Facility or well name: <u>Cotton Draw Unit #98</u> API #: <u>30-025-37586</u> U/L or Qtr/Qtr <u>/ E</u> Sec <u>21</u> T <u>25S</u> R <u>32E</u>		
County: <u>Lea</u> Latitude <u>32:06:58.34N</u> Longitude <u>103:41:03.03W</u> NAD: 1927 <input type="checkbox"/> 1983 <input type="checkbox"/>		
Surface Owner: Federal <input type="checkbox"/> State <input type="checkbox"/> Private <input type="checkbox"/> Indian <input checked="" type="checkbox"/>		
Pit Type: Drilling <input type="checkbox"/> Production <input checked="" type="checkbox"/> Disposal <input type="checkbox"/> Workover <input type="checkbox"/> Emergency <input type="checkbox"/> Lined <input checked="" type="checkbox"/> Unlined <input type="checkbox"/> Liner type: Synthetic <input checked="" type="checkbox"/> Thickness <u>12</u> mil Clay <input type="checkbox"/> Pit Volume <u>16000</u> bbl	Below-grade tank Volume: _____ bbl Type of fluid: _____ Construction material: _____ Double-walled, with leak detection? Yes <input type="checkbox"/> If not, explain why not. _____	
Depth to ground water (vertical distance from bottom of pit to seasonal high water elevation of ground water.)	Less than 50 feet	(20 points)
	50 feet or more, but less than 100 feet	(10 points)
	100 feet or more X	(0 points) 0
Wellhead protection area: (Less than 200 feet from a private domestic water source, or less than 1000 feet from all other water sources.)	Yes	(20 points)
	No X	(0 points) 0
Distance to surface water: (horizontal distance to all wetlands, playas, irrigation canals, ditches, and perennial and ephemeral watercourses.)	Less than 200 feet	(20 points)
	200 feet or more, but less than 1000 feet	(10 points)
	1000 feet or more X	(0 points) 0
Ranking Score (Total Points)		0

If this is a pit closure: (1) Attach a diagram of the facility showing the pit's relationship to other equipment and tanks. (2) Indicate disposal location: (check the onsite box if you are burying in place) onsite ☐ offsite ☐ If offsite, name of facility _____. (3) Attach a general description of remedial action taken including remediation start date and end date. (4) Groundwater encountered: No ☐ Yes ☐ If yes, show depth below ground surface _____ ft. and attach sample results. (5) Attach soil sample results and a diagram of sample locations and excavations.

Additional Comments:

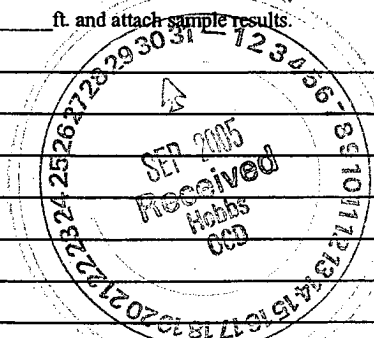

I hereby certify that the information above is true and complete to the best of my knowledge and belief. I further certify that the above-described pit or below-grade tank has been/will be constructed or closed according to NMOCD guidelines ☒, a general permit ☐, or an (attached) alternative OCD-approved plan ☐.

Date: 09/28/05

Printed Name/Title Cathy Wright, Sr. Eng Tech

Signature Cathy Wright

Your certification and NMOCD approval of this application/closure does not relieve the operator of liability should the contents of the pit or tank contaminate ground water or otherwise endanger public health or the environment. Nor does it relieve the operator of its responsibility for compliance with any other federal, state, or local laws and/or regulations.

Approval:

PETROLEUM ENGINEER

Printed Name/Title _____

Signature [Signature]

Date: DEC 09 2005

Water Resources

Data Category:

Site Information

Geographic Area:

New Mexico

GO

Site Map for New Mexico

USGS 321005103402301 24S.32E.33.42241

Available data for this site

site map

GO

Lea County, New Mexico

Hydrologic Unit Code 13070001

Latitude 32°10'05", Longitude 103°40'23" NAD27

Land-surface elevation 3,499.00 feet above sea level NGVD29

The depth of the well is 367 feet below land surface.

This well is completed in the CHINLE FORMATION (231CHNL) local aquifer.

Location of the site in New Mexico.

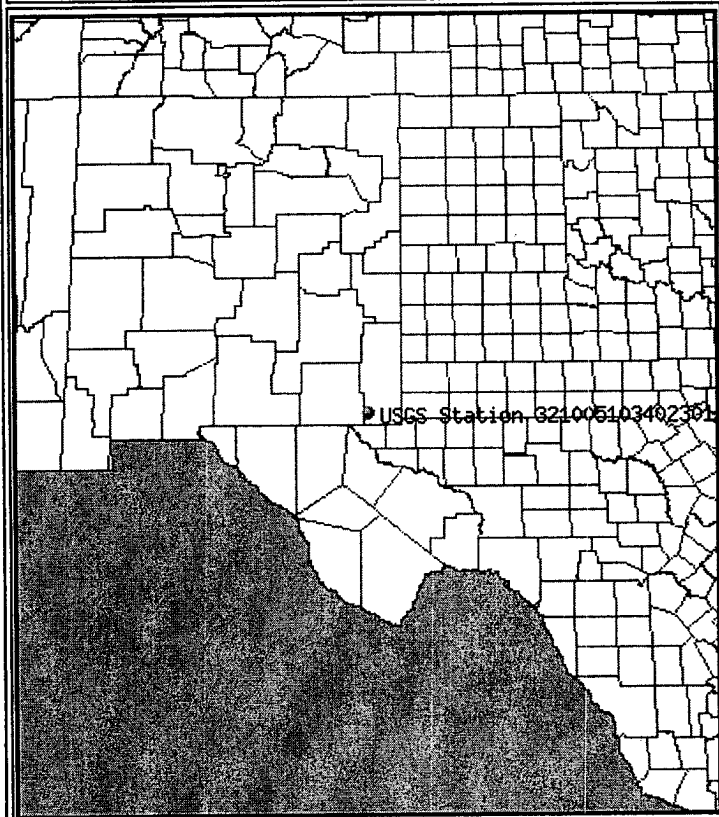

Site map.

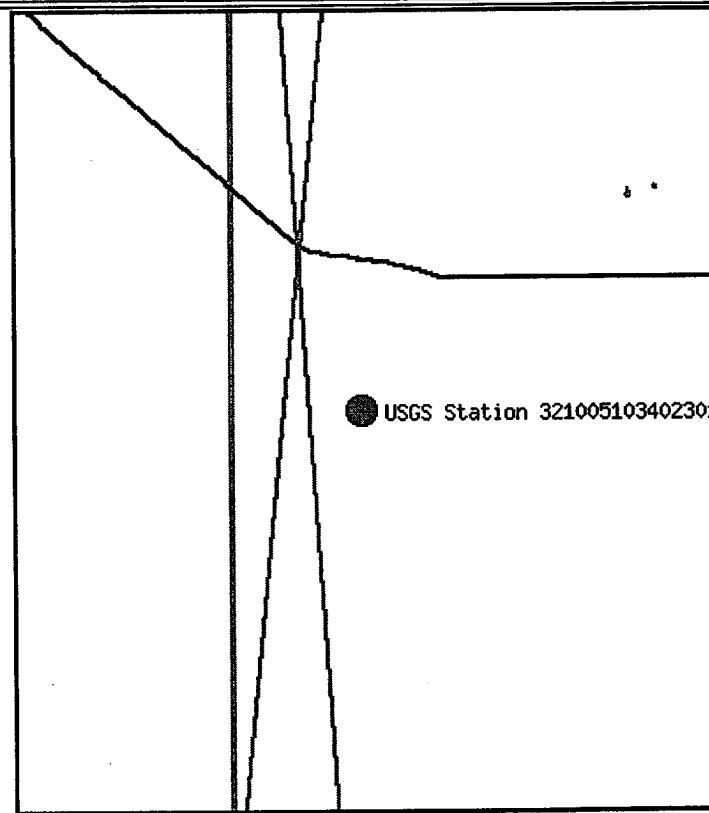

ZOOM IN 2X, 4X, 6X, 8X, or ZOOM OUT 2X, 4X, 6X, 8X.

Maps are generated by US Census Bureau TIGER Mapping Service.

Questions about data [New Mexico NWISWeb Data Inquiries](#)Feedback on this website [New Mexico NWISWeb Maintainer](#)

NWIS Site Inventory for New Mexico: Site Map

<http://waterdata.usgs.gov/nm/nwis/nwismap?>[Top](#)[Explanation of terms](#)

Retrieved on 2005-09-28 11:18:04 EDT

Department of the Interior, U.S. Geological Survey

USGS Water Resources of New Mexico

http://nwis.waterdata.usgs.gov/nm/nwis/nwismap/?site_no=321005103402301

9/28/2005

Water Resources

Data Category:

Ground Water

Geographic Area:

New Mexico

go

Ground-water levels for New Mexico

Search Results -- 1 sites found

Search Criteria

site_no list = • 321005103402301

Save file of selected sites to local disk for future upload

USGS 321005103402301 24S.32E.33.42241

Available data for this site

Ground-water: Levels

GO

Lea County, New Mexico

Hydrologic Unit Code 13070001

Latitude 32°10'05", Longitude 103°40'23" NAD27

Land-surface elevation 3,499.00 feet above sea level NGVD29

The depth of the well is 367 feet below land surface.

This well is completed in the CHINLE FORMATION (231CHNL) local aquifer.

Output formats

[Table of data](#)[Tab-separated data](#)[Graph of data](#)[Reselect period](#)

USGS 321005103402301 24S.32E.33.42241

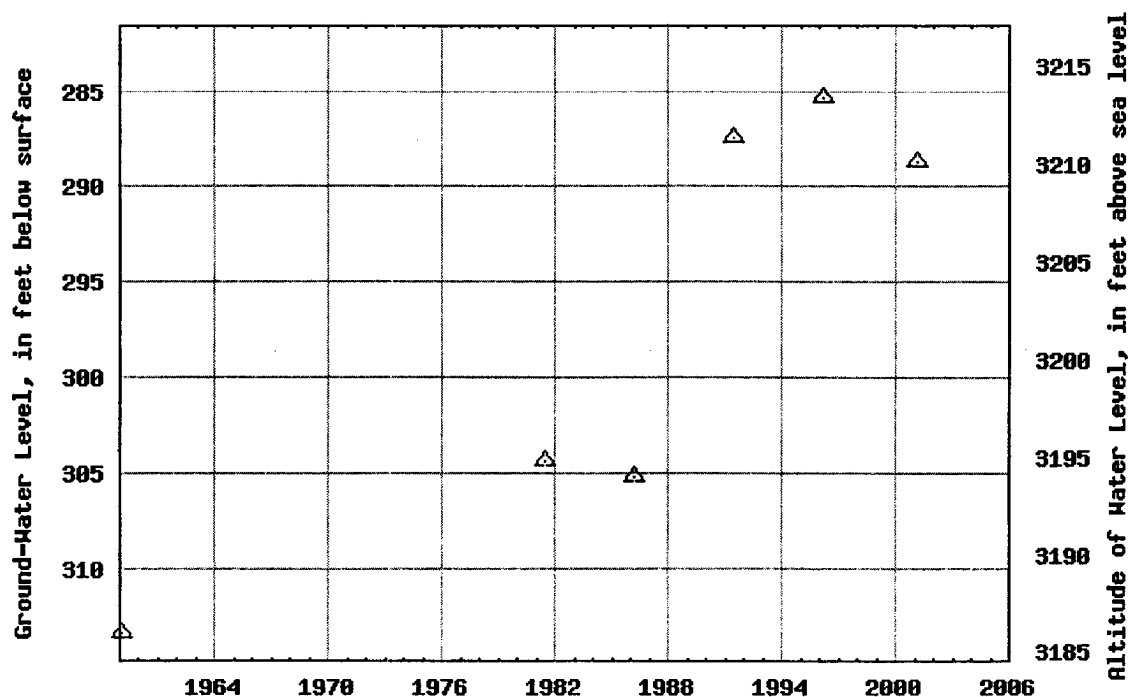

Breaks in the plot represent a gap of at least one calendar year between two consecutive points.

[Download a presentation-quality graph](#)[Questions about data](#) [New Mexico NWISWeb Data Inquiries](#)[Feedback on this website](#) [New Mexico NWISWeb Maintainer](#)[Top](#)
[Explanation of terms](#)

Great Circle Calculator.

By Ed Williams

You need Javascript enabled if you want this page to do anything useful! For Netscape, it's under Options/Network Preferences/Languages.

Compute true course and distance between points.

Enter lat/lon of points, select distance units and earth model and click "compute". Lat/lons may be entered in DD.DD, DD:MM.MM or DD:MM:SS.SS formats.

Note that if either point is very close to a pole, the course may be inaccurate, because of its extreme sensitivity to position and inevitable rounding error.

Input Data

Lat1		Lon1	
32:10:05	N	103:40:23	W
Lat2		Lon2	
32:06:58.34	N	103:41:03.03	W

Output

Course 1-2	Course 2-1	Distance
190.294866	10.2889507	3.161873654

Distance Units: Earth model:

Compute lat/lon given radial and distance from a known point

Enter lat/lon of initial point, true course and distance. Select distance units and earth model and click "compute". Lat/lons may be entered in DD.DD, DD:MM.MM or DD:MM:SS.SS formats.

Note that the starting point cannot be a pole.

Input data

Lat1		Lon1	
0:00.00	N	0:00.00	W
Course 1-2		Distance 1-2	
360		0.0	

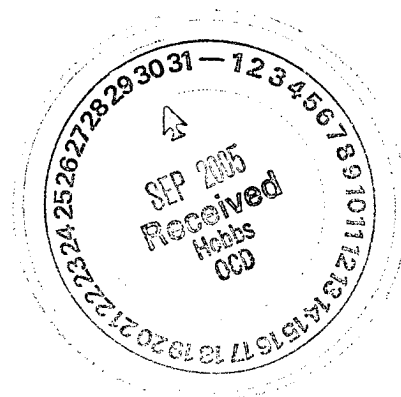

POGO Producing Company **Cotton Draw Unit #98** **Approximate Pit Dimensions**

E/21/25S/32E, Lea County, New Mexico

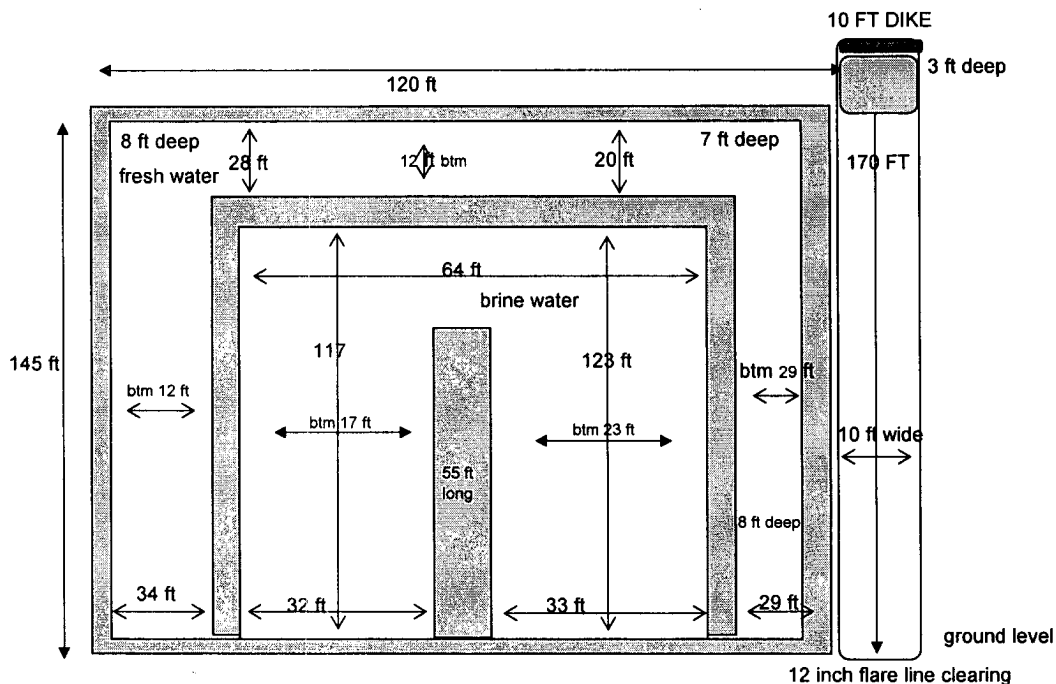

PIT NOTES:

Pit will be lined with 12 mil Black plastic w/ UV protection.

Pit walls are 6 ft to 8 ft wide.

Pit is 8 ft deep below ground level plus 2 ft walls

Pit walls are 2 ft above ground level.

Caliches mined from pit used to make Well Pad.

Fresh Water volume to ground level = \pm 7950 bbls

Brine Water volume to ground level = \pm 7730 bbls

12 inch Flare line laid on gradual descending graded ROW away from rig to avoid fluid trapping

Fresh water well = (Nad 27) 32° 10' 05" N & 103° 40' 23" W "Published data"

This well produces from a depth greater than 100 ft.

Pit equals approx 16000 bbls

