

## Operator Certification

CONOCOPHILLIPS COMPANY

CERTIFICATION:

I hereby certify that I, or persons under my direct supervision, have inspected the proposed drill site and access route proposed herein; that I am familiar with the conditions which currently exist; that I have full knowledge of State and Federal laws applicable to this operation; that the statements made in this APD package are, to the best of my knowledge, true and correct; and that the work associated with the operations proposed herein will be performed in conformity with this APD package and the terms and conditions under which it is approved. I also certify that I, or the company I represent, am responsible for the operations conducted under this application with bond coverage provided by Nationwide Bond ES0085. These statements are subject to the provisions of 18 U.S.C. 1001 for the filing of false statements.



Kristina Mickens  
Regulatory Specialist

Date: 10/16/2013

HOOPER

MAR 28 2016

Attachment # 1



RECEIVED

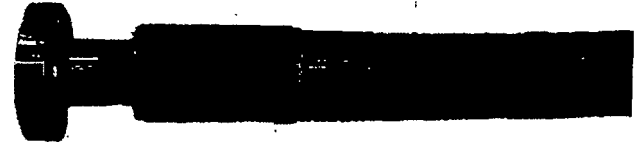

### Reliance Eliminator Choke & Kill

This hose can be used as a choke hose which connects the BOP stack to the bleed-off manifold or a kill hose which connects the mud stand pipe to the BOP kill valve.

The Reliance Eliminator Choke & Kill hose contains a specially bonded compounded cover that replaces rubber covered Asbestos, Fibreglass and other fire retardant materials which are prone to damage. This high cut and gouge resistant cover overcomes costly repairs and downtime associated with older designs.

The Reliance Eliminator Choke & Kill hose has been verified by an independent engineer to meet and exceed EUB Directive 36 (700°C for 5 minutes).

Nom. ID		Nom OD		Weight		Min Bend Radius		Max WP	
in.	mm.	in.	mm	lb/ft	kg/m	in.	mm.	psi	Mpa
3	76.2	5.11	129.79	14.5	21.46	48	1219.2	5000	34.47
3-1/2	88.9	5.79	147.06	20.14	29.80	54	1371.6	5000	34.47



**Fittings**  
 RC4X5055  
 RC3X5055  
 RC4X5575

**Flanges**  
 R35 - 3-1/8 5000# API Type 6B  
 R31 - 3-1/8 3000# API Type 6B

**Hammer Unions**  
 All Union Configurations

**Other**  
 LP Threaded Connectio  
 Graylock  
 Custom Ends



Industrial Products USA, Ltd.

2030 E. 8th Street, Suite B • Greeley, CO 80631  
Ph: (970) 346-3751 • Fax: (970) 353-3168 • Toll Free: (866) 771-9739

**T E S T   C E R T I F I C A T E**

Customer:           PRECISION DRILLING           Cert No.:           27792  
P.O. #:             RIG 822                                 Date:             9/21/2012  
Invoice #:          27792  
Material:          3 1/2" FIREGUARD  
Description:        3 1/2" X 10'  
Coupling 1:        3 1/2" FLANGE R31  
" Serial:  
" Quality:  
Coupling 2:        3 1/2" FLOATING R31  
" Serial:  
" Quality:  
Working Pressure : 3000  
Test Pressure:     7500  
Duration (mins):  10

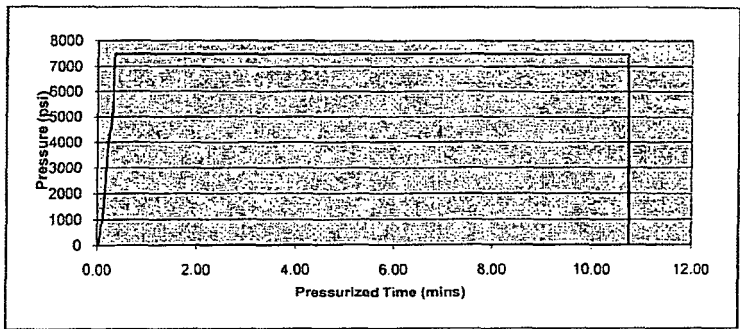
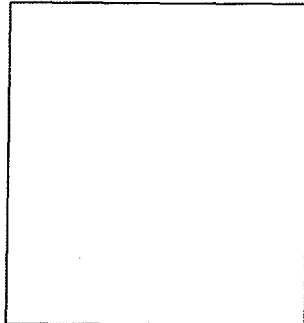

Conducted By:     FLORES M.  
                          Test Technician

- Acceptable
- Not Acceptable



**ConocoPhillips**  
**Well: Britt B Well No. 55**  
**Site: Britt B**  
**Project: Lea County, New Mexico**  
**Design: rev0**  
**Rig:**  
**HOBBS OCD**  
**MAR 28 2016**  
**RECEIVED**

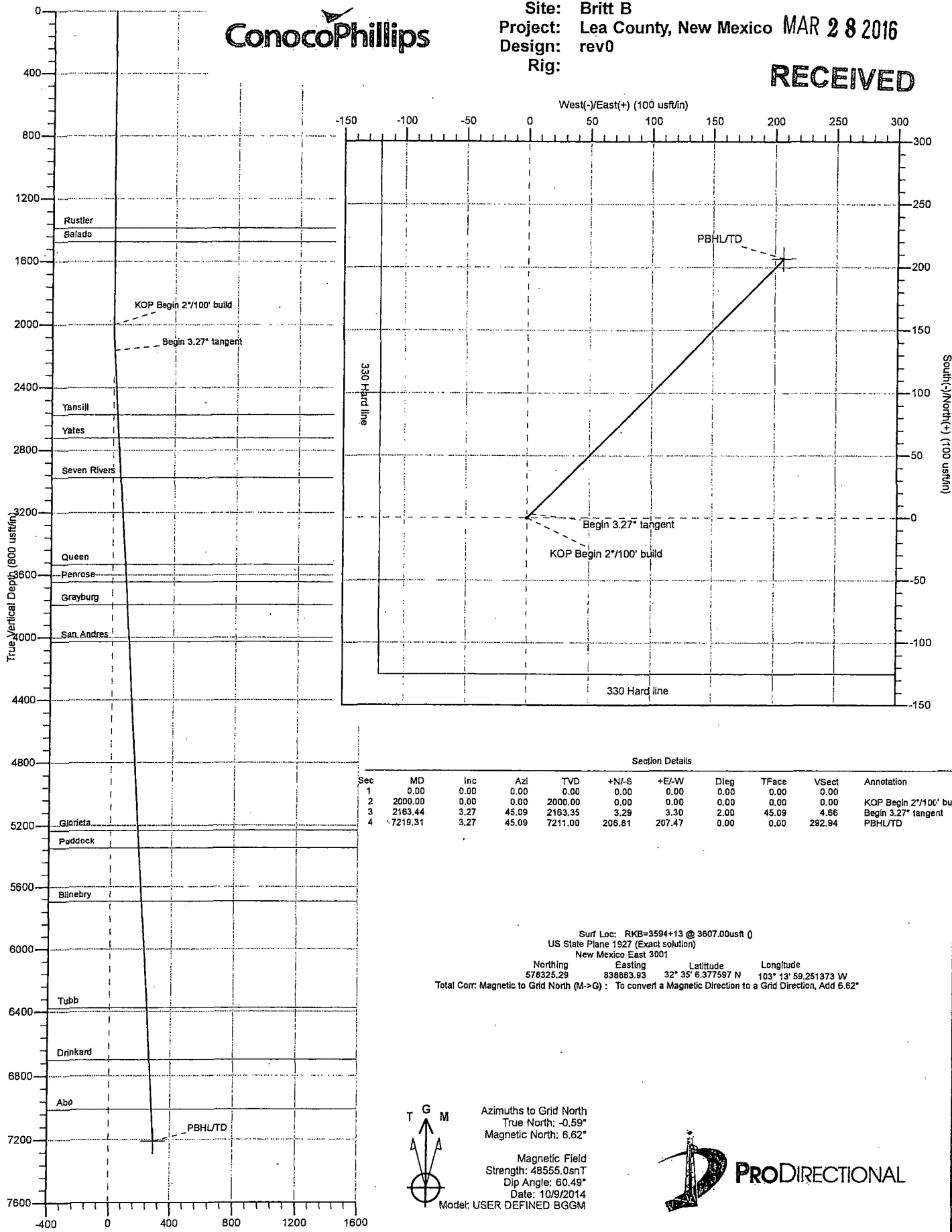

**Section Details**

Sec	MD	Inc	Azi	TVD	+N/-S	+E/-W	Dleg	TFace	VSec	Annotation
1	0.00	0.00	0.00	0.00	0.00	0.00	0.00	0.00	0.00	
2	2000.00	0.00	0.00	2000.00	0.00	0.00	0.00	0.00	0.00	KOP Begin 2°/100' bu
3	2163.44	3.27	45.09	2163.35	3.29	3.30	2.00	45.09	4.66	Begin 3.27° tangent
4	7219.31	3.27	45.09	7211.00	208.81	207.47	0.00	0.00	292.94	PBHL/TD

Surf Loc: RKB=3594+13 @ 3607.00ust 0  
 US State Plane 1927 (Exact solution)  
 New Mexico East 3001  
 Northing: 578325.29    Easting: 838883.93    Latitude: 32° 35' 6.377597 N    Longitude: 103° 13' 59.251373 W  
 Total Corr: Magnetic to Grid North (M->G) : To convert a Magnetic Direction to a Grid Direction, Add 6.62°



Azimuths to Grid North  
 True North: -0.59°  
 Magnetic North: 6.62°

Magnetic Field  
 Strength: 48555.0snT  
 Dip Angle: 60.49°  
 Date: 10/9/2014  
 Model: USER DEFINED BGGM



**PRODIRECTIONAL**

Database:	EDM 5000.1 Database	Local Co-ordinate Reference:	Well Britt B Well No. 55
Company:	ConocoPhillips	TVD Reference:	RKB=3594+13 @ 3607.00usft ()
Project:	Lea County, New Mexico	MD Reference:	RKB=3594+13 @ 3607.00usft ()
Site:	Britt B	North Reference:	Grid
Well:	Britt B Well No. 55	Survey Calculation Method:	Minimum Curvature
Wellbore:	Original Hole		
Design:	rev0		

Project	Lea County, New Mexico		
Map System:	US State Plane 1927 (Exact solution)	System Datum:	Mean Sea Level
Geo Datum:	NAD 1927 (NADCON CONUS)		
Map Zone:	New Mexico East 3001		

Site	Britt B				
Site Position:		Northing:	576,203.96 usft	Latitude:	32° 34' 45.597456 N
From:	Map	Easting:	836,841.94 usft	Longitude:	103° 14' 23.368414 W
Position Uncertainty:	0.00 usft	Slot Radius:	13-3/16 "	Grid Convergence:	0.59 °

Well	Britt B Well No. 55					
Well Position	+N/-S	2,121.33 usft	Northing:	578,325.29 usft	Latitude:	32° 35' 6.377597 N
	+E/-W	2,041.99 usft	Easting:	838,883.92 usft	Longitude:	103° 13' 59.251373 W
Position Uncertainty	0.00 usft		Wellhead Elevation:		Ground Level:	3,594.00 usft

Wellbore	Original Hole				
Magnetics	Model Name	Sample Date	Declination	Dip Angle	Field Strength
	User Defined	10/9/2014	(°) 7.21	(°) 60.49	(nT) 48,555

Design	rev0				
Audit Notes:					
Version:	Phase:	PLAN	Tie On Depth:	0.00	
Vertical Section:	Depth From (TVD)	+N/-S	+E/-W	Direction	
	(usft)	(usft)	(usft)	(°)	
	0.00	0.00	0.00	45.09	

Plan Sections										
Measured	Inclination	Azimuth	Vertical	+N/-S	+E/-W	Dogleg	Build	Turn	TFO	Target
Depth	(°)	(°)	Depth	(usft)	(usft)	Rate	Rate	Rate	(°)	
(usft)			(usft)			(°/100usft)	(°/100usft)	(°/100usft)		
0.00	0.00	0.00	0.00	0.00	0.00	0.00	0.00	0.00	0.00	0.00
2,000.00	0.00	0.00	2,000.00	0.00	0.00	0.00	0.00	0.00	0.00	0.00
2,163.44	3.27	45.09	2,163.35	3.29	3.30	2.00	2.00	27.59	45.09	
7,219.31	3.27	45.09	7,211.00	206.81	207.47	0.00	0.00	0.00	0.00	Britt B #55 PBHL

Database: EDM 5000.1 Ddatabase  
 Company: ConocoPhillips  
 Project: Lea County, New Mexico  
 Site: Britt B  
 Well: Britt B Well No. 55  
 Wellbore: Original Hole  
 Design: rev0

Local Co-ordinate Reference: Well Britt B Well No. 55  
 TVD Reference: RKB=3594+13 @ 3607.00usft ()  
 MD Reference: RKB=3594+13 @ 3607.00usft ()  
 North Reference: Grid  
 Survey Calculation Method: Minimum Curvature

Planned Survey

Measured Depth (usft)	Inclination (°)	Azimuth (°)	Vertical Depth (usft)	+N/-S (usft)	+E/-W (usft)	Vertical Section (usft)	Dogleg Rate (°/100usft)	Build Rate (°/100usft)	Turn Rate (°/100usft)
0.00	0.00	0.00	0.00	0.00	0.00	0.00	0.00	0.00	0.00
100.00	0.00	0.00	100.00	0.00	0.00	0.00	0.00	0.00	0.00
200.00	0.00	0.00	200.00	0.00	0.00	0.00	0.00	0.00	0.00
300.00	0.00	0.00	300.00	0.00	0.00	0.00	0.00	0.00	0.00
400.00	0.00	0.00	400.00	0.00	0.00	0.00	0.00	0.00	0.00
500.00	0.00	0.00	500.00	0.00	0.00	0.00	0.00	0.00	0.00
600.00	0.00	0.00	600.00	0.00	0.00	0.00	0.00	0.00	0.00
700.00	0.00	0.00	700.00	0.00	0.00	0.00	0.00	0.00	0.00
800.00	0.00	0.00	800.00	0.00	0.00	0.00	0.00	0.00	0.00
900.00	0.00	0.00	900.00	0.00	0.00	0.00	0.00	0.00	0.00
1,000.00	0.00	0.00	1,000.00	0.00	0.00	0.00	0.00	0.00	0.00
1,100.00	0.00	0.00	1,100.00	0.00	0.00	0.00	0.00	0.00	0.00
1,200.00	0.00	0.00	1,200.00	0.00	0.00	0.00	0.00	0.00	0.00
1,300.00	0.00	0.00	1,300.00	0.00	0.00	0.00	0.00	0.00	0.00
1,386.00	0.00	0.00	1,386.00	0.00	0.00	0.00	0.00	0.00	0.00
<b>Rustler</b>									
1,400.00	0.00	0.00	1,400.00	0.00	0.00	0.00	0.00	0.00	0.00
1,474.00	0.00	0.00	1,474.00	0.00	0.00	0.00	0.00	0.00	0.00
<b>Salado</b>									
1,500.00	0.00	0.00	1,500.00	0.00	0.00	0.00	0.00	0.00	0.00
1,600.00	0.00	0.00	1,600.00	0.00	0.00	0.00	0.00	0.00	0.00
1,700.00	0.00	0.00	1,700.00	0.00	0.00	0.00	0.00	0.00	0.00
1,800.00	0.00	0.00	1,800.00	0.00	0.00	0.00	0.00	0.00	0.00
1,900.00	0.00	0.00	1,900.00	0.00	0.00	0.00	0.00	0.00	0.00
2,000.00	0.00	0.00	2,000.00	0.00	0.00	0.00	0.00	0.00	0.00
<b>KOP Begin 2°/100' build</b>									
2,100.00	2.00	45.09	2,099.98	1.23	1.24	1.75	2.00	2.00	0.00
2,163.44	3.27	45.09	2,163.35	3.29	3.30	4.66	2.00	2.00	0.00
<b>Begin 3.27° tangent</b>									
2,200.00	3.27	45.09	2,199.85	4.76	4.78	6.75	0.00	0.00	0.00
2,300.00	3.27	45.09	2,299.69	8.79	8.82	12.45	0.00	0.00	0.00
2,400.00	3.27	45.09	2,399.53	12.81	12.85	18.15	0.00	0.00	0.00
2,500.00	3.27	45.09	2,499.36	16.84	16.89	23.85	0.00	0.00	0.00
2,572.75	3.27	45.09	2,572.00	19.77	19.83	28.00	0.00	0.00	0.00
<b>Tansil</b>									
2,600.00	3.27	45.09	2,599.20	20.86	20.93	29.55	0.00	0.00	0.00
2,700.00	3.27	45.09	2,699.04	24.89	24.97	35.26	0.00	0.00	0.00
2,723.00	3.27	45.09	2,722.00	25.82	25.90	36.57	0.00	0.00	0.00
<b>Yates</b>									
2,800.00	3.27	45.09	2,798.88	28.91	29.01	40.96	0.00	0.00	0.00
2,900.00	3.27	45.09	2,898.71	32.94	33.05	46.66	0.00	0.00	0.00
2,978.41	3.27	45.09	2,977.00	36.10	36.21	51.13	0.00	0.00	0.00
<b>Seven Rivers</b>									
3,000.00	3.27	45.09	2,998.55	36.97	37.08	52.36	0.00	0.00	0.00
3,100.00	3.27	45.09	3,098.39	40.99	41.12	58.06	0.00	0.00	0.00
3,200.00	3.27	45.09	3,198.23	45.02	45.16	63.77	0.00	0.00	0.00
3,300.00	3.27	45.09	3,298.06	49.04	49.20	69.47	0.00	0.00	0.00
3,400.00	3.27	45.09	3,397.90	53.07	53.24	75.17	0.00	0.00	0.00
3,500.00	3.27	45.09	3,497.74	57.09	57.28	80.87	0.00	0.00	0.00
3,534.32	3.27	45.09	3,532.00	58.47	58.66	82.83	0.00	0.00	0.00
<b>Queen</b>									
3,600.00	3.27	45.09	3,597.57	61.12	61.31	86.57	0.00	0.00	0.00
3,646.50	3.27	45.09	3,644.00	62.99	63.19	89.22	0.00	0.00	0.00

Database: EDM 5000.1 Ddatabase  
 Company: ConocoPhillips  
 Project: Lea County, New Mexico  
 Site: Britt B  
 Well: Britt B Well No. 55  
 Wellbore: Original Hole  
 Design: rev0

Local Co-ordinate Reference: Well Britt B Well No. 55  
 TVD Reference: RKB=3594+13 @ 3607.00usft ()  
 MD Reference: RKB=3594+13 @ 3607.00usft ()  
 North Reference: Grid  
 Survey Calculation Method: Minimum Curvature

Planned Survey									
Measured Depth (usft)	Inclination (°)	Azimuth (°)	Vertical Depth (usft)	+N-S (usft)	+E-W (usft)	Vertical Section (usft)	Dogleg Rate (°/100usft)	Build Rate (°/100usft)	Turn Rate (°/100usft)
<b>Penrose</b>									
3,700.00	3.27	45.09	3,697.41	65.14	65.35	92.27	0.00	0.00	0.00
3,792.74	3.27	45.09	3,790.00	68.88	69.10	97.56	0.00	0.00	0.00
<b>Grayburg</b>									
3,800.00	3.27	45.09	3,797.25	69.17	69.39	97.98	0.00	0.00	0.00
3,900.00	3.27	45.09	3,897.09	73.19	73.43	103.68	0.00	0.00	0.00
4,000.00	3.27	45.09	3,996.92	77.22	77.47	109.38	0.00	0.00	0.00
4,030.13	3.27	45.09	4,027.00	78.43	78.68	111.10	0.00	0.00	0.00
<b>San Andres</b>									
4,100.00	3.27	45.09	4,096.76	81.25	81.51	115.08	0.00	0.00	0.00
4,200.00	3.27	45.09	4,196.60	85.27	85.54	120.78	0.00	0.00	0.00
4,300.00	3.27	45.09	4,296.44	89.30	89.58	126.49	0.00	0.00	0.00
4,400.00	3.27	45.09	4,396.27	93.32	93.62	132.19	0.00	0.00	0.00
4,500.00	3.27	45.09	4,496.11	97.35	97.66	137.89	0.00	0.00	0.00
4,600.00	3.27	45.09	4,595.95	101.37	101.70	143.59	0.00	0.00	0.00
4,700.00	3.27	45.09	4,695.78	105.40	105.74	149.29	0.00	0.00	0.00
4,800.00	3.27	45.09	4,795.62	109.42	109.77	155.00	0.00	0.00	0.00
4,900.00	3.27	45.09	4,895.46	113.45	113.81	160.70	0.00	0.00	0.00
5,000.00	3.27	45.09	4,995.30	117.47	117.85	166.40	0.00	0.00	0.00
5,100.00	3.27	45.09	5,095.13	121.50	121.89	172.10	0.00	0.00	0.00
5,200.00	3.27	45.09	5,194.97	125.53	125.93	177.80	0.00	0.00	0.00
5,235.09	3.27	45.09	5,230.00	126.94	127.34	179.80	0.00	0.00	0.00
<b>Glorieta</b>									
5,300.00	3.27	45.09	5,294.81	129.55	129.97	183.51	0.00	0.00	0.00
5,356.28	3.27	45.09	5,351.00	131.82	132.24	186.72	0.00	0.00	0.00
<b>Paddock</b>									
5,400.00	3.27	45.09	5,394.65	133.58	134.00	189.21	0.00	0.00	0.00
5,500.00	3.27	45.09	5,494.48	137.60	138.04	194.91	0.00	0.00	0.00
5,600.00	3.27	45.09	5,594.32	141.63	142.08	200.61	0.00	0.00	0.00
5,700.00	3.27	45.09	5,694.16	145.65	146.12	206.31	0.00	0.00	0.00
5,700.84	3.27	45.09	5,695.00	145.69	146.15	206.36	0.00	0.00	0.00
<b>Blinebry</b>									
5,800.00	3.27	45.09	5,794.00	149.68	150.16	212.02	0.00	0.00	0.00
5,900.00	3.27	45.09	5,893.83	153.70	154.20	217.72	0.00	0.00	0.00
6,000.00	3.27	45.09	5,993.67	157.73	158.23	223.42	0.00	0.00	0.00
6,100.00	3.27	45.09	6,093.51	161.75	162.27	229.12	0.00	0.00	0.00
6,200.00	3.27	45.09	6,193.34	165.78	166.31	234.82	0.00	0.00	0.00
6,300.00	3.27	45.09	6,293.18	169.81	170.35	240.53	0.00	0.00	0.00
6,383.96	3.27	45.09	6,377.00	173.19	173.74	245.31	0.00	0.00	0.00
<b>Tubb</b>									
6,400.00	3.27	45.09	6,393.02	173.83	174.39	246.23	0.00	0.00	0.00
6,500.00	3.27	45.09	6,492.86	177.86	178.43	251.93	0.00	0.00	0.00
6,600.00	3.27	45.09	6,592.69	181.88	182.46	257.63	0.00	0.00	0.00
6,700.00	3.27	45.09	6,692.53	185.91	186.50	263.33	0.00	0.00	0.00
6,708.48	3.27	45.09	6,701.00	186.25	186.84	263.82	0.00	0.00	0.00
<b>Drinkard</b>									
6,800.00	3.27	45.09	6,792.37	189.93	190.54	269.04	0.00	0.00	0.00
6,900.00	3.27	45.09	6,892.21	193.96	194.58	274.74	0.00	0.00	0.00
7,000.00	3.27	45.09	6,992.04	197.98	198.62	280.44	0.00	0.00	0.00
7,018.99	3.27	45.09	7,011.00	198.75	199.38	281.52	0.00	0.00	0.00
<b>Abo</b>									
7,100.00	3.27	45.09	7,091.88	202.01	202.66	286.14	0.00	0.00	0.00
7,200.00	3.27	45.09	7,191.72	206.03	206.69	291.84	0.00	0.00	0.00

<b>Database:</b>	EDM 5000.1 Ddatabase	<b>Local Co-ordinate Reference:</b>	Well Britt B Well No. 55
<b>Company:</b>	ConocoPhillips	<b>TVD Reference:</b>	RKB=3594+13 @ 3607.00usft ()
<b>Project:</b>	Lea County, New Mexico	<b>MD Reference:</b>	RKB=3594+13 @ 3607.00usft ()
<b>Site:</b>	Britt B	<b>North Reference:</b>	Grid
<b>Well:</b>	Britt B Well No. 55	<b>Survey Calculation Method:</b>	Minimum Curvature
<b>Wellbore:</b>	Original Hole		
<b>Design:</b>	rev0		

Planned Survey									
Measured Depth (usft)	Inclination (°)	Azimuth (°)	Vertical Depth (usft)	+N/-S (usft)	+E/-W (usft)	Vertical Section (usft)	Dogleg Rate (°/100usft)	Build Rate (°/100usft)	Turn Rate (°/100usft)
7,219.31	3.27	45.09	7,211.00	206.81	207.47	292.94	0.00	0.00	0.00
PBHL/TD									

Design Targets									
Target Name	Dip Angle (°)	Dip Dir. (°)	TVD (usft)	+N/-S (usft)	+E/-W (usft)	Northing (usft)	Easting (usft)	Latitude	Longitude
Britt B #55 PBHL	0.00	0.00	7,211.00	206.81	207.47	578,532.10	839,091.40	32° 35' 8.402553 N	103° 13' 56.801869 W
- hit/miss target									
- Shape									
- plan hits target center									
- Point									

Formations						
Measured Depth (usft)	Vertical Depth (usft)	Name	Lithology	Dip (°)	Dip Direction (°)	
1,386.00	1,386.00	Rustler		0.00		
1,474.00	1,474.00	Salado		0.00		
2,572.75	2,572.00	Tansill		0.00		
2,723.00	2,722.00	Yates		0.00		
2,978.41	2,977.00	Seven Rivers		0.00		
3,534.32	3,532.00	Queen		0.00		
3,646.50	3,644.00	Penrose		0.00		
3,792.74	3,790.00	Grayburg		0.00		
4,030.13	4,027.00	San Andres		0.00		
5,235.09	5,230.00	Glorieta		0.00		
5,356.28	5,351.00	Paddock		0.00		
5,700.84	5,695.00	Blinebry		0.00		
6,383.96	6,377.00	Tubb		0.00		
6,708.48	6,701.00	Drinkard		0.00		
7,018.99	7,011.00	Abo		0.00		