



Occidental Permian Limited Partnership

June 26, 2007

New Mexico Oil Conservation Division
District I
1625 N. French Drive
Hobbs, New Mexico 88240

Attn: Environmental Engineering

RE: Drilling Pit Closure Plan
North Hobbs Unit 13-645 Drilling Pit
API#30-025-38518
UL 'P', Sec. 13, T-18-S, R-37-E

This letter is being sent as final notification of pit closure for the drilling pit at the above mentioned location. This pit will be closed as follows:

1. All drill cuttings and liner were removed from pit area.
2. All cuttings were disposed of at Sundance Services, Parabo Facility near Eunice, New Mexico.
3. A five spot composite sample was taken in the area below the pit liner.
4. A 2' clay liner will be placed in the bottom of the pit before back filling.
5. Native soils, stored on site, will be used for backfill of the area.
6. Work should be completed by the end of July 2007.

If you have any questions, or if I can be of further assistance, please contact me at (505) 397-8251.

A handwritten signature in black ink that reads "Steven M. Bishop". The signature is fluid and cursive, with the first name "Steven" being the most prominent.

Steven M. Bishop
HES Technician/WSAH RMT
Steven_Bishop@oxy.com
(505) 397-8251

Attachments: Final Form C-144
Diagram of pit and well location
Cardinal Lab analysis dated 04/25/07 showing initial chloride and BTEX non-detect
Cardinal Lab analysis dated 05/09/07 showing TPH non-detect
Cardinal Lab analysis dated 06/25/07 showing final chloride

District I
1625 N French Dr., Hobbs, NM 88240
District II
1301 W Grand Avenue, Artesia, NM 88210
District III
1000 Rio Brazos Road, Aztec, NM 87410
District IV
1220 S St Francis Dr, Santa Fe, NM 87505

State of New Mexico
Energy Minerals and Natural Resources

Oil Conservation Division
1220 South St. Francis Dr.
Santa Fe, NM 87505

Form C-144
March 12, 2004

For drilling and production facilities, submit to appropriate NMOCD District Office.
For downstream facilities, submit to Santa Fe office

Pit or Below-Grade Tank Registration or Closure

Is pit or below-grade tank covered by a "general plan"? Yes ☐ No ☒

Type of action: Registration of a pit or below-grade tank ☐ Closure of a pit or below-grade tank ☒

Operator: Occidental Permian LTD Telephone: 505.397 8251 e-mail address: Steven_Bishop@oxy.com

Address 1017 W Stanolind Road Hobbs, NM 88240

Facility or well name: NHU 13-645 API # 30-025-38518 U/L or Qtr/Qtr P SE-SE Sec 13 T 18 S R 37 E

County: Lea Latitude 32°44'31 94" N Longitude 103°11'56 95" W NAD: 1927 ☒ 1983 ☐ Surface Owner Federal ☐ State ☐ Private ☒ Indian ☐

Pit

Type: Drilling ☒ Production ☐ Disposal ☐

Workover ☐ Emergency ☐

Lined ☒ Unlined ☐

Liner type Synthetic ☒ Thickness 12 mil Clay ☐

8000 bbl

Below-grade tank

Volume: bbl Type of fluid

Construction material:

Double-walled, with leak detection? Yes ☐ If not, explain why not.

Depth to ground water (vertical distance from bottom of pit to seasonal high water elevation of ground water.)

Less than 50 feet

(20 points) 20

50 feet or more, but less than 100 feet

(10 points)

100 feet or more

(0 points)

Wellhead protection area (Less than 200 feet from a private domestic water source, or less than 1000 feet from all other water sources)

Yes

(20 points)

No

(0 points) 0

Distance to surface water (horizontal distance to all wetlands, playas, irrigation canals, ditches, and perennial and ephemeral watercourses)

Less than 200 feet

(20 points)

200 feet or more, but less than 1000 feet

(10 points)

1000 feet or more

(0 points) 0

Ranking Score (Total Points)

20

If this is a pit closure: (1) attach a diagram of the facility showing the pit's relationship to other equipment and tanks (2) Indicate disposal location

onsite ☐ offsite ☒ If offsite, name of facility Sundance Services, Parabo Facility. (3) Attach a general description of remedial action taken including remediation start date and end date (4) Groundwater encountered: No ☒ Yes ☐ If yes, show depth below ground surface ft. and attach sample results (5) Attach soil sample results and a diagram of sample locations and excavations.

I hereby certify that the information above is true and complete to the best of my knowledge and belief. I further certify that the above-described pit or below-grade tank has been/will be constructed or closed according to NMOCD guidelines ☒, a general permit ☐, or an (attached) alternative OCD-approved plan ☐.

Date: June 26, 2007

Printed Name/Title Steven M. Bishop /HES Tech.

Signature

Steven M. Bishop

Your certification and NMOCD approval of this application/closure does not relieve the operator of liability should the contents of the pit or tank contaminate ground water or otherwise endanger public health or the environment Nor does it relieve the operator of its responsibility for compliance with any other federal, state, or local laws and/or regulations

Approval.

Date: 6/26/07

Printed Name/Title CHRIS WILLIAMS /DIST. SUPV.

Signature

Chris Williams

North Hobbs Unit #13-645

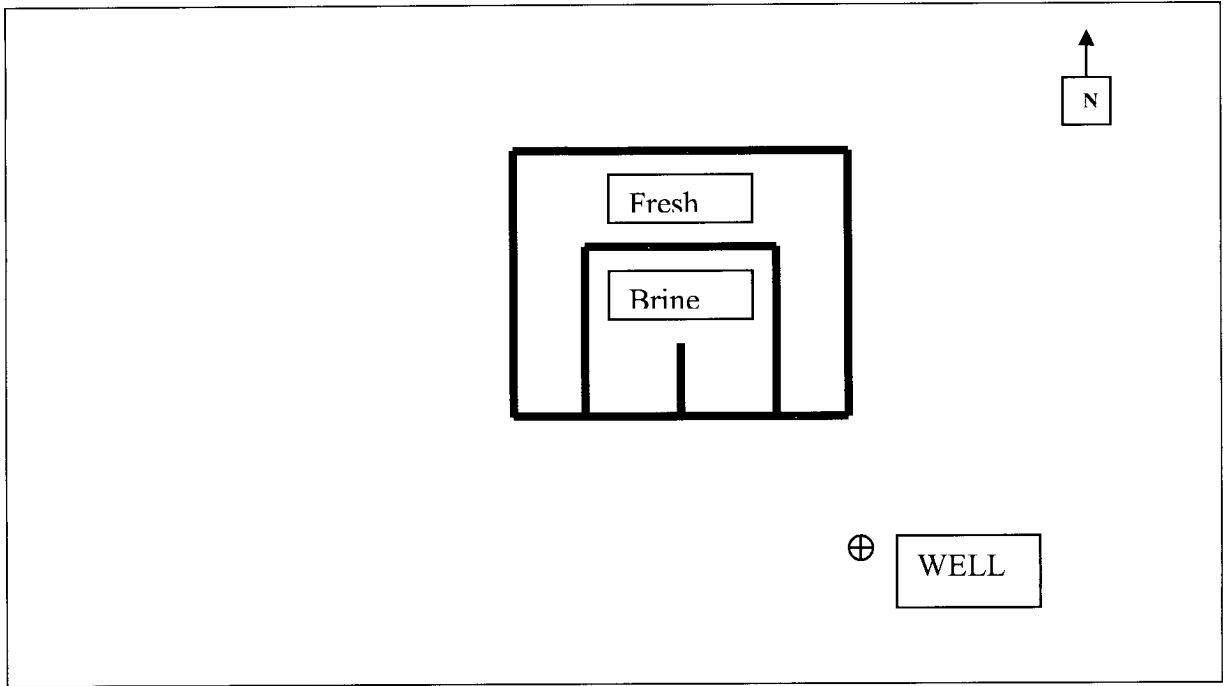

Occidental Permian Ltd.

North Hobbs Unit #13-645

API # 30-025-38518

Unit Letter P, Section 13, T-18-S, R-37-E

N 32°44'31.94", W103°11'56.95"

100' X 100' Pit approximately 50' north of wellhead



PHONE (325) 873-7001 • 2111 BEECHWOOD • ABILENE, TX 79603

PHONE (505) 393-2326 • 101 E. MARLAND • HOBBS, NM 88240

ANALYTICAL RESULTS FOR
OCCIDENTAL PERMIAN LTD. PARTNERSHIP
ATTN: STEVE BISHOP
1017 W. STANOLIND ROAD
HOBBS, NM 88240
FAX TO: (505) 397-8204

Receiving Date: 04/24/07
Reporting Date: 04/25/07
Project Owner: OXY
Project Name: NHU 13-645
Project Location: DRILLING PIT

Sampling Date: 04/24/07
Sample Type: SOIL
Sample Condition: COOL & INTACT
Sample Received By: NF
Analyzed By: HM/BC

LAB NO.	SAMPLE ID	Cl ⁻ (mg/Kg)	BENZENE (mg/Kg)	TOLUENE (mg/Kg)	ETHYL BENZENE (mg/Kg)	TOTAL XYLENES (mg/Kg)
ANALYSIS DATE:		04/25/07	04/24/07	04/24/07	04/24/07	04/24/07
H12502-1	NHU 13-645 PIT	17600	<0.005	<0.005	<0.005	<0.015
Quality Control		480	0.103	0.109	0.103	0.296
True Value QC		500	0.100	0.100	0.100	0.300
% Recovery		96.0	103.0	109	103	98.6
Relative Percent Difference		2.0	0.7	4.0	1.1	1.0

*Analysis performed on a 1:4 aqueous extract.

METHODS: Cl⁻ - Std. Methods 4500-ClB; BTEX - EPA SW-846-8020

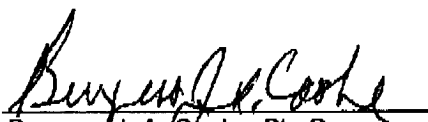
Burgess J. A. Cooke, Ph. D.

4/25/07
Date

PLEASE NOTE: Liability and Damages. Cardinal's liability and client's exclusive remedy for any claim arising, whether based in contract or tort, shall be limited to the amount paid by client for analysis. All claims, including those for negligence and any other cause whatsoever shall be deemed waived unless made in writing and received by Cardinal within thirty (30) days after completion of the applicable service. H12502-1 OXY shall be liable for incidental or consequential damages, including without limitation, business interruptions, loss of use, or loss of profits incurred by client, its subsidiaries, affiliates or successors arising out of or related to the performance of services hereunder by Cardinal, regardless of whether such claim is based upon any of the above-stated reasons or otherwise.



ARDINAL LABORATORIES

PHONE (325) 673-7001 • 2111 BEECHWOOD • ABILENE, TX 79603

PHONE (505) 393-2326 • 101 E MARLAND • HOBBS, NM 88240

ANALYTICAL RESULTS FOR
OCCIDENTAL PERMIAN LTD. PARTNERSHIP
ATTN: STEVE BISHOP
1017 W. STANOLIND ROAD
HOBBS, NM 88240
FAX TO: (505) 397-8204

Receiving Date: 05/07/07
Reporting Date: 05/09/07
Project Number: NOT GIVEN
Project Name: NHU 13-645
Project Location: DRILLING PIT

Sampling Date: 05/07/07
Sample Type: SOIL
Sample Condition: COOL & INTACT
Sample Received By: AB
Analyzed By: BC

LAB NUMBER	SAMPLE ID	GRO (C ₆ -C ₁₀) (mg/Kg)	DRO (>C ₁₀ -C ₂₈) (mg/Kg)
ANALYSIS DATE:		05/08/07	05/08/07
H12558-4	BRINE SIDE	<10.0	<10.0
Quality Control		779	791
True Value QC		800	800
% Recovery		98.8	97.4
Relative Percent Difference		0.9	1.8

METHOD: SW-846 8015 M

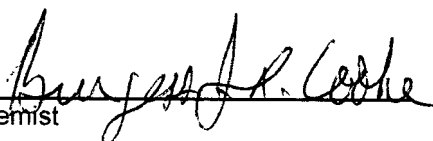
Chemist

5/9/07
Date

H12558A OXY

PLEASE NOTE **Liability and Damages** Cardinal's liability and client's exclusive remedy for any claim arising, whether based in contract or tort, shall be limited to the amount paid by client for analysis. All claims, including those for negligence and any other cause whatsoever shall be deemed waived unless made in writing and received by Cardinal within thirty (30) days after completion of the applicable service. In no event shall Cardinal be liable for incidental or consequential damages, including, without limitation, business interruptions, loss of use, or loss of profits incurred by client, its subsidiaries, affiliates or successors arising out of or related to the performance of services hereunder by Cardinal, regardless of whether such claim is based upon any of the above-stated reasons or otherwise.



PHONE (505) 393-2326 • 101 E MARLAND • HOBBS, NM 88240

ANALYTICAL RESULTS FOR
OCCIDENTAL PERMIAN LTD. PARTNERSHIP
ATTN: STEVE BISHOP
1017 W. STANOLIND ROAD
HOBBS, NM 88240
FAX TO: (505) 397-8204

Analysis Date: 06/22/07
Sampling Date: 06/22/07
Sample Type: SOIL
Sample Condition: COOL & INTACT
Sample Received By: NF
Analyzed By: HM

METHOD: Standard Methods	4500-C/B
Note: Analysis performed on a 1:4 w:v aqueous extract.	

Chemist

Date _____

H12789 OCC

PLEASE NOTE. Liability and Damages. Cardinal's liability and client's exclusive remedy for any claim arising, whether based in contract or tort, shall be limited to the amount paid by client for analyses. All claims, including those for negligence and any other cause whatsoever shall be deemed waived unless made in writing and received by Cardinal within thirty (30) days after completion of the applicable service. In no event shall Cardinal be liable for incidental or consequential damages, including, without limitation, business interruptions, loss of use, or loss of profits incurred by client, its subsidiaries, affiliates or successors arising out of or related to the performance of services hereunder by Cardinal, regardless of whether such claim is based upon any of the above-stated reasons or otherwise.