

DISTRICT I
1625 N. FRENCH DR., HOBBES, NM 88240

State of New Mexico
Energy, Minerals and Natural Resources Department

DISTRICT II
1301 W GRAND AVENUE, ARTESIA, NM 88210

DISTRICT III
1000 Rio Brazos Rd., Aztec, NM 87410

OIL CONSERVATION DIVISION
1220 SOUTH ST. FRANCIS DR.
Santa Fe, New Mexico 87505

Form C-102
Revised October 12, 2005
Submit to Appropriate District Office
State Lease - 4 Copies
Fee Lease - 3 Copies

DISTRICT IV
1220 S ST FRANCIS DR., SANTA FE, NM 87505

WELL LOCATION AND ACREAGE DEDICATION PLAT

☐ AMENDED REPORT

API Number 30-025-39899	Pool Code 96764; 57000; 47090; 63780; 47080	Pool Name Monument; MBO, SE - Skaggs; Drinkard - Monument; Tubbs - Weir; Blinbry - Monument; Paddock
Property Code 120 302374	Property Name V. LAUGHLIN	Well Number 8
OGRID No. 873	Operator Name APACHE CORPORATION	Elevation 3550'

- Surface Location -

UL or lot No.	Section	Township	Range	Lot Idn	Feet from the	North/South line	Feet from the	East/West line	County
C	9	20-S	37-E		950	NORTH	2310	WEST	LEA

Bottom Hole Location If Different From Surface

UL or lot No.	Section	Township	Range	Lot Idn	Feet from the	North/South line	Feet from the	East/West line	County

Dedicated Acres 40	Joint or Infill	Consolidation Code	Order No.
------------------------------	-----------------	--------------------	-----------

NO ALLOWABLE WILL BE ASSIGNED TO THIS COMPLETION UNTIL ALL INTERESTS HAVE BEEN CONSOLIDATED
OR A NON-STANDARD UNIT HAS BEEN APPROVED BY THE DIVISION

	<p>OPERATOR CERTIFICATION</p> <p>I hereby certify that the information herein is true and complete to the best of my knowledge and belief, and that this organization either owns a working interest or unleased mineral interest in the land including the proposed bottom hole location or has a right to drill this well at this location pursuant to a contract with an owner of such mineral or working interest, or to a voluntary pooling agreement or a compulsory pooling order heretofore entered by the division</p> <p><i>Sorina L. Flores</i> 9/7/10 Signature Date</p> <p>Sorina L. Flores Printed Name</p> <p>SURVEYOR CERTIFICATION</p> <p>I hereby certify that the well location shown on this plat was plotted from field notes of actual surveys made by me or under my supervision, and that the same is true and correct to the best of my belief.</p> <p>AUGUST 10 2010 Date Surveyed LA</p> <p>Signature & Seal of Professional Surveyor <i>Ronald E. Edson</i> 8/24/2010 10.11 1240</p> <p>Certificate No. RONALD EDSON 3239</p>
--	---

SECTION 9, TOWNSHIP 20 SOUTH, RANGE 37 EAST, N.M.P.M.,
 LEA COUNTY, NEW MEXICO

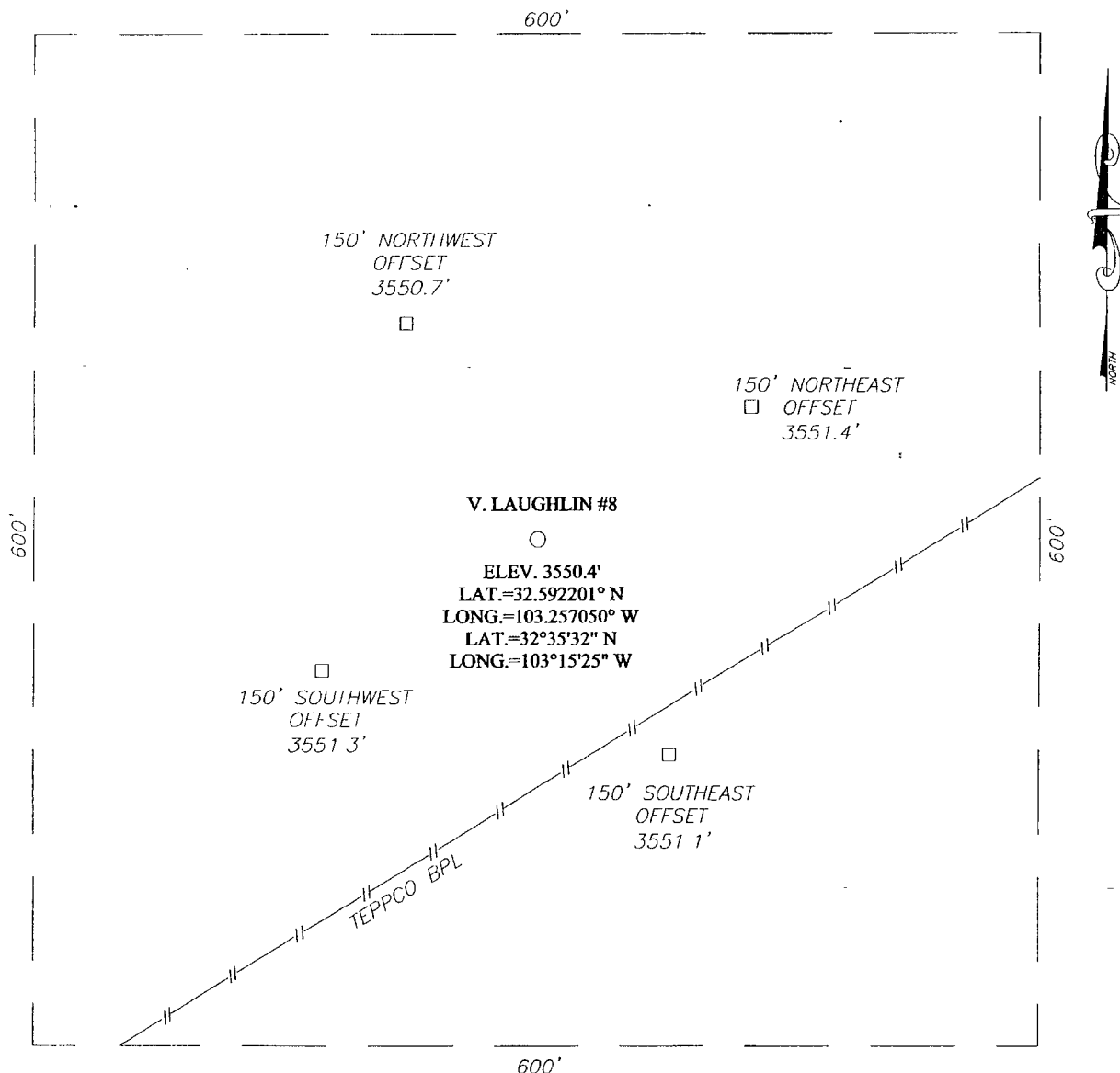

DIRECTIONS TO LOCATION

FROM THE INTERSECTION OF HWY. 8 AND CO. RD.
 #322 (MONUMENT) GO SOUTH ON HWY #8
 APPROX. 2.3 MILES. TURN LEFT AND GO EAST
 APPROX. 0.4 MILES THE LOCATION IS APPROX.
 250 FEET SOUTH.

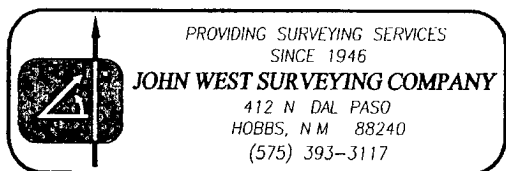
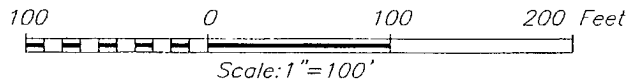

APACHE CORPORATION

V. LAUGHLIN #8
 LOCATED 950 FEET FROM THE NORTH LINE
 AND 2310 FEET FROM THE WEST LINE OF SECTION 9,
 TOWNSHIP 20 SOUTH, RANGE 37 EAST, N.M.P.M.,
 LEA COUNTY, NEW MEXICO.

Survey Date 8/16/10	Sheet 1 of 1 Sheets
W.O. Number: 10.11 1240	Dr By: LA
Date: 8/25/10	10111240
	Scale: 1"=100'

VICINITY MAP

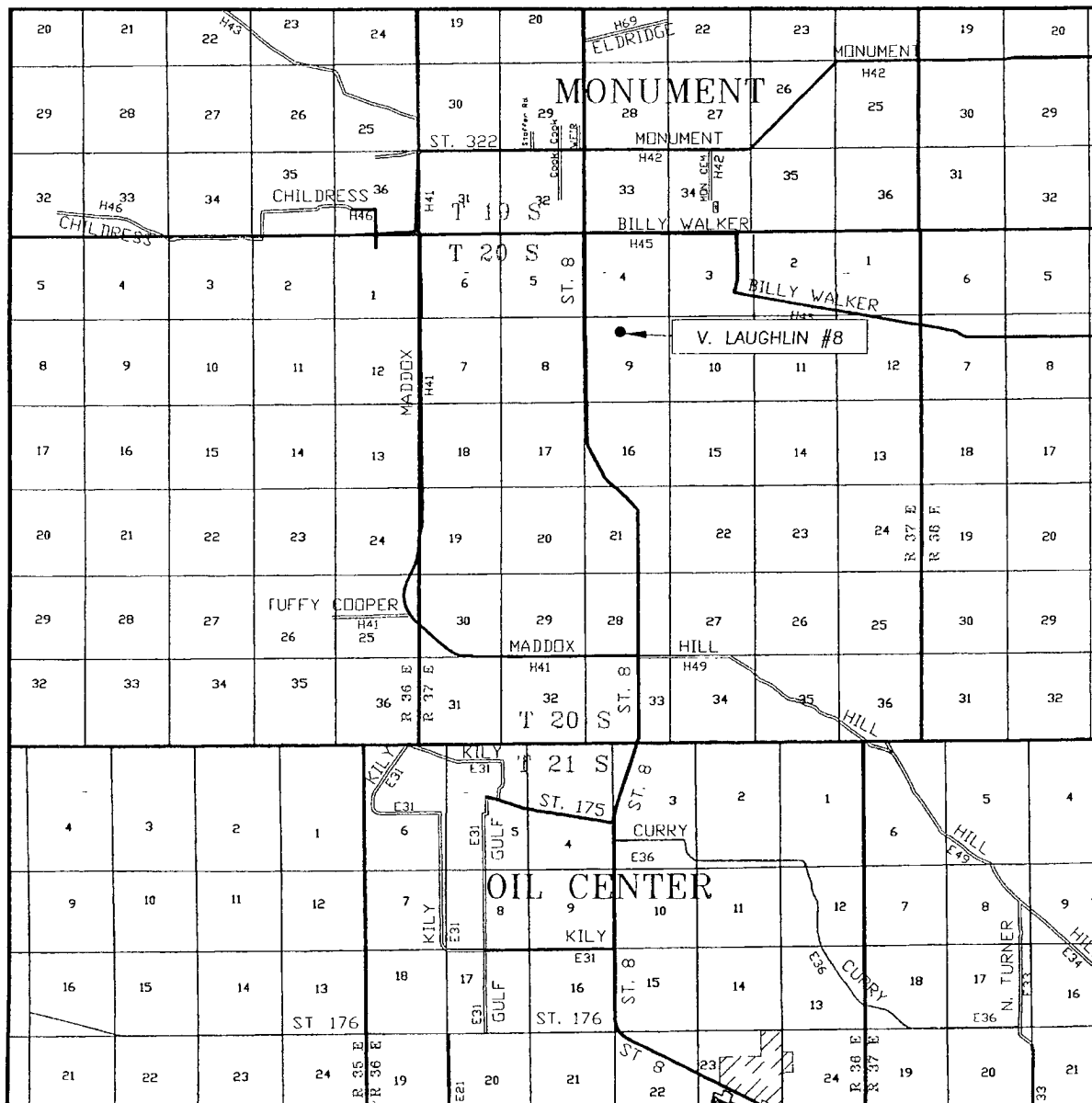

SCALE: 1" = 2 MILES

SEC. 9 TWP 20-S RGE. 37-E

SURVEY N.M.P.M.

COUNTY LEA STATE NEW MEXICO

DESCRIPTION 950' FNL & 2310' FWL

ELEVATION 3550'

OPERATOR APACHE CORPORATION

LEASE V. LAUGHLIN

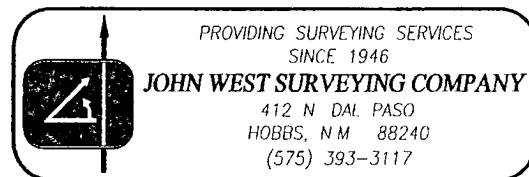

LOCATION VERIFICATION MAP

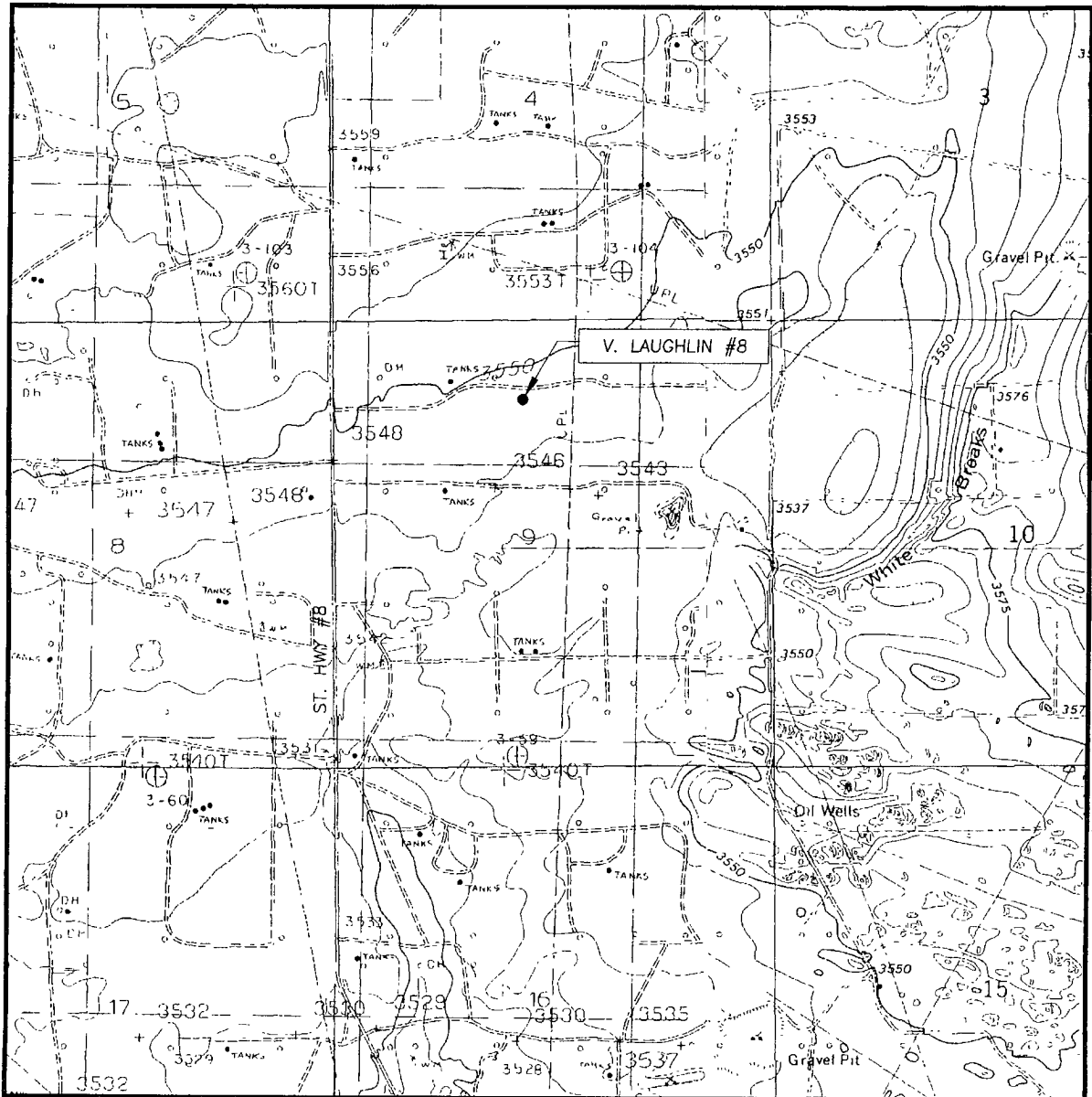

SCALE. 1" = 2000'

SEC. 9 TWP. 20-S RGE 37-E

SURVEY N.M.P.M.

COUNTY LEA STATE NEW MEXICO

DESCRIPTION 950' FNL & 2310' FWI

ELEVATION 3550'

OPERATOR APACHE CORPORATION

LEASE V. LAUHLIN

U.S.G.S. TOPOGRAPHIC MAP
HOBBS SW, N M

CONTOUR INTERVAL
HOBBS SW, N.M. - 5'
MONUMENT SOUTH, N.M. - 5'

