

NO. OF COPIES RECEIVED		
DISTRIBUTION		
SANTA FE		
FILE		
U.S.G.S.		
LAND OFFICE		
OPERATOR		

NEW MEXICO OIL CONSERVATION COMMISSION

Form C-101
Revised 1-1-65

5A. Indicate Type of Lease
STATE ☐ FEE ☒

5. State Oil & Gas Lease No.

APPLICATION FOR PERMIT TO DRILL, DEEPEN, OR PLUG BACK

1a. Type of Work
b. Type of Well
DRILL ☒ Reentry DEEPEN ☐ PLUG BACK ☐
OIL WELL ☒ GAS WELL ☐ OTHER ☐ SINGLE ZONE ☒ MULTIPLE ZONE ☐

2. Name of Operator
Tenneco Oil Company

3. Address of Operator
Box 1031, Midland, Texas 79701

4. Location of Well
UNIT LETTER H LOCATED 2310 FEET FROM THE North LINE
AND 330 FEET FROM THE East LINE OF SEC. 11 TWP. 9-S RGE. 35-E NMPM

7. Unit Agreement Name

8. Farm or Lease Name
Hooper

9. Well No.
1

10. Field and Pool, or Wildcat
Bough (Permo Penn)

12. County
Lea

19. Proposed Depth 9900' 19A. Formation Bough "C" Penn 20. Rotary or C.T. Rotary
21. Elevations (Show whether DF, RT, etc.) 4143' CL 21A. Kind & Status Plug. Bond in effect 21B. Drilling Contractor Unknown 22. Approx. Date Work will start Upon Approval

PROPOSED CASING AND CEMENT PROGRAM

SIZE OF HOLE	SIZE OF CASING	WEIGHT PER FOOT	SETTING DEPTH	SACKS OF CEMENT	EST. TOP
13 7/8"	10 3/4"	35.75	428'	425	Circ.
9 7/8"	7 7/8"	24 3/4 26.4	4250'	1800	Circ.
6 3/4"	5 1/2"	17	9900	300	8500'

This well was originally drilled as the Magnolia Petroleum Company Bertha-Hooper #1 to a total depth of 9801' and completed D&A on 12-16-52.

Propose to reenter and evaluate for production.

APPROVAL VALID
FOR 90 DAYS UNLESS
DRILLING COMMENCED,

EXPIRES 1-14-70

IN ABOVE SPACE DESCRIBE PROPOSED PROGRAM: IF PROPOSAL IS TO DEEPEN OR PLUG BACK, GIVE DATA ON PRESENT PRODUCTIVE ZONE AND PROPOSED NEW PRODUCTIVE ZONE. GIVE BLOWOUT PREVENTER PROGRAM, IF ANY.

I hereby certify that the information above is true and complete to the best of my knowledge and belief.

Signed W. J. Mathis Title DIST. DRLG. ENGINEER Date 10-10-69

(This space for State Use)

APPROVED BY [Signature] TITLE FOR DISTRICT DATE OCT 14 1969

CONDITIONS OF APPROVAL, IF ANY:

NEW MEXICO OIL CONSERVATION COMMISSION
WELL LOCATION AND ACREAGE DEDICATION PLAT

Form C-102
Supersedes C-128
Effective 1-1-65

All distances must be from the outer boundaries of the Section.

Operator Tenneco Oil Company			Lease Hooper		Well No. 1
Unit Letter H	Section 11	Township 9-S	Range 35-E	County Lea	
Actual Footage Location of Well: 2310' feet from the North line and 230 feet from the East line					
Ground Level Elev. 4143	Producing Formation Bough "C" Penn		Pool Bough (Permian-Penn.)		Dedicated Acreage: 40 Acres

1. Outline the acreage dedicated to the subject well by colored pencil or hachure marks on the plat below.
2. If more than one lease is dedicated to the well, outline each and identify the ownership thereof (both as to working interest and royalty).
3. If more than one lease of different ownership is dedicated to the well, have the interests of all owners been consolidated by communitization, unitization, force-pooling, etc?

☐ Yes ☐ No If answer is "yes," type of consolidation _____

If answer is "no," list the owners and tract descriptions which have actually been consolidated. (Use reverse side of this form if necessary.) _____

No allowable will be assigned to the well until all interests have been consolidated (by communitization, unitization, forced-pooling, or otherwise) or until a non-standard unit, eliminating such interests, has been approved by the Commission.

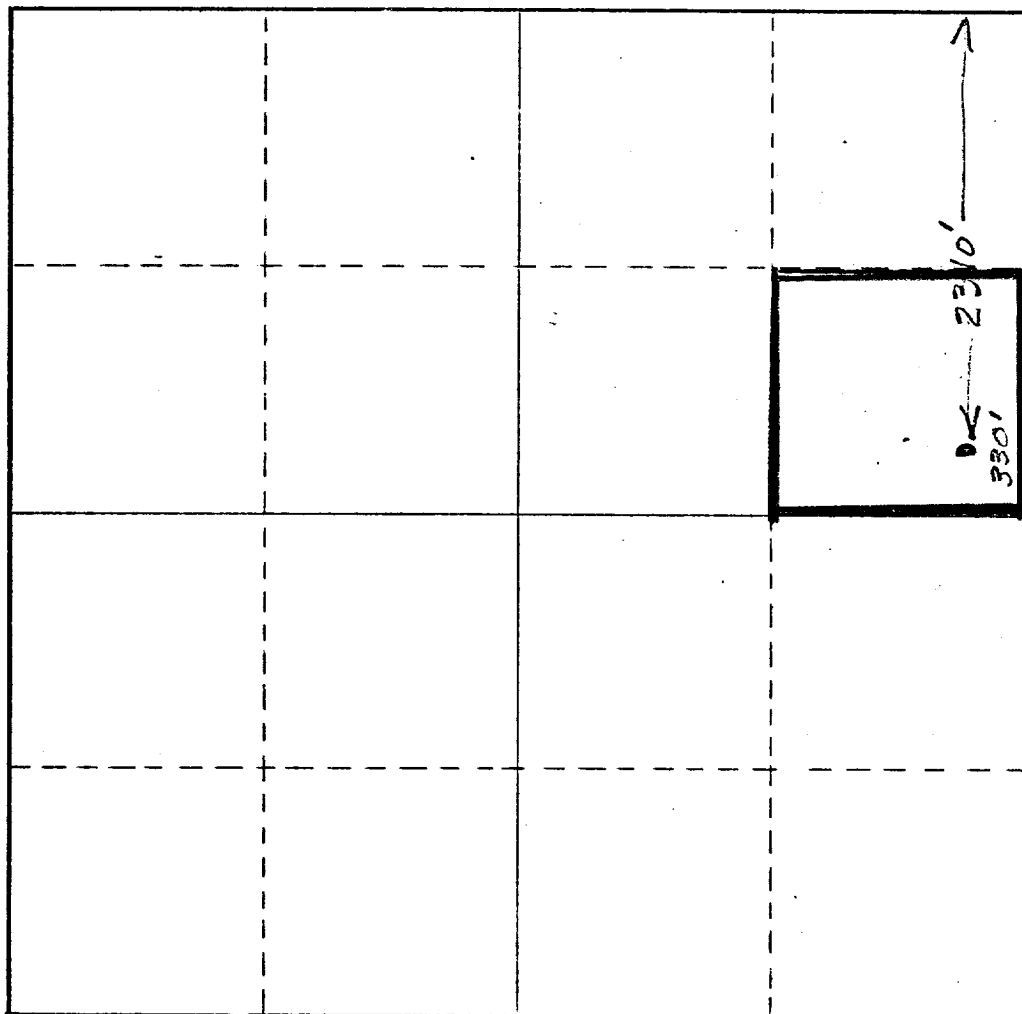

CERTIFICATION

I hereby certify that the information contained herein is true and complete to the best of my knowledge and belief.

Name
John J. Mathis
Position
DIST. DRLG. ENGINEER
Company
Tenneco Oil Co.
Date
October 10, 1969

I hereby certify that the well location shown on this plat was plotted from field notes of actual surveys made by me or under my supervision, and that the same is true and correct to the best of my knowledge and belief.

Unknown
Date Surveyed
Unknown
Registered Professional Engineer and/or Land Surveyor

Certificate No.