

## NEW MEXICO OIL CONSERVATION COMMISSION

Santa Fe, New Mexico

## NOTICE OF INTENTION TO DRILL

Notice must be given to the Oil Conservation Commission or its proper agent and approval obtained before drilling begins. If changes in the proposed plan are considered advisable, a copy of this notice showing such changes will be returned to the sender. Submit this notice in triplicate. One copy will be returned following approval. See instructions in Rules and Regulations of the Commission.

Dallas 1, Texas

July 23, 1948

Place

Date

OIL CONSERVATION COMMISSION,  
Santa Fe, New Mexico,

Gentlemen:

You are hereby notified that it is our intention to commence the drilling of a well to be known as \_\_\_\_\_

MAGNOLIA PETROLEUM COMPANY

Byler-Federal

Well No. 1 in NE 1/4 NE 1/4

Company or Operator

Lease

of Sec. 7, T. 28, R. 36E, N. M., P. M., WILDCAT Field, Lea County.

N

The well is 660' feet (N) (S.) of the North line and 660' feet (E.) (W) of the West line of NE 1/4 NE 1/4

(Give location from section or other legal subdivision lines. Cross out wrong directions.)

If state land the oil and gas lease is No. \_\_\_\_\_ Assignment No. \_\_\_\_\_

If patented land the owner is \_\_\_\_\_

Address \_\_\_\_\_

If government land the permittee is Unknown

Address \_\_\_\_\_

The lessee is Unknown

Address \_\_\_\_\_

We propose to drill well with drilling equipment as follows: Rotary

AREA 640 ACRES  
LOCATE WELL CORRECTLY

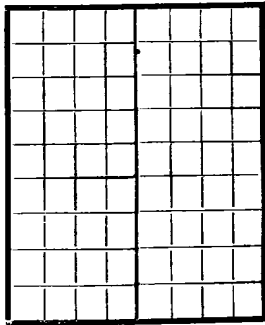

The status of a bond for this well in conformance with Rule 39 of the General Rules and Regulations of the Commission is as follows: Financial Statement of Company filed with Commission and in First Judicial District of New Mexico.

We propose to use the following strings of casing and to land or cement them as indicated:

Size of Hole	Size of Casing	Weight Per Foot	New or Second Hand	Depth	Landed or Cemented	Sacks Cement
12-1/4"	9-5/8" OD	36#	New	600	Cemented	300
7-7/8"	5-1/2" OD	17#	New	5000	Cemented	1150

If changes in the above plan become advisable we will notify you before cementing or landing casing. We estimate that the first productive oil or gas sand should occur at a depth of about 5000 feet.

Additional information:

Approved \_\_\_\_\_, 19\_\_\_\_

except as follows:

OIL CONSERVATION COMMISSION,

By \_\_\_\_\_

Title \_\_\_\_\_

Sincerely yours,

MAGNOLIA PETROLEUM COMPANY

Company or Operator

By Marguerite Shaffer

Field Superintendent

Position \_\_\_\_\_

Send communications regarding well to

Name Marguerite Shaffer

Address Box 900 - Dallas 1, Texas

Wildcat Field  
Magnolia Petroleum Company  
PRODUCING DEPARTMENT

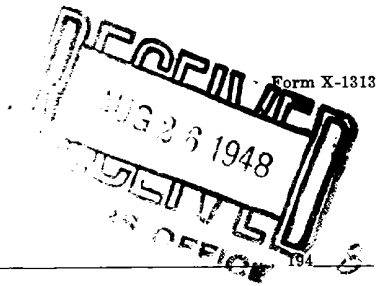

Location made July 22nd,  
Byler-Federal Well No. 1

Lea District  
Lease NM-1407 acres 1118.83 Sec 7, T 9 S, R 33 E { District  
Lea County, New Mexico Township

Scale 1"=500' N S E W

Barnesdell

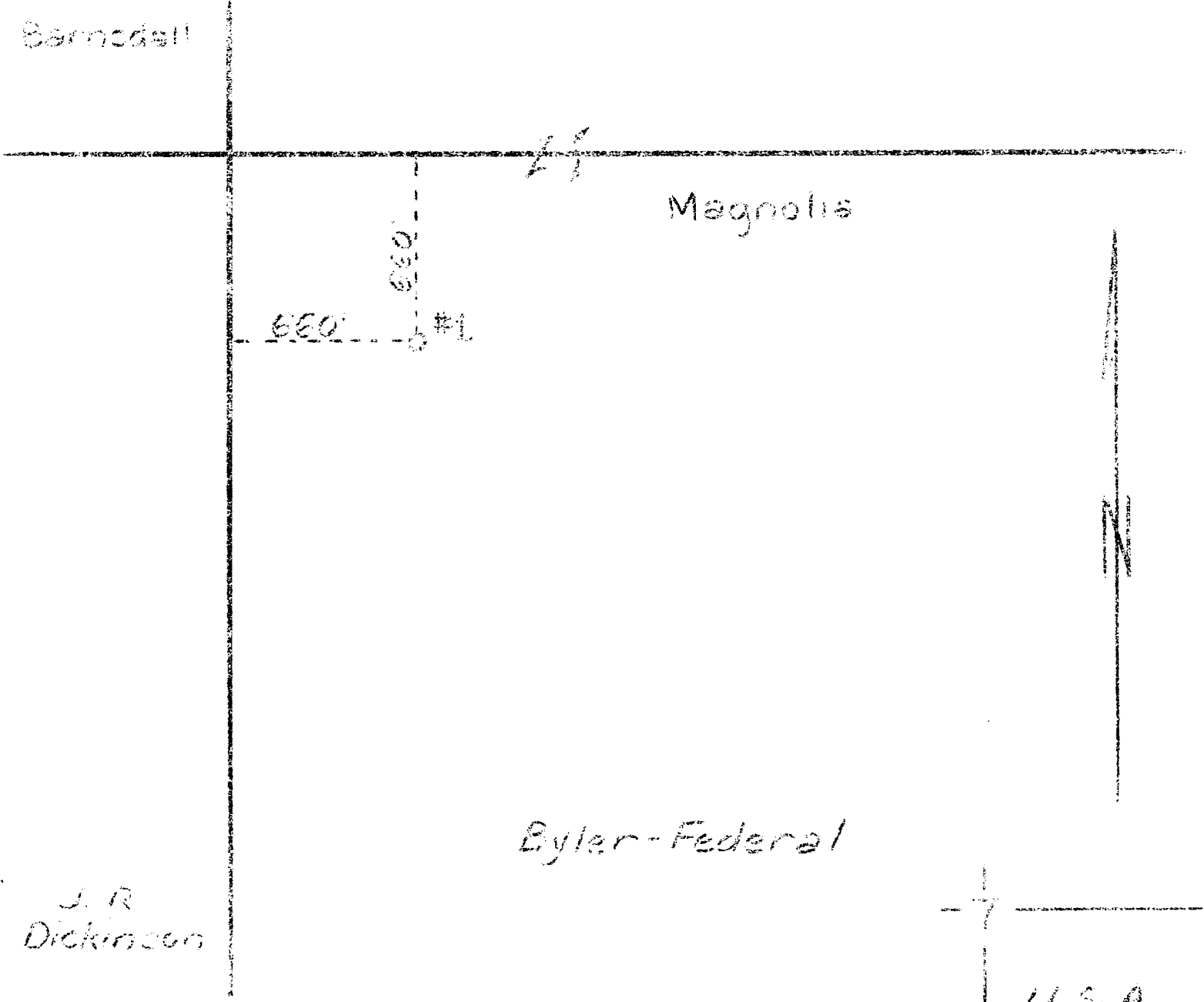

J. R.  
Dickinson

Byler-Federal

U.S.A.

Reserve None

Special instructions

Location changed on account of

Date work is commenced \_\_\_\_\_, 194\_\_\_\_ Supt.

Location approved by \_\_\_\_\_ Plat made by R. M. Brady

**Magnolia Petroleum Company**  
**PRODUCING DEPARTMENT**

Location for Well No. \_\_\_\_\_

\_\_\_\_\_

File No. \_\_\_\_\_

Wildcat Field  
Magnolia Petroleum Company  
PRODUCING DEPARTMENT

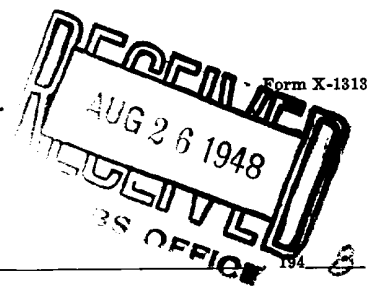

Location made July 22nd,  
Byler-Federal Well No. 1

Lea District  
Lease NM-1407 acres 1118.83 Sec 7, T 9 S, R 39 E { District  
Lea County, New Mexico Township

Scale 1"=500' N S E W

Barnsdall

Magnolia

660'  
660' #1

Byler-Federal

J. R.  
Dickinson

U.S.A.

Reserve None

Special instructions

Location changed on account of

Date work is commenced \_\_\_\_\_, 194\_\_\_\_ Supt.

Location approved by \_\_\_\_\_ Plat made by R. M. Brady

**Magnolia Petroleum Company**  
**PRODUCING DEPARTMENT**

Location for Well No. \_\_\_\_\_

\_\_\_\_\_

File No. \_\_\_\_\_