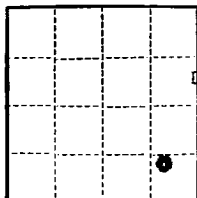

APPROVED

Form 9-331a  
(Feb. 1951)

DEC 12 1960

(SUBMIT IN TRIPLICATE)

Budget Bureau No. 42-R358.4.  
Approval expires 12-31-60.Land Office **New Mexico**  
Lease No. **0659**  
Unit **P**E. W. STANLEY  
DISTRICT ENGINEER
 UNITED STATES  
DEPARTMENT OF THE INTERIOR  
GEOLOGICAL SURVEY

JAN 1 1961

## SUNDRY NOTICES AND REPORTS ON WELLS

NOTICE OF INTENTION TO DRILL.....	<input checked="" type="checkbox"/>	SUBSEQUENT REPORT OF WATER SHUT-OFF.....	
NOTICE OF INTENTION TO CHANGE PLANS.....		SUBSEQUENT REPORT OF SHOOTING OR ACIDIZING.....	
NOTICE OF INTENTION TO TEST WATER SHUT-OFF.....		SUBSEQUENT REPORT OF ALTERING CASING.....	
NOTICE OF INTENTION TO RE-DRILL OR REPAIR WELL.....		SUBSEQUENT REPORT OF RE-DRILLING OR REPAIR.....	
NOTICE OF INTENTION TO SHOOT OR ACIDIZE.....		SUBSEQUENT REPORT OF ABANDONMENT.....	
NOTICE OF INTENTION TO PULL OR ALTER CASING.....		SUPPLEMENTARY WELL HISTORY.....	
NOTICE OF INTENTION TO ABANDON WELL.....			

(INDICATE ABOVE BY CHECK MARK NATURE OF REPORT, NOTICE, OR OTHER DATA)

Federal Kelley "A"

December 1, 1960, 19

Well No. **1** is located **990** ft. from **SE** line and **990** ft. from **E** line of sec. **19**

SE SE of Sec. 19

98

38E

(1/4 Sec. and Sec. No.)

(Twp.)

(Range)

(Meridian)

Sawyer San Andres Gas

Lea

New Mexico

(Field)

(County or Subdivision)

(State or Territory)

The elevation of the derrick floor above sea level is \_\_\_\_\_ ft.

## DETAILS OF WORK

(State names of and expected depths to objective sands; show sizes, weights, and lengths of proposed casings; indicate mudding jobs, cementing points, and all other important proposed work)

Plan to drill a San Andres gas well to a depth of approximately 5,100'.  
The pipe program is as follows:

9-5/8" to be set at approx. 350' with sufficient cement to circulate to surface.

5-1/2" to be set at approx. 5,100' with sufficient cement to circulate to surface.

All casing will be set and cemented in accordance with approved methods.

I understand that this plan of work must receive approval in writing by the Geological Survey before operations may be commenced.

Company **THE OHIO OIL COMPANY**Address **Box 2107****Hobbs, New Mexico**

By

Title **Superintendent**

**DISTRIBUTION:**

**U.S.G.S.**

**Mr. J. A. Grimes  
Mr. L. H. Shearer  
Mr. D. V. Kitley  
Mr. T. A. Steele  
Mr. C. M. Lynch  
Mr. T. O. Webb  
Mr. R. E. Feather**

**THE OHIO OIL CO.  
CORP. PROD. OFF.**

**RECEIVED  
DEC 8 1960**

## NEW MEXICO OIL CONSERVATION COMMISSION

FORM C-128  
Revised 5/1/57

## WELL LOCATION AND ACREAGE DEDICATION PLAT

SEE INSTRUCTIONS FOR COMPLETING THIS FORM ON THE REVERSE SIDE

## SECTION A

Operator <b>The Ohio Oil Company</b>		Lease <b>Federal Kelley "A"</b>		Well No. <b>1</b>
Unit Letter <b>P</b>	Section <b>19</b>	Township <b>9 South</b>	Range <b>38 East</b>	County <b>Lea</b>
Actual Footage Location of Well: <b>990</b> feet from the <b>South</b> line and <b>990</b> feet from the <b>East</b> line				
Ground Level Elev.	Producing Formation <b>San Andres</b>	Pool <b>Sawyer San Andres Gas Pool</b>	Dedicated Acreage: <b>160</b> Acres	

1. Is the Operator the only owner in the dedicated acreage outlined on the plat below? YES ☒ NO \_\_\_\_ ("Owner" means the person who has the right to drill into and to produce from any pool and to appropriate the production either for himself or for himself and another. (63-3-29 (e) NMSA 1935 Comp.)
2. If the answer to question one is "no," have the interests of all the owners been consolidated by communitization agreement or otherwise? YES \_\_\_\_ NO \_\_\_\_ . If answer is "yes," Type of Consolidation \_\_\_\_
3. If the answer to question two is "no," list all the owners and their respective interests below:

Owner	Land Description

## SECTION B

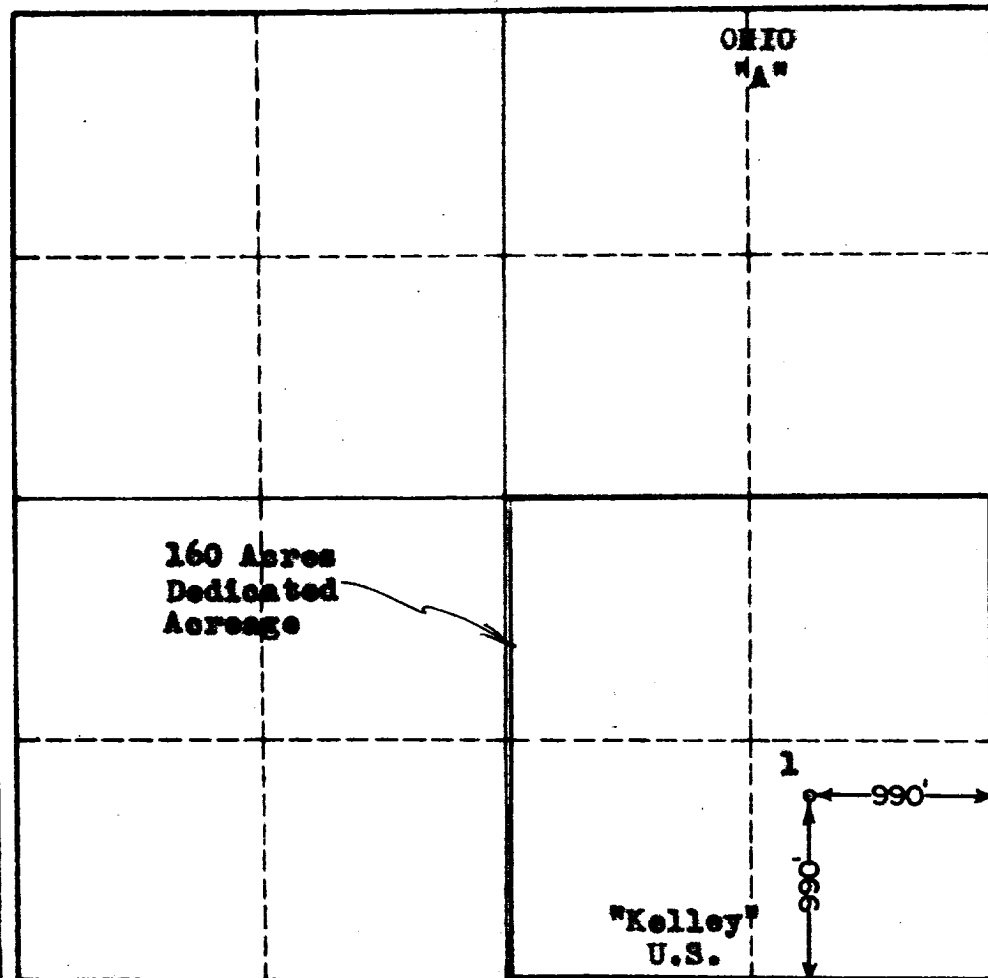

## CERTIFICATION

I hereby certify that the information in SECTION A above is true and complete to the best of my knowledge and belief.

Name T. O. Webb  
Position Area Petroleum Engineer  
Company The Ohio Oil Company  
Date 12-5-60

I hereby certify that the information shown on the plat in SECTION B plotted from notes of actual surveys made by me or under my supervision and that the same is true and correct to the best of my knowledge and belief.

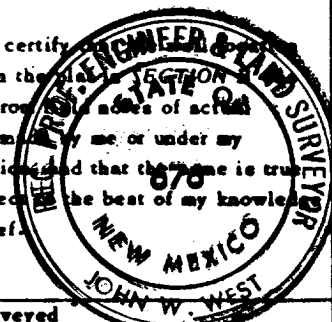

Date Surveyed Nov. 30, 1960  
Registered Professional Engineer and/or Land Surveyor, JOHN W. WEST  
Certificate No. 676  
N.M. - P.E. & L.S. NO. 676

0 330 660 990 1320 1650 1980 2310 2640 2000 1500 1000 500 0

RECEIVED  
DEC 9 1960  
THE OHIO OIL CO.  
HOBBS, PROD. CO.