

**APPROVED**occ  
HobbsBudget Bureau No. 42-R368.4.  
Approval expires 12-31-60.Form 9-381a  
(Feb. 1961)

JAN 10 1961

(SUBMIT IN TRIPPLICATE)

Land Office Hobbs, N. M.Lease No. 016269  
065151

Unit \_\_\_\_\_

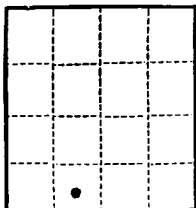
Sec 19  
T-9-S  
R-3 8-E  
Lea Co.,  
N.M.E. W. STANDLEY  
DISTRICT ENGINEER

UNITED STATES

DEPARTMENT OF THE INTERIOR

GEOLOGICAL SURVEY

**SUNDRY NOTICES AND REPORTS ON WELLS**

NOTICE OF INTENTION TO DRILL	<input checked="" type="checkbox"/>	SUBSEQUENT REPORT OF WATER SHUT-OFF	
NOTICE OF INTENTION TO CHANGE PLANS		SUBSEQUENT REPORT OF SHOOTING OR ACIDIZING	
NOTICE OF INTENTION TO TEST WATER SHUT-OFF		SUBSEQUENT REPORT OF ALTERING CASING	
NOTICE OF INTENTION TO RE-DRILL OR REPAIR WELL		SUBSEQUENT REPORT OF RE-DRILLING OR REPAIR	
NOTICE OF INTENTION TO SHOOT OR ACIDIZE		SUBSEQUENT REPORT OF ABANDONMENT	
NOTICE OF INTENTION TO PULL OR ALTER CASING		SUPPLEMENTARY WELL HISTORY	
NOTICE OF INTENTION TO ABANDON WELL			

(INDICATE ABOVE BY CHECK MARK NATURE OF REPORT, NOTICE, OR OTHER DATA)

January 9, 1961

Mc Dermott Federal

Well No. 2 is located 660' ft. from  $\begin{Bmatrix} N \\ S \end{Bmatrix}$  line and 1980 ft. from  $\begin{Bmatrix} E \\ W \end{Bmatrix}$  line of sec. 19SE/4 - SW/4 Sec. 19  
( $\frac{1}{4}$  Sec. and  $\frac{1}{4}$  Sec. No.)9-S  
(Twp.)38-E  
(Range)NMPM  
(Meridian)Sawyer San Andres  
(Field)Lea County  
(County or Subdivision)New Mexico  
(State or Territory)

The elevation of the derrick floor above sea level is 3964 ft. G. L. Elev. 3953'

**DETAILS OF WORK**

(State names of and expected depths to objective sands; show sizes, weights, and lengths of proposed casings; indicate mudding jobs, cementing points, and all other important proposed work)

Will drill to San Andres Pay horizon, total depth approximately 5050 feet, with rotary tools. Set approximately 375 feet of 8-5/8", 28# surface casing, circulating cement to surface. Set 4-1/2", 11.60# casing to total depth. Cement production casing with approximately 350 sacks cement. Run Gammaray-Nuetron logs and perforate casing - Acid treatment approximately 10,000 Gallons.

Top of Rustler	- 2400' Est.
Top of Yates	- 2900' Est.
Top of San Andres	- 4185' Est.
Top of Pay	- 4900' Est.

I understand that this plan of work must receive approval in writing by the Geological Survey before operations may be commenced.

Company Western Drilling Company of Longview, TexasAddress P. O. Box 1428Odessa, TexasBy JD HendersonTitle Partner

## NEW MEXICO OIL CONSERVATION COMMISSION

FORM C-128  
Revised 5/1/57

## WELL LOCATION AND ACREAGE DEDICATION PLAT

SEE INSTRUCTIONS FOR COMPLETING THIS FORM ON THE REVERSE SIDE

## SECTION A

Operator <b>WESTERN DRILLING COMPANY of Longview</b>			Lease <b>McDermott FEDERAL</b>		Well No. <b>1 16 2</b>
Unit Letter <b>N</b>	Section <b>19</b>	Township <b>9 South</b>	Range <b>38 East</b>	County <b>Lea</b>	
Actual Footage Location of Well: <b>660</b> feet from the <b>South</b> line and <b>1980</b> feet from the <b>West</b> line					
Ground Level Elev. <b>3953</b>	Producing Formation		Pool		Dedicated Acreage: Acres

1. Is the Operator the only owner in the dedicated acreage outlined on the plat below? YES \_\_\_\_\_ NO \_\_\_\_\_. ("Owner" means the person who has the right to drill into and to produce from any pool and to appropriate the production either for himself or for himself and another. (65-3-29 (e) NMSA 1935 Comp.)
2. If the answer to question one is "no," have the interests of all the owners been consolidated by communitization agreement or otherwise? YES \_\_\_\_\_ NO \_\_\_\_\_. If answer is "yes," Type of Consolidation \_\_\_\_\_
3. If the answer to question two is "no," list all the owners and their respective interests below:

Owner	Land Description

## SECTION B

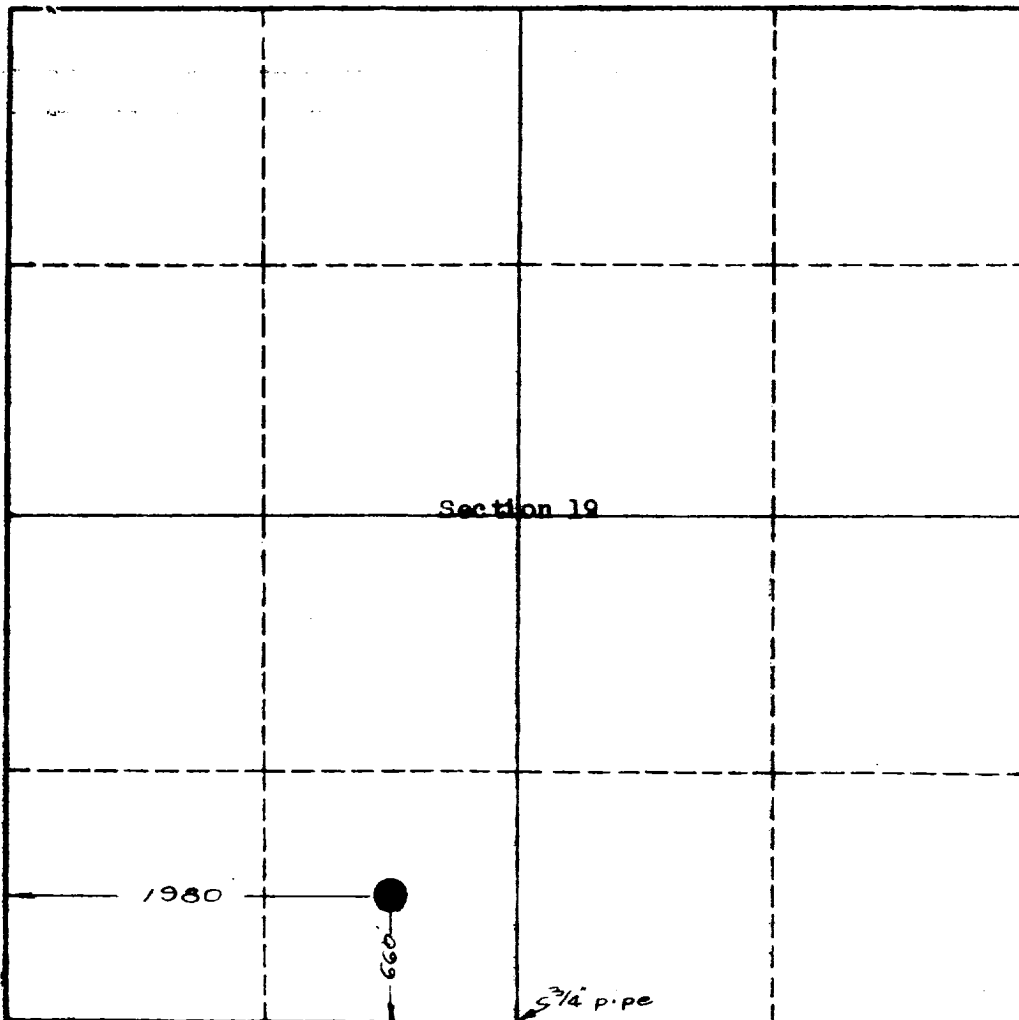

## CERTIFICATION

I hereby certify that the information in SECTION A above is true and complete to the best of my knowledge and belief.

Name J. D. Henderson  
Position \_\_\_\_\_  
Company **WESTERN DRILLING COMPANY of Longview**  
Date \_\_\_\_\_

I hereby certify that the well location shown on the plat in SECTION B was plotted from field notes of actual surveys made by me or under my supervision, and that the same is true and correct to the best of my knowledge and belief.

Date Surveyed  
**January 7, 1961**  
Registered Professional Engineer  
and/or Land Surveyor

John W. Shearn  
Certificate No. \_\_\_\_\_

1559