

DUPLICATE

RECEIVED

NEW MEXICO OIL CONSERVATION COMMISSION WELL LOCATION AND ACREAGE DEDICATION PLAT

FORM C-128
NOV 28 1960
REVISED 5/1/57

SEE INSTRUCTIONS FOR COMPLETING THIS FORM ON THE REVERSE SIDE U. C. C.

SECTION A

Operator SOUTHERN UNION GAS COMPANY		Lease 10 15		Well No. 2-32	
STATE LEA					
Unit Letter J	Section 32	Township 9 SOUTH	Range 38 EAST	County LEA	
Actual Footage Location of Well: 1980 feet from the SOUTH line and 1980 feet from the EAST line					
Ground Level Elev. 3933.1	Producing Formation San Andres		Pool South Group		Dedicated Acreage: 1.00 Acres

1. Is the Operator the only owner in the dedicated acreage outlined on the plat below? YES ☐ NO ☒ ("Owner" means the person who has the right to drill into and to produce from any pool and to appropriate the production either for himself or for himself and another. (65-3-29 (e) NMSA 1955 Comp.)
2. If the answer to question one is "no," have the interests of all the owners been consolidated by communitization agreement or otherwise? YES ☒ NO ☐ If answer is "yes," Type of Consolidation **Joint Ownership**
3. If the answer to question two is "no," list all the owners and their respective interests below:

Owner	Land Description
SOUTHERN UNION GAS CO. - 100%	1/4 of Section 32
THOMAS DONALDSON (DECEASED) & WIFE - 25%	
SOUTHERN UNION GAS CO. - 25%	

SECTION B

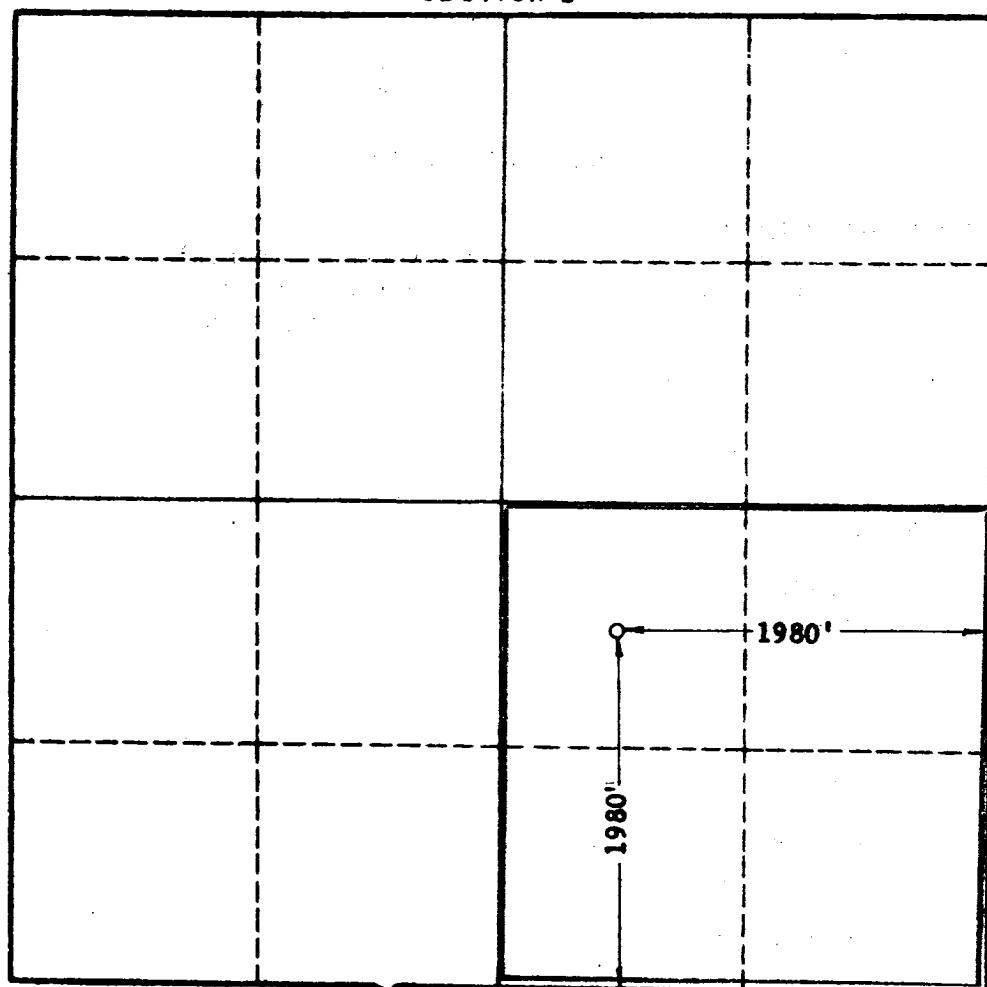

CERTIFICATION

I hereby certify that the information in SECTION A above is true and complete to the best of my knowledge and belief.

Name Robert J. Graf
Position Professional Engineer
Company SOUTHERN UNION GAS CO.
Date Nov 22, 1960

I hereby certify that the well location shown on the plat in SECTION B was plotted from field notes of actual surveys made by me or under my supervision, and that the same is true and correct to the best of my knowledge and belief.

Date Surveyed NOVEMBER 19, 1960
Registered Professional Engineer and/or Land Surveyor JOHN W. WEST
Certificate No. 14 N. M. P. E. & L. S. No. 576

