

NEW MEXICO OIL CONSERVATION COMMISSION
WELL LOCATION AND ACREAGE DEDICATION PLAT

FORM C-128
Revised 5-1-57

SEE INSTRUCTIONS FOR COMPLETING THIS FORM ON THE REVERSE SIDE

SECTION A

Operator L. R. FRENCH, JR.		Lease Gulf State		Date PM 11 32		Well No. 4
Unit Letter L	Section 18	Township 11 South	Range 34 East	County Lea		
Actual Footage Location of Well: 2086 feet from the south line and 693 feet from the west line						
Ground Level Elev. 4178	Producing Formation Bough "C"		Pool Inbe (Penn)		Dedicated Acreage: 71.25 Acres	

1. Is the Operator the only owner in the dedicated acreage outlined on the plat below? YES ☒ NO ☐ ("Owner" means the person who has the right to drill into and to produce from any pool and to appropriate the production either for himself or for himself and another. (65-3-29 (e) NMSA 1933 Comp.)
2. If the answer to question one is "no," have the interests of all the owners been consolidated by communitization agreement or otherwise? YES ☐ NO ☐ If answer is "yes," Type of Consolidation _____
3. If the answer to question two is "no," list all the owners and their respective interests below:

Owner State of New Mexico	Land Description 1/2 Sec. 18 T-11-S R-34-E
-------------------------------------	--

SECTION B

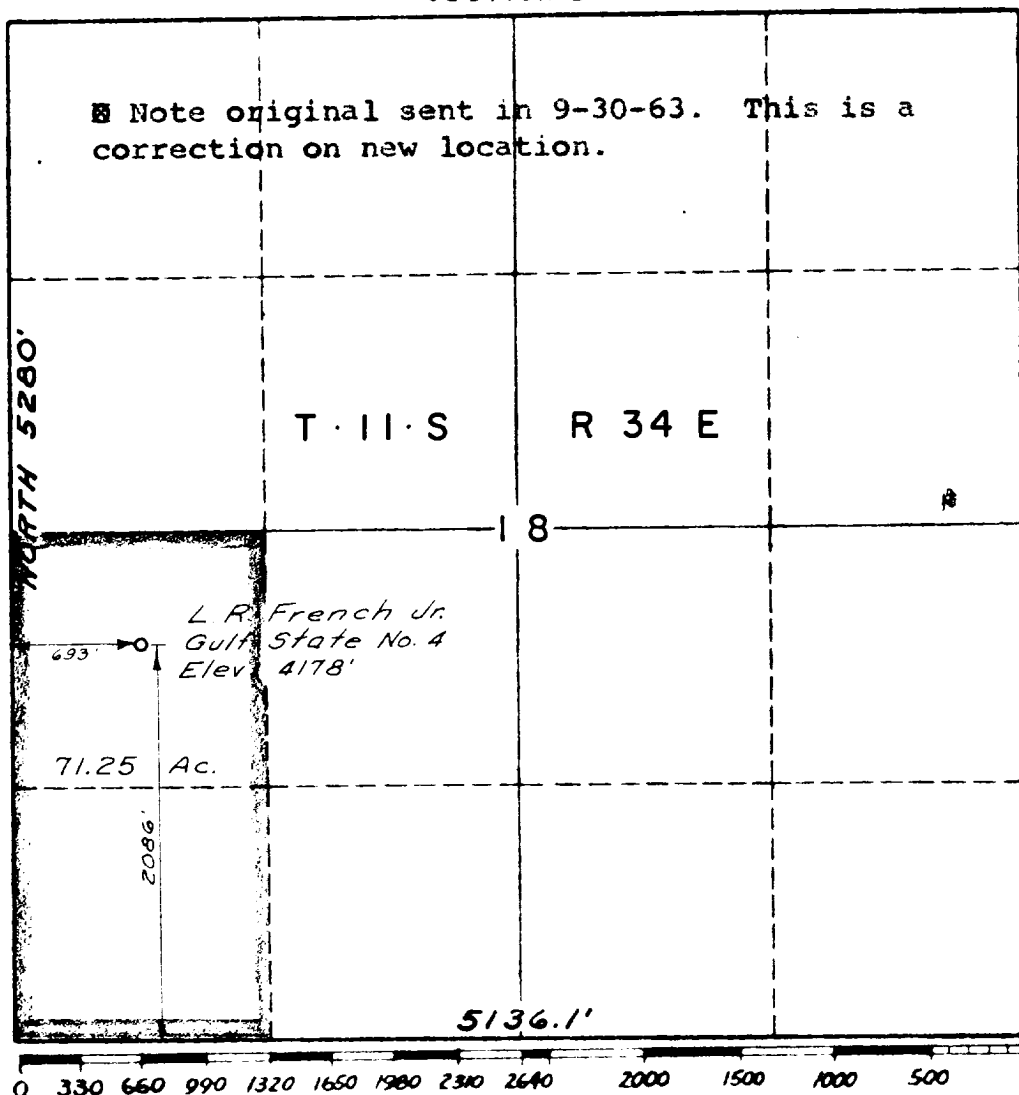

CERTIFICATION

I hereby certify that the information in SECTION A above is true and complete to the best of my knowledge and belief.

Name
David H. Donaldson
Production Supt.
L. R. French, Jr.
Date
October 1, 1963

I hereby certify that the well location shown on the plat in SECTION B was plotted from field notes of actual surveys made by me or under my supervision, and that the same is true and correct to the best of my knowledge and belief.

Date Surveyed
Oct 1, 1963
Registered Professional Engineer and/or Land Surveyor
David H. Donaldson
Certificate No.
1581