

NOTICE OF INTENTION TO DRILL

Notice must be given to the District Office of the Oil Conservation Commission and approval obtained before drilling or recompletion begins. If changes in the proposed plan are considered advisable, a copy of this notice showing such changes will be returned to the sender. Submit this notice in QUINTUPLICATE. One copy will be returned following approval. See additional instructions in Rules and Regulations of the Commission.

If State Land submit 6 Copies Attach Form C-128 in triplicate to first 3 copies of form C-101

P. O. Box 1538, Midland, Texas 79701

(Place)

August 15, 1963

(Date)

OIL CONSERVATION COMMISSION
SANTA FE, NEW MEXICO

Gentlemen:

You are hereby notified that it is our intention to commence the Drilling of a well to be known as

Bell Petroleum Company

(Company or Operator)

State-5

(Lease)

Well No. **1**, in **I** (Unit)

located **1980** feet from the **South** line and **660** feet from the **East** line of Section **5**, T. **9-S**, R. **32-E**, NMPM.

(GIVE LOCATION FROM SECTION LINE)

Wildcat

Pool, **Lea** County

If State Land the Oil and Gas Lease is No. **K-169**

If patented land the owner is

Address

We propose to drill well with drilling equipment as follows: **Rotary to TD**

The status of plugging bond is **Active**

Drilling Contractor **Will notify later.**

We intend to complete this well in the **Ellenburger** formation at an approximate depth of **12,000** feet.

CASING PROGRAM

We propose to use the following strings of Casing and to cement them as indicated:

| Size of Hole | Size of Casing | Weight per Foot | New or Second Hand | Depth | Sacks Cement |
|---------------|----------------|------------------|--------------------|--------------|--------------|
| 17" | 13-3/8" | 40# | New | 350' | 330 |
| 11" | 8-5/8" | 24# - 32# | New | 3600' | 1500 |
| 7 1/2" | 5 1/2" | 17 | New | 1200 | 550 |

If changes in the above plans become advisable we will notify you immediately.

ADDITIONAL INFORMATION (If recompletion give full details of proposed plan of work.)

Approved _____, 19____
Except as follows:

OIL CONSERVATION COMMISSION

By _____

Sincerely yours,

BELL PETROLEUM COMPANY

(Company or Operator)

By **Ed E. Ellsworth**

Position **Mgr. Supt.**

Send Communications regarding well to

Name **Bell Petroleum Company**

Address **P. O. Box 1538, Midland, Texas 79701**

NEW MEXICO OIL CONSERVATION COMMISSION

WELL LOCATION AND ACREAGE DEDICATION PLAT

FORM C-128
Revised 8/1/57

NMSO'S OFFICE 000

SEE INSTRUCTIONS FOR COMPLETING THIS FORM ON THE REVERSE SIDE

| | | | |
|---|---|----------------------------|--------------------------------------|
| SECTION A | | 1963 AUG 23 PM 4:01 | |
| Operator BELL PETROLEUM CORP. | | Lease STATE-5 | |
| Unit Later 1 | Section 5 | Township 9 SOUTH | Range 32 EAST |
| | | County LEA | |
| Actual Footage Location of Well: 1980 feet from the SOUTH line and 660 feet from the EAST line | | | |
| Ground Level Elev. 4426 GL | Producing Formation Ellenburger | Pool Wildcat | Dedicated Acreage 40 Acres |

1. Is the Operator the only owner in the dedicated acreage outlined on the plat below? YES X NO ____ . ("Owner" means the person who has the right to drill into and to produce from any pool and to appropriate the production either for himself or for himself and another. (63-3-29 (a) NMSA 1955 Comp.)
2. If the answer to question one is "no," have the interests of all the owners been consolidated by communication agreement or otherwise? YES ____ NO ____ . If answer is "yes," Type of Consolidation ____
3. If the answer to question two is "no," list all the owners and their respective interests below:

| Owner | Land Description |
|-------|------------------|
| | |

SECTION B

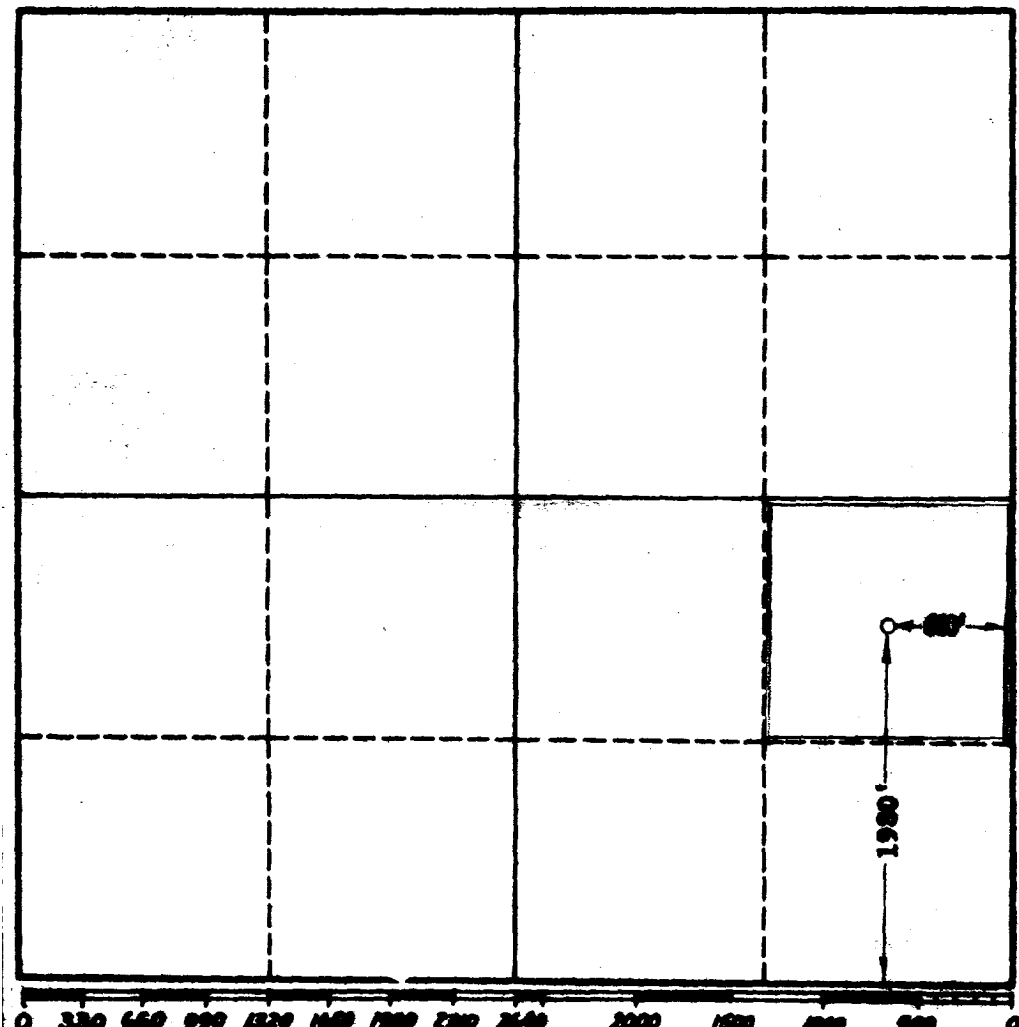

CERTIFICATION

I hereby certify that the information in SECTION A above is true and complete to the best of my knowledge and belief.

John A. West
 Name
Petroleum Engineer
 Position
Bell Petroleum Company
 Company
August 22, 1963
 Date

I hereby certify that the well location shown on the plat in SECTION B was plotted from field notes of actual surveys made by me or under my supervision, and that the same is true and correct to the best of my knowledge and belief.

Date Surveyed **8-14-63**
 Registered Professional Engineer and Land Surveyor, **JOHN A. WEST**
 No. **676**