

NEW MEXICO OIL CONSERVATION COMMISSION  
Santa Fe, New Mexico

Form G-101  
Revised (12/1/55)

## NOTICE OF INTENTION TO DRILL

Notice must be given to the District Office of the Oil Conservation Commission and approval obtained before drilling or recompletion begins. If changes in the proposed plan are considered advisable, a copy of this notice showing such changes will be returned to the sender. Submit this notice in QUINTUPPLICATE. One copy will be returned following approval. See additional instructions in Rules and Regulations of the Commission. If State Land submit 6 Copies Attach Form G-128 in triplicate to first 3 copies of form G-101

Midland, Texas

April 26, 1963

(Place)

(Date)

OIL CONSERVATION COMMISSION  
SANTA FE, NEW MEXICO

Gentlemen:

You are hereby notified that it is our intention to commence the Drilling of a well to be known as

**RALPH LOWE**

(Company or Operator)

**Marathon-State**

(Lease)

Well No. **1**, in **D** The well is

(Unit)

located **660** feet from the **West** line and **660** feet from the

**North**

line of Section **32**, T. **9-S**, R. **35-E**, NMPM.

(GIVE LOCATION FROM SECTION LINE)

**Wildcat**

Pool,

**Lea**

County

If State Land the Oil and Gas Lease is No. **E-7098**

If patented land the owner is

Address

We propose to drill well with drilling equipment as follows: **Rotary to TD**

The status of plugging bond is **\$10,000.00 Blanket**

Drilling Contractor **Unknown at present time.**

We intend to complete this well in the **Devonian**

formation at an approximate depth of **12,700** feet.

### CASING PROGRAM

We propose to use the following strings of Casing and to cement them as indicated:

Size of Hole	Size of Casing	Weight per Foot	New or Second Hand	Depth	Sacks Cement
<b>17"</b>	<b>13 3/8"</b>	<b>48#</b>	<b>New</b>	<b>450'</b>	<b>Sufficient to Circ.</b>
<b>11"</b>	<b>8 5/8"</b>	<b>24#</b>	<b>New</b>	<b>4350' app.</b>	<b>" " "</b>
				<b>or tie into surface string.</b>	
<b>7 7/8"</b>	<b>5 1/2"</b>	<b>14#</b>	<b>New</b>	<b>12700'</b>	<b>Approx. 800 sacks</b>

If changes in the above plans become advisable we will notify you immediately.

ADDITIONAL INFORMATION (If recompletion give full details of proposed plan of work.)

Approved \_\_\_\_\_, 19\_\_\_\_\_  
Except as follows:

Sincerely yours,

**RALPH LOWE**

(Company or Operator)

By \_\_\_\_\_

Position **Agent**

Send Communications regarding well to

Name **RALPH LOWE**

Address **Box 832, Midland, Texas**

OIL CONSERVATION COMMISSION

By \_\_\_\_\_

NEW MEXICO OIL CONSERVATION COMMISSION  
Well Location and Acreage Dedication Plat

Section A.

Date April 26, 1963

Operator Ralph Lowe Lease Marathon-State E-7098  
Well No. 1 Unit Letter D Section 32 Township 9-S Range 35-E NMPM  
Located 660 Feet From West Line, 660 Feet From North Line  
County Lea G. L. Elevation 4165 Dedicated Acreage 80 Acres  
Name of Producing Formation Devonian Pool Wildcat

1. Is the Operator the only owner\* in the dedicated acreage outlined on the plat below?  
Yes X No       .
2. If the answer to question one is "no," have the interests of all the owners been consolidated by communitization agreement or otherwise? Yes        No       . If answer is "yes," Type of Consolidation
3. If the answer to question two is "no," list all the owners and their respective interests below:

Owner

Land Description

Section B

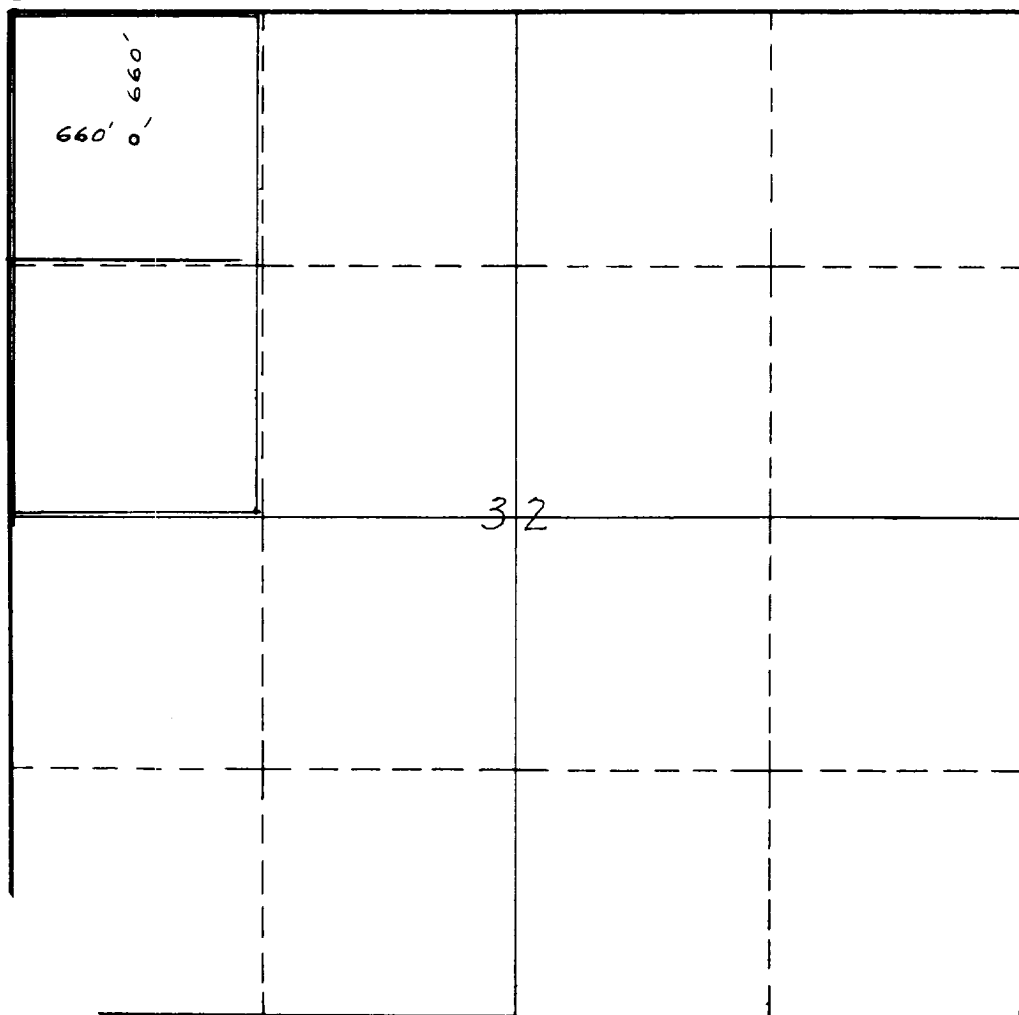

This is to certify that the information in Section A above is true and complete to the best of my knowledge and belief.

Ralph Lowe

(Operator)

E. L. Manning  
(Representative)

Box 832, Midland, Texas

Address

This is to certify that the well location shown on the plat in Section B was plotted from field notes of actual surveys made by me or under my supervision and that the same is true and correct to the best of my knowledge and belief.

Date Surveyed 4-25-63

J. F. Johnson  
Registered Professional  
Engineer and/or Land Surveyor.

Certificate No. 1390

INSTRUCTIONS FOR COMPLETION:

1. Operator shall furnish and certify to the information called for in Section A.
2. Operator shall outline the dedicated acreage for both oil and gas wells on the plat in Section B.
3. A registered professional engineer or land surveyor registered in the State of New Mexico or approved by the Commission shall show on the plat the location of the well and certify this information in the space provided.
4. All distances shown on the plat must be from the outer boundaries of Section.
5. If additional space is needed for listing owners and their respective interests as required in question 3, Section A, please use space below

\* "Owner" means the person who has the right to drill into and to from any pool and to appropriate the production either for him for himself and another. (65-3-29 (e) NMSA 1953 Comp.)

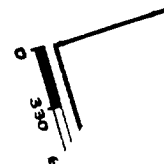

ATLANTIC

HUMBLE

AMERADA

T - 9 - S, R - 35 - E

Carver & Glenn

J. A. Glenn

U. S.

AMERADA

RALPH LOWE

U. S.

Ruby Wykes

AMERADA

AMERADA

U. S.

Marathon-State

U. S.

UNION

UNION

ATLANTIC

UNION

T - 10 - S, R - 35 - E

State

State

State

State

I, J. F. Johnson, hereby certify above survey was  
made by me on the ground and that this plat is  
True and Correct.  
April 25, 1963

RALPH LOWE

MARATHON-STATE LEASE  
Survey 32, T-9-S, R-35-E  
Lea County, New Mexico  
Scale: 1" - 1000'

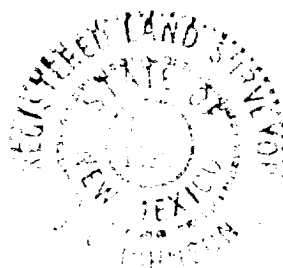

Licensed & Registered State Land Surveyor  
Midland, Texas

