

NUMBER OF COPIES RECEIVED	
DISTRIBUTION	
SANTA FE	
FILE	
U.S.G.S.	
LAND OFFICE	
TRANSPORTER	OIL
	GAS
PRODUCTION OFFICE	
OPERATOR	

NEW MEXICO OIL CONSERVATION COMMISSION
SANTA FE, NEW MEXICO
**CERTIFICATE OF COMPLIANCE AND AUTHORIZATION
TO TRANSPORT OIL AND NATURAL GAS**

FORM C-110

(Rev. 7-60)
HDSB'S OFFICE D. C. C.
APR 28 3 03 PM '64

FILE THE ORIGINAL AND 4 COPIES WITH THE APPROPRIATE OFFICE

Company or Operator Coastal States Gas Producing Company				Lease Redfern State		Well No. 1	
Unit Letter G	Section 16	Township 9-S	Range 33-E	County Lea			
Pool Undesignated				Kind of Lease (State, Fed, Fee) State			
If well produces oil or condensate give location of tanks			Unit Letter G	Section 16	Township 9-S	Range 33-E	
Authorized transporter of oil <input checked="" type="checkbox"/> or condensate <input type="checkbox"/> McWood Corporation				Address (give address to which approved copy of this form is to be sent) 306 V & J Tower Building Midland, Texas			
Is Gas Actually Connected? Yes <input type="checkbox"/> No <input type="checkbox"/>							
Authorized transporter of casing head gas <input type="checkbox"/> or dry gas <input type="checkbox"/> None			Date Con- nected	Address (give address to which approved copy of this form is to be sent)			

If gas is not being sold, give reasons and also explain its present disposition:

Flared - No present market.

REASON(S) FOR FILING (please check proper box)

New Well ☒
Change in Transporter (check one)
Oil ☐ Dry Gas ☐
Casing head gas . ☐ Condensate.. ☐

Change in Ownership ☐
Other (explain below)

Remarks

The undersigned certifies that the Rules and Regulations of the Oil Conservation Commission have been complied with.

Executed this the 23rd day of April, 1964..

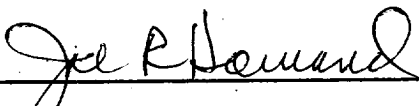
OIL CONSERVATION COMMISSION		By	
Approved by		Title	
Title	Engineer	Company	COASTAL STATES GAS PRODUCING COMPANY
Date	APR 23 1964	Address	P. O. Box 385, Abilene, Texas

NUMBER OF COPIES RECEIVED	
DISTRIBUTION	
SANTA FE	
FILE	
U.S.G.S.	
LAND OFFICE	
TRANSPORTER	OIL GAS
PRODUCTION OFFICE	
OPERATOR	

NEW MEXICO OIL CONSERVATION COMMISSION

MISCELLANEOUS REPORTS ON WELLS

(Submit to appropriate District Office as per Commission Rule 1106)

HOODS FORM C-103
(Rev. 3-55)
N.M.O.C.C.
APR 22 1964

Name of Company Coastal States Gas Producing Company				Address P.O. Box 385, Abilene, Texas			
Lease Redfern State		Well No. 1	Unit Letter G	Section 16	Township 9-S	Range 33-E	
Date Work Performed 4-18-64		Pool Undesignated			County Lea		

THIS IS A REPORT OF: (Check appropriate block)

- ☐ Beginning Drilling Operations
 ☒ Casing Test and Cement Job
 ☐ Other (Explain):
☐ Plugging
 ☒ Remedial Work

Detailed account of work done, nature and quantity of materials used, and results obtained.

SPUD DATE: 3-31-64

Ran 4- $\frac{1}{2}$ " 10.5#, J-55 8rd Casing (4529') and set at 4531'. Cemented with 200 sks 1:1 Pozmix w/ 2% sodium chloride and 100 sks Class "C" cement w/ 2% sodium chloride. Cement did not circulate. P-D @ 9:05 p.m. 4-18-64. WOC - 24 hours. Tested casing to 1500# - held O. K. Cemented by Dowell.

Perforated 4499-4501', 4505-08', 4513-17', 4525-30' w/ 2 jet shots/ft.

Witnessed by Slim Taylor	Position Tool Pusher	Company Wes-Tex Drilling Company
------------------------------------	--------------------------------	--

FILL IN BELOW FOR REMEDIAL WORK REPORTS ONLY

ORIGINAL WELL DATA

D F Elev.	T D	P B T D	Producing Interval	Completion Date
Tubing Diameter	Tubing Depth	Oil String Diameter	Oil String Depth	
Perforated Interval(s)				
Open Hole Interval		Producing Formation(s)		

RESULTS OF WORKOVER

Test	Date of Test	Oil Production BPD	Gas Production MCFPD	Water Production BPD	GOR Cubic feet/Bbl	Gas Well Potential MCFPD
Before Workover						
After Workover						

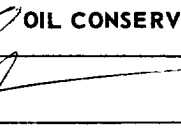
OIL CONSERVATION COMMISSION		I hereby certify that the information given above is true and complete to the best of my knowledge.	
Approved by 		Name Joe R. Howard	
Title Engineer		Position Production Superintendent	
Date APR 22 1964		Company Coastal States Gas Producing Company	

NUMBER OF COPIES RECEIVED	
DISTRIBUTION	
SANTA FE	
P.L.E.	
U.S.G.S.	
LAND OFFICE	
TRANSPORTER	OIL GAS
PRODUCTION OFFICE	
OPERATOR	

NEW MEXICO OIL CONSERVATION COMMISSION FORM C-103
(Rev 3-55)
MISCELLANEOUS REPORTS ON WELLS
OFFICE O. C. C.

(Submit to appropriate District Office as per Commission Rule 1108)

APR 16 10 50 AM '64

Name of Company Coastal States Gas Producing Company				Address P. O. Box 385, Abilene, Texas			
Lease Redfern State	Well No. 1	Unit G	Letter 16	Section 9-S	Township 33-E	Range 33-E	
Date Work Performed 3-31-64	Pool Undesignated			County Lea			

THIS IS A REPORT OF: (Check appropriate block)

<input checked="" type="checkbox"/> Beginning Drilling Operations	<input checked="" type="checkbox"/> Casing Test and Cement Job	<input type="checkbox"/> Other (Explain):
<input type="checkbox"/> Plugging	<input type="checkbox"/> Remedial Work	

Detailed account of work done, nature and quantity of materials used, and results obtained.

SPUD DATE: 4:00 P.M., 3/31/64

Ran 12 joints (364') 8-5/8", 24#, J-55 Casing set @ 373'. Cemented with 130 sks Class "A" Cement with 2% CaCl. Cement circulated. Plug-down at 2:00 a.m. WOC - 24 hours. Tested casing to 1000# for 30 minutes - held O. K. Cemented by Dowell.

Witnessed by Slim Taylor	Position Tool Pusher	Company Wes-Tex Drilling Company
------------------------------------	--------------------------------	--

FILL IN BELOW FOR REMEDIAL WORK REPORTS ONLY

ORIGINAL WELL DATA

D F Elev.	T D	P B T D	Producing Interval	Completion Date
Tubing Diameter	Tubing Depth	Oil String Diameter	Oil String Depth	
Perforated Interval(s)				
Open Hole Interval			Producing Formation(s)	

RESULTS OF WORKOVER

Test	Date of Test	Oil Production BPD	Gas Production MCFPD	Water Production BPD	GOR Cubic feet/Bbl	Gas Well Potential MCFPD
Before Workover						
After Workover						

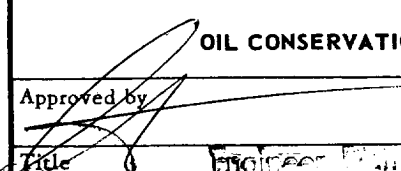
OIL CONSERVATION COMMISSION		I hereby certify that the information given above is true and complete to the best of my knowledge.	
Approved by 	Name J. R. Howard	Position Production Superintendent	
Title Engineer	Company Coastal States Gas Producing Co.		
Date APR 16 1964			

NEW MEXICO OIL CONSERVATION COMMISSION

Santa Fe, New Mexico

NOTICE OF INTENTION TO DRILL

NUMBER OF COPIES RECEIVED	
DISTRIBUTION	
SANTA FE	
FILE	
U.S.O.S.	
LAND OFFICE	
TRANSPORTER	OIL
	GAS
PRORATION OFFICE	
OPERATOR	

Notice must be given to the District Office of the Oil Conservation Commission and approval obtained before drilling or recompletion begins. If changes in the proposed plan are considered advisable, a copy of this notice showing such changes will be returned to the sender. Submit this notice in QUINTUPLICATE. One copy will be returned following approval. See additional instructions in Rules and Regulations of the Commission. If State Land submit 6 Copies. Attach Form C-128 in triplicate to first 3 copies of Form C-101.

Abilene, Texas

3-19-64

(Place)

(Date)

OIL CONSERVATION COMMISSION
SANTA FE, NEW MEXICO

Gentlemen:

You are hereby notified that it is our intention to commence the Drilling of a well to be known as
Coastal States Gas Producing Company's

Redfern State

(Company or Operator)

1

G

, Well No. _____, in _____ The well is

(Lease)

1997.9

feet from the

East

line and

1977.5

(Unit)

feet from the

North

line of Section

16

T 9-S

R 33-E

NMPM.

(GIVE LOCATION FROM SECTION LINE)

Flying "M" San Andres

Pool,

Lea

County

K-2129

If State Land the Oil and Gas Lease is No. _____

If patented land the owner is _____

Address _____

Rotary

We propose to drill well with drilling equipment as follows: _____

The status of plugging bond is _____

Filed

Drilling Contractor _____ Contract Not Let as Yet

We intend to complete this well in the _____ San Andres

formation at an approximate depth of _____ 4600 _____ feet.

CASING PROGRAM

We propose to use the following strings of Casing and to cement them as indicated:

Size of Hole	Size of Casing	Weight per Foot	New or Second Hand	Depth	Sacks Cement
12-1/4"	8-5/8"	24#	New	350'	200 (Circ)
7-7/8"	4-1/2"	10.5#	"	4600'	300

If changes in the above plans become advisable we will notify you immediately.

ADDITIONAL INFORMATION (If recompletion give full details of proposed plan of work.)

Approved _____, 19____
Except as follows:

Sincerely yours,

COASTAL STATES GAS PRODUCING COMPANY

By _____ (Company or Operator)

Position _____ Production Superintendent

Send Communications regarding well to

Coastal States Gas Producing Co.

Name _____

Address _____ P. O. Box 385, Abilene, Texas

OIL CONSERVATION COMMISSION

By _____

NEW MEXICO OIL CONSERVATION COMMISSION **OFFICE O.C. FORM C-128**
WELL LOCATION AND ACREAGE DEDICATION PLAT **Revised 5/1/57**

SEE INSTRUCTIONS FOR COMPLETING THIS FORM ON THE REVERSE SIDE

SECTION A

Operator COASTAL STATES GAS PRODUCING CO.			Lease REDFERN STATE		Well No. 1
Unit Letter G	Section 16	Township 9 SOUTH	Range 33 EAST	County LEA	
Actual Footage Location of Well: 1997.9 feet from the EAST line and 1977.5 feet from the NORTH line					
Ground Level Elev. 4371.6	Producing Formation San Andres		Pool Flying "M" San Andres		Dedicated Acreage: 40 Acres

1. Is the Operator the only owner in the dedicated acreage outlined on the plat below? YES ☒ NO ____ ("Owner" means the person who has the right to drill into and to produce from any pool and to appropriate the production either for himself or for himself and another. (65-3-29 (e) NMSA 1955 Comp.)
2. If the answer to question one is "no," have the interests of all the owners been consolidated by communitization agreement or otherwise? YES ____ NO ____ . If answer is "yes," Type of Consolidation ____
3. If the answer to question two is "no," list all the owners and their respective interests below:

Owner Coastal States Gas Producing Company	Land Description 1997.9 FNL & 1977.5 FNL, Unit G, Sec 16, T-9S, R-33E, Lea County, N.M.
--	---

SECTION B

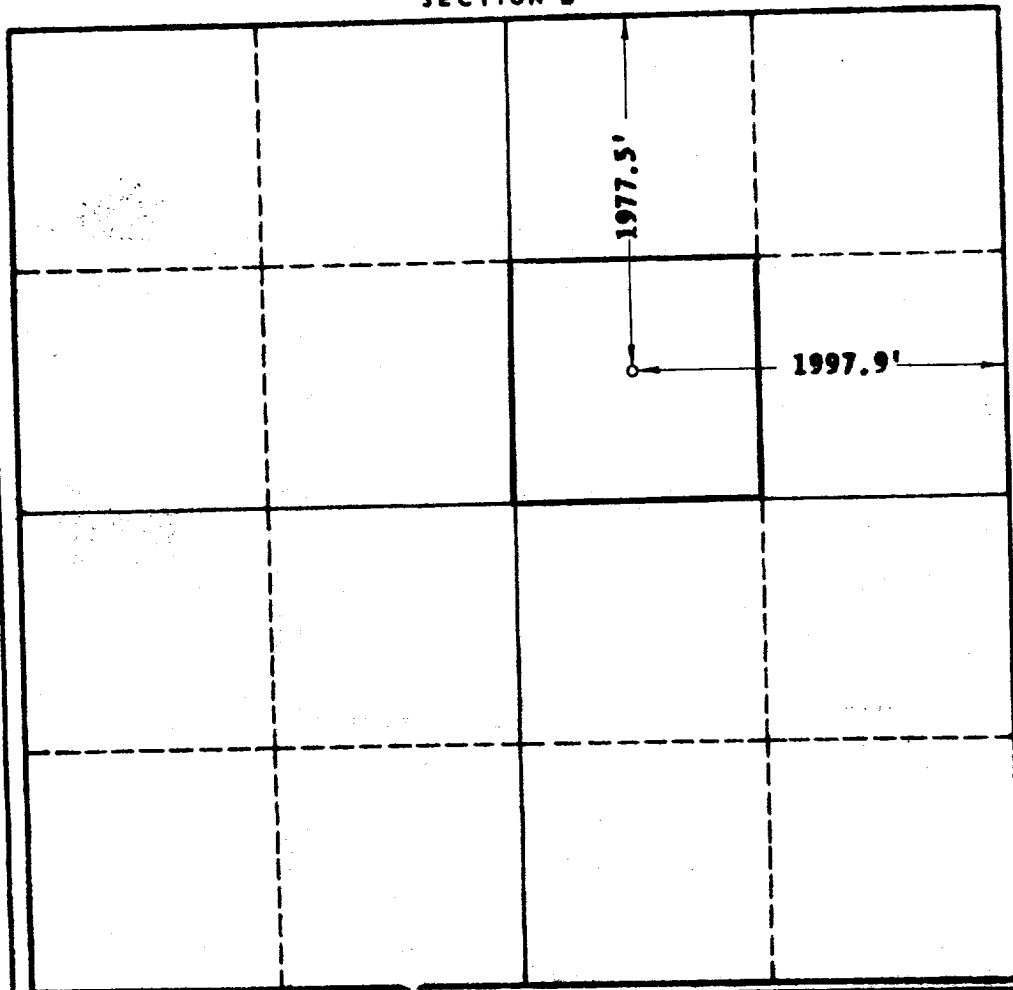

CERTIFICATION

I hereby certify that the information in SECTION A above is true and complete to the best of my knowledge and belief.

Name	Joe R. Howard
Position	Production Superintendent
Company	Coastal States Gas Producing Company
Date	3-19-64

I hereby certify that the well location shown on the plat in SECTION B was plotted from field notes of actual surveys made by me or under my supervision, and that the same is true and correct to the best of my knowledge and belief.

Date Surveyed	3-17-1964
Registered Professional Engineer and/or Land Surveyor, JOHN W. WEST	
Certificate No.	N.M. - P.E. & L.S. NO. 676

0 330 660 990 1320 1650 1980 2310 2640 2970 3300