

NEW MEXICO OIL CONSERVATION COMMISSION
WELL LOCATION AND ACREAGE DEDICATION PLAT

FORM C-128
Revised 5/1/57

SEE INSTRUCTIONS FOR COMPLETING THIS FORM ON THE REVERSE SIDE

SECTION A

| | | | | |
|--|--|--------------------------------|--|---------------------------------|
| Operator COASTAL STATES GAS PRODUCING CO. | | Lease SINCLAIR-STATE | | Well No. 2 |
| Unit Letter "J" | Section 20 | Township 9-S | Range 33 E | County LEA |
| Actual Footage Location of Well: 1980 feet from the SOUTH line and 1993 feet from the EAST line | | | | |
| Ground Level Elev. 4363 | Producing Formation SAN ANDRES | | Pool FLYING "M" - SAN ANDRES | Dedicated Acreage: 40 |

1. Is the Operator the only owner in the dedicated acreage outlined on the plat below? YES ☒ NO ____ ("Owner" means the person who has the right to drill into and to produce from any pool and to appropriate the production either for himself or for himself and another. (65-3-29 (e) NMSA 1935 Comp.)
2. If the answer to question one is "no," have the interests of all the owners been consolidated by communitization agreement or otherwise? YES ____ NO ____ . If answer is "yes," Type of Consolidation ____
3. If the answer to question two is "no," list all the owners and their respective interests below:

| | |
|--|---|
| Owner Coastal States Gas Producing Company | Land Description 1980' FEL & 1993' FEL, Unit J, Sec |
| P. O. Box 385, Abilene, Texas | 20, T-33, R-33E, Lea County, New M. |

SECTION B

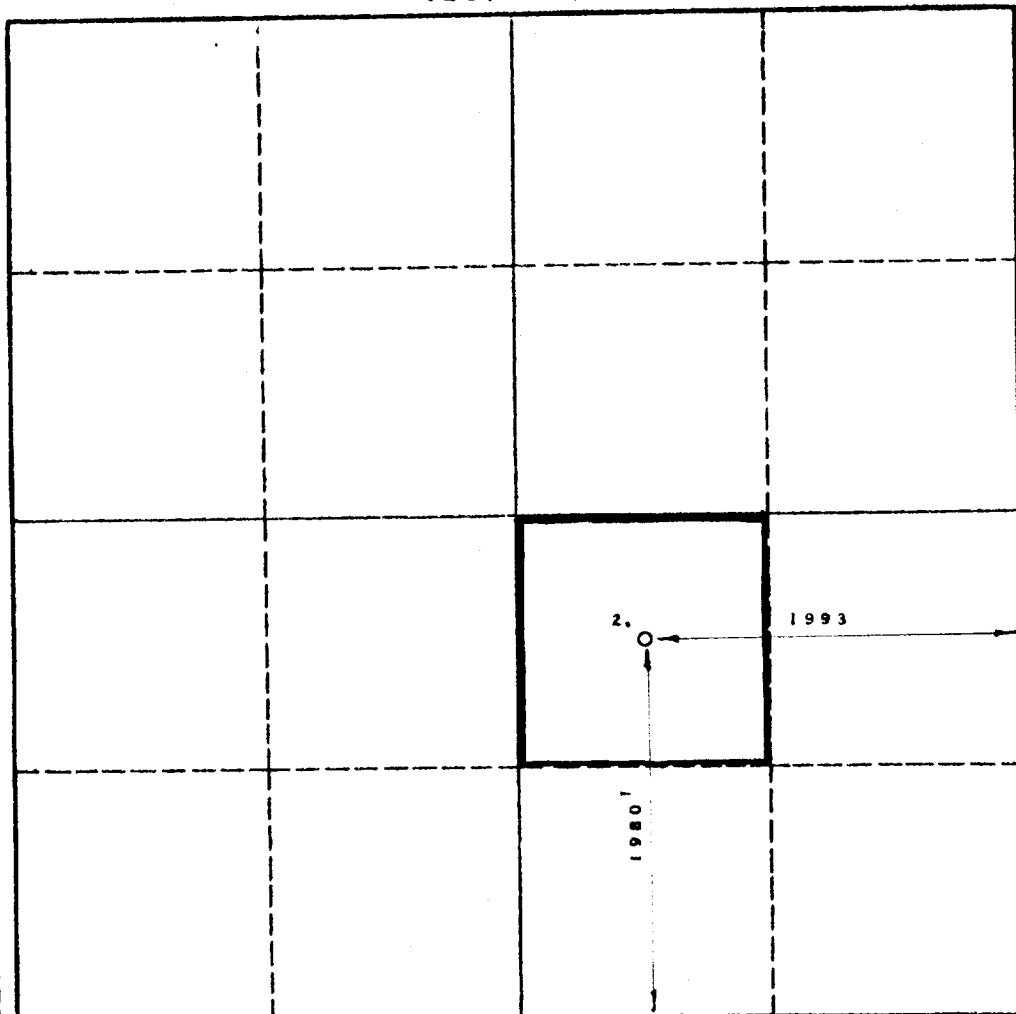

CERTIFICATION

I hereby certify that the information in SECTION A above is true and complete to the best of my knowledge and belief.

Name **J. P. Havens**
Position **Production Supt.**
Company **COASTAL STATES GAS PRODUCING COMPANY**
Date **June 29, 1964**

I hereby certify that the well location shown on the plat in SECTION B was plotted from field notes of actual surveys made by me or under my supervision, and that the same is true and correct to the best of my knowledge and belief.

Date Surveyed
JUNE 24, 1964
Registered Professional Engineer and/or Land Surveyor
MAX A. SCHUMAKER JR.
Certificate No. **1519**

0 330 660 990 1320 1650 1980 2310 2640 2000 1500 1000 500 0