

DISTRIBUTION	
SANTA FE	
FILE	
U.S.G.S.	
LAND OFFICE	
TRANSPORTER	OIL
	GAS
PRODUCTION OFFICE	
OPERATOR	

NEW MEXICO OIL CONSERVATION COMMISSION  
Santa Fe, New Mexico

Revised 12/1/64

## NOTICE OF INTENTION TO DRILL

Notice must be given to the District Office of the Oil Conservation Commission and approval obtained before drilling or recompletion begins. If changes in the proposed plan are considered advisable, a copy of this notice showing such changes will be returned to the sender. Submit this notice in QUINTUPLICATE. One copy will be returned following approval. See additional instructions in Rules and Regulations of the Commission. If State Land submit 6 Copies. Attach Form C-128 in triplicate to first 3 copies of Form C-101.

Roswell, New Mexico  
(Place)

December 8, 1964  
(Date)

OIL CONSERVATION COMMISSION  
SANTA FE, NEW MEXICO

Gentlemen:

You are hereby notified that it is our intention to commence the Drilling of a well to be known as  
Jack L. McClellan and Len Mayer

(Company or Operator)

Deloris State, Well No. 1, in E The well is  
(Lease) (Unit)  
located 1980 feet from the North line and 660 feet from the  
West line of Section 17, T. 9-South, R. 32-East, NMPM.

(GIVE LOCATION FROM SECTION LINE) Wildcat Pool, Lea County

D	C	B	A
E	F	G	H
L	K	J	I
M	N	O	P

If State Land the Oil and Gas Lease is No. K-4258

If patented land the owner is

Address

We propose to drill well with drilling equipment as follows: Rotary from  
surface to estimated 4200 feet.

The status of plugging bond is Statewide

Drilling Contractor Monarch Drilling Company, Hobbs, New Mexico

We intend to complete this well in the San Andres  
formation at an approximate depth of 4200 feet.

### CASING PROGRAM

We propose to use the following strings of Casing and to cement them as indicated:

Size of Hole	Size of Casing	Weight per Foot	New or Second Hand	Depth	Sacks Cement
12-1/4	8-5/8	23 lb.	Used	360	150 circ.
7-7/8	4-1/2	9-1/2 lb.	New	4200	150 sx.

If changes in the above plans become advisable we will notify you immediately.

ADDITIONAL INFORMATION (If recompletion give full details of proposed plan of work.)

Approved \_\_\_\_\_, 19\_\_\_\_  
Except as follows:

OIL CONSERVATION COMMISSION

By \_\_\_\_\_

Sincerely yours,

Jack L. McClellan and Len Mayer

(Company or Operator)

By Jack L. McClellan

Position Operator

Send Communications regarding well to

Name Jack L. McClellan

Address P. O. Box 848, Roswell, New Mexico

NEW MEXICO OIL CONSERVATION COMMISSION  
WELL LOCATION AND ACREAGE DEDICATION PLAT.

FORM C-128  
Revised 5/1/57

SEE INSTRUCTIONS FOR COMPLETING THIS FORM ON THE REVERSE SIDE.

SECTION A

Operator Jack L. McClellan and Len Mayer			Lease Deloris STATE		Well No. 1-17
Unit Letter E	Section 17	Township 9 SOUTH	Range 32 EAST	County LEA	
Actual Footage Location of Well: 1980 feet from the NORTH line and 660 feet from the WEST line					
Ground Level Elev. 4428.5	Producing Formation San Andres		Pool Wildcat	Dedicated Acreage: 40 Acres	

1. Is the Operator the only owner in the dedicated acreage outlined on the plat below? YES ☒ NO \_\_\_\_ . ("Owner" means the person who has the right to drill into and to produce from any pool and to appropriate the production either for himself or for himself and another. (65-3-29 (e) NMSA 1935 Comp.)
2. If the answer to question one is "no," have the interests of all the owners been consolidated by communitization agreement or otherwise? YES \_\_\_\_ NO \_\_\_\_ . If answer is "yes," Type of Consolidation \_\_\_\_
3. If the answer to question two is "no," list all the owners and their respective interests below:

Owner	Land Description

SECTION B

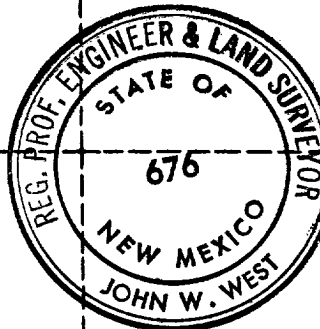
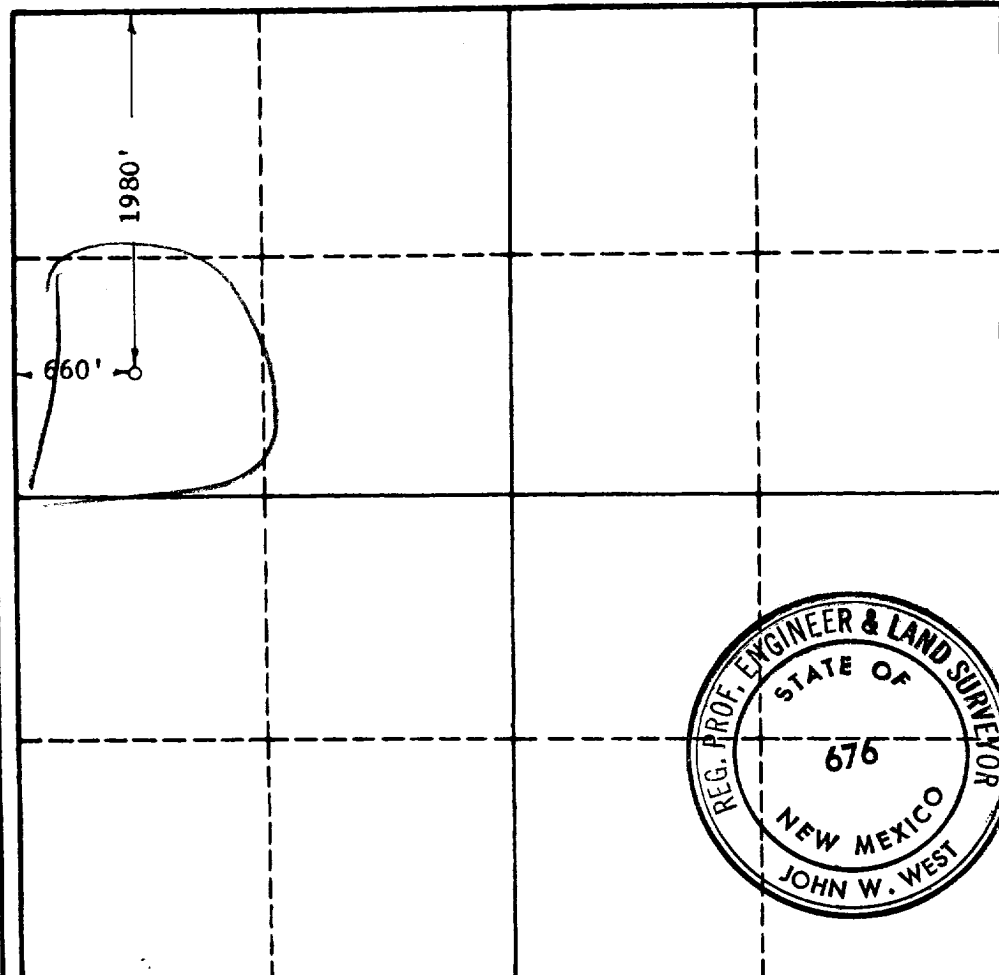

CERTIFICATION

I hereby certify that the information in SECTION A above is true and complete to the best of my knowledge and belief.

Name  
*Jack L. McClellan*  
Position  
Operator  
Company  
Jack L. McClellan  
Date  
December 8, 1964

I hereby certify that the well location shown on the plat in SECTION B was plotted from field notes of actual surveys made by me or under my supervision, and that the same is true and correct to the best of my knowledge and belief.

Date Surveyed  
NOVEMBER 27, 1964  
Registered Professional Engineer and/or Land Surveyor, JOHN W. WEST  
*John W. West*  
Certificate No.  
N.M. - P.E. & L.S. NO. 676