

NUMBER OF COPIES RECEIVED	
DISTRIBUTION	
SANTA FE	
FILE	
U.S.G.S.	
LAND OFFICE	
TRANSPORTER	OIL GAS
PRODUCTION OFFICE	
OPERATOR	

NEW MEXICO OIL CONSERVATION COMMISSION

FORM C-128
Revised 5/1/57

WELL LOCATION AND ACREAGE DEDICATION PLAT

SEE INSTRUCTIONS FOR COMPLETING THIS FORM ON THE REVERSE SIDE

RECEIVED
AUG 17 8 43 AM '64
JUL 30 3 14 PM '64
OFFICE O.C.C.

SECTION A

Operator Norman L. Stevens, Jr.		Lease State (OG-10)		Well No. 1
Unit Letter 0	Section 18	Township T-10-S	Range R-32-E	County Lea
Actual Footage Location of Well: 990 feet from the South line and 1650 feet from the East line				
Ground Level Elev. 4355	Producing Formation San Andres		Pool	Dedicated Acreage: 40 Acres

- Is the Operator the only owner in the dedicated acreage outlined on the plat below? YES _____ NO _____. ("Owner" means the person who has the right to drill into and to produce from any pool and to appropriate the production either for himself or for himself and another. (65-3-29 (e) NMSA 1935 Comp.)
- If the answer to question one is "no," have the interests of all the owners been consolidated by communitization agreement or otherwise? YES _____ NO _____. If answer is "yes," Type of Consolidation _____
- If the answer to question two is "no," list all the owners and their respective interests below:

Owner	Land Description

SECTION B

R-32-E

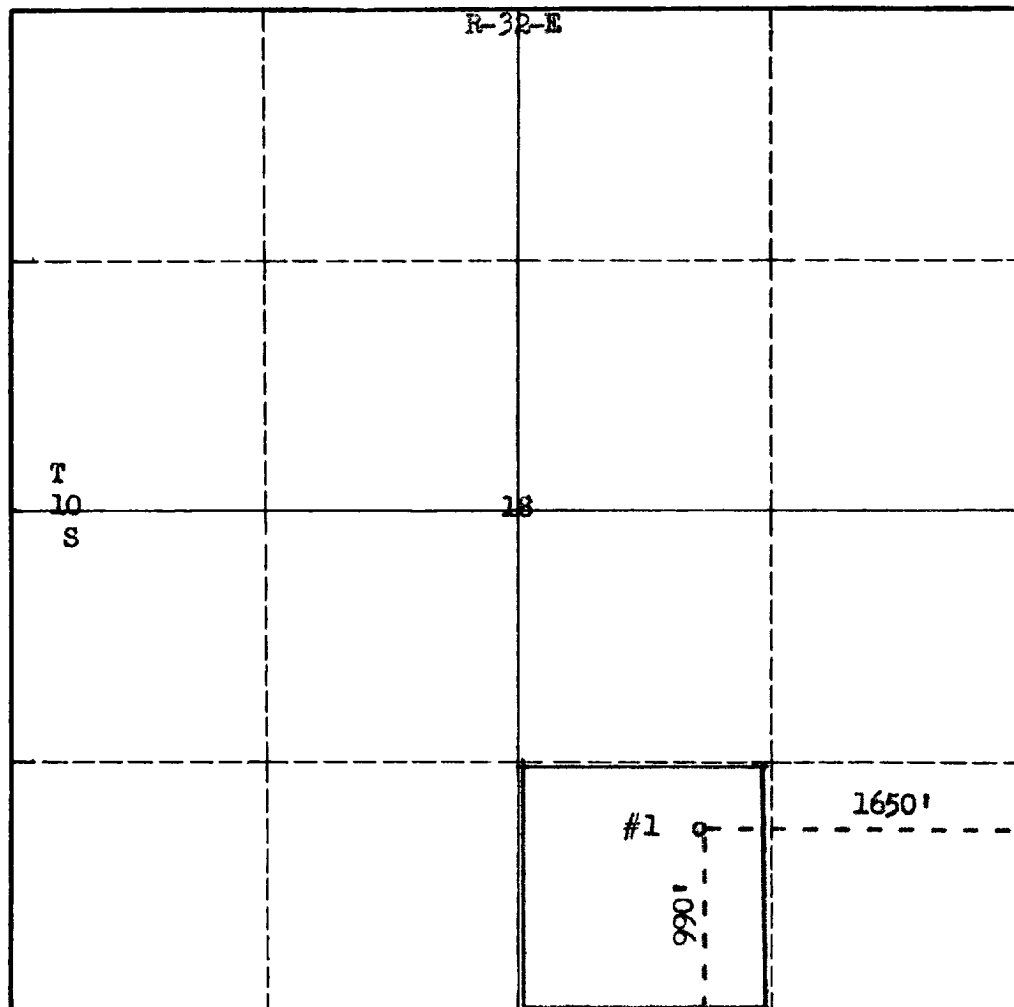

CERTIFICATION

I hereby certify that the information in SECTION A above is true and complete to the best of my knowledge and belief.

Name
Position
Company
Date

I hereby certify that the well location shown on the plat in SECTION B was plotted from field notes of actual surveys made by me or under my supervision, and that the same is true and correct to the best of my knowledge and belief.

Date Surveyed July 28, 1964
Registered Professional Engineer and/or Land Surveyor <i>James H. Brown</i>
Certificate No. 542