

NEW MEXICO OIL CONSERVATION COMMISSION
WELL LOCATION AND ACREAGE DEDICATION PLAT

FORM C-126
Revised 3/1/57

SEE INSTRUCTIONS FOR COMPLETING THIS FORM ON THE REVERSE SIDE

SECTION A

Operator U. S. SMELTING, REFINING & MINING CO.		Lease L. PROCTOR		Well No. 1
Unit Letter 1	Section 5	Township 11 SOUTH	Range 32 EAST	County LEA
Actual Footage Location of Well: 990 feet from the NORTH line and 890 feet from the EAST line				
Ground Level Elev.	Producing Formation DEVONIAN	Pool WILDCAT	Dedicated Acreage: LOT 1 (44.5) Acres	

1. Is the Operator the only owner in the dedicated acreage outlined on the plat below? YES ☒ NO ____ ("Owner" means the person who has the right to drill into and to produce from any pool and to appropriate the production either for himself or for himself and another. (65-3-29 (e) NMSA 1935 Comp.)
2. If the answer to question one is "no," have the interests of all the owners been consolidated by communitization agreement or otherwise? YES ____ NO ____ . If answer is "yes," Type of Consolidation ____
3. If the answer to question two is "no," list all the owners and their respective interests below:

Owner	Land Description

SECTION B

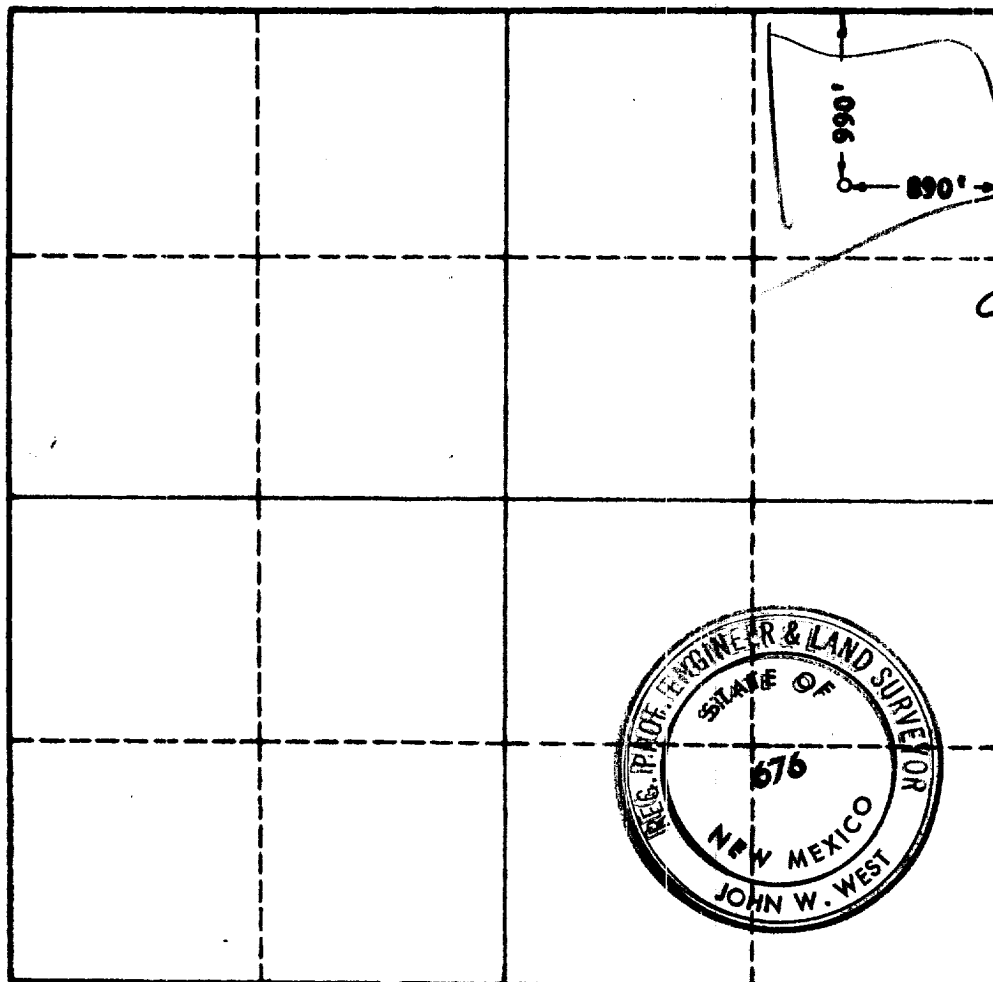

CERTIFICATION

I hereby certify that the information in SECTION A above is true and complete to the best of my knowledge and belief.

Name John W. West
Position **AGENT**
Company **U.S. SMELTING, REF. & MIN.**
Date **3-27-1964**

I hereby certify that the well location shown on the plat in SECTION B was plotted from field notes of actual surveys made by me or under my supervision, and that the same is true and correct to the best of my knowledge and belief.

Date Surveyed **3-26-1964**
Registered Professional Engineer and/or Land Surveyor, **JOHN W. WEST**
John W. West
Certificate No. **N.M. - P.E. & L.S. NO. 676**

0 350 650 950 1250 1550 1850 2150 2450 2750 3050 3350 3650 3950 4250 4550 4850 5150 5450 5750 6050 6350 6650 6950 7250 7550 7850 8150 8450 8750 9050 9350 9650 9950 10000