

NEW MEXICO OIL CONSERVATION COMMISSION  
Santa Fe, New Mexico

Form O-101  
Revised (12/1/55)

## NOTICE OF INTENTION TO DRILL

Notice must be given to the District Office of the Oil Conservation Commission and approval obtained before drilling or recompletion begins. If changes in the proposed plan are considered advisable, a copy of this notice showing such changes will be returned to the sender. Submit this notice in **QUINTUPLICATE**. One copy will be returned following approval. See additional instructions in Rules and Regulations of the Commission. **If State Land submit 6 Copies Attach Form O-128 in triplicate to first 3 copies of form O-101**

Midland, Texas  
(Place)

12-4-64  
(Date)

OIL CONSERVATION COMMISSION  
SANTA FE, NEW MEXICO

Gentlemen:

You are hereby notified that it is our intention to commence the **Drilling** of a well to be known as  
**Humble Oil & Refining Company**  
(Company or Operator)

New Mexico State AF, Well No. 3, in J (Unit). The well is located 2160 feet from the South line and 1980 feet from the East line of Section 27, T. 10-S, R. 32-E, NMPM. (GIVE LOCATION FROM SECTION LINE) Mescalero (San Andres) Pool, Lea County

If State Land the Oil and Gas Lease is No. E-1110

If patented land the owner is.....

Address.....

We propose to drill well with drilling equipment as follows: rotary

The status of plugging bond is on file

Drilling Contractor unknown

We intend to complete this well in the San Andres formation at an approximate depth of 4400 feet.

### CASING PROGRAM

We propose to use the following strings of Casing and to cement them as indicated:

Size of Hole	Size of Casing	Weight per Foot	New or Second Hand	Depth	Sacks Cement
11"	8-5/8	24	New	400	250*
7-7/8	4-1/2	9.5	"	4400	400*

If changes in the above plans become advisable we will notify you immediately.

**ADDITIONAL INFORMATION** (If recompletion give full details of proposed plan of work.)

\*Circl. to surf.

\*\*Circl. back to salt section.

Approved....., 19.....  
Except as follows:

OIL CONSERVATION COMMISSION

By.....

Sincerely yours,

**Humble Oil & Refining Company**

(Company or Operator)  
By J. E. Pinkerton

Position Adm. Specialist

Send Communications regarding well to

Name R. R. McCarty

Address Box 1600, Midland, Texas

Well Location and Acreage Dedication Plat

Section A. Date Dec. 4, 1964  
Operator Humble Oil & Refining Co. Lease New Mexico State "AF"  
Well No. 3 Unit Letter J Section 27 Township 10 South Range 32 East NMPM  
Located 1980 Feet From East Line, 2160 Feet From South Line  
County Lea G. L. Elevation Later Dedicated Acreage 40 Acres  
Name of Producing Formation San Andres Pool Mescalero

1. Is the Operator the only owner\* in the dedicated acreage outlined on the plat below?  
Yes ☒ No ☐  
2. If the answer to question one is "no", have the interests of all the owners been consolidated by communitization agreement or otherwise? Yes ☐ No ☐ If answer is "yes," Type of Consolidation \_\_\_\_\_  
3. If the answer to question two is "no," list all the owners and thier respective interests below:

<u>Owner</u>	<u>Land Description</u>
--------------	-------------------------

Section B

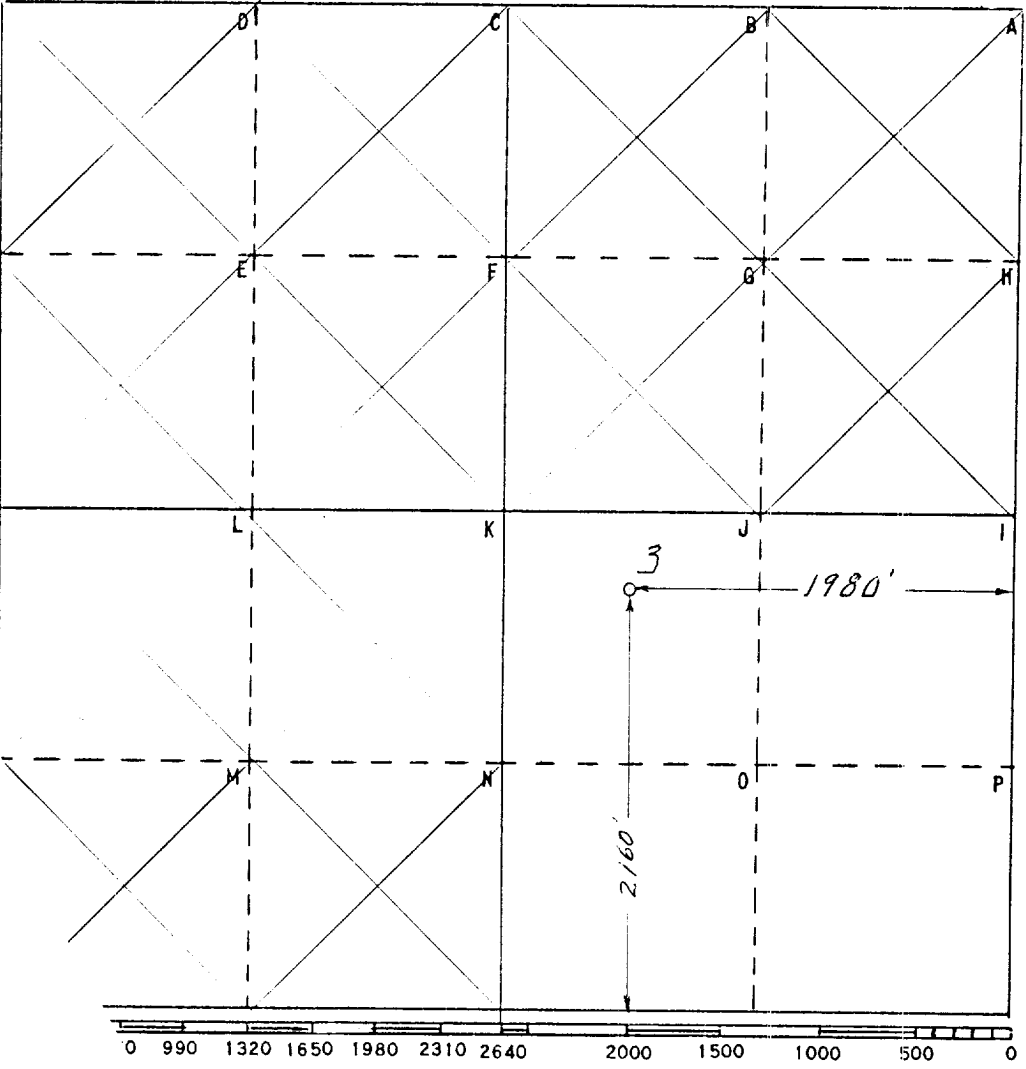

This is to certify that the information in Section A above is true and complete to the best of my knowledge and belief

HUMBLE OIL & REFG. CO.  
(Operator)  
J. E. Pinkerton  
(Representative)  
Box 1600 Midland, Texas  
Address

This is to certify that the well location shown on the plat in Section B was plotted from field notes of actual surveys made by me or under my supervision and that the same is true and correct to the best of my knowledge and belief.

Date Surveyed 12-2-64  
W. S. Westorf  
Registered Professional  
Engineer and/or Land Surveyor  
Certificate No. 1382