

| | |
|---------------------------|-----|
| NUMBER OF COPIES RECEIVED | |
| DISTRIBUTION | |
| SANTA FE | |
| FILE | |
| U.S.G.S. | |
| LAND OFFICE | |
| TRANSPORTER | OIL |
| | GAS |
| PRODUCTION OFFICE | |
| OPERATOR | |

NEW MEXICO OIL CONSERVATION COMMISSION
Santa Fe, New Mexico

Form C-101
Revised 12/1/55

NOTICE OF INTENTION TO DRILL

Notice must be given to the District Office of the Oil Conservation Commission and approval obtained before drilling or recompletion begins. If changes in the proposed plan are considered advisable, a copy of this notice showing such changes will be returned to the sender. Submit this notice in QUINTUPLE COPIES. One copy will be returned following approval. See additional instructions in Rules and Regulations of the Commission. If State Land submit 6 Copies. Attach Form C-128 in triplicate to first 3 copies of Form C-101.

Roswell, New Mexico

(Place)

January 3, 1965

(Date)

OIL CONSERVATION COMMISSION
SANTA FE, NEW MEXICO

Gentlemen:

You are hereby notified that it is our intention to commence the Drilling of a well to be known as

Jack L. McClellan and Len Mayer

(Company or Operator)

Oil Well No. 1, in 1 (Unit) The well is located 660 feet from the East line of Section 21, T 10-N, R 22-E, NMPM.

(GIVE LOCATION FROM SECTION LINE) Designated Pool, 1st County

| | | | |
|---|---|---|---|
| D | C | B | A |
| E | F | G | H |
| L | K | J | I |
| M | N | O | Φ |

If State Land the Oil and Gas Lease is No. 30-1982

If patented land the owner is _____

Address _____

We propose to drill well with drilling equipment as follows: Rotary from

Surface

The status of plugging bond is to be paid

Drilling Contractor George Drilling Company
1000, New Mexico

We intend to complete this well in the Oil (Liquor)
formation at an approximate depth of 4100 feet.

CASING PROGRAM

We propose to use the following strings of Casing and to cement them as indicated:

| Size of Hole | Size of Casing | Weight per Foot | New or Second Hand | Depth | Sacks Cement |
|--------------|----------------|-----------------|--------------------|-------|----------------|
| 12-3/4" | 8-5/8" | | Used | 500 | 200 Sx (Circ.) |
| 7-7/8" | 6-1/2" | 11.2 | New | 4800 | 200 Sx |
| | | | | | |
| | | | | | |

If changes in the above plans become advisable we will notify you immediately.

ADDITIONAL INFORMATION (If recompletion give full details of proposed plan of work.)

*An alternate plan will be to set surface with cable tools and rotary from that point to total depth.

Approved _____
Except as follows:

Sincerely yours,

Jack L. McClellan and Len Mayer

(Company or Operator)

By Jack L. McClellan
Operator

Position _____

Send Communications regarding well to

Jack L. McClellan

Name _____

Box 843, Roswell, New Mexico

Address _____

OIL CONSERVATION COMMISSION

By _____

NEW MEXICO OIL CONSERVATION COMMISSION
WELL LOCATION AND ACREAGE DEDICATION PLAT

FORM C-128
Revised 5/1/57

SEE INSTRUCTIONS FOR COMPLETING THIS FORM ON THE REVERSE SIDE

SECTION A

| | | | | |
|--|-----------------------------------|----------------------|--------------------------------|---------------|
| Operator JACK L. MCCLELLAN & LEN MAYER | | Lease STATE 28 | | Well No. 1 |
| Unit Letter P | Section 23 | Township 10 SOUTH | Range 32 EAST | County LEA |
| Actual Footage Location of Well: 660 feet from the SOUTH line and 660 feet from the EAST line | | | | |
| Ground Level Elev. | Producing Formation San Andres | Pool Undesignated | Dedicated Acreage: 40 Acres | |

1. Is the Operator the only owner in the dedicated acreage outlined on the plat below? YES ☒ NO ☐ "Owner" means the person who has the right to drill into and to produce from any pool and to appropriate the production either for himself or for himself and another. (65-3-29 (e) NMSA 1935 Comp.)
2. If the answer to question one is "no," have the interests of all the owners been consolidated by communitization agreement or otherwise? YES ☐ NO ☐ If answer is "yes" Type of Consolidation _____
3. If the answer to question two is "no," list all the owners and their respective interests below:

| Owner | Land Description |
|-------|------------------|
| | |
| | |

SECTION B

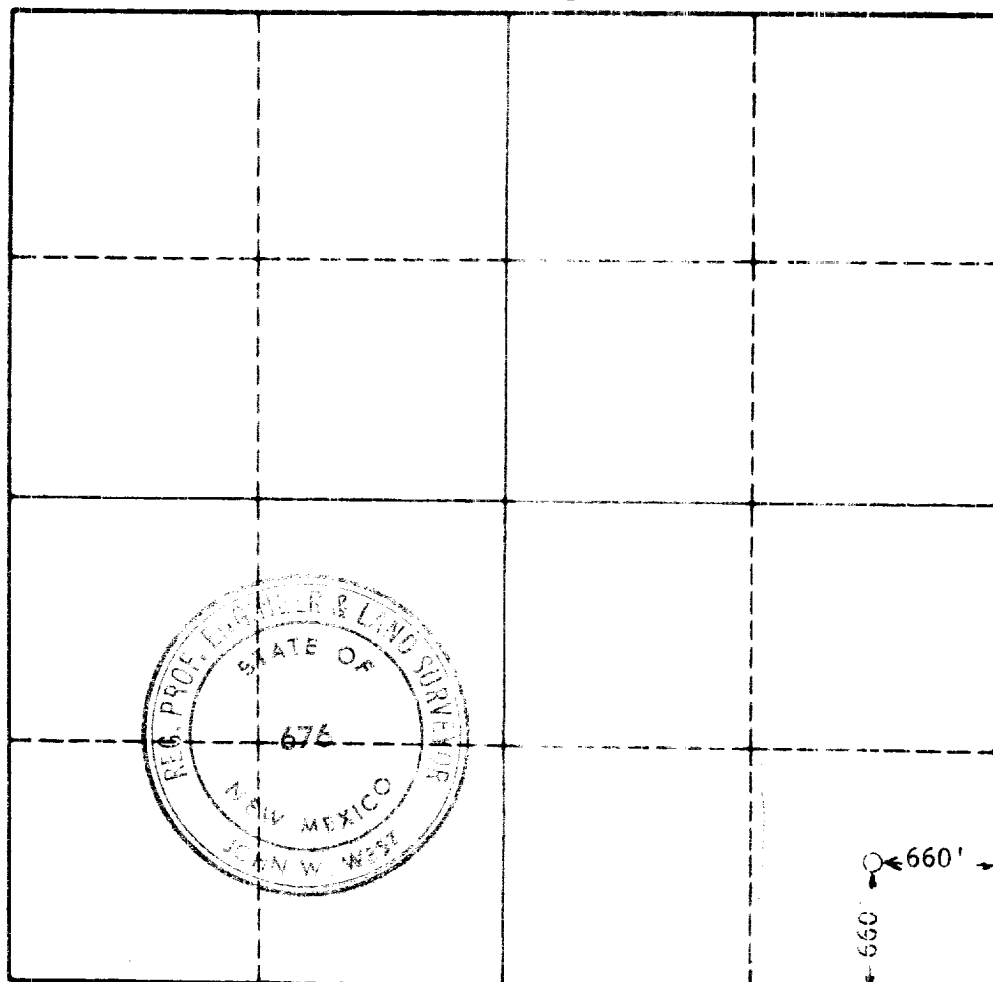

CERTIFICATION

I hereby certify that the information in SECTION A above is true and complete to the best of my knowledge and belief.

Name
J. McClellan
Position
Operator
Company
Jack L. McClellan & Len Mayer
Date
January 8, 1965

I hereby certify that the well location shown on the plat in SECTION B was plotted from field notes of actual surveys made by me or under my supervision, and that the same is true and correct to the best of my knowledge and belief.

Date Surveyed
JAN 8, 1965
Registered Professional Engineer and/or Land Surveyor, JOHN W. WEST
Certificate No.
N.M. - P.E. & L.S. NO. 676