

| NUMBER OF COPIES RECEIVED | |
|---------------------------|-----|
| DISTRIBUTION | |
| SANTA FE | |
| FILE | |
| U.S.G.P. | |
| LAND OFFICE | |
| TRANSPORTER | OIL |
| | GAS |
| PRODUCTION OFFICE | |
| OPERATOR | |

NEW MEXICO OIL CONSERVATION COMMISSION
Santa Fe, New Mexico

Form C-101
Revised (12/1/55)

NOTICE OF INTENTION TO DRILL

Notice must be given to the District Office of the Oil Conservation Commission and approval obtained before drilling or recompletion begins. If changes in the proposed plan are considered advisable, a copy of this notice showing such changes will be returned to the sender. Submit this notice in **QUINTUPLICATE**. One copy will be returned following approval. See additional instructions in Rules and Regulations of the Commission. If State Land submit 6 Copies Attach Form C- 128 in triplicate to first 3 copies of form C-101

Midland, Texas
(Place)

February 2, 1965
(Date)

OIL CONSERVATION COMMISSION
SANTA FE, NEW MEXICO

Gentlemen:

You are hereby notified that it is our intention to commence the **Drilling** of a well to be known as

Burleson & Huff
(Company, or Operator)

Pure State
(Lease)

, Well No. 1, in D Unit

The well is

located 760 feet from the West line and 660 feet from the

North line of Section 11, T. 9-S, R. 33-E, NMPM.

(GIVE LOCATION FROM SECTION LINE) Undesignated Pool, Lea County

If State Land the Oil and Gas Lease is No. OG 1504

If patented land the owner is

Address

We propose to drill well with drilling equipment as follows: Rotary to total
depth at about 4700 feet.

The status of plugging bond is valid and effective.

Drilling Contractor Sitton and Norton Drilling Co.,
Lubbock, Texas

We intend to complete this well in the Slaughter zone of San Andres
formation at an approximate depth of 4700 feet.

CASING PROGRAM

We propose to use the following strings of Casing and to cement them as indicated:

| Size of Hole | Size of Casing | Weight per Foot | New or Second Hand | Depth | Sacks Cement |
|----------------|----------------|-----------------|--------------------|--------------|--------------|
| <u>12 1/2"</u> | <u>8-5/8"</u> | <u>20 lb.</u> | <u>new</u> | <u>270'</u> | <u>225</u> |
| <u>6-3/4"</u> | <u>4 1/2"</u> | <u>9.5 lb</u> | <u>new</u> | <u>T. D.</u> | <u>250</u> |

If changes in the above plans become advisable we will notify you immediately.

ADDITIONAL INFORMATION (If recompletion give full details of proposed plan of work.)

Approved....., 19.....
Except as follows:

OIL CONSERVATION COMMISSION

By.....

Sincerely yours,

Burleson & Huff
By [Signature]

Position Partner
Send Communications regarding well to

Name Burleson & Huff
Address Box 935, Midland, Texas

NEW MEXICO OIL CONSERVATION COMMISSION
WELL LOCATION AND ACREAGE DEDICATION PLAT

FORM C-128
Revised 5/1/57

SEE INSTRUCTIONS FOR COMPLETING THIS FORM ON THE REVERSE SIDE

SECTION A

| | | | | |
|--|--|----------------------------|-----------------------------|--|
| Operator BURLESON & HUFF | | Lease PURE STATE | | Well No. 1 |
| Unit Letter D | Section 11 | Township 9 SOUTH | Range 33 EAST | County LEA |
| Actual Footage Location of Well: 660 feet from the NORTH line and 760 feet from the WEST line | | | | |
| Ground Level Elev. 4356.0 | Producing Formation San Andres | | Pool Undesignated | Dedicated Acreage: 40.80 Acres |

1. Is the Operator the only owner in the dedicated acreage outlined on the plat below? YES ☒ NO ☐ ("Owner" means the person who has the right to drill into and to produce from any pool and to appropriate the production either for himself or for himself and another. (65-3-29 (e) NMSA 1935 Comp.)
2. If the answer to question one is "no," have the interests of all the owners been consolidated by communitization agreement or otherwise? YES ☐ NO ☐ If answer is "yes," Type of Consolidation _____
3. If the answer to question two is "no," list all the owners and their respective interests below:

| | |
|-------|------------------|
| Owner | Land Description |
| | |
| | |

SECTION B

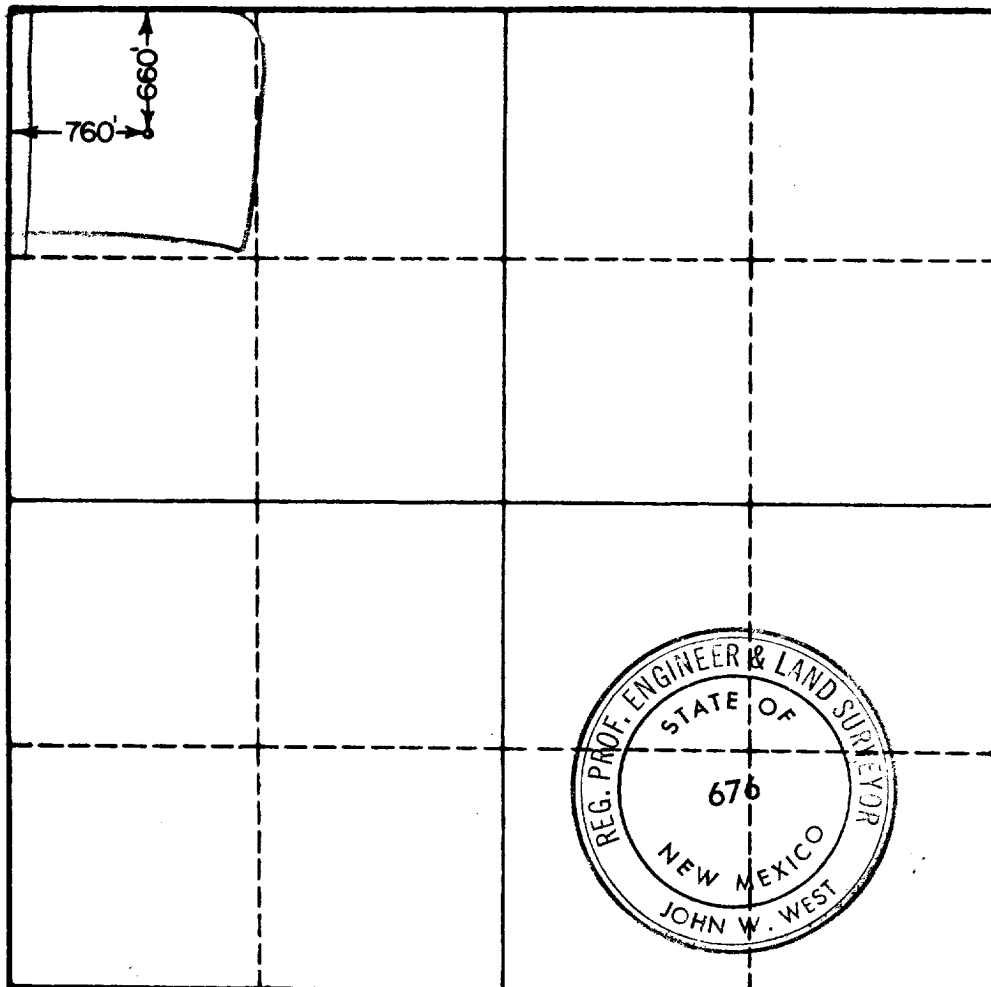

CERTIFICATION

I hereby certify that the information in SECTION A above is true and complete to the best of my knowledge and belief.

| |
|---------------------------------------|
| Name Jack Huff |
| Position Partner |
| Company Burleson & Huff |
| Date 2-2-65 |

I hereby certify that the well location shown on the plat in SECTION B was plotted from field notes of actual surveys made by me or under my supervision, and that the same is true and correct to the best of my knowledge and belief.

| |
|--|
| Date Surveyed 1-30-65 |
| Registered Professional Engineer and/or Land Surveyor, JOHN W. WEST |
| Certificate No. W. M. - P. E. & L. S. NO. 676 |

0 330 660 990 1320 1650 1980 2310 2640 2000 1500 1000 500