

NEW MEXICO OIL CONSERVATION COMMISSION
WELL LOCATION AND ACREAGE DEDICATION PLAT

FORM C-128
Revised 3/1/57

SEE INSTRUCTIONS FOR COMPLETING THIS FORM ON THE REVERSE SIDE

SECTION A

Operator MIDWEST OIL CORP.		Lease SKELLY STATE		Well No. 1
Unit Letter P	Section 10	Township 10 SOUTH	Range 33 EAST	County LEA
Actual Footage Location of Well: 660 feet from the SOUTH line and 660 feet from the EAST line				
Ground Level Elev. 4213.0	Producing Formation Penn		Pool Middle Lana (Permian)	Dedicated Acreage: 80 Acres

1. Is the Operator the only owner in the dedicated acreage outlined on the plat below? YES ☒ NO ☐ ("Owner" means the person who has the right to drill into and to produce from any pool and to appropriate the production either for himself or for himself and another. (65-3-29 (e) NMSA 1955 Comp.)
2. If the answer to question one is "no," have the interests of all the owners been consolidated by communitization agreement or otherwise? YES ☐ NO ☐ If answer is "yes," Type of Consolidation _____
3. If the answer to question two is "no," list all the owners and their respective interests below:

Owner	Land Description

SECTION B

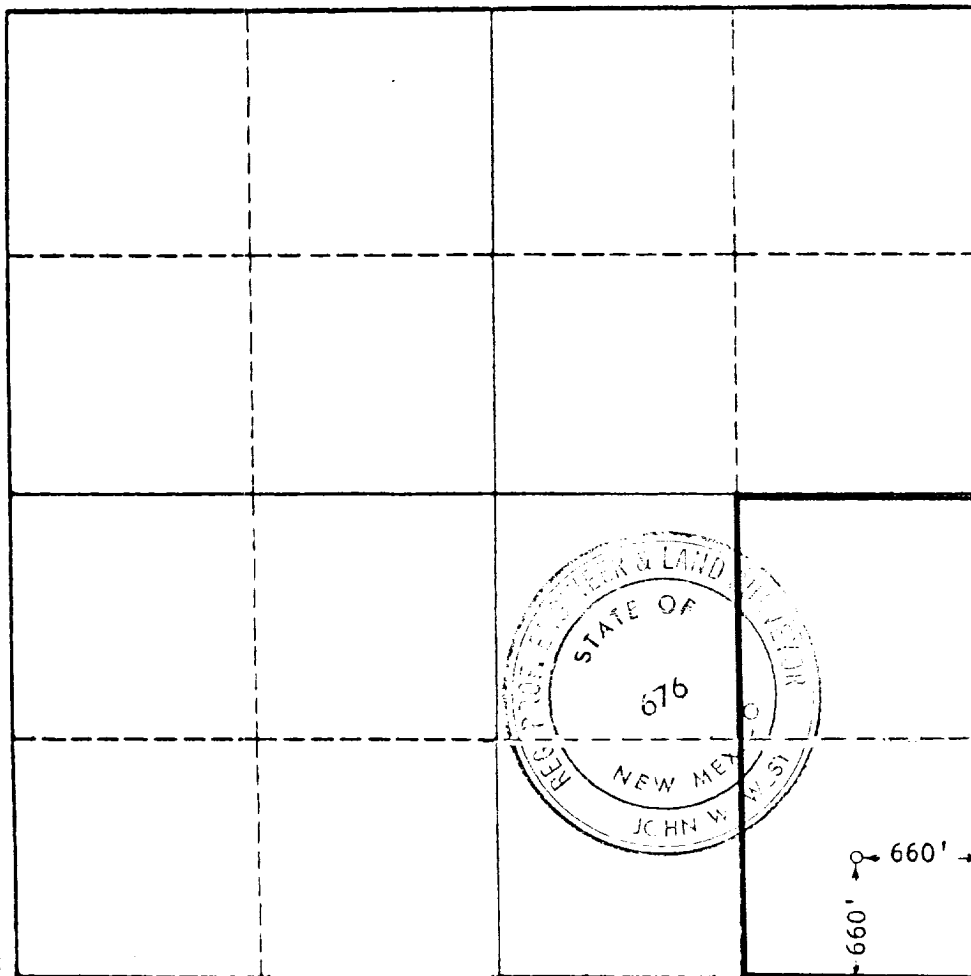

CERTIFICATION

I hereby certify that the information in SECTION A above is true and complete to the best of my knowledge and belief.

Name	<i>John W. West</i>
Position	District Clerk
Company	Midwest Oil Corp.
Date	June 2, 1965

I hereby certify that the well location shown on the plat in SECTION B was plotted from field notes of actual surveys made by me or under my supervision, and that the same is true and correct to the best of my knowledge and belief.

Date Surveyed	JUNE 1, 1965
Registered Professional Engineer and/or Land Surveyor, JOHN W. WEST	
<i>John W. West</i>	
Certificate No.	N.M. - P.E. & L.S. NO. 676

0 330 660 990 1320 1650 1980 2310 2640 2000 1500 1000 500 0