

NO. OF COPIES RECEIVED	
DISTRIBUTION	
SANTA FE	
FILE	
U.S.G.S.	
LAND OFFICE	
OPERATOR	

# NEW MEXICO OIL CONSERVATION COMMISSION

Form C-101  
Revised 1-1-65

SEP 24

5A. Indicate Type of Lease  
 14 MONTHS FEE ☒

5. State Oil & Gas Lease No.

## APPLICATION FOR PERMIT TO DRILL, DEEPEN, OR PLUG BACK

1a. Type of Work DRILL <input checked="" type="checkbox"/> DEEPEN <input type="checkbox"/> PLUG BACK <input type="checkbox"/>		7. Unit Agreement Name
b. Type of Well OIL WELL <input checked="" type="checkbox"/> GAS WELL <input type="checkbox"/> OTHER <input type="checkbox"/> SINGLE ZONE <input checked="" type="checkbox"/> MULTIPLE ZONE <input type="checkbox"/>		8. Farm or Lease Name Bell
2. Name of Operator Delta & Company		9. Well No. 2
3. Address of Operator c/o Oil Reports & Gas Services, Box 763, Hobbs, New Mexico		10. Field and Pool, or Wildcat Upper Undeg. (H. Bagley Penn)
4. Location of Well UNIT LETTER <b>A</b> LOCATED <b>554</b> FEET FROM THE <b>North</b> LINE <b>554</b> <b>East</b> <b>21</b> <b>118</b> <b>33E</b> AND FEET FROM THE LINE OF SEC. TWP. RGE. NMPM		12. County Lea
19. Proposed Depth <b>10,200</b>		19A. Formation Upper Penn
20. Rotary or C.T. Rotary		
21. Elevation (whether DF, RT, etc.) 4264.2	21A. Kind & Status Plug. Bond Blanket	21B. Drilling Contractor Forester Drilling Co.
22. Approx. Date Work will start 9/28/65		

23.

## PROPOSED CASING AND CEMENT PROGRAM

SIZE OF HOLE	SIZE OF CASING	WEIGHT PER FOOT	SETTING DEPTH	SACKS OF CEMENT	EST. TOP
12 1/4	10 3/4	32.75#	350	Circulated	
9 3/4	7 5/8	26#	3750	175	2880
6 3/4	4 1/2	11.6#	10,200	300	8000

\*H-80 and J-55

APPROVAL VALID  
FOR 90 DAYS UNLESS  
DRILLING COMMENCED  
EXPIRES 10-24-65

IN ABOVE SPACE DESCRIBE PROPOSED PROGRAM: IF PROPOSAL IS TO DEEPEN OR PLUG BACK, GIVE DATA ON PRESENT PRODUCTIVE ZONE AND PROPOSED NEW PRODUCTIVE ZONE. GIVE BLOWOUT PREVENTER PROGRAM, IF ANY.

I hereby certify that the information above is true and complete to the best of my knowledge and belief.

Signed H. L. Smith Title Agent Date Sept. 24, 1965

(This space for State Use)

APPROVED BY \_\_\_\_\_ TITLE \_\_\_\_\_ DATE \_\_\_\_\_

CONDITIONS OF APPROVAL, IF ANY:

**NEW MEXICO OIL CONSERVATION COMMISSION**  
**WELL LOCATION AND ACREAGE DEDICATION PLAT**

Form C-102  
 Supersedes C-128  
 Effective 1-1-65

All distances must be from the outer boundaries of the Section.

*SEP 24 10 14 AM '65*

Operator <b>STOLTZ &amp; COMPANY</b>			Lease <b>BELL</b>			Well No. <b>2</b>
Unit Letter <b>A</b>	Section <b>21</b>	Township <b>11 SOUTH</b>	Range <b>33 EAST</b>	County <b>LEA</b>		
Actual Footage Location of Well: <b>554</b> feet from the <b>NORTH</b> line and <b>554</b> feet from the <b>EAST</b> line						
Ground Level Elev. <b>4264.2</b>	Producing Formation <b>Upper Penn</b>		Pool <b>Undes. (North Bagley)</b>		Dedicated Acreage: <b>80</b> Acres	

1. Outline the acreage dedicated to the subject well by colored pencil or hachure marks on the plat below.
2. If more than one lease is dedicated to the well, outline each and identify the ownership thereof (both as to working interest and royalty).
3. If more than one lease of different ownership is dedicated to the well, have the interests of all owners been consolidated by communitization, unitization, force-pooling, etc?

☐ Yes    ☐ No    If answer is "yes," type of consolidation \_\_\_\_\_

If answer is "no," list the owners and tract descriptions which have actually been consolidated. (Use reverse side of this form if necessary.) \_\_\_\_\_

No allowable will be assigned to the well until all interests have been consolidated (by communitization, unitization, forced-pooling, or otherwise) or until a non-standard unit, eliminating such interests, has been approved by the Commission.

**CERTIFICATION**

I hereby certify that the information contained herein is true and complete to the best of my knowledge and belief.

Name *H. L. Smith*  
 Position  
**Agent**  
 Company  
**Stoltz & Company**  
 Date  
**September 24, 1965**

I hereby certify that the well location shown on this plat was plotted from field notes of actual survey made by me or under my supervision, and that the same is true and correct to the best of my knowledge and belief.

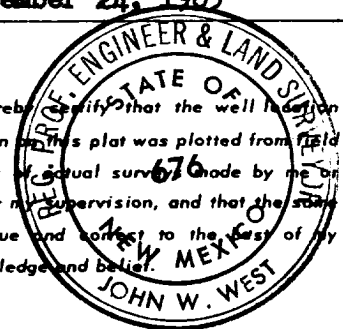

Date Surveyed  
**SEPT. 22, 1965**  
 Registered Professional Engineer  
 and/or Land Surveyor

*John W. West*  
 Certificate No.  
**676**

