

NO. OF COPIES RECEIVED	
DISTRIBUTION	
SANTA FE	
FILE	
U.S.G.S.	
LAND OFFICE	
OPERATOR	

NEW MEXICO OIL CONSERVATION COMMISSION

Form C-101
Revised 1-1-65

Jan 13 3 21 PM '66

5A. Indicate Type of Lease	
STATE <input checked="" type="checkbox"/>	FEE <input checked="" type="checkbox"/>
5. State Oil & Gas Lease No.	

APPLICATION FOR PERMIT TO DRILL, DEEPEN, OR PLUG BACK

1a. Type of Work		7. Unit Agreement Name	
b. Type of Well OIL WELL <input checked="" type="checkbox"/> GAS WELL <input type="checkbox"/> OTHER <input type="checkbox"/>		8. Farm or Lease Name Zack Taylor	
2. Name of Operator J. W. Hunt		9. Well No. 1	
3. Address of Operator 1203 Wilco Bldg., Midland, Texas		10. Field and Pool, or Wildcat Wildcat	
4. Location of Well UNIT LETTER G LOCATED 1980' FEET FROM THE North LINE AND 1980' FEET FROM THE East LINE OF SEC. 25 TWP. 11S RGE. 37E NMPM		12. County Lea	
19. Proposed Depth 5200'		19A. Formation San Andres	
20. Rotary or C.T. Rotary		21. Elevations (Show whether DF, RT, etc.) 3913 GL	
21A. Kind & Status Plug. Bond Blanket approved		21B. Drilling Contractor Sitton & Norton	
22. Approx. Date Work will start Jan. 25, 1966			

23.

PROPOSED CASING AND CEMENT PROGRAM

SIZE OF HOLE	SIZE OF CASING	WEIGHT PER FOOT	SETTING DEPTH	SACKS OF CEMENT	EST. TOP
11"	8-5/8"	28#	350'	250	Surface
7-7/8"	4-1/2"	9.5#	5200'	150	4400'

IN ABOVE SPACE DESCRIBE PROPOSED PROGRAM: IF PROPOSAL IS TO DEEPEN OR PLUG BACK, GIVE DATA ON PRESENT PRODUCTIVE ZONE AND PROPOSED NEW PRODUCTIVE ZONE. GIVE BLOWOUT PREVENTER PROGRAM, IF ANY.

I hereby certify that the information above is true and complete to the best of my knowledge and belief.

Signed J. W. Hunt Title Operator Date January 17, 1966

(This space for State Use)

APPROVED BY [Signature] TITLE DATE

CONDITIONS OF APPROVAL, IF ANY:

NEW MEXICO OIL CONSERVATION COMMISSION
WELL LOCATION AND ACREAGE DEDICATION

Form C-102
Supersedes C-128
Effective 1-1-65

All distances must be from the outer boundaries of the Section

Operator J. W. HUNT		Lease 3 20 PM 66		Well No. 1	
Unit Letter G	Section 25	Township 11 SOUTH	Range 37 EAST	County LEA	
Actual Footage Location of Well:					
1980 feet from the NORTH line and		1980 feet from the EAST line			
Ground Level Elev. 3913.4	Dedicated Acreage: Acres				

1. Outline the acreage dedicated to the subject well by colored pencil or hatchure marks on the plat below.
2. If more than one lease is dedicated to the well, outline each and identify the ownership thereof (both as to working interest and royalty).
3. If more than one lease of different ownership is dedicated to the well, have the interests of all owners been consolidated by communitization, unitization, force-pooling, etc?

☐ Yes ☐ No If answer is "yes," type of consolidation _____

If answer is "no," list the owners and tract descriptions which have actually been consolidated. (Use reverse side of this form if necessary.) _____

No allowable will be assigned to the well until all interests have been consolidated (by communitization, unitization, forced-pooling, or otherwise) or until a non-standard unit, eliminating such interests, has been approved by the Commission.

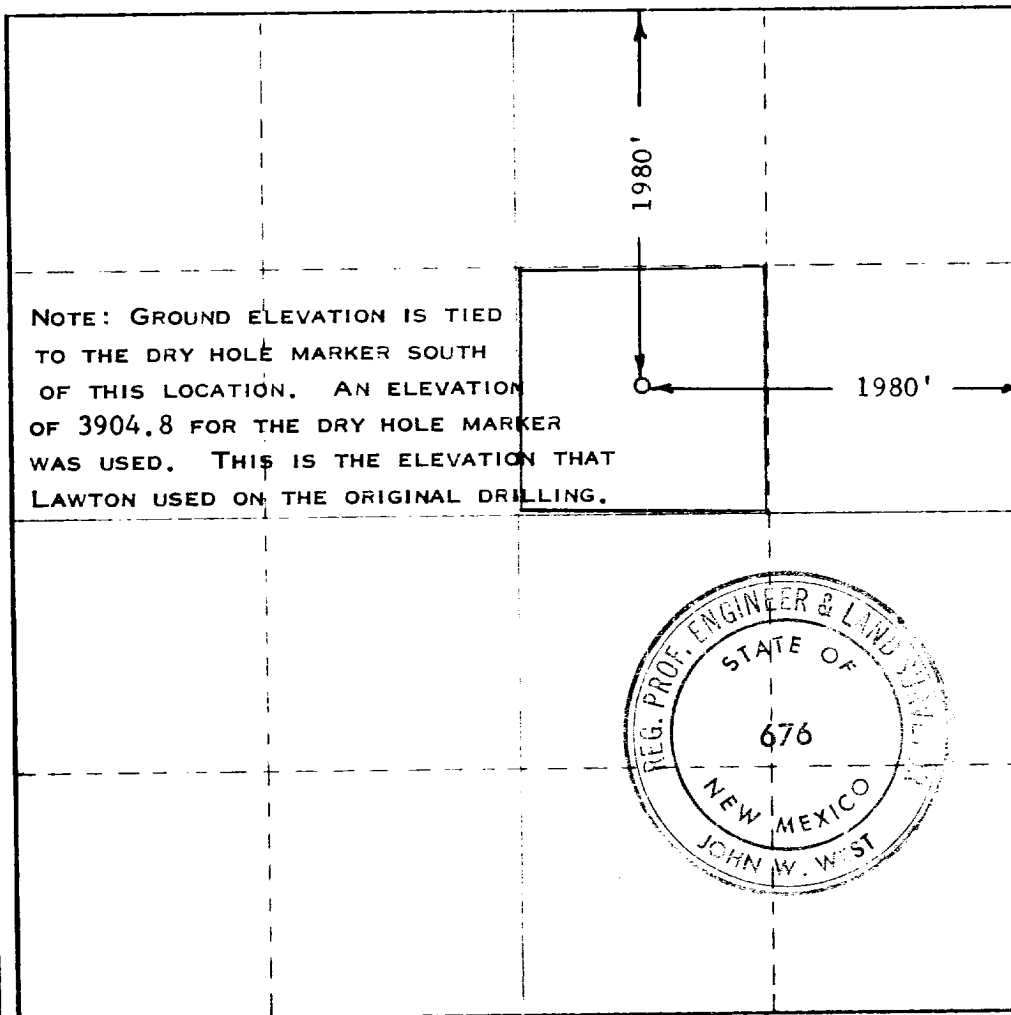

CERTIFICATION

I hereby certify that the information contained herein is true and complete to the best of my knowledge and belief.

Name _____

Position _____

Operator

Company _____

Date _____

January 17, 1966

I hereby certify that the well location shown on this plat was plotted from field notes of actual surveys made by me or under my supervision, and that the same is true and correct to the best of my knowledge and belief.

Date Surveyed _____

JANUARY 8, 1966

Registered Professional Engineer and/or Land Surveyor

John W. West

Certificate No. _____

676