

**NEW MEXICO OIL CONSERVATION COMMISSION
WELL LOCATION AND ACREAGE DEDICATION PLAT**

Form C-102
Supersedes C-128
Effective 1-1-65

All distances must be from the outer boundaries of the Section. **HOODS OFFICE O. C. C.**

| | | | | | |
|---|--|----------------------------|---|--|----------------------|
| Operator TENNECO OIL COMPANY | | | Lease LOVEJOY JUL 13 11 28 AM '66 | | Well No. 1 |
| Unit Letter 1 | Section 14 | Township 9 SOUTH | Range 35 EAST | County LEA | |
| Actual Footage Location of Well: 1980 feet from the SOUTH line and 330 feet from the EAST line | | | | | |
| Ground Level Elev. 4110 | Producing Formation SAN ANDRES | | Pool Undesignated | Dedicated Acreage: 160 Acres | |

1. Outline the acreage dedicated to the subject well by colored pencil or hachure marks on the plat below.
2. If more than one lease is dedicated to the well, outline each and identify the ownership thereof (both as to working interest and royalty).
3. If more than one lease of different ownership is dedicated to the well, have the interests of all owners been consolidated by communitization, unitization, force-pooling, etc?

☐ Yes ☐ No If answer is "yes," type of consolidation _____

If answer is "no," list the owners and tract descriptions which have actually been consolidated. (Use reverse side of this form if necessary.) _____

No allowable will be assigned to the well until all interests have been consolidated (by communitization, unitization, forced-pooling, or otherwise) or until a non-standard unit, eliminating such interests, has been approved by the Commission.

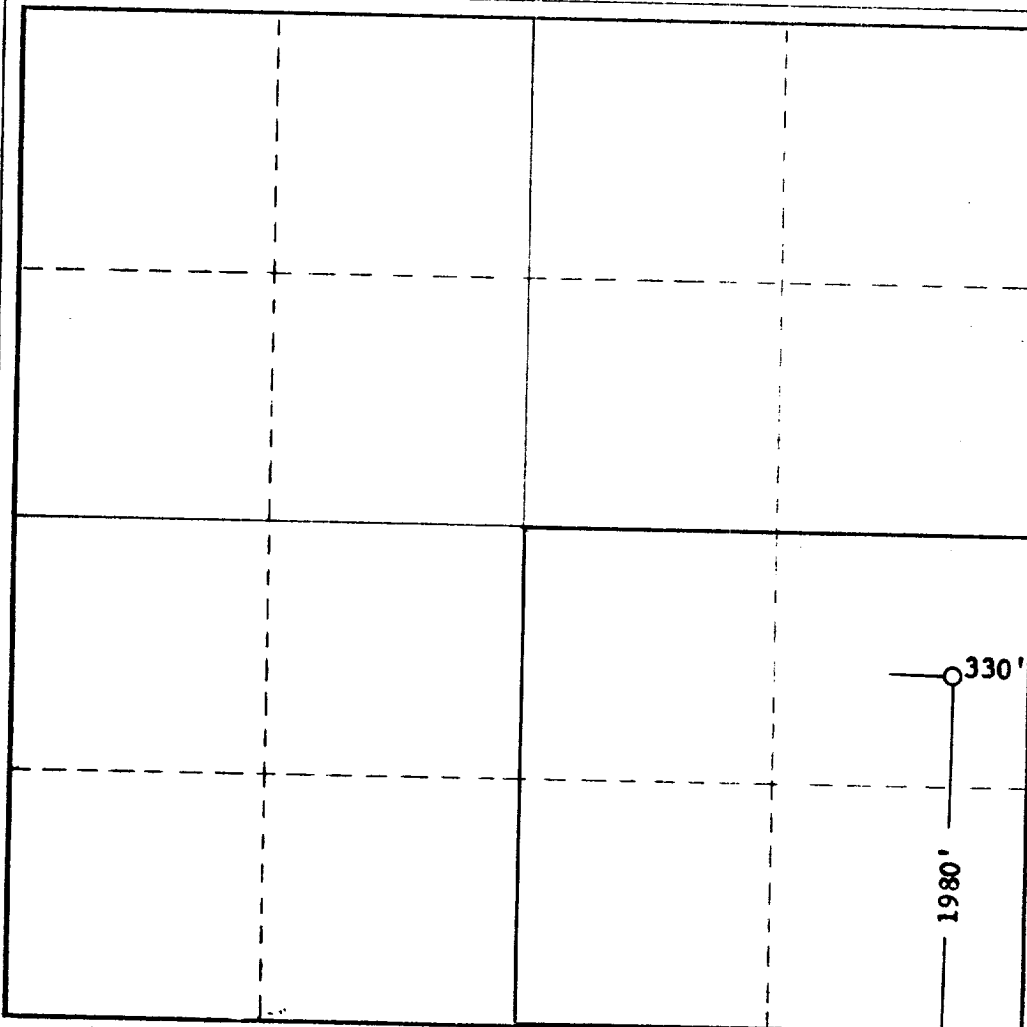

CERTIFICATION

I hereby certify that the information contained herein is true and complete to the best of my knowledge and belief.

Name J. F. Carnes **J. F. Carnes**
Position District Production Engineer

Company Tenneco Oil Company

Date July 12, 1966

I hereby certify that the well location shown on this plat was plotted from field notes of actual survey made by me or under my supervision, and that the same is true and correct to the best of my knowledge and belief.

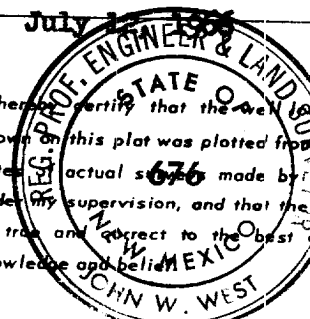

Date Surveyed
OCT. 19, 1965

Registered Professional Engineer
and/or Land Surveyor

John W. West
Certificate No. **676**