

NEW MEXICO OIL CONSERVATION COMMISSION
WELL LOCATION AND ACREAGE DEDICATION PLAT

Form 1-7
Supersedes C-128
Effective 1-1-65

All distances must be from the outer boundaries

Mar 30 12 56 PM '66

Operator Ralph S. Cooley		Well No. 72	
Unit Letter C	Section 10	Township 9 South	Range 20 East
Actual Well Location of Well: 1930		Line and 1850	
Round Level Flow 2050	Producing Formation San Andres	Pool Sawyer San Andres Oil	Dedicated Acreage: 40
		Acres	

1. Outline the acreage dedicated to the subject well by colored pencil or hatchure marks on the plat below.
2. If more than one lease is dedicated to the well, outline each and identify the ownership thereof (both as to working interest and royalty).
3. If more than one lease of different ownership is dedicated to the well, have the interests of all owners been consolidated by communitization, unitization, force-pooling, etc?

☐ Yes ☐ No If answer is "yes," type of consolidation _____

If answer is "no," list the owners and tract descriptions which have actually been consolidated. (Use reverse side of this form if necessary) _____

No allowable will be assigned to the well until all interests have been consolidated (by communitization, unitization, forced-pooling, or otherwise) or until a non-standard unit, eliminating such interests, has been approved by the Commission.

See Form C-102 filed December 10, 1965
for this well as a gas well.

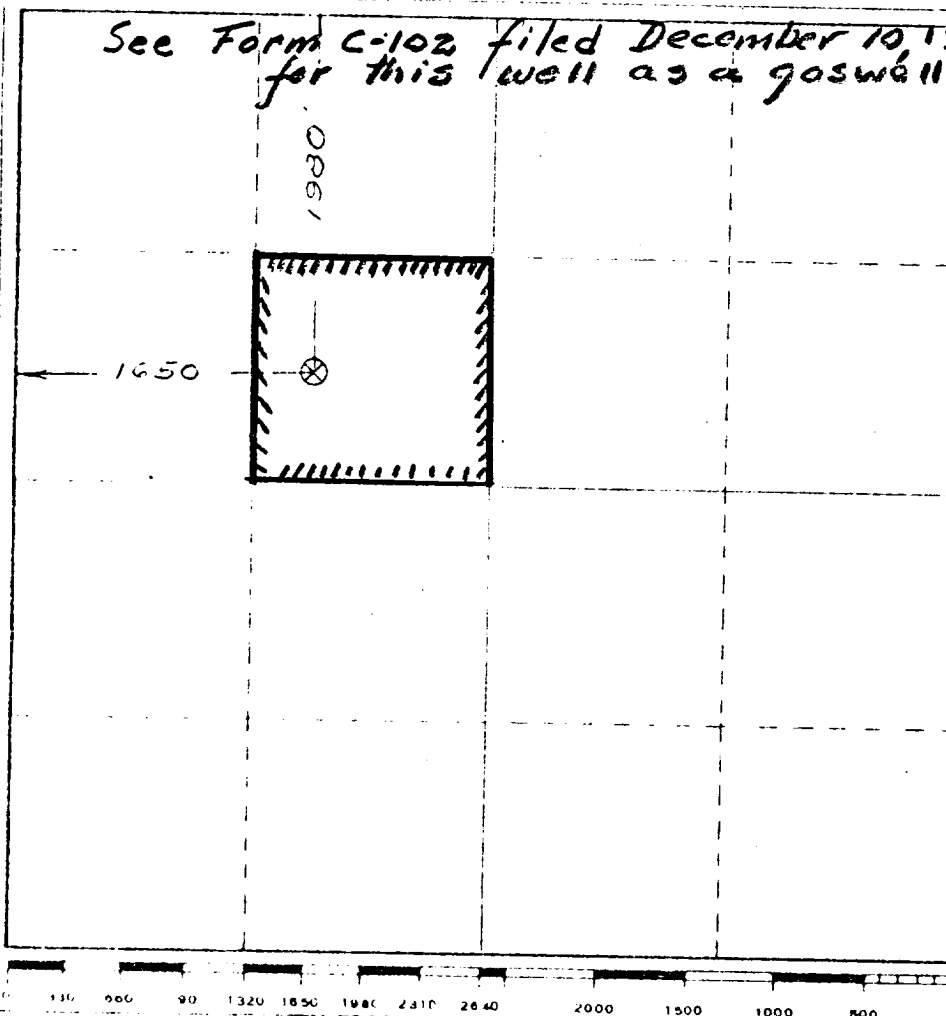

CERTIFICATION

I hereby certify that the information contained herein is true and complete to the best of my knowledge and belief.

Name

Ralph S. Cooley

Position

Operator

Company

Ralph S. Cooley

Date

December 10, 1965

I hereby certify that the well location shown on this plat was plotted from field notes of actual surveys made by me or under my supervision, and that the same is true and correct to the best of my knowledge and belief.

Date Surveyed

Dec. 6 and 7, 1965

Registered Professional Engineer
and/or Land Surveyor

John W. Shamm

Certificate No.

XERO COPY

XERO COPY

XERO COPY

XERO COPY