

UNITED STATES
DEPARTMENT OF THE INTERIOR
GEOLOGICAL SURVEY

APPLICATION FOR PERMIT TO DRILL, DEEPEN, OR PLUG BACK

1a. TYPE OF WORK
 DRILL DEEPEN PLUG BACK

b. TYPE OF WELL
 OIL WELL GAS WELL OTHER _____
 SINGLE ZONE MULTIPLE ZONE

2. NAME OF OPERATOR
 John L. Cox

3. ADDRESS OF OPERATOR
 408 West Wall, Midland, Texas 79701

4. LOCATION OF WELL (Report location clearly and in accordance with any State requirements.*)
 At surface 660' FSL, 810' FEL
 At proposed prod. zone

14. DISTANCE IN MILES AND DIRECTION FROM NEAREST TOWN OR POST OFFICE*
 9 miles East, Crossroads, New Mexico

15. DISTANCE FROM PROPOSED* LOCATION TO NEAREST PROPERTY OR LEASE LINE, FT. (Also to nearest drlg. unit line, if any) 660'

16. NO. OF ACRES IN LEASE 80

17. NO. OF ACRES ASSIGNED TO THIS WELL 80

18. DISTANCE FROM PROPOSED LOCATION* TO NEAREST WELL, DRILLING, COMPLETED, OR APPLIED FOR, ON THIS LEASE, FT. 1st Well

19. PROPOSED DEPTH 5100'

20. ROTARY OR CABLE TOOLS Rotary

21. ELEVATIONS (Show whether DF, RT, GR, etc.) 3966 GR

22. APPROX. DATE WORK WILL START* July 9, 1973

23. PROPOSED CASING AND CEMENTING PROGRAM

| SIZE OF HOLE | SIZE OF CASING | WEIGHT PER FOOT | SETTING DEPTH | QUANTITY OF CEMENT |
|--------------|----------------|-----------------|---------------|--------------------|
| 12 1/4" | 8 5/8" | 20# | 400 | 375 sx. Circulated |
| 7 7/8" | 4 1/2" | 9.5# | 5100 | 350 sx. |

8 5/8" casing to be cemented with 375 sx. Class H cement with 2% Calcium Chloride. This is ample cement to circulate to surface.

4 1/2" casing to be cemented with 350 sx. Class C cement, 50-50 pozmix with 2% gel, 8# salt/sack and 0.75% CFR2 preceded by 500 gallon mud slush.

Mud Program: Water, gel, lime 0 - 400'
 Native Redbed mud 400' - 4700'
 Low-solids salt gel-starch mud 4700' - TD

IN ABOVE SPACE DESCRIBE PROPOSED PROGRAM: If proposal is to deepen or plug back, give data on present productive zone and proposed new productive zone. If proposal is to drill or deepen directionally, give pertinent data on subsurface locations and measured and true vertical depths. Give blowout preventer program, if any.

24. SIGNED Monte Kittenband TITLE Production Clerk DATE July 3, 1973

(This space for Federal or State office use)

PERMIT NO. _____ APPROVAL DATE _____

APPROVED BY _____ TITLE _____ DATE _____

CONDITIONS OF APPROVAL, IF ANY:

APPROVED
 JUL 9 1973
 ARTHUR R. BROWN
 DISTRICT ENGINEER

NEW MEXICO OIL CONSERVATION COMMISSION
WELL LOCATION AND ACREAGE DEDICATION PLAT

Form O-172
Supersedes O-128
Effective 1-1-65

All distances must be from the outer boundaries of the Section

| | | | | | |
|--|--|----------------------------|---|--------------------------------|----------------------|
| Operator JOHN L. COX | | Lease FEDERAL | | | Well No. 1 |
| Unit Letter P | Section 22 | Township 9 SOUTH | Range 37 EAST | County LEA | |
| Actual Footage Location of Well: 810 feet from the EAST line and 660 feet from the SOUTH line | | | | | |
| Ground Level Elev. 3966' | Producing Formation San Andres | | Pool West Sawyer (San Andres) | Dedicated Acreage 80 | |

1. Outline the acreage dedicated to the subject well by colored pencil or hachure marks on the plat below.
2. If more than one lease is dedicated to the well, outline each and identify the ownership thereof (but as to working interest and royalty).
3. If more than one lease of different ownership is dedicated to the well, have the interests of all owners been consolidated by communitization, unitization, force-pooling, etc?

Yes No If answer is "yes," type of consolidation _____

If answer is "no," list the owners and tract descriptions which have actually been consolidated. (Use reverse side of this form if necessary.) _____

No allowable will be assigned to the well until all interests have been consolidated (by communitization, unitization, forced-pooling, or otherwise) or until a non-standard unit, eliminating such interests, has been approved by the Commission.

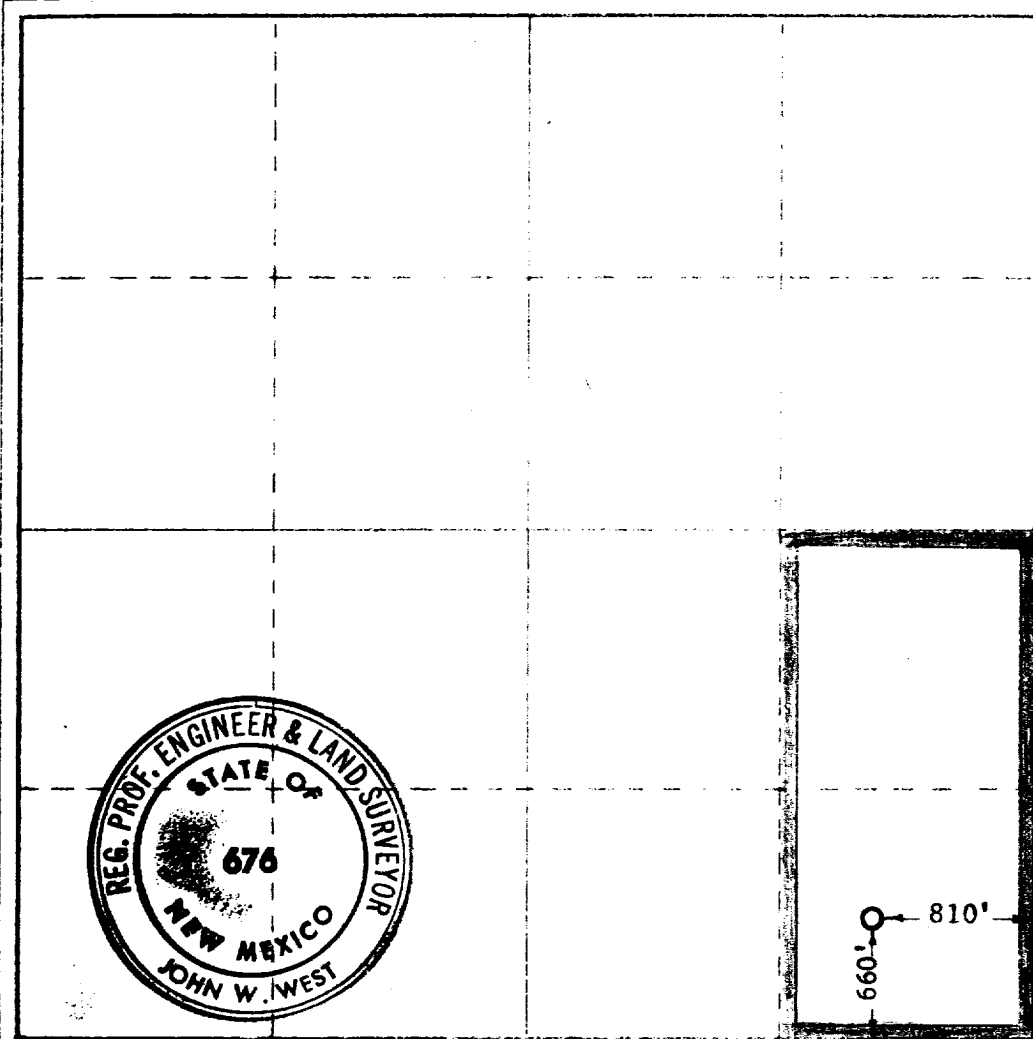

CERTIFICATION

I hereby certify that the information contained herein is true and complete to the best of my knowledge and belief.

Martha Wittenbach
Name

Martha Wittenbach

Position
Production Clerk

Operator
JOHN L. COX

Date
July 3, 1973

I hereby certify that the well location shown on this plat was plotted from field notes of actual surveys made by me or under my supervision, and that the same is true and correct to the best of my knowledge and belief.

Date Surveyed
JUNE 29, 1973

Registered Professional Engineer and/or Land Surveyor

John W. West
Certificate No.

676

