

MAY 10 1961

(SUBMIT IN TRIPLICATE)

Land Office **New Mexico**

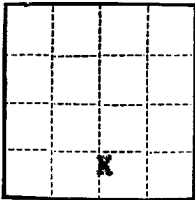

E. W. STANDLEY
DISTRICT ENGINEER

UNITED STATES
DEPARTMENT OF THE INTERIOR
GEOLOGICAL SURVEY

Lease No. **LC 068345-A**
HOBBS OFFICE OCC
Unit

1961 MAY 16 AM 10 33

MAY 10 1961

SUNDRY NOTICES AND REPORTS ON WELLS

HOBBS, NEW MEXICO

NOTICE OF INTENTION TO DRILL.....	<input checked="" type="checkbox"/>	SUBSEQUENT REPORT OF WATER SHUT-OFF.....	
NOTICE OF INTENTION TO CHANGE PLANS.....		SUBSEQUENT REPORT OF SHOOTING OR ACIDIZING.....	
NOTICE OF INTENTION TO TEST WATER SHUT-OFF.....		SUBSEQUENT REPORT OF ALTERING CASING.....	
NOTICE OF INTENTION TO RE-DRILL OR REPAIR WELL.....		SUBSEQUENT REPORT OF RE-DRILLING OR REPAIR.....	
NOTICE OF INTENTION TO SHOOT OR ACIDIZE.....		SUBSEQUENT REPORT OF ABANDONMENT.....	
NOTICE OF INTENTION TO PULL OR ALTER CASING.....		SUPPLEMENTARY WELL HISTORY.....	
NOTICE OF INTENTION TO ABANDON WELL.....			

(INDICATE ABOVE BY CHECK MARK NATURE OF REPORT, NOTICE, OR OTHER DATA)

May 10, 1961

Carper-Bluitt "A"

Well No. **1** is located **660** ft. from **S** line and **1980** ft. from **E** line of sec. **34**

NW/4 **SE/4** **34** **8S** **37E** **MIP**
(1/4 Sec. and Sec. No.) (Twp.) (Range) (Meridian)

Wildcat **Roosevelt** **New Mexico**
(Field) (County or Subdivision) (State or Territory)

The elevation of the derrick floor above sea level is **4015** ft.

DETAILS OF WORK

(State names of and expected depths to objective sands; show sizes, weights, and lengths of proposed casings; indicate mudding jobs, cementing points, and all other important proposed work)

We propose to drill this well with rotary tools to an approximate depth of 9700' unless commercial production is obtained at a lesser depth.

We will run approximately the following casing strings:

- Surface: 200' of 10 3/4" O.D. casing, cement to circulate to surface.
- Intermediate: 3100' of 7 5/8" O.D. casing, cement to circulate to surface.
- Production: 9700' of 4 1/2" O.D. casing if production is found, with 100 sacks cement.

I understand that this plan of work must receive approval in writing by the Geological Survey before operations may be commenced.

Company **Carper Drilling Company, Inc.**

Address **200 Carper Building**
Artesia, New Mexico

By *J. Nausha Sawly*

Title **Vice President**

NEW MEXICO OIL CONSERVATION COMMISSION
WELL LOCATION AND ACREAGE DEDICATION PLAT

FORM C-128
 Revised 5/1/57

HOBBS OFFICE 000

SEE INSTRUCTIONS FOR COMPLETING THIS FORM ON THE REVERSE SIDE

SECTION A

Operator CARPER DRILLING COMPANY		Lease 1961 MAY 16 AM 10:33	
Unit Letter O	Section 34	Township B SOUTH	Range 37 EAST
Actual Footage Location of Well: 660 feet from the SOUTH line and 1980 feet from the EAST line		County ROOSEVELT	
Ground Level Elev. 4015	Producing Formation Bough #C	Pool Wildcat	Dedicated Acreage: 40 Acres

1. Is the Operator the only owner in the dedicated acreage outlined on the plat below? YES NO ("Owner" means the person who has the right to drill into and to produce from any pool and to appropriate the production either for himself or for himself and another. 165-3-29 (e) NMSA 1955 Comp.)
2. If the answer to question one is "no," have the interests of all the owners been consolidated by communitization agreement or otherwise? YES NO . If answer is "yes," Type of Consolidation _____
3. If the answer to question two is "no," list all the owners and their respective interests below:

Owner	Land Description

MAY 10 1961
 U. S. COMMISSION
 HOBBS
 CERTIFICATION

SECTION B

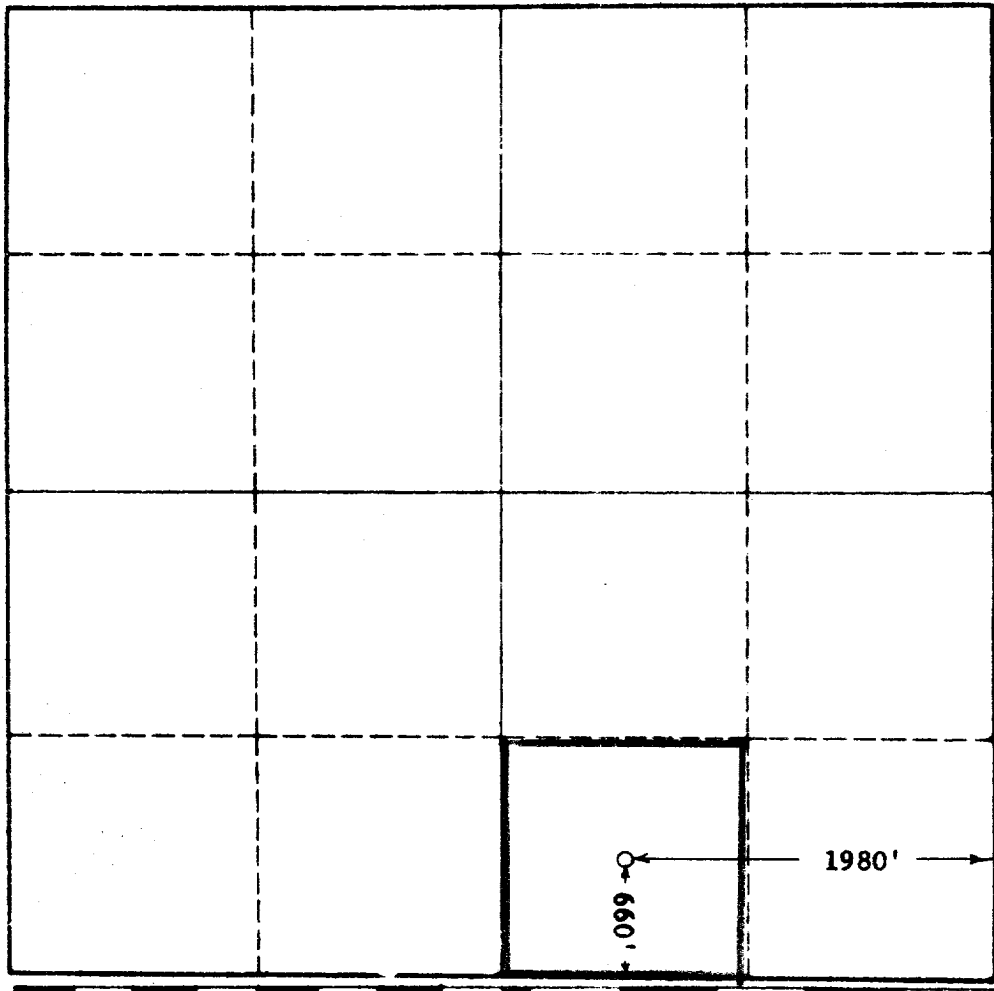

I hereby certify that the information in SECTION A above is true and complete to the best of my knowledge and belief.

Name: **Thames Raulz**
 Position: **Vice President**
 Company: **Carper Drilling Co., Inc.**
 Date: **May 10, 1961**

I hereby certify that the well location shown on the plat in SECTION B was plotted from ~~field notes~~ actual surveys made by me or under my supervision, and that the same is true and correct to the best of my knowledge and belief.

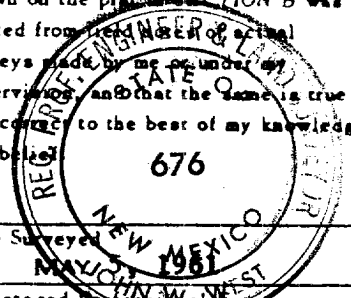

Date Surveyed: **MAY 10 1961**
 Registered Professional Engineer and/or Land Surveyor, **JOHN W. WEST**

John W. West
 Certificate No. **N.M. - P.E. & L.S. NO. 676**