

UNITED STATES  
DEPARTMENT OF THE INTERIOR  
GEOLOGICAL SURVEY O. C. C.

HOBBS SURVEY

5. LEASE DESIGNATION AND SERIAL NO.  
**LC-060978**

6. IF INDIAN, ALLOTTEE OR TRIBE NAME

7. UNIT AGREEMENT NAME

8. FARM OR LEASE NAME  
**Jacobs Federal**

9. WELL NO.  
**18**

10. FIELD AND POOL, OR WILDCAT  
**Milnesand-San Andres**

11. SEC., T., R. M., OR BLK.  
AND SURVEY OR AREA  
**Sec. 19, T8S, R35E**

12. COUNTY OR PARISH  
**Roosevelt**

13. STATE  
**N. M.**

APPLICATION FOR PERMIT TO DRILL, DEEPEN, OR PLUG BACK

1a. TYPE OF WORK  
 DRILL  **MAY 17 8 20 AM '64** DEEPEN  PLUG BACK

b. TYPE OF WELL  
 OIL WELL  GAS WELL  OTHER  SINGLE ZONE  MULTIPLE ZONE

2. NAME OF OPERATOR  
**El Chorro Exploration, Inc.**

3. ADDRESS OF OPERATOR  
**c/o Oil Reports & Gas Services, Box 763, Hobbs, New Mexico**

4. LOCATION OF WELL (Report location clearly and in accordance with any State requirements.\*)  
 At surface **660' FNL & 990' FNL of Section 19**  
 At proposed prod. zone

14. DISTANCE IN MILES AND DIRECTION FROM NEAREST TOWN OR POST OFFICE\*  
**5 miles S. Milnesand**

15. DISTANCE FROM PROPOSED\* LOCATION TO NEAREST PROPERTY OR LEASE LINE, FT. (Also to nearest drlg. unit line, if any)  
**660'**

16. NO. OF ACRES IN LEASE  
**960**

17. NO. OF ACRES ASSIGNED TO THIS WELL  
**40**

18. DISTANCE FROM PROPOSED LOCATION\* TO NEAREST WELL, DRILLING, COMPLETED, OR APPLIED FOR, ON THIS LEASE, FT.  
**990'**

19. PROPOSED DEPTH  
**4300**

20. ROTARY OR CABLE TOOLS  
**Rotary**

21. ELEVATIONS (Show whether DF, RT, GR, etc.)  
**4225.5 GL**

22. APPROX. DATE WORK WILL START\*  
**6/15/64**

PROPOSED CASING AND CEMENTING PROGRAM

SIZE OF HOLE	SIZE OF CASING	WEIGHT PER FOOT	SETTING DEPTH	QUANTITY OF CEMENT
12 1/4	6 5/8	24#	350	Circulated
7 7/8	4 1/2	10.5#	4800	200

IN ABOVE SPACE DESCRIBE PROPOSED PROGRAM: If proposal is to deepen or plug back, give data on present productive zone and proposed new productive zone. If proposal is to drill or deepen directionally, give pertinent data on subsurface locations and measured and true vertical depths. Give blowout preventer program, if any.

24. SIGNED A. L. Smith TITLE Agent DATE May 8, 1964

(This space for Federal or State office use)

PERMIT NO. \_\_\_\_\_ APPROVAL DATE \_\_\_\_\_

APPROVED BY \_\_\_\_\_ TITLE \_\_\_\_\_  
CONDITIONS OF APPROVAL, IF ANY:

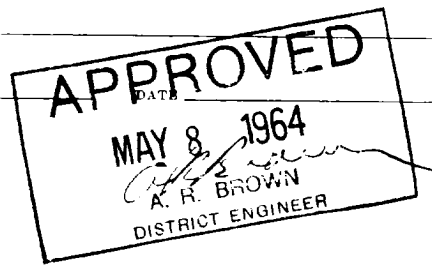

\*See Instructions On Reverse Side

## Instructions

7. General: This form is designed for submitting proposals to perform certain well operations, as indicated, on all types of lands and leases for appropriate action by either Federal or a State agency, or both, pursuant to applicable Federal and/or State laws and regulations. Any necessary special instructions concerning the use of this form and the number of copies to be submitted, particularly with regard to local, area, or regional procedures and practices, either are shown below or will be issued by, or may be obtained from, the local Federal and/or State office.

Item 1: If the proposal is to redrill to the same reservoir at a different subsurface location or to a new reservoir, use this form with appropriate notations. Consult applicable State or Federal regulations concerning subsequent work proposals or reports on the well.

Item 4: If there are no applicable State requirements, locations on Federal or Indian land should be described in accordance with Federal requirements. Consult local State or Federal office for specific instructions.

Item 14: Needed only when location of well cannot readily be found by road from the land or lease description. A plat, or plats, separate or on this reverse side, showing the location of the surveyed location of, the well, and any other required information, should be furnished when required by Federal or State agency offices.

Items 15 and 16: If well is to be, or has been directionally drilled, give distances for subsurface location of hole in any present or objective production zone.

Item 2: Consult applicable Federal or State regulations, or appropriate officials, concerning approval of the proposal before operations are started.

**NEW MEXICO OIL CONSERVATION COMMISSION**  
**WELL LOCATION AND ACREAGE DEDICATION PLAT**

FORM C-128  
 Revised 5/1/57

OFFICE O. C. C.  
 MAY 12 8 30 AM '64

SEE INSTRUCTIONS FOR COMPLETING THIS FORM ON THE REVERSE SIDE

**SECTION A**

Operator <b>EL CHORRO EXPLORATION, INC.</b>		Lease <b>JABOCS FEDERAL</b>		Well No. <b>18</b>
Unit Letter <b>A</b>	Section <b>19</b>	Township <b>8 SOUTH</b>	Range <b>35 EAST</b>	County <b>ROOSEVELT</b>
Actual Footage Location of Well: <b>660</b> feet from the <b>NORTH</b> line and <b>990</b> feet from the <b>EAST</b> line				
Ground Level Elev. <b>4225.5</b>	Producing Formation <b>San Andres</b>	Pool <b>Milnesand-San Andres</b>	Dedicated Acreage: <b>40</b> Acres	

1. Is the Operator the only owner in the dedicated acreage outlined on the plat below? YES  NO  ("Owner" means the person who has the right to drill into and to produce from any pool and to appropriate the production either for himself or for himself and another. (65-3-29 (e) NMSA 1935 Comp.)
2. If the answer to question one is "no," have the interests of all the owners been consolidated by communitization agreement or otherwise? YES  NO  . If answer is "yes," Type of Consolidation \_\_\_\_\_
3. If the answer to question two is "no," list all the owners and their respective interests below:

Owner	Land Description

**SECTION B**

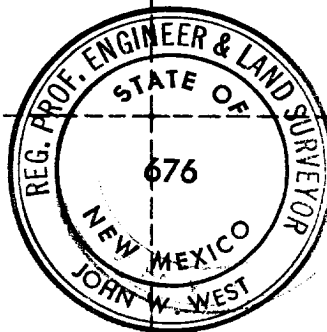
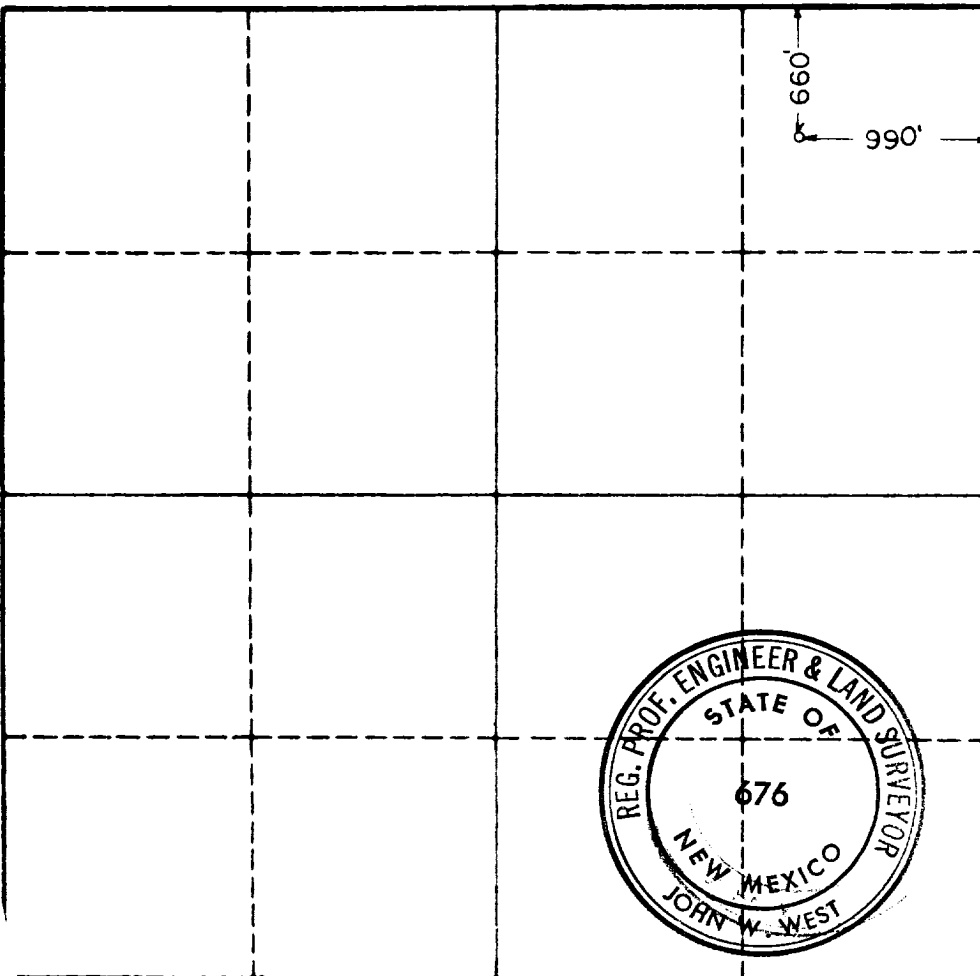

**CERTIFICATION**

I hereby certify that the information in SECTION A above is true and complete to the best of my knowledge and belief.

Name *H. L. Smith*  
 Position **Agent**  
 Company **El Chorro Exploration, Inc.**  
 Date **May 6, 1964**

I hereby certify that the well location shown on the plat in SECTION B was plotted from field notes of actual surveys made by me or under my supervision, and that the same is true and correct to the best of my knowledge and belief.

Date Surveyed **MAY 6, 1964**  
 Registered Professional Engineer and/or Land Surveyor, **JOHN W. WEST**  
*John W. West*  
 Certificate No. **N. M. - P. E. & L. S. NO. 676**

330 660 990 1320 1650 1980 2310 2640 2000 1500 1000 500