

Form 9-331a  
(Feb. 1951)

(SUBMIT IN TRIPLICATE)

Local Office \_\_\_\_\_

Lease No. **LC-064900**

**APPROVED**  
OCT 19 1959  
*James A. Knauf*  
JAMES A. KNAUF  
SUPERVISOR

**UNITED STATES GEOLOGICAL SURVEY  
DEPARTMENT OF THE INTERIOR**

OCT 21 AM 9:18

**SUNDRY NOTICES AND REPORTS ON WELLS**

NOTICE OF INTENTION TO DRILL	<input checked="" type="checkbox"/>	SUBSEQUENT REPORT OF WATER SHUT-OFF	
NOTICE OF INTENTION TO CHANGE PLANS		SUBSEQUENT REPORT OF SHOOTING OR ACIDIZING	
NOTICE OF INTENTION TO TEST WATER SHUT-OFF		SUBSEQUENT REPORT OF ALTERING CASING	
NOTICE OF INTENTION TO RE-DRILL OR REPAIR WELL		SUBSEQUENT REPORT OF RE-DRILLING OR REPAIR	
NOTICE OF INTENTION TO SHOOT OR ACIDIZE		SUBSEQUENT REPORT OF ABANDONMENT	
NOTICE OF INTENTION TO PULL OR ALTER CASING		SUPPLEMENTARY WELL HISTORY	
NOTICE OF INTENTION TO ABANDON WELL			

(INDICATE ABOVE BY CHECK MARK NATURE OF REPORT, NOTICE, OR OTHER DATA)

October 14, 19 59

Well No. **Federal-Medlin 12-17** is located **990** ft. from **N** line and **1980** ft. from **E** line of sec. **17**

**SE/4 Section 17** (1/4 Sec. and Sec. No.) **T-15-S** (Twp.) **R-31-E** (Range) **N.M.P.M.** (Meridian)  
**Caprock (Queen)** (Field) **Chaves** (County or Subdivision) **New Mexico** (State or Territory)

The elevation of the derrick floor above sea level is **unknown at present.**

**DETAILS OF WORK**

(State names of and expected depths to objective sands; show sizes, weights, and lengths of proposed casings; indicate mudding jobs, cementing points, and all other important proposed work)

Drill 11" hole to approximately 300' and cement 8-5/8" casing with 175 ex. cement.  
Drill 6-3/4" hole to 3100'.  
Core Queen sand to check for possible production. If production is indicated, cement 4 1/2" casing at approximately 3100' with 200 ex. 4 1/2 gel cement and 200 ex. Strata-crete.

I understand that this plan of work must receive approval in writing by the Geological Survey before operations may be commenced.

Company **Union Oil Company of California**

Address **619 West Texas Avenue**

**Midland, Texas**

By *R. W. Yarbrough*  
**R. W. Yarbrough**  
Title **Drilling Supt.**

**NEW MEXICO OIL CONSERVATION COMMISSION**  
**WELL LOCATION AND ACREAGE DEDICATION PLAT**

FORM C-128  
 Revised 5/1/57

**SEE INSTRUCTIONS FOR COMPLETING THIS FORM ON THE REVERSE SIDE**

**SECTION A**

Operator <b>Union Oil Co. of California</b>		Lease <b>Federal Medlin</b>		Well No. <b>12-17</b>
Unit Letter <b>O</b>	Section <b>17</b>	Township <b>15 South</b>	Range <b>31 East</b>	County <b>Chaves</b>
Actual Footage Location of Well: <b>990</b> feet from the <b>South</b> line and <b>1980</b> feet from the <b>East</b> line				
Ground Level Elev. <del>Unknown</del>	Producing Formation <del>Queen</del>	Pool <b>Caprock Queen</b>		Dedicated Acreage: <b>40</b> Acres

1. Is the Operator the only owner in the dedicated acreage outlined on the plat below? YES  NO  . ("Owner" means the person who has the right to drill into and to produce from any pool and to appropriate the production either for himself or for himself and another. (65-3-29 (e) NMSA 1935 Comp.)
2. If the answer to question one is "no," have the interests of all the owners been consolidated by communitization agreement or otherwise? YES  NO  . If answer is "yes," Type of Consolidation \_\_\_\_\_
3. If the answer to question two is "no," list all the owners and their respective interests below:

Owner	Land Description

**SECTION B**

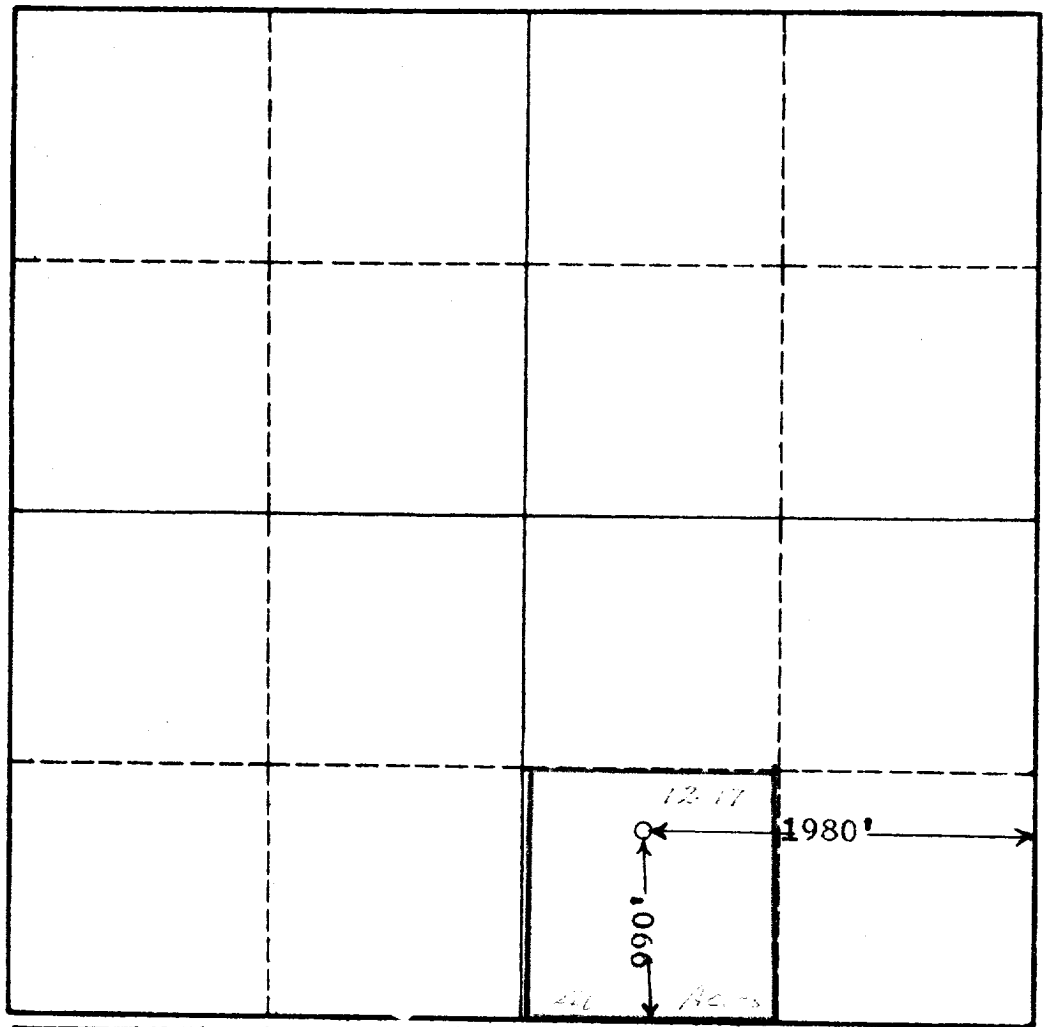

**CERTIFICATION**

I hereby certify that the information in SECTION A above is true and complete to the best of my knowledge and belief.

Name *R. W. Yarbrough*  
**R. W. Yarbrough**

Position  
**Drilling Supt.**

Company  
**Union Oil Co. of California**

Date  
**October 16, 1959**

I hereby certify that the well location shown on the plat in SECTION B was plotted from field notes of actual surveys made by me or under my supervision, and that the same is true and correct to the best of my knowledge and belief.

Date Surveyed  
**10-12-59**

Registered Professional Engineer and/or Land Surveyor, **JOHN W. WEST**

*John W. West*

Certificate No.  
**N.M. - P.E. & L.S. NO. 676**

0 330 660 990 1320 1650 1980 2310 2640 2000 1500 1000 500