

**NEW MEXICO OIL CONSERVATION COMMISSION**  
**Santa Fe, New Mexico**

Form C-101  
 Revised (12/1/55)

10375  
**AMENDED**  
 OFFICE OCC

**NOTICE OF INTENTION TO DRILL**

Notice must be given to the District Office of the Oil Conservation Commission and approval obtained before drilling or recompletion begins. If changes in the proposed plan are considered advisable, a copy of this notice showing such changes will be returned to the sender. Submit this notice in **QUINTUPLICATE**. One copy will be returned following approval. See additional instructions in Rules and Regulations of the Commission. **If State Land submit 6 Copies Attach Form C- 128 in triplicate to first 3 copies of Form C-101**

Midland, Texas

(Place)

December 10, 1957

(Date)

OIL CONSERVATION COMMISSION  
 SANTA FE, NEW MEXICO

Gentlemen:

You are hereby notified that it is our intention to commence the Drilling of a well to be known as  
**Union Oil Company of California**

(Company or Operator)

W. H. Anderson

(Lease)

Well No. 1-7, in H The well is

(Unit)

located 660 feet from the East line and 1650 feet from the North line of Section 7, T. 13-S, R. 36-E, NMPM.

(GIVE LOCATION FROM SECTION LINE)

Undesignated Pool, Lea County

If State Land the Oil and Gas Lease is No. \_\_\_\_\_

If patented land the owner is W. H. Anderson

Address Tatum, New Mexico

We propose to drill well with drilling equipment as follows: Rotary

The status of plugging bond is J. W. Ward & Sons

Artesia, New Mexico

Drilling Contractor Delta Drilling Company

Citizens National Bank Bldg.

Tyler, Texas

We intend to complete this well in the Wolfcamp

formation at an approximate depth of 10,500 feet.

**CASING PROGRAM**

We propose to use the following strings of Casing and to cement them as indicated:

Size of Hole	Size of Casing	Weight per Foot	New or Second Hand	Depth	Sacks Cement
15"	11-3/4"	42#	New	325	350
11"	8-5/8"	32 and 24#	New	4,500	500
7-7/8"	5-1/2"	17 and 15.5#	New	10,500'	400

If changes in the above plans become advisable we will notify you immediately.

ADDITIONAL INFORMATION (If recompletion give full details of proposed plan of work.)

**This amended form is being filed to designated a change in location of the well and supercedes previous form C-101 dated November 27, 1957.**

Approved \_\_\_\_\_, 19\_\_\_\_  
 Except as follows:

Sincerely yours,

Union Oil Company of California  
 (Company or Operator)

By [Signature]

Position Acting Drilling Supt.

Send Communications regarding well to

Name Union Oil Company of California

Address 619 W. Texas Ave., Midland, Texas

OIL CONSERVATION COMMISSION

By [Signature]

NEW MEXICO OIL CONSERVATION COMMISSION

Well Location and Acreage Dedication Plat

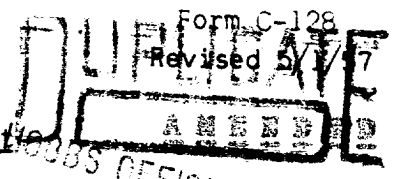

Date December 5, 1957  
 DEC 12 PM '57

Section A.

Operator Union Oil Co. of California Lease Anderson  
 Well No. 1-7 Unit letter H Section 7 Township 13S Range 36E2 NMFM  
 Located 660 Feet From East Line, 1650 Feet From the North Line  
 County Lea G. L. Elevation 4004.3 Dedicated Acreage 40 Acres  
 Name of Producing Formation Wolfcamp Pool Undesignated

1. Is the Operator the only owner\* in the dedicated acreage outlined on the plat below?  
 Yes \_\_\_\_\_ No X
2. If the answer to question one is "no," have the interests of all the owners been consolidated by communitization agreement or otherwise? Yes X No \_\_\_\_\_. If answer is "yes," Type of Consolidation Unit operating agreement
3. If the answer to question two is "no," list all the owners and their respective interests below:

Owner Land Description

<u>Owner</u>	<u>Land Description</u>

Section B

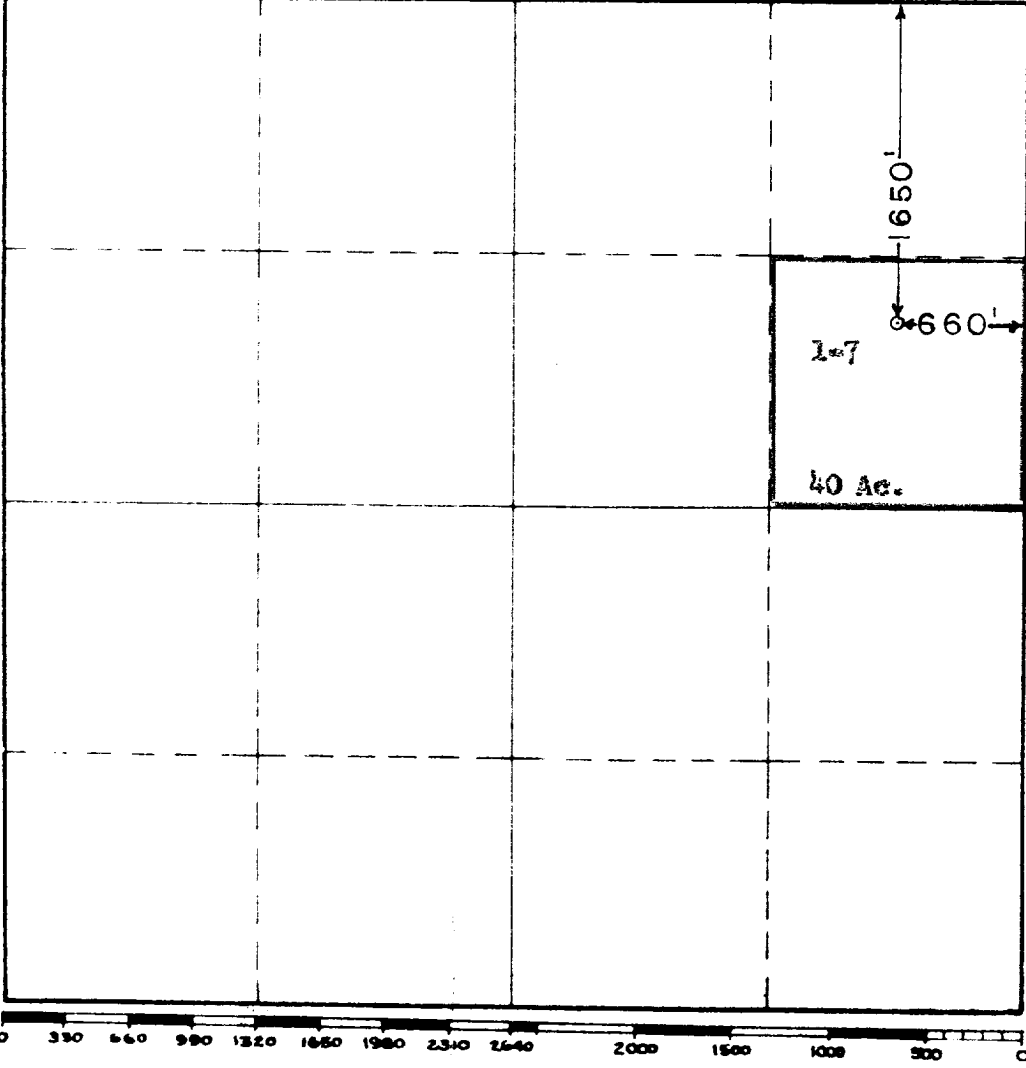

This is to certify that the information in Section A above is true and complete to the best of my knowledge and belief.

Union Oil Co. of California  
 (Operator)  
[Signature]  
 (Representative)  
619 West Texas Avenue  
Midland, Texas  
 Address

This is to certify that the well location shown on the plat in Section B was plotted from field notes of actual surveys made by me or under my supervision and that the same is true and correct to the best of my knowledge and belief.

Date Surveyed 12-5-57  
[Signature]  
 Registered Professional  
 Engineer and/or Land Surveyor.

Certificate No. 676

(See instructions for completing this form on page 2)

NOTICE OF INTENTION TO DRILL

Notice must be given to the District Office of the Oil Conservation Commission and approval obtained before drilling or recompletion begins. If changes in the proposed plan are considered advisable, a copy of this notice showing such changes will be returned to the sender. Submit this notice in QUINTUPLICATE. One copy will be returned following approval. See additional instructions in Rules and Regulations of the Commission. If State Land submit 6 Copies Attach Form G-128 in triplicate to first 3 copies of form G-101

Midland, Texas

(Place)

November 27, 1957

(Date)

OIL CONSERVATION COMMISSION  
SANTA FE, NEW MEXICO

Gentlemen:

You are hereby notified that it is our intention to commence the Drilling of a well to be known as  
**Union Oil Company of California**

(Company or Operator)

W. H. Anderson

(Lease)

, Well No. **1-7**, in **H** (Unit) The well is

located **660** feet from the **East** line and **1980** feet from the

**North**

line of Section **7**, T. **138**, R. **36E**, NMPM.

(GIVE LOCATION FROM SECTION LINE)

**Undesignated** Pool, **Lee** County

If State Land the Oil and Gas Lease is No. \_\_\_\_\_

If patented land the owner is **W. H. Anderson**

Address **Tatum, New Mexico**

We propose to drill well with drilling equipment as follows: **Rotary**

The status of plugging bond is **J. S. Ward & Sons**

**Artesia, New Mexico**

Drilling Contractor **Unknown at present**

We intend to complete this well in the **Wolfcamp** formation at an approximate depth of **10,500** feet.

CASING PROGRAM

We propose to use the following strings of Casing and to cement them as indicated:

Size of Hole	Size of Casing	Weight per Foot	New or Second Hand	Depth	Sacks Cement
15"	11-3/4"	42#	New	325	350
11"	8-5/8"	32# and 24#	New	4,500	500
7-7/8"	5-1/2"	17# and 15.5#	New	10,500	400

If changes in the above plans become advisable we will notify you immediately.

ADDITIONAL INFORMATION (If recompletion give full details of proposed plan of work.)

Approved \_\_\_\_\_, 19\_\_\_\_  
Except as follows:

Sincerely yours,

**Union Oil Company of California**  
(Company or Operator)

By **R. W. Yalson**

Position **Drilling Supt.**

Send Communications regarding well to

Name **Union Oil Company of California**

Address **619 West Texas Ave., Midland, Texas**

OIL CONSERVATION COMMISSION

By **[Signature]**

NEW MEXICO OIL CONSERVATION COMMISSION  
Well Location and Acreage Dedication Plat

PROCESSED 000  
M 8 41

Section A.

Date 11-23-1957

Operator Union Oil Company of California Lease W. H. Anderson  
Well No. 1-7 Unit Letter H Section 7 Township 13 South Range 36 East NMPM  
Located 1980 Feet From North Line, 660 Feet From East Line  
County Lea G. L. Elevation 1402 Dedicated Acreage 40 Acres  
Name of Producing Formation Wolfcamp Pool Undesignated

1. Is the Operator the only owner\* in the dedicated acreage outlined on the plat below?  
Yes \_\_\_\_\_ No X
2. If the answer to question one is "no," have the interests of all the owners been consolidated by communitization agreement or otherwise? Yes X No \_\_\_\_\_. If answer is "yes," Type of Consolidation Unit Operating Agreement
3. If the answer to question two is "no," list all the owners and their respective interests below:

<u>Owner</u>	<u>Land Description</u>

Section B

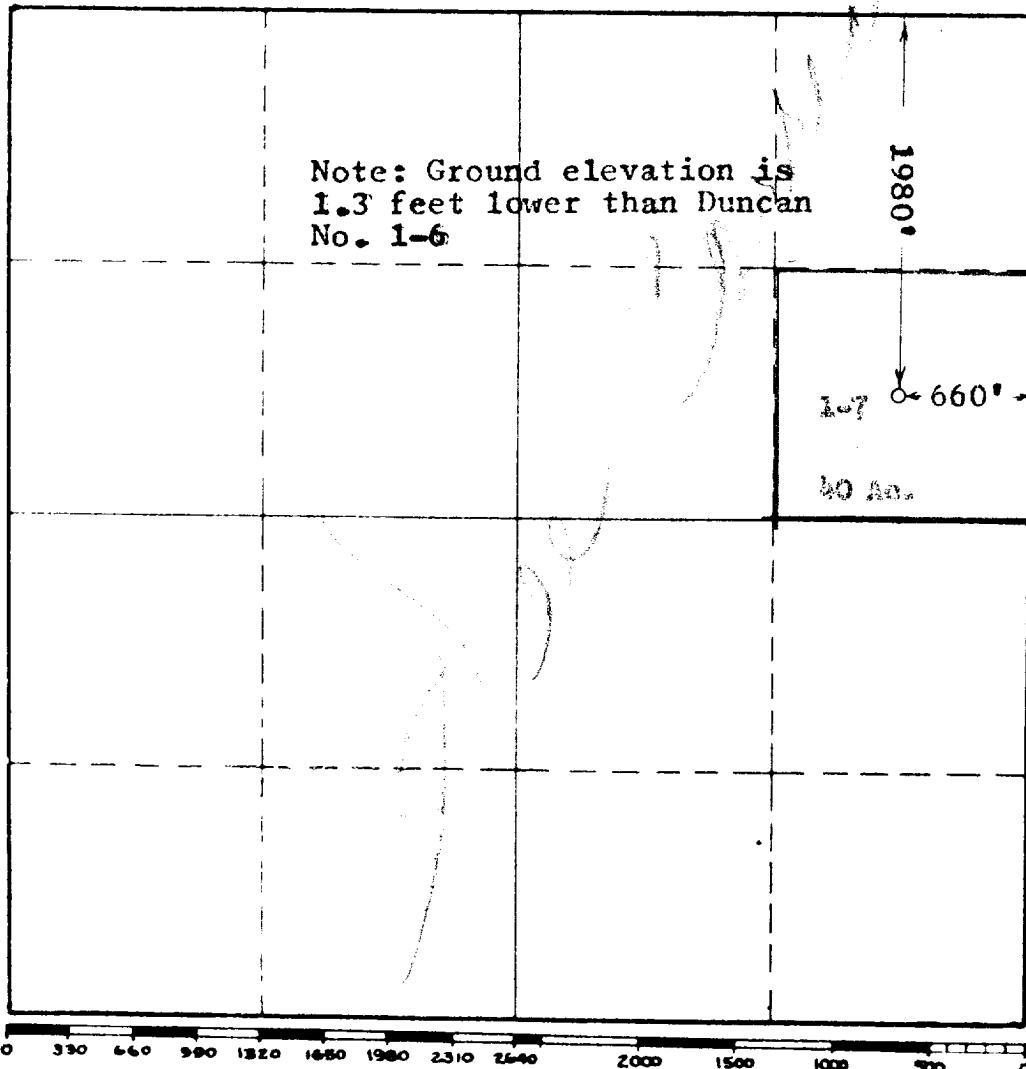

This is to certify that the information in Section A above is true and complete to the best of my knowledge and belief.

Union Oil Company of California  
(Operator)  
R. W. Yarbrough  
(Representative)  
619 West Travis Avenue  
Midland, Texas  
Address

This is to certify that the well location shown on the plat in Section B was plotted from field notes of actual surveys made by me or under my supervision and that the same is true and correct to the best of my knowledge and belief.

Date Surveyed 11-23-1957  
John W. West  
Registered Professional  
Engineer and/or Land Surveyor.