

NO. OF COPIES RECEIVED	
DISTRIBUTION	
SANTA FE	
FILE	
U.S.G.S.	
LAND OFFICE	
OPERATOR	

NEW MEXICO OIL CONSERVATION COMMISSION

HUBBS OFFICE O. C. C.  
 MAY 24 11 35 AM '68

Form C-101  
 Revised 1-1-65

5A. Indicate Type of Lease  
 STATE  FEE

5. State Oil & Gas Lease No.  
 K 6270

7. Unit Agreement Name

8. Farm or Lease Name  
 Huber State

9. Well No. 1

10. Field and Pool, or Wildcat  
 Wildcat

12. County  
 Lea

19. Proposed Depth 10300  
 19A. Formation Lower Penn  
 20. Rotary or C.T. Rotary

21. Elevations (Show whether DF, RT, etc.) 9250.9 GL.  
 21A. Kind & Status Plug. Bond Blanket  
 21B. Drilling Contractor Moran Drilling Co.  
 22. Approx. Date Work will start 5/25/68

APPLICATION FOR PERMIT TO DRILL, DEEPEN, OR PLUG BACK

1a. Type of Work

b. Type of Well DRILL  DEEPEN  PLUG BACK   
 OIL WELL  GAS WELL  OTHER   
 SINGLE ZONE  MULTIPLE ZONE

2. Name of Operator  
 Hando Properties, Ltd.

3. Address of Operator  
 Box 953, Midland, Texas

4. Location of Well  
 UNIT LETTER L LOCATED 650 FEET FROM THE W LINE  
 AND 2130 FEET FROM THE S LINE OF SEC. 9 TWP. 12S RGE. 33E NMPM

23. PROPOSED CASING AND CEMENT PROGRAM

SIZE OF HOLE	SIZE OF CASING	WEIGHT PER FOOT	SETTING DEPTH	SACKS OF CEMENT	EST. TOP
17 1/2	13 3/8	32	375	400	circ
12	8 5/8	24 & 32	3200	400	1850
7	4 1/2	11.6 & N-80	10300	280	8700

COMMISSION MUST BE NOTIFIED  
 24 HOURS PRIOR TO RUNNING CASING

APPROVAL VALID  
 FOR 90 DAYS UNLESS  
 DRILLING COMMENCED

8-28-68

IN ABOVE SPACE DESCRIBE PROPOSED PROGRAM: IF PROPOSAL IS TO DEEPEN OR PLUG BACK, GIVE DATA ON PRESENT PRODUCTIVE ZONE AND PROPOSED NEW PRODUCTIVE ZONE. GIVE BLOWOUT PREVENTER PROGRAM, IF ANY.

I hereby certify that the information above is true and complete to the best of my knowledge and belief.

Signed [Signature] Title Agent Date 5/23/68

(This space for State Use)

APPROVED BY [Signature] TITLE \_\_\_\_\_ DATE \_\_\_\_\_

CONDITIONS OF APPROVAL, IF ANY:

NEW MEXICO OIL CONSERVATION COMMISSION  
WELL LOCATION AND ACREAGE DEDICATION PLAT

Form C-102  
Supersedes C-128  
Effective 1-1-65

All distances must be from the outer boundaries of the Section.

OFFICE O. C. C.  
MAY 24 11 35 AM '68  
HUBER STATE

Operator <b>MEADCO PROPERTIES, LTD.</b>		Lease <b>HUBER STATE</b>		Well No. <b>1</b>
Unit Letter <b>L</b>	Section <b>9</b>	Township <b>12 SOUTH</b>	Range <b>33 EAST</b>	County <b>LEA</b>
Actual Footage Location of Well: <b>2130</b> feet from the <b>SOUTH</b> line and <b>660</b> feet from the <b>WEST</b> line				
Ground Level Elev. <b>4260.9</b>	Producing Formation <b>Lower Penn</b>	Pool <b>Wildcat</b>	Dedicated Acreage <b>88 40</b> Acres	

- Outline the acreage dedicated to the subject well by colored pencil or hachure marks on the plat below.
- If more than one lease is dedicated to the well, outline each and identify the ownership thereof (both as to working interest and royalty).
- If more than one lease of different ownership is dedicated to the well, have the interests of all owners been consolidated by communitization, unitization, force-pooling, etc?

Yes  No If answer is "yes," type of consolidation \_\_\_\_\_

If answer is "no," list the owners and tract descriptions which have actually been consolidated. (Use reverse side of this form if necessary.) \_\_\_\_\_

No allowable will be assigned to the well until all interests have been consolidated (by communitization, unitization, forced-pooling, or otherwise) or until a non-standard unit, eliminating such interests, has been approved by the Commission.

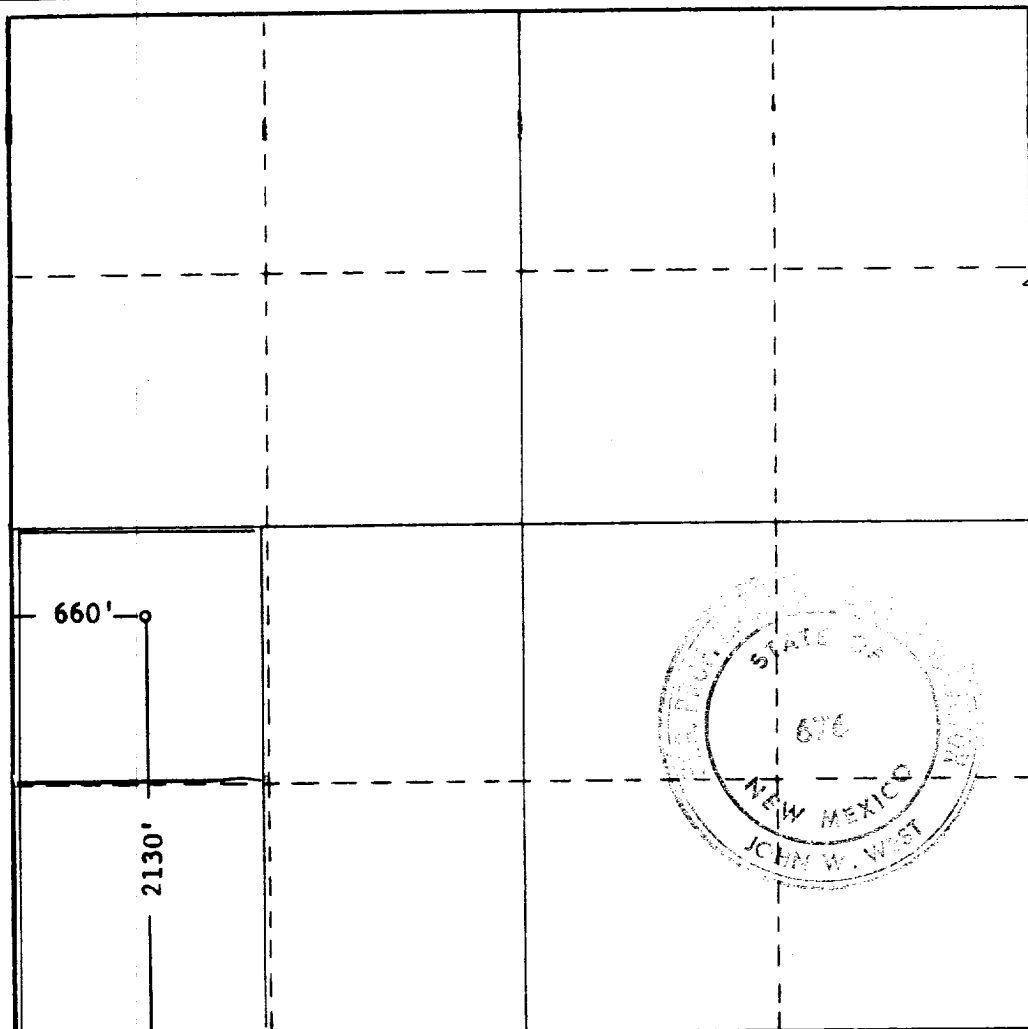

CERTIFICATION

I hereby certify that the information contained herein is true and complete to the best of my knowledge and belief.

Name *[Signature]*  
Position  
**Agent**

Company  
**Meadco Properties, Ltd.**

Date  
**5/23/68**

I hereby certify that the well location shown on this plat was plotted from field notes of actual surveys made by me or under my supervision, and that the same is true and correct to the best of my knowledge and belief.

Date Surveyed  
**MAY 21, 1968**

Registered Professional Engineer and/or Land Surveyor

*[Signature]*  
Certificate No. **676**

