

✓

NO. OF COPIES RECEIVED		
DISTRIBUTION		
SANTA FE		
FILE		
U.S.G.S.		
LAND OFFICE		
OPERATOR		

NEW MEXICO OIL CONSERVATION COMMISSION

Form C-101
Revised 1-1-65 **30 025-239M**

5A. Indicate Type of Lease	
STATE <input checked="" type="checkbox"/>	FEE <input type="checkbox"/>
5. State Oil & Gas Lease No.	

APPLICATION FOR PERMIT TO DRILL, DEEPEN, OR PLUG BACK

1a. Type of Work DRILL <input checked="" type="checkbox"/> DEEPEN <input type="checkbox"/> PLUG BACK <input type="checkbox"/>		7. Unit Agreement Name
b. Type of Well OIL WELL <input checked="" type="checkbox"/> GAS WELL <input type="checkbox"/> OTHER <input type="checkbox"/> SINGLE ZONE <input checked="" type="checkbox"/> MULTIPLE ZONE <input type="checkbox"/>		8. Farm or Lease Name State "B" A/c-1
2. Name of Operator TEXAS PACIFIC OIL CO., INC.		9. Well No. 5
3. Address of Operator P. O. Box 1069 - Hobbs, New Mexico 88240		10. Field or Pool Name UNDESIGNATED
4. Location of Well UNIT LETTER L LOCATED 1980 FEET FROM THE South LINE AND 660 FEET FROM THE West LINE OF SEC. 10 TWP. 12-S RGE. 33-E NMPM		12. County Lea
19. Proposed Depth 9750'		19A. Formation Penn
20. Rotary or C.T. Rotary		
21. Elevations (Show whether DF, RT, etc.) 4253.6' GR	21A. Kind & Status Plug. Bond As Required	21B. Drilling Contractor Hondo
22. Approx. Date Work will start Upon Approval		

23. PROPOSED CASING AND CEMENT PROGRAM

SIZE OF HOLE	SIZE OF CASING	WEIGHT PER FOOT	SETTING DEPTH	SACKS OF CEMENT	EST. TOP
16"	13-3/8"	40#	350	375	Circ
12-1/4"	8-5/8"	24 & 32#	3950'	350	
7-7/8"	5-1/2"	17, 15.5 & 14#	9750'	350	

THE COMMISSION MUST BE NOTIFIED
24 HOURS PRIOR TO RUNNING **13 3/4**
CASING.

APPROVAL VALID
FOR 90 DAYS UNLESS
DRILLING COMMENCED,
EXPIRES **3-27-72**

IN ABOVE SPACE DESCRIBE PROPOSED PROGRAM: IF PROPOSAL IS TO DEEPEN OR PLUG BACK, GIVE DATA ON PRESENT PRODUCTIVE ZONE AND PROPOSED NEW PRODUCTIVE ZONE. GIVE BLOWOUT PREVENTER PROGRAM, IF ANY.

I hereby certify that the information above is true and complete to the best of my knowledge and belief.

Signed Sheldon Ward Title Area Superintendent Date 12-22-71

(This space for State Use)

APPROVED BY [Signature] TITLE SUPERVISOR DISTRICT 1 DATE DEC 27 1971

CONDITIONS OF APPROVAL, IF ANY:

RECEIVED

1 - 121971

OIL CONSERVATION COMM.
HOODES, H. M.

NEW MEXICO OIL CONSERVATION COMMISSION
WELL LOCATION AND ACREAGE DEDICATION PLAT

Form O-102
Supersedes O-128
Effective 11-65

All distances must be from the outer boundaries of the Section

Operator TEXAS PACIFIC OIL COMPANY			Lease STATE B ACCOUNT 1		Well No. 5
Unit Letter L	Section 10	Township 12 SOUTH	Range 33 EAST	County LEA	
Actual Footage Location of Well: 1980 feet from the SOUTH line and 660 feet from the WEST line					
Ground Level Elev. 4253.6	Producing Formation Penn		Pool North Bagley		Dedicated Acreage: 80 Acres

1. Outline the acreage dedicated to the subject well by colored pencil or hachure marks on the plat below.
2. If more than one lease is dedicated to the well, outline each and identify the ownership thereof (both as to working interest and royalty).
3. If more than one lease of different ownership is dedicated to the well, have the interests of all owners been consolidated by communitization, unitization, force-pooling, etc?

☐ Yes ☐ No If answer is "yes," type of consolidation _____

If answer is "no," list the owners and tract descriptions which have actually been consolidated. (Use reverse side of this form if necessary.) _____

No allowable will be assigned to the well until all interests have been consolidated (by communitization, unitization, forced-pooling, or otherwise) or until a non-standard unit, eliminating such interests, has been approved by the Commission.

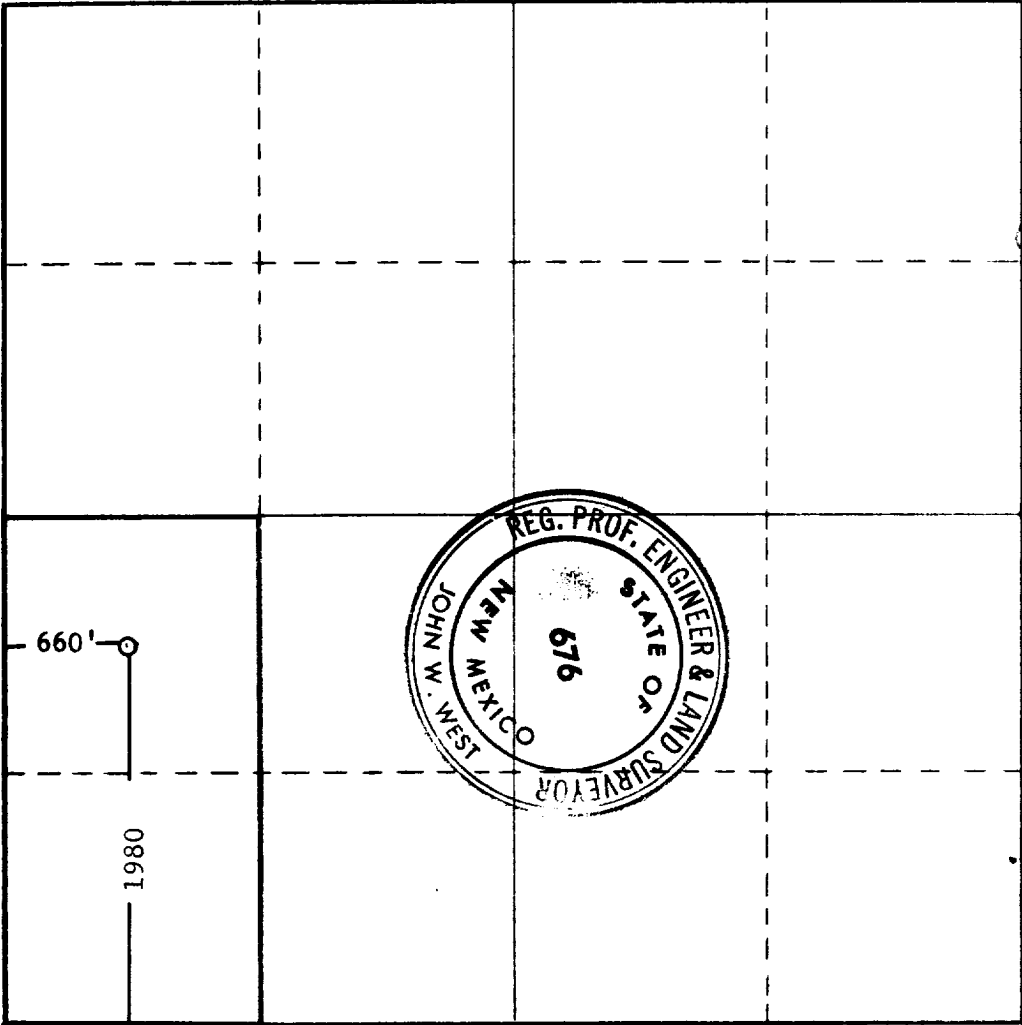

CERTIFICATION

I hereby certify that the information contained herein is true and complete to the best of my knowledge and belief.

Sheldon Ward
Name
Sheldon Ward

Position
Area Superintendent

Company
TEXAS PACIFIC OIL CO., INC.

Date
12-22-71

I hereby certify that the well location shown on this plat was plotted from field notes of actual surveys made by me or under my supervision, and that the same is true and correct to the best of my knowledge and belief.

Date Surveyed
DEC. 18, 1971

Registered Professional Engineer and/or Land Surveyor

John W. West
Certificate No. **676**

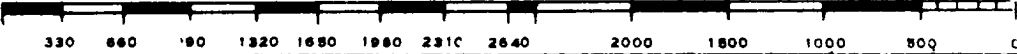

173

RECEIVED

SEP 22 1971

OIL CONSERVATION COMM.
HOBBBS, H. D.