

20-025-27239

NO. COPIES RECEIVED		
DISTRIBUTION		
SANTA FE		
FILE		
U.S.G.S.		
LAND OFFICE		
OPERATOR		

NEW MEXICO OIL CONSERVATION COMMISSION

Form C-101
Revised 1-1-85

5A. Indicate Type of Lease
STATE FEE
6. State Oil & Gas Lease No.
LG 3224

APPLICATION FOR PERMIT TO DRILL, DEEPEN, OR PLUG BACK

1a. Type of Work
b. Type of Well DRILL DEEPEN PLUG BACK
OIL WELL GAS WELL OTHER SINGLE ZONE MULTIPLE ZONE
2. Name of Operator
Gulf Oil Corporation
3. Address of Operator
P. O. Box 670
4. Location of Well UNIT LETTER **P** LOCATED **330** FEET FROM THE **South** LINE
AND **330** FEET FROM THE **East** LINE OF SEC. **16** TWP. **14S** RGE. **33E** NMPM
7. Well Agreement Name
8. Farm or Lease Name
Lea "VF" State
9. Well No.
1
10. Field and Pool, or Well Unit
Saunders Permo Penn
11. County
Lea
18. Proposed Depth
10,100'
19A. Formation
Permo Penn
20. Rotary or C.T.
Rotary
21. Elevations (Show whether DF, RT, etc.)
4208.7' GL
21A. Kind & Status Plug. Bond

21B. Drilling Contractor
Sharp
22. Approx. Date Work will start
1-28-81

PROPOSED CASING AND CEMENT PROGRAM

SIZE OF HOLE	SIZE OF CASING	WEIGHT PER FOOT	SETTING DEPTH	SACKS OF CEMENT	EST. TOP
15"	11-3/4"	42#	400'	600	circ
11"	8-5/8"	28#	4100'	1200	circ
7-7/8"	5 1/2"	17#	10,100'	will be determined by log caliper	8000'

Drilling Fluids: 0' - 400' FW Spud Mud
400' - 4100' Saturated BW
4100' - 10,100' Brackish water 8.5-10.0 ppg

SEE ATTACHED BOP DRAWING #4

APPROVAL VALID FOR 180 DAYS
PERMIT EXPIRES 7/22/81
ONCE DRILLING UNDERWAY

IN ABOVE SPACE DESCRIBE PROPOSED PROGRAM; IF PROPOSAL IS TO DEEPEN OR PLUG BACK, GIVE DATA ON PRESENT PRODUCTIVE ZONE AND PROPOSED NEW PRODUCTIVE ZONE. GIVE BLOWOUT PREVENTER PROGRAM, IF ANY.

I hereby certify that the information above is true and complete to the best of my knowledge and belief.

Signed R.C. Anderson Title Area Production Manager Date 1-21-81

(This space for State Use)

APPROVED BY Jessie Clements TITLE OIL & GAS DATE 1-21-81

CONDITIONS OF APPROVAL, IF ANY:

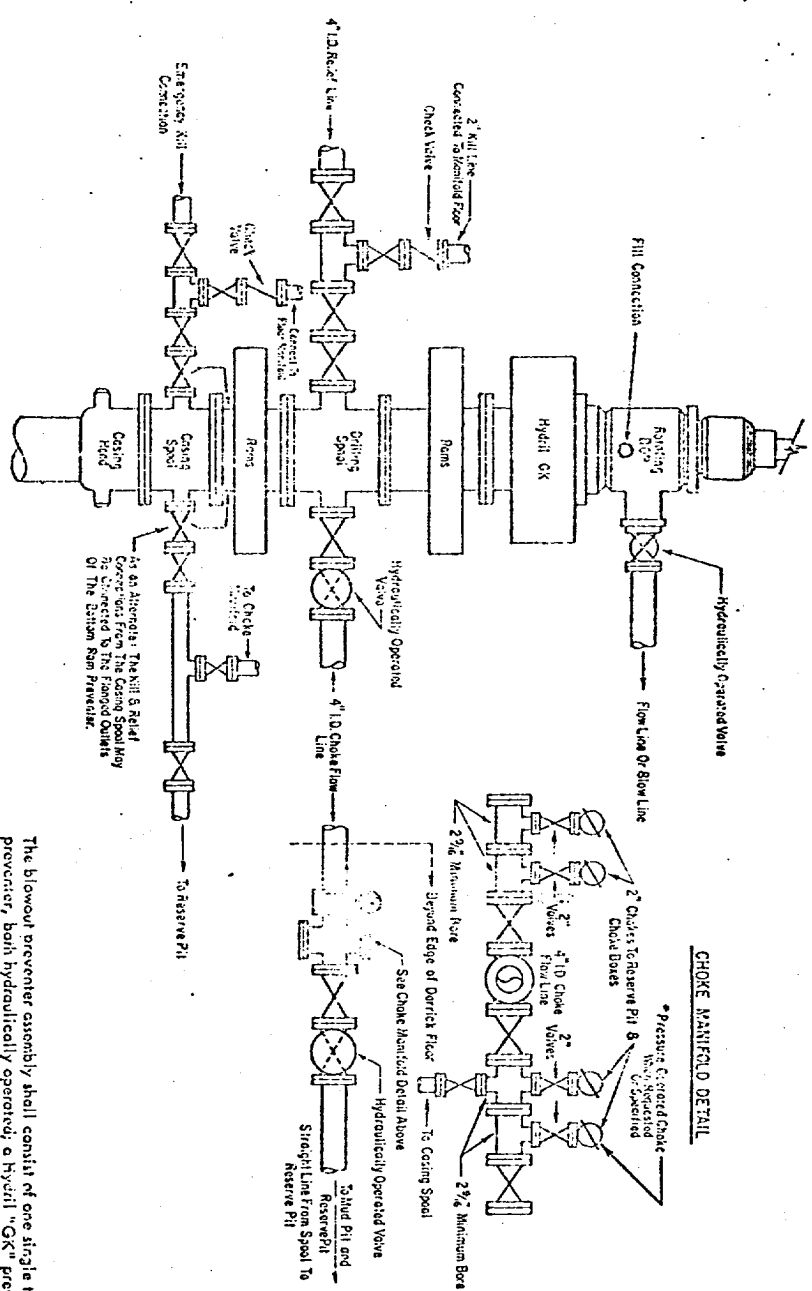

ADDITIONS - DELETIONS - CHANGES
SPECIFY

**5000 PSI WORKING PRESSURE
BLOWOUT PREVENTER HOOK-UP**

The blowout preventer assembly shall consist of one single type blind ram preventer and one single type pipe ram preventer, both hydraulically operated, a Hydral "GK" preventer, a ram preventer, blowout preventer valves, chokes and connections, as illustrated. If a tapered drill string is used, a ram preventer must be provided for each size of drill pipe. Casing and tubing rams to fit the preventer are to be available as needed. If correct in size, the tapered outlets of the ram preventer may be used for connecting to the 4-inch I.D. choke flow line and 4-inch I.D. relief line, except when air or gas drilling. All preventer connections are to be open-face flanged.

Minimum operating equipment for the preventer and hydraulically operated valves shall be as follows: (1) Multiple pumps, driven by a continuous source of power, capable of fluid charging the total accumulator volume from the nitrogen precharge pressure to its rated pressure within _____ minutes. Also, the pumps are to be connected to the hydraulic operating system, which is to be a closed system. (2) Accumulators with a precharge of nitrogen of not less than 750 PSI and connected so as to receive the de-aerated fluid charge. With the charging pumps shut down, the pressurized fluid volume stored in the accumulators must be sufficient to close all the pressure-operated devices simultaneously within _____ seconds after closure. With the remaining accumulator pressure shall be not less than 1000 PSI with the remaining accumulator fluid volume at least _____ percent of the original. (3) When requested, an additional source of power, remote and equivalent, is to be available to operate the above pumps; or there shall be additional pumps operated by separate power and equal in performance capabilities.

The choke manifold and choke closing manifold shall have a separate control for each pressure-operated device. Controls are to be labeled, with control handles indicating open and closed positions. A pressure gauge and regulator must be provided for operating the Hydral preventer. When requested, a second pressure reducer shall be available to limit operating fluid pressures to ram preventers. A pressure gauge and regulator must be provided for operating the Hydral preventer. When requested, a second pressure reducer shall be available to limit operating fluid pressures to ram preventers.

The choke manifold, choke flow line, relief line, and choke lines are to be supported by metal stands and adequately anchored. The choke flow line, relief line, and choke line shall be constructed as strong as feasible and without sharp bends. Easy and safe access is to be maintained in the choke manifold. If deemed necessary, walkways and stairways shall be erected thereon. The choke manifold. All valves are to be selected for operation in the presence of oil, gas, and drilling fluids. The choke flow line valves and relief line valves connected to the drilling pipe and all ram type preventers must be equipped with stem extensions, universal joints if needed, and hand wheels which are to extend beyond the edge of the derrick substructure. All other valves are to be equipped with handwheels.

* To include derrick floor mounted controls.

NEW MEXICO OIL CONSERVATION COMMISSION
 WE LOCATION AND ACREAGE DEDICATION PLAT

Form C-102
 Supersedes C-128
 Effective 1-1-65

All distances must be from the outer boundaries of the Section

Operator Gulf Oil Company			Lease Lea VF State			Well No. 1
Unit Letter P	Section 16	Township 14S	Range 33E	County Lea		
Actual Footage Location of Well: 330 feet from the South line and 330 feet from the East line						
Well Elev. Elev 4208.7'	Producing Formation Permo Penn		Pool Saunders Permo Penn		Dedicated Acreage: 40 Acres	

1. Outline the acreage dedicated to the subject well by colored pencil or hachure marks on the plat below.
2. If more than one lease is dedicated to the well, outline each and identify the ownership thereof (both as to working interest and royalty).
3. If more than one lease of different ownership is dedicated to the well, have the interests of all owners been consolidated by communitization, unitization, force-pooling, etc?

Yes No If answer is "yes," type of consolidation _____

If answer is "no," list the owners and tract descriptions which have actually been consolidated. (Use reverse side of this form if necessary.) _____

No allowable will be assigned to the well until all interests have been consolidated (by communitization, unitization, forced-pooling, or otherwise) or until a non-standard unit, eliminating such interests, has been approved by the Commission.

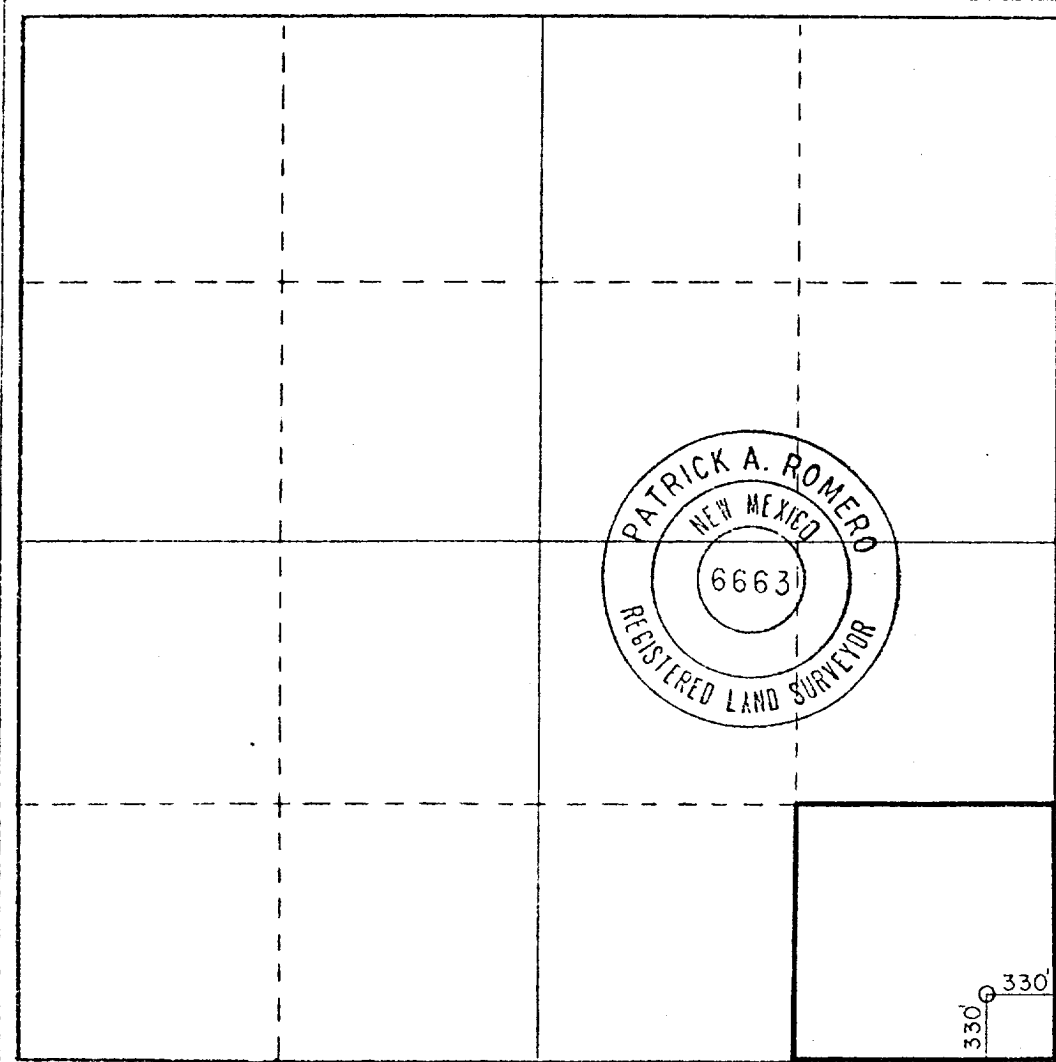

CERTIFICATION

I hereby certify that the information contained herein is true and complete to the best of my knowledge and belief.

R. C. Anderson

Name

R. C. ANDERSON

Position

Area Production Manager

Company

Gulf Oil Corporation

Date

1-21-81

I hereby certify that the well location shown on this plat was plotted from field notes of actual surveys made by me or under my supervision, and that the same is true and correct to the best of my knowledge and belief.

Date Surveyed

Jan. 19, 1981

Registered Professional Engineer and/or Land Surveyor

Patrick A. Romero

Certificate No **JOHN W. WEST 676**
PATRICK A. ROMERO 6663
Ronald J. Eidson 3239

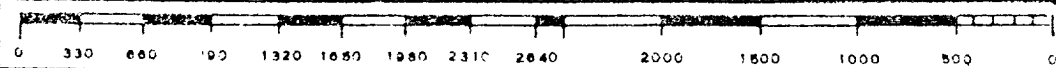

RECEIVED
JAN 21 1981
FBI - MEMPHIS

473