

P. O. BOX 2088

SANTA FE, NEW MEXICO 87501

NO. OF COPIES RECEIVED	
DISTRIBUTION	
SANTA FE	
FILE	
U.S.G.S.	
LAND OFFICE	
OPERATOR	

5A. Indicate Type of Lease
STATE FEDERAL

5. State Oil & Gas Lease No.
LG-2670

APPLICATION FOR PERMIT TO DRILL, DEEPEN, OR PLUG BACK

1. Type of Work

2. Type of Well DRILL DEEPEN PLUG BACK
OIL WELL GAS WELL OTHER SINGLE ZONE MULTIPLE ZONE

7. Unit Agreement Name

8. Farm or Lease Name

Dove "VK" State

Name of Operator

Yates Petroleum Corporation

9. Well No.

1

Address of Operator

207 S. 4th, Artesia, New Mexico 88210

10. Field and Pool, or Wildcat

Lazy J Penn

Location of Well

UNIT LETTER L LOCATED 1980 FEET FROM THE South LINE

12. County

Lea

660 FEET FROM THE West LINE OF SEC. 3 TWP. 14S RGE. 33E NMPM

19. Proposed Depth

10,200'

19A. Formation

Permo Penn

20. Rotary or C.T.

Rotary

Elevations (Show whether DF, KI, etc.)

4232.2' GL

21A. Kind & Status Plug. Bond

Blanket

21B. Drilling Contractor

Collier

22. Approx. Date Work will start

ASAP

PROPOSED CASING AND CEMENT PROGRAM

SIZE OF HOLE	SIZE OF CASING	WEIGHT PER FOOT	SETTING DEPTH	SACKS OF CEMENT	EST. TOP
17 1/2"	13 3/8"	48# J-55	450'	400 sx	circulated
12 1/4"	8 5/8"	24# J-55	4200'	1300 sx	400'
7 7/8"	5 1/2"	17# N-80-L	TD	450 sx	9200'
		17# N-55-L			
		17# K-55-S			
		17# N-80-L			

We propose to drill a 10,150' well and test the Permo-Penn and intermediate formations. Approximately 450' of surface casing will be set and cement circulated and approximately 4200' of intermediate will be set and cement circulated back to about 400'. Production casing will be set to TD and cemented back to approximately 9200'.

MUD PROGRAM: FW gel to 450', native mud 4200', water & paper to 7500', starch-driskpak-KCL to TD.

BOP PROGRAM: BOP's will be installed at the offset and tested daily.

ABOVE SPACE DESCRIBE PROPOSED PROGRAM; IF PROPOSAL IS TO DEEPEN OR PLUG BACK, GIVE DATA ON PRESENT PRODUCTIVE ZONE AND PROPOSED NEW PRODUCTION ZONE. GIVE BLOWOUT PREVENTER PROGRAM, IF ANY.

I hereby certify that the information above is true and complete to the best of my knowledge and belief.

[Signature]
(This space for State Use)

Title Regulatory Manager

Date 10/20/82

APPROVED BY *[Signature]*

TITLE OIL & GAS INSPECTOR

DATE 09/01 1982

CONDITIONS OF APPROVAL, IF ANY:

APPROVAL VALID FOR 180 DAYS
PERMIT EXPIRES 4/21/83
UNLESS DRILLING UNDERWAY



RECEIVED

OCT 21 1982

O.C.O.
HOBBS OFFICE

N MEXICO OIL CONSERVATION COMMISS
WELL LOCATION AND ACREAGE DEDICATION PLAT

Form C-102
Supersedes C-128
Effective 1-1-65

All distances must be from the outer boundaries of the Section.

Operator YATES PETROLEUM CORPORATION		Lease Dove "VK" State		Well No. 1
Unit Letter L	Section 3	Township 14 South	Range 33 East	County Lea
Actual Footage Location of Well: 1980 feet from the South line and 660 feet from the West line				
Ground Level Elev. 4232.2'	Producing Formation Penn	Pool Lazy J Penn	Dedicated Acreage: 40 Acres	

1. Outline the acreage dedicated to the subject well by colored pencil or hachure marks on the plat below.
2. If more than one lease is dedicated to the well, outline each and identify the ownership thereof (both as to working interest and royalty).
3. If more than one lease of different ownership is dedicated to the well, have the interests of all owners been consolidated by communitization, unitization, force-pooling, etc?

Yes No If answer is "yes," type of consolidation _____

If answer is "no," list the owners and tract descriptions which have actually been consolidated. (Use reverse side of this form if necessary.) _____

No allowable will be assigned to the well until all interests have been consolidated (by communitization, unitization, forced-pooling, or otherwise) or until a non-standard unit, eliminating such interests, has been approved by the Commission.

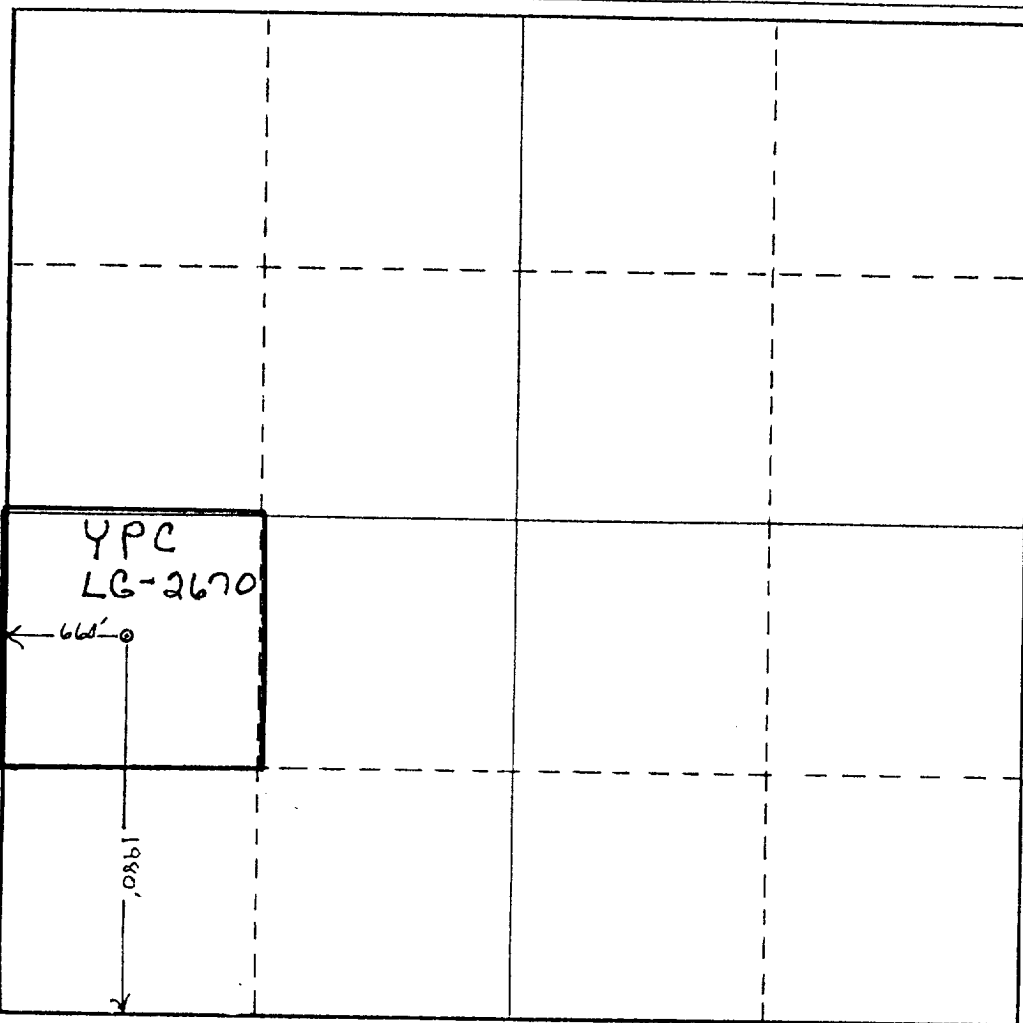

CERTIFICATION

I hereby certify that the information contained herein is true and complete to the best of my knowledge and belief.

Gliserio Rodriguez
Name
Gliserio Rodriguez

Position
Regulatory Manager

Company
Yates Petroleum Corp.

Date
10/21/82

I hereby certify that the location shown on this plat was plotted from field notes of actual surveys made by me or under my supervision, and that the same is true and correct to the best of my knowledge and belief.

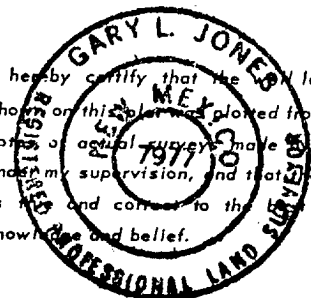

Date Surveyed
October 20, 1982

Registered Professional Engineer and/or Land Surveyor

Dan Jones
Certificate No.

7977

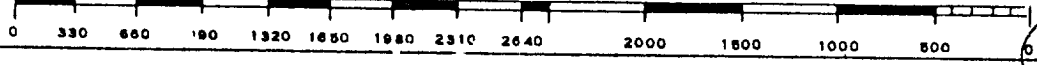

18

RECEIVED
OCT 21 1982
S. C. J.
HOBBS OFFICE

grating head if necessary
Fill up Line

ROTATING
BOP
2000 psi

Flowline

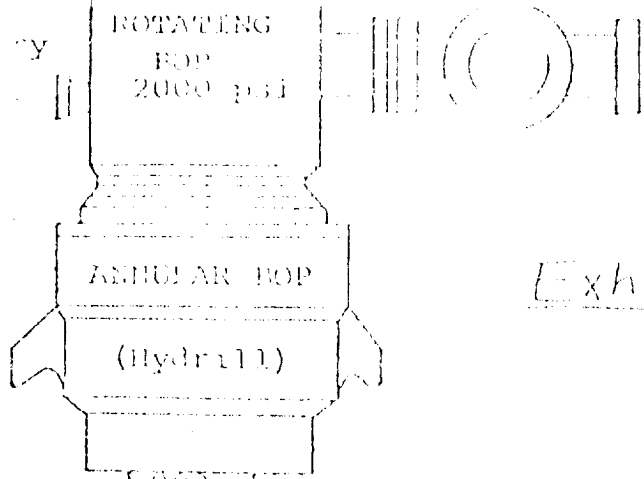
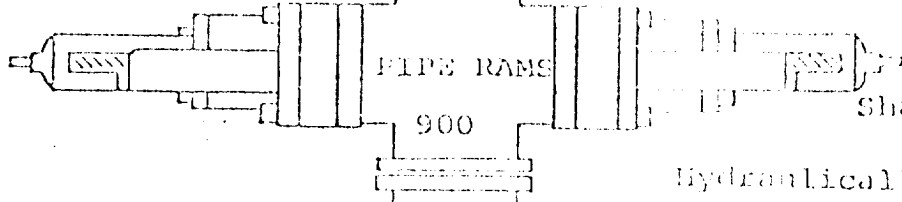

Exhibit B

900



PIPE RAMS
900

Shaffer 10" Series 900
Hydraulically Operated B.O.P.'s

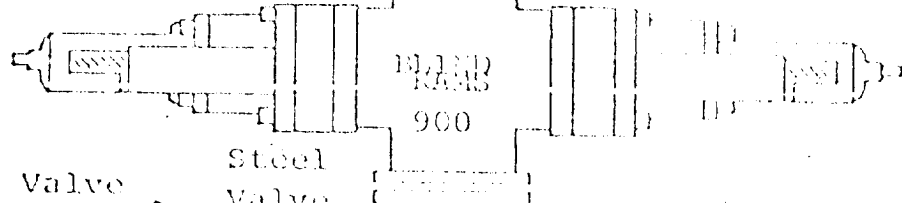

PIPE RAMS
900

Check Valve
Kill Line



Steel Valve

900

4" Inch Line

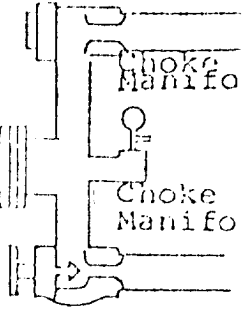

Choke Manifo

Choke Manifo

Ringhead or Brasshead

900

THE FOLLOWING CONSTITUTE MINIMUM BLOWOUT PREVENTER REQUIREMENTS

- All preventers to be hydraulically operated with secondary manual control installed prior to drilling out from under casing.
- Choke outlet to be a minimum of 4" diameter.
- Kill line to be of all steel construction of 2" minimum diameter.
- All connections from operating manifolds to preventers to be all steel, hole or tube a minimum of one inch in diameter.
- The available closing pressure shall be at least 15% in excess of that required with sufficient volume to operate the B.O.P.'s.
- All connections to and from preventer to have a pressure rating equivalent to that of the B.O.P.'s.
- Inside blowout preventer to be available on rig floor.
- Operating controls located a safe distance from the rig floor.
- Hole must be kept filled on trips below intermediate casing. Operator not responsible for blowouts resulting from not keeping hole full.
- D. P. float must be installed and used before any of first gas intrusion

F

RECEIVED
OCT 21 1982
U.S. AIR FORCE

173